

EPIC[®] SOLAR Crimp tool 44428001

Operating Instructions
For all EPIC[®] SOLAR crimping contacts



EPIC® SOLAR CRIMP TOOL

Important Operating Instructions for the correct handling of the EPIC® SOLAR Crimp tool

Handling of the Operating Instructions Manual

The Operating Instructions manual of the EPIC® SOLAR Crimp tool must always be kept with the tool. Everybody who works with the EPIC® SOLAR Crimp tool must know the manual and follow its instructions. The LAPP Group disclaims any liability for damages caused by improper handling and failure to follow the operating instructions of the EPIC® SOLAR Crimp tool. This operating instructions manual should also be supplemented by other national regulations concerning accident prevention and environmental protection rules should they exist.

Basic safety instructions

The EPIC® SOLAR Crimp tool is designed to the very latest technology and recognized safety rules and exclusively for the purpose described herein.

Remark:

Cumulative trauma symptoms can occur as a result of a sustained use of these manual crimping pliers. Manual crimping pliers are meant for occasional use only and with relatively small quantities at a time.

Responsibilities

The EPIC® SOLAR Crimp tool may be operated only by instructed and authorized persons. No changes or modifications shall be made to the EPIC® SOLAR Crimp tool, if modifications are made the manufacturer / supplier will not be liable for any injury or damage that may occur.

Installation and use of the EPIC® SOLAR Crimp Tool

The EPIC® SOLAR Crimp tool may only be set up and operated in safe working conditions, observing all the safety regulations and considering all possible dangers. The EPIC® SOLAR Crimp tool is to be used only for the purpose which is mentioned in the operating instruction manual. The manufacturers and suppliers will not be liable for any damages which may result due to the tool being used for a purpose other than that for which it was intended.

This instruction manual describes the use and handling of the EPIC® SOLAR Crimp tool 44428001 as well as the required maintenance procedures. The factory settings of the EPIC® SOLAR Crimp tool may not be changed. For additional information and questions which is not covered in this manual, technical support as well as repairs and settings please contact:

U.I. Lapp GmbH

Schulze-Delitzsch Str. 25

D-70565 Stuttgart

Tel.: +49-711/78 38 - 01

Fax: +49-711/78 38 - 26 40

www.lappgroup.com

EPIC[®] SOLAR CRIMP TOOL

Tool Components

The **EPIC[®] SOLAR** Crimp tool is packaged with the locator, two additional screws, a hex wrench and the operating instructions in a handy plastic case.

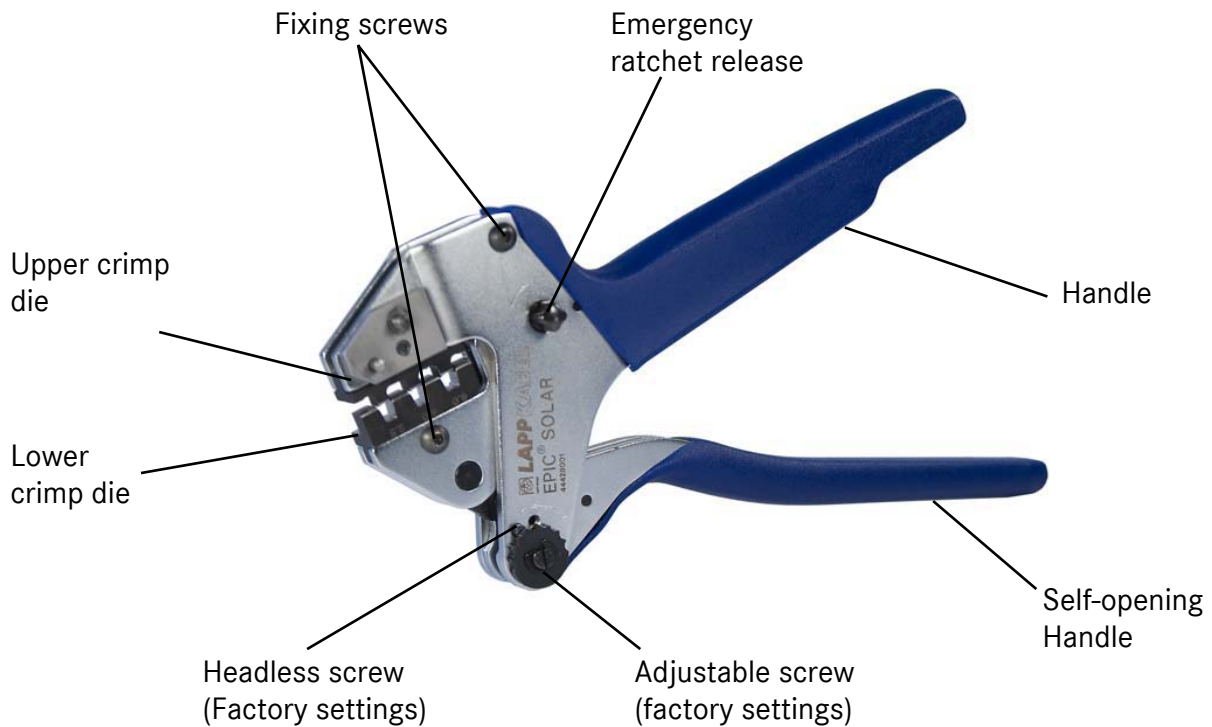

Description

The **EPIC[®] SOLAR** Crimp tool consists of the basic tool, two crimp dies, two fixing screws for the crimp dies and the emergency ratchet release. The ratchet-mechanism has six locking positions identified by audible “CLICKS”. With the sixth “CLICK”, the crimp tool is unlocked and the **EPIC[®] SOLAR** Crimp tool will open again.

Maintenance and Inspection

After usage of the **EPIC[®] SOLAR** Crimp tool we recommend the following steps:

Clean the assembled tool by removal of dust, moisture and other contaminants from the **EPIC[®] SOLAR** Crimp tool with a clean and soft brush, or a clean and soft lint-free cloth. Do not use hard or abrasive objects that could damage the tool. All pins, pivot points, and bearing surfaces should be protected with a thin coat of any good SAE No. 20 motor oil. Do not oil excessively.



For protection against an electric shock, all connections have been disconnected from power supply when assembling the connector by you.

EPIC[®] SOLAR CRIMP TOOL

EPIC[®] SOLAR Crimp tool with Locator

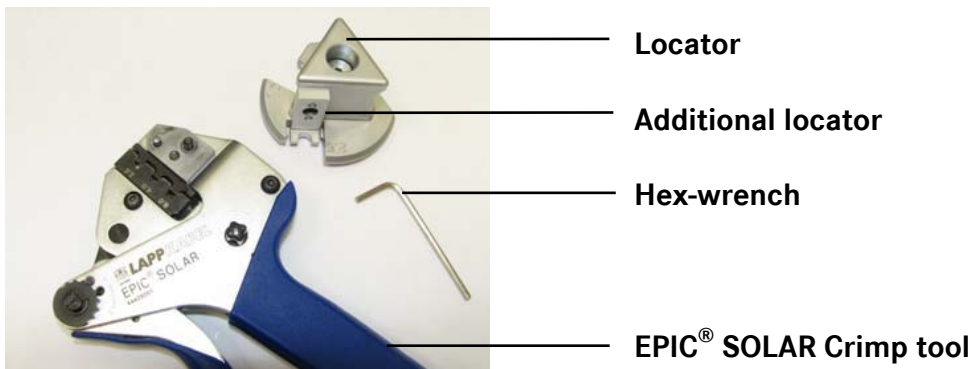

Installation of the locator

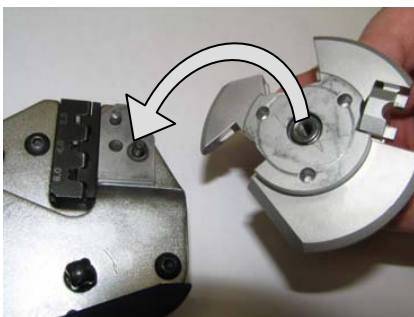

Screw the locator to the tool until it snaps in place and then tighten with the hex wrench provided.

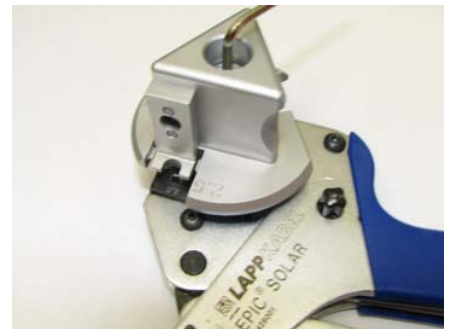

Note:

An additional locator is required for EPIC[®] SOLAR built in plugs and Hirschmann sunCon

Removing the additional locator



Remove the additional locator with the hex-wrench provided and store in the crimp tool case.

The locator of the EPIC[®] SOLAR Crimp tool has multiple positions:

- one side for 2,5 mm² contacts
- one side for 4,0 mm² contacts
- one side for 6,0 mm² contacts.

To choose the right side, pull the locator away from the EPIC[®] SOLAR Crimp tool until the index pin is cleared. Rotate 120 degrees until the desired edge is in the right position to the crimp die and then let the locator snap in place.

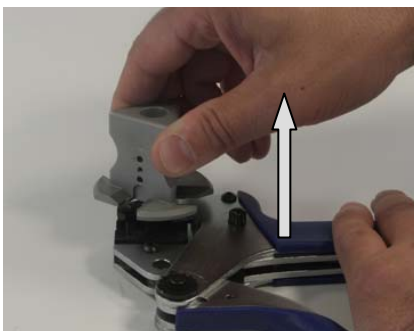

Pull it up

and rotate in steps of 120 degrees into the right position.

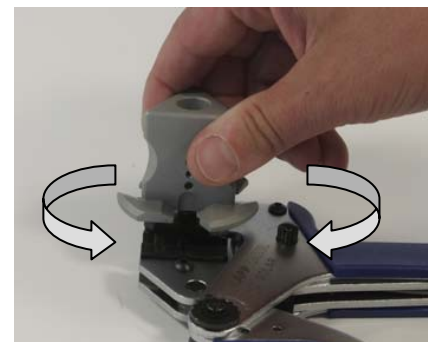

EPIC[®] SOLAR CRIMP TOOL



Female

Insulator body guide slot

EPIC[®] SOLAR field mountable M12 connectors



Male

Strip the cable 8.0 mm

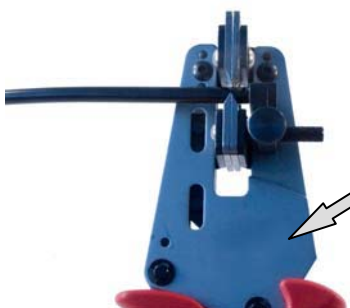

Universal STRIP SOLAR
Part number: 21920120
available from Lapp



8.0 mm



Check that the O-ring is assembled in the insulator body.



Pull the cable thru the back shell cap nut and clamping ring

Open the **EPIC[®] SOLAR** Crimp tool

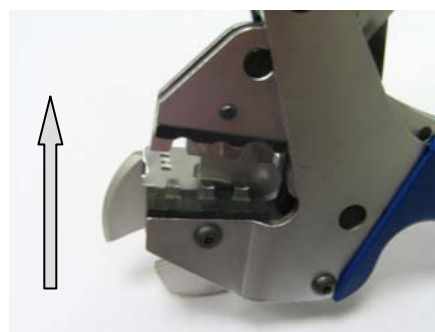

Slide the insulator body with the pre-assembled contact into the crimp tool aligning the insulator body guide slot with crimp tool positioning tabs

Insert the cable with the pre-assembled gland into the crimp contact

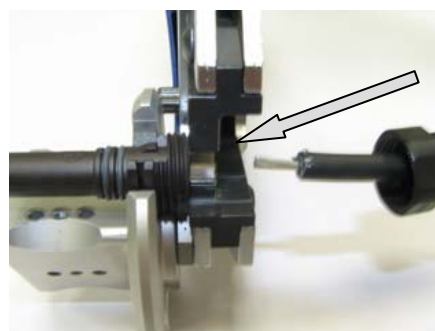

EPIC[®] SOLAR CRIMP TOOL

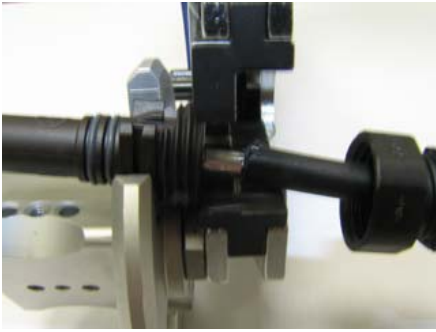

Squeeze the tool handles fully until the crimp is completed and tool unlocks.

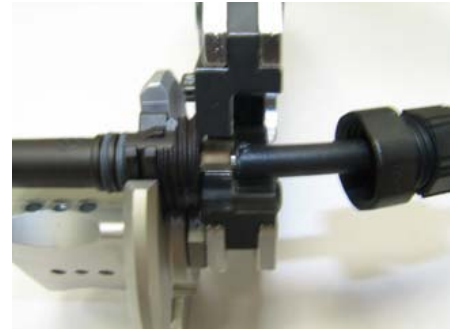

After crimping,

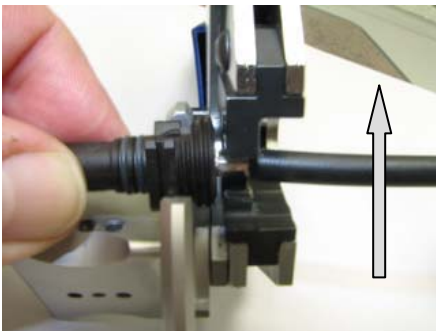

remove insulator body from the tool by moving towards upper jaw and out of the positioning tabs.

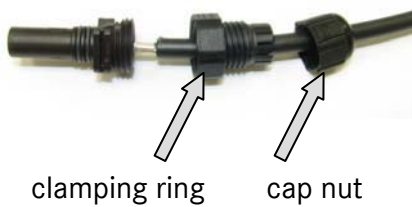
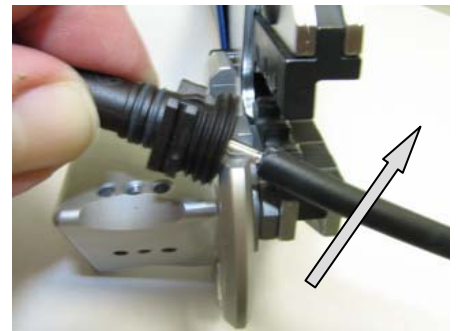

Untighten the cap nut, screw the clamping ring onto the insulator body and tighten to a torque of 2.5 Nm

Then tighten the cap nut to 2.5 Nm

Important: Hold the clamping ring immobile while tightening the cap nut – otherwise the crimp connection could be damaged.



EPIC[®] SOLAR male



EPIC[®] SOLAR female

EPIC[®] SOLAR CRIMP TOOL

How to crimp the EPIC[®] SOLAR male built in plug and EPIC[®] SOLAR female built in plug

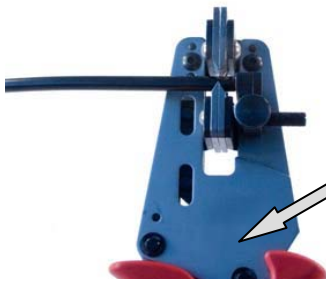

Strip the cable 8.0 mm

Universal STRIP SOLAR
Part number: 1920120

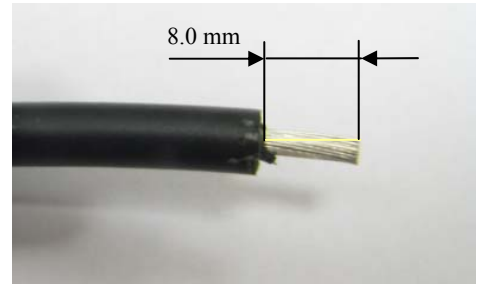

Installation of the additional locator with the EPIC[®] SOLAR Crimp tool

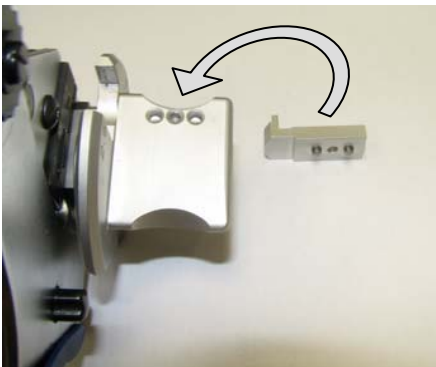

Select the cable cross section by rotating the locator to the desired position
Mount the additional locator in with the dowel pins and tighten with the hex wrench.

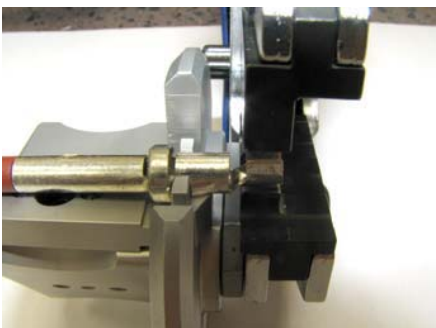

Place in the contact as shown in picture on left.

Insert the cable with the mounted plug insulator into the crimp contact

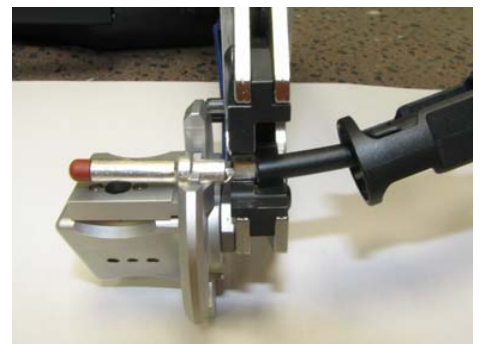

Close the EPIC[®] SOLAR Crimp tool

Take the contact out of the locator. Slide built in plug insulator towards the crimp contact until an audible snap is heard.



Note: The completed connection is irreversible !



EPIC[®] SOLAR CRIMP TOOL



LAPP GROUP

U.I. Lapp GmbH

D-70565 Stuttgart/Germany

www.lappgroup.com

L-44428001-1 V01

A company of the Lapp Group