

10399200	DATA SHEET	
Valid from: 17.09.2018	EPIC® MCS 3 / MCB 3 COAX	

Description

- The mixed assembly guarantees high flexibility. For applications in mechanical and plant engineering, for printing machines and slide-in technology.
- Assembly of individual connectors, suitable for different applications.



General Characteristics

Series	MC Module
Number of Contacts	3
Termination Methods	Solder termination: var. coax cables
Temperature Range	-40°C to +100°C, short-term up to +125°C

Artikel No.	Module	VPE
10399200	Male	10
10399300	Female	10

Mechanical Characteristics

Cycles of mechanical operation	100
--------------------------------	-----

Electrical Characteristics

Rated Voltage	250 V
Contact resistance	< 2.7 mOhm
Pollution Degree	3

Materials and Surfaces

Contact	Copper alloy, gold-plated
Module	PA
Flammability Class according to UL 94	V0

Creator: MANA2/PDP Released: IVSE1/PDP	Document: DB10399200EN Version: 02	Page 1 of 2
---	---------------------------------------	-------------

10399200	DATA SHEET	
Valid from: 17.09.2018	EPIC® MCS 3 / MCB 3 COAX	

Technical Drawing



M

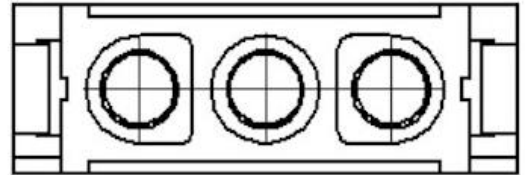

F

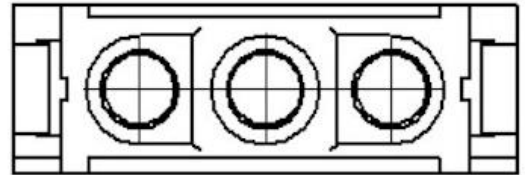

Automation



Industrial machinery and plant engineering



Wind Energy

Info

RGB video signal transmission in one module

Application range

Plant engineering
Light & sound technology
Control engineering

Remark

Photographs are not to scale and do not represent detailed images of the respective products.

Creator: MANA2/PDP Released: IVSE1/PDP	Document: DB10399200EN Version: 02	Page 2 of 2
---	---------------------------------------	-------------