

Nylon cable chains for heavy duty applications

Product	Page
SILVYN® CHAIN H57SC	130
SILVYN® CHAIN H57PC/PN	132
SILVYN® CHAIN H57B	134
SILVYN® CHAIN H57T	136
SILVYN® CHAIN H80SC/SA	138
SILVYN® CHAIN H80PC/PA	140
SILVYN® CHAIN H80B	142
SILVYN® CHAIN H80T	144
SILVYN® CHAIN H110SC/SA	146
SILVYN® CHAIN H110PC/PA	148
SILVYN® CHAIN H110B	150
SILVYN® CHAIN H110T	152

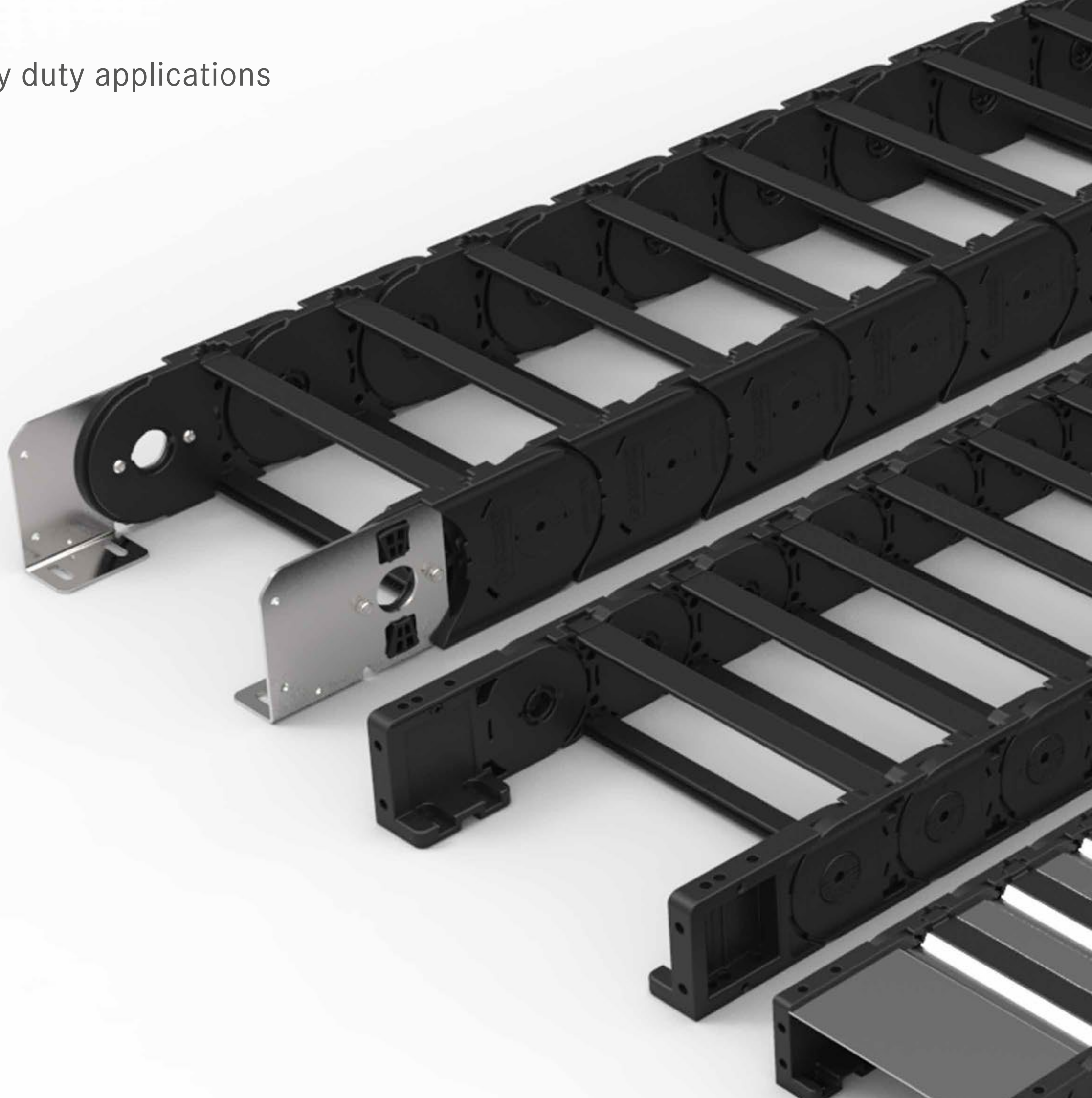

SILVYN® CHAIN H57SC

Nylon Cable Chain with opening frames

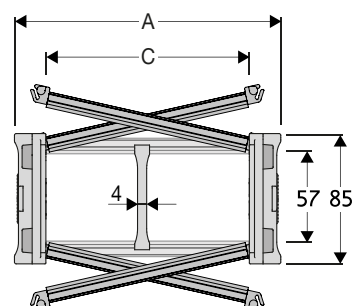

Technical data

- Inner Height (D)**
57 mm
- Pitch (P)**
90 mm
- Height Moving Point (W)**
250 mm
- Speed**
8 m/s
- Acceleration**
40 m/s²

A (mm)	B (mm)	C (mm)	D (mm)	R (mm)	Weight (kg/m)	Article number
113	85	75	57	150-180-200-250-300-350-400	3.03	H57SC075□□□
138	85	100	57	150-180-200-250-300-350-400	3.09	H57SC100□□□
163	85	125	57	150-180-200-250-300-350-400	3.16	H57SC125□□□
188	85	150	57	150-180-200-250-300-350-400	3.22	H57SC150□□□
213	85	175	57	150-180-200-250-300-350-400	3.29	H57SC175□□□
238	85	200	57	150-180-200-250-300-350-400	3.35	H57SC200□□□
263	85	225	57	150-180-200-250-300-350-400	3.42	H57SC225□□□
288	85	250	57	150-180-200-250-300-350-400	3.48	H57SC250□□□
313	85	275	57	150-180-200-250-300-350-400	3.55	H57SC275□□□
338	85	300	57	150-180-200-250-300-350-400	3.61	H57SC300□□□
388	85	350	57	150-180-200-250-300-350-400	3.74	H57SC350□□□
438	85	400	57	150-180-200-250-300-350-400	3.88	H57SC400□□□

□□□ to be filled with Radius R

Separator

Unassembled Article number S57CF3
Assembled Article number S57CF3MCI, S57CF3MCE

MCI: chain opening outer radius
MCE: chain opening inner radius

Strong-hold separator for C > 200 mm

Unassembled Article number S57HOFL
Assembled Article number S57HOFL
Pin Article number PNH57RS

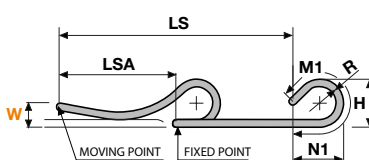
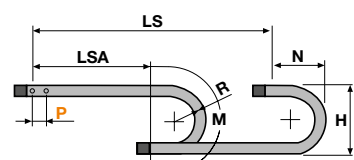

L=LSA + M or M1 Length of chain (L) = Half travel distance LSA plus length of curve (M) or (M1)

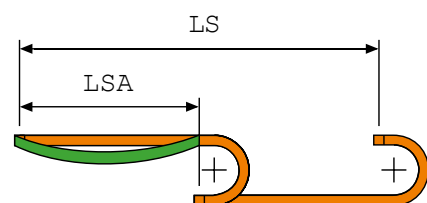

R	H	N	M	N1	M1
150	385	283	655	480	1050
180	445	313	750	620	1385
200	485	333	810	715	1605
250	585	383	970	950	2160
300	685	433	1125	1190	2720
350	785	483	1280	1425	3275
400	885	533	1440	1660	3830

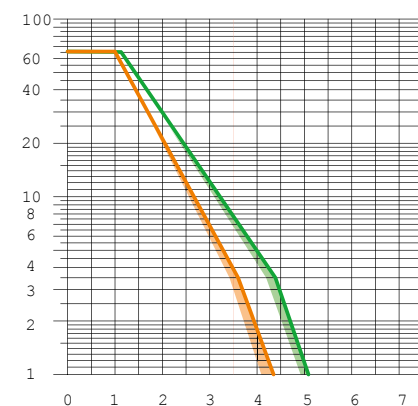

Self-Supporting Capacity Diagram

The maximum length of the self-supporting capacity LSA in relationship to the weight of the cables and hoses contained per metre.

The orange marking/area in the diagram considers the difference of weight between various widths of chain.

For applications with LSA and weights not included in the area of the diagram showing a self-supporting capacity, verify the possible use of support rollers (see page 41).

End brackets

The end brackets set allows the two ends of the chain to be attached to the equipment. Set complete with tiwrap clamps available on request.

Nylon Type

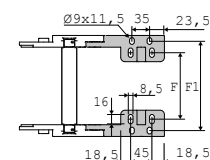
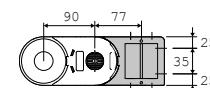
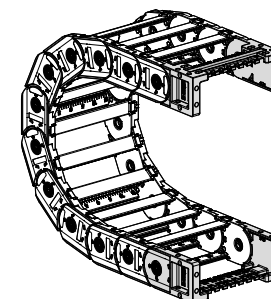

Chain Type	F	F1
H57SC075	51	98
H57SC100	76	123
H57SC125	101	148
H57SC150	126	173
H57SC175	151	198
H57SC200	176	223
H57SC225	201	248
H57SC250	226	273
H57SC275	251	298
H57SC300	276	323
H57SC350	326	373
H57SC400	376	423

Nylon Type Part Numbers

Complete Set Assembled

ANH57KM□

Complete Set Unassembled

ANH57K□

Tiewrap Clamp Part Numbers

Complete Set Assembled

SFCTH57□□□KMA

Complete Set Unassembled

SFCTH57□□□KA

□□□ Inner width (C)

Possible mounting positions: 1/2/3 (acc. to page 33)

SILVYN® CHAIN H57PC / PN

Nylon cable chain with openable aluminium/nylon covers

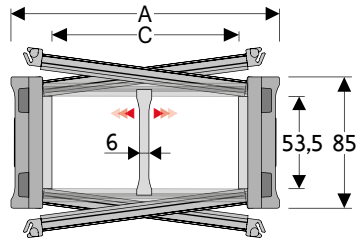

Technical data

- Inner Height (D)**
53,5 mm
- Pitch (P)**
90 mm
- Height Moving Point (W)**
250 mm
- Speed**
8 m/s
- Acceleration**
40 m/s²

Separator H57PC

Unassembled Article number S57UA
Assembled Article number S57UAMCI, S57UAMCE

Separator H57PN

Unassembled Article number S57CF3
Assembled Article number S57CF3MCI, S57CF3MCE

MCI: chain opening outer radius

MCE: chain opening inner radius

Pin Article number PNH57RS

A (mm)	B (mm)	C (mm)	D (mm)	R (mm)	Weight (kg/m)	Article number
SILVYN® CHAIN H57PC (Aluminium)						
113	85	75	53.5	180-200-250-300-350-400	4.23	H57PC075□□□
138	85	100	53.5	180-200-250-300-350-400	4.67	H57PC100□□□
163	85	125	53.5	180-200-250-300-350-400	5.11	H57PC125□□□
188	85	150	53.5	180-200-250-300-350-400	5.56	H57PC150□□□
213	85	175	53.5	180-200-250-300-350-400	6.00	H57PC175□□□
238	85	200	53.5	180-200-250-300-350-400	6.43	H57PC200□□□
263	85	225	53.5	180-200-250-300-350-400	6.88	H57PC225□□□
288	85	250	53.5	180-200-250-300-350-400	7.32	H57PC250□□□
313	85	275	53.5	180-200-250-300-350-400	7.77	H57PC275□□□
338	85	300	53.5	180-200-250-300-350-400	8.21	H57PC300□□□
388	85	350	53.5	180-200-250-300-350-400	9.09	H57PC350□□□
438	85	400	53.5	180-200-250-300-350-400	9.98	H57PC400□□□
SILVYN® CHAIN H57PN (Nylon)						
188	85	150	57	180-200-250-300-350-400	4.45	H57PN150□□□
238	85	200	57	180-200-250-300-350-400	4.92	H57PN200□□□
288	85	250	57	180-200-250-300-350-400	5.45	H57PN250□□□

□□□ to be filled with Radius R

R	H	N	M	N1	M1
150	385	283	655	480	1050
180	445	313	750	620	1385
200	485	333	810	715	1605
250	585	383	970	950	2160
300	685	433	1125	1190	2720
350	785	483	1280	1425	3275
400	885	533	1440	1660	3830

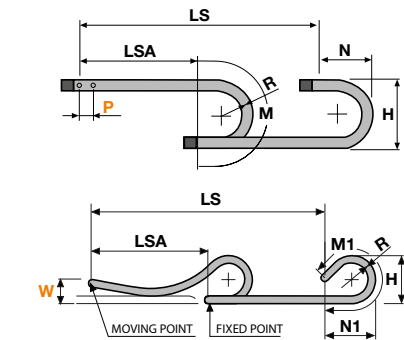

L=LSA + M or M1 Length of chain (L) = Half travel distance LSA plus length of curve (M) or (M1)

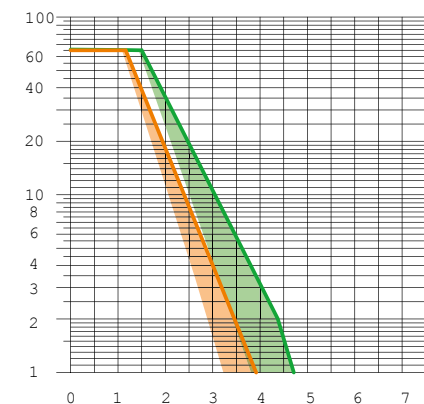
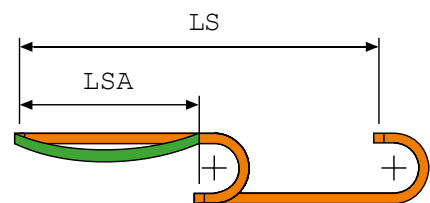

Self-Supporting Capacity Diagram
The maximum length of the self-supporting capacity LSA in relationship to the weight of the cables and hoses contained per metre.

The orange marking/area in the diagram considers the difference of weight between various widths of chain.

For applications with LSA and weights not included in the area of the diagram showing a self-supporting capacity, verify the possible use of support rollers (see page 41).

End brackets

The end brackets set allows the two ends of the chain to be attached to the equipment. Set complete with tiewrap clamps available on request.

Nylon Type

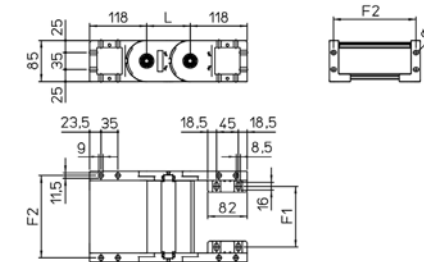
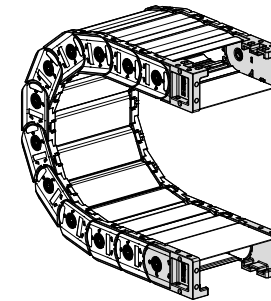

Chain Type	F	F1
H57PC075	51	98
H57PC100	76	123
H57PC125	101	148
H57PC150	126	173
H57PC175	151	198
H57PC200	176	223
H57PC225	201	248
H57PC250	226	273
H57PC275	251	298
H57PC300	276	323
H57PC350	326	373
H57PC400	376	423

Nylon Type Part Numbers

Complete Set Assembled

ANH57P□□□KMQ

Complete Set Unassembled

ANH57P□□□K□

Tiewrap Clamp Part Numbers

Complete Set Assembled

SFCTH57□□□KMA

Complete Set Unassembled

SFCTH57□□□KA

□□□ Inner width (C)

Possible mounting positions: 1/2/3 (acc. to page 33)

SILVYN® CHAIN H57B

Nylon Cable Chain with opening frames

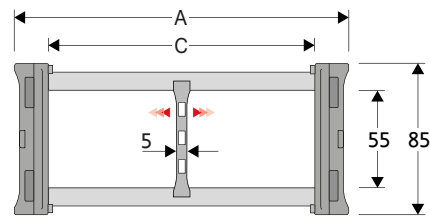

Technical data

- Inner Height (D)**
55 mm
- Pitch (P)**
90 mm
- Height Moving Point (W)**
250 mm
- Speed**
8 m/s
- Acceleration**
40 m/s²

- Separator**
- Unassembled Article number S57BF
 - Assembled Article number S57BFMC
 - MCI: chain opening outer radius
 - MCE: chain opening inner radius
 - Pin** Article number PNH57RS

A (mm)	B (mm)	C (mm)	D (mm)	R (mm)	Weight (kg/m)	Article number
113	85	75	55	150-180-200-250-300-350-400	3.03	H57B075□□□
138	85	100	55	150-180-200-250-300-350-400	3.09	H57B100□□□
163	85	125	55	150-180-200-250-300-350-400	3.16	H57B125□□□
188	85	150	55	150-180-200-250-300-350-400	3.22	H57B150□□□
213	85	175	55	150-180-200-250-300-350-400	3.29	H57B175□□□
238	85	200	55	150-180-200-250-300-350-400	3.35	H57B200□□□
263	85	225	55	150-180-200-250-300-350-400	3.42	H57B225□□□
288	85	250	55	150-180-200-250-300-350-400	3.48	H57B250□□□
313	85	275	55	150-180-200-250-300-350-400	3.55	H57B275□□□
338	85	300	55	150-180-200-250-300-350-400	3.61	H57B300□□□
388	85	350	55	150-180-200-250-300-350-400	3.74	H57B350□□□
438	85	400	55	150-180-200-250-300-350-400	3.88	H57B400□□□

□□□ to be filled with Radius R

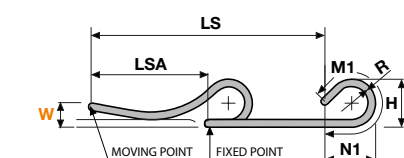
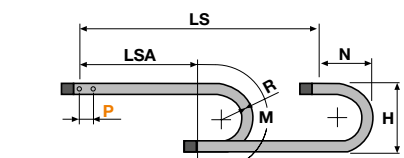

L=LSA + M or M1 Length of chain (L) = Half travel distance LSA plus length of curve (M) or (M1)

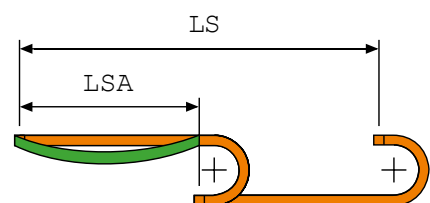

R	H	N	M	N1	M1
150	385	283	655	480	1050
180	445	313	750	620	1385
200	485	333	810	715	1605
250	585	383	970	950	2160
300	685	433	1125	1190	2720
350	785	483	1280	1425	3275
400	885	533	1440	1660	3830

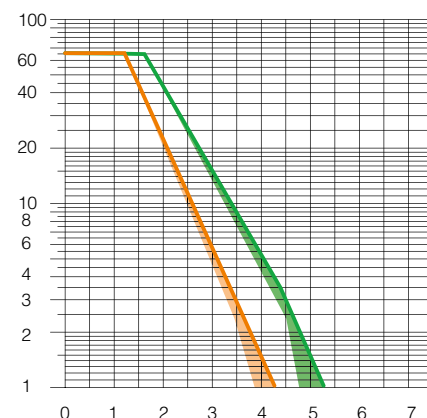

Self-Supporting Capacity Diagram
The maximum length of the self-supporting capacity LSA in relationship to the weight of the cables and hoses contained per metre.

The orange marking/area in the diagram considers the difference of weight between various widths of chain.

For applications with LSA and weights not included in the area of the diagram showing a self-supporting capacity, verify the possible use of support rollers (see page 41).

End brackets

The end brackets set allows the two ends of the chain to be attached to the equipment. Set complete with tiwrap clamps available on request.

Nylon Type

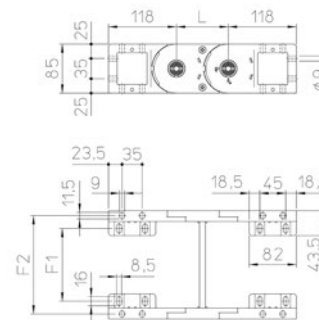
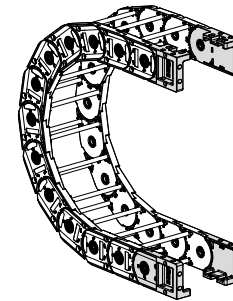

Chain Type	F	F1
H57B075	51	98
H57B100	76	123
H57B125	101	148
H57B150	126	173
H57B175	151	198
H57B200	176	223
H57B225	201	248
H57B250	226	273
H57B275	251	298
H57B300	276	323
H57B350	326	373
H57B400	376	423

- Nylon Type Part Numbers**
- Complete Set Assembled ANH57KM□
 - Complete Set Unassembled ANH57K□
- Tiewrap Clamp Part Numbers**
- Complete Set Assembled SFCTH57□□□KMA
 - Complete Set Unassembled SFCTH57□□□KA

□□□ Inner width (C)

SILVYN® CHAIN H57T

Nylon cable chain with un-screwable aluminium rods.

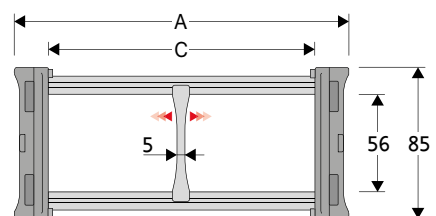

Technical data	
	Inner Height (D) 56 mm
	Pitch (P) 90 mm
	Height Moving Point (W) 250 mm
	Speed 8 m/s
	Acceleration 40 m/s ²

Separator	
Unassembled	Article number S57TF
Assembled	Article number S57TFMC
MCI: chain opening outer radius	
MCE: chain opening inner radius	
Pin	Article number PNH57RS

A (mm)	B (mm)	C (mm)	D (mm)	R (mm)	Weight (kg/m)	Article number
113	85	75	56	150-180-200-250-300-350-400	3.03	H57T075□□□
138	85	100	56	150-180-200-250-300-350-400	3.09	H57T100□□□
163	85	125	56	150-180-200-250-300-350-400	3.16	H57T125□□□
188	85	150	56	150-180-200-250-300-350-400	3.22	H57T150□□□
213	85	175	56	150-180-200-250-300-350-400	3.29	H57T175□□□
238	85	200	56	150-180-200-250-300-350-400	3.35	H57T200□□□
263	85	225	56	150-180-200-250-300-350-400	3.42	H57T225□□□
288	85	250	56	150-180-200-250-300-350-400	3.48	H57T250□□□
313	85	275	56	150-180-200-250-300-350-400	3.55	H57T275□□□
338	85	300	56	150-180-200-250-300-350-400	3.61	H57T300□□□
388	85	350	56	150-180-200-250-300-350-400	3.74	H57T350□□□
438	85	400	56	150-180-200-250-300-350-400	3.88	H57T400□□□

□□□ to be filled with Radius R

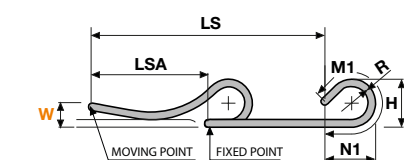
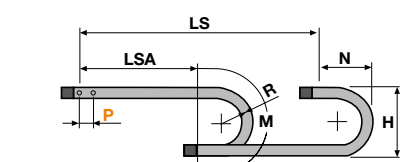

L=LSA + M or M1 Length of chain (L) = Half travel distance LSA plus length of curve (M) or (M1)

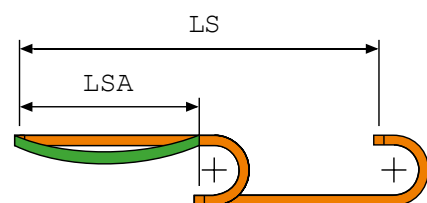

R	H	N	M	N1	M1
150	385	283	655	480	1050
180	445	313	750	620	1385
200	485	333	810	715	1605
250	585	383	970	950	2160
300	685	433	1125	1190	2720
350	785	483	1280	1425	3275
400	885	533	1440	1660	3830

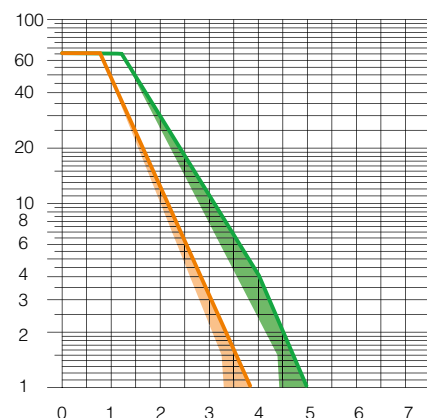

Self-Supporting Capacity Diagram

The maximum length of the self-supporting capacity LSA in relationship to the weight of the cables and hoses contained per metre.

The orange marking/area in the diagram considers the difference of weight between various widths of chain.

For applications with LSA and weights not included in the area of the diagram showing a self-supporting capacity, verify the possible use of support rollers (see page 41).

End brackets

The end brackets set allows the two ends of the chain to be attached to the equipment. Set complete with tiwrap clamps available on request.

Nylon Type

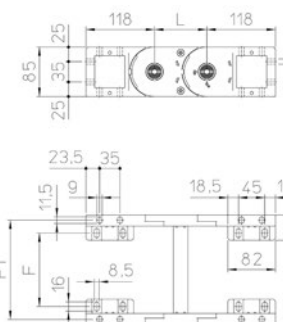
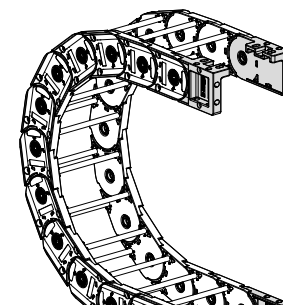

Chain type	F	F1
H57T075	51	98
H57T100	76	123
H57T125	101	148
H57T150	126	173
H57T175	151	198
H57T200	176	223
H57T225	201	248
H57T250	226	273
H57T275	251	298
H57T300	276	323
H57T350	326	373
H57T400	376	423

Nylon Type Part Numbers	
Complete Set Assembled	
ANH57KM□	
Complete Set Unassembled	
ANH57K□	
Tiwrap Clamp Part Numbers	
Complete Set Assembled	
SFCTH57□□□KMA	
Complete Set Unassembled	
SFCTH57□□□KA	

□□□ Inner width (C)

SILVYN® CHAIN H80SC / SA

Nylon Cable Chain with opening frames

Info

- Sideband construction with quickly removable pin. Covers openable from either side on both inner and outer radius.

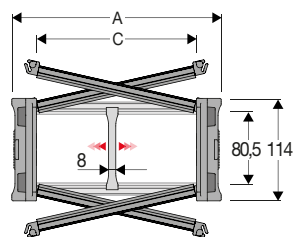

Technical data	
	Inner Height (D) 80,5 mm
	Pitch (P) 120 mm
	Height Moving Point (W) 300 mm
	Speed 8 m/s
	Acceleration 40 m/s ²

Separator H80SC	
Unassembled	Article number SH80SCF6
Assembled	Article number SH80SCF6MCI, SH80SCF6MCE
Separator H80SA	
Unassembled	Article number S80
Assembled	Article number S80MCI, S80MCE
MCI: chain opening outer radius MCE: chain opening inner radius	
Strong-hold separator for C > 200 mm H80SC	
Unassembled	Article number SH80HOF6L
Assembled	Article number SH80HOF6LMC
Strong-hold separator for C > 200 mm H80SA	
Unassembled	Article number S80HOF1
Assembled	Article number S80HOF1MC
Pin	Article number PNH80RS

A (mm)	B (mm)	C (mm)	D (mm)	R (mm)	Weight kg/m	Article number
SILVYN® CHAIN H80SC						
205	114	150	80,5	200-250-300-350-400-500-600	6,70	H80SC150□□
225	114	175	80,5	200-250-300-350-400-500-600	6,87	H80SC175□□
255	114	200	80,5	200-250-300-350-400-500-600	7,04	H80SC200□□
280	114	225	80,5	200-250-300-350-400-500-600	7,20	H80SC225□□
305	114	250	80,5	200-250-300-350-400-500-600	7,37	H80SC250□□
330	114	275	80,5	200-250-300-350-400-500-600	7,52	H80SC275□□
355	114	300	80,5	200-250-300-350-400-500-600	7,66	H80SC300□□
380	114	325	80,5	200-250-300-350-400-500-600	7,86	H80SC325□□
405	114	350	80,5	200-250-300-350-400-500-600	8,05	H80SC350□□
430	114	375	80,5	200-250-300-350-400-500-600	8,23	H80SC375□□
SILVYN® CHAIN H80SA						
129	114	74	80,5	200-250-300-350-400-500-600	5,99	H80SA074□□
149	114	94	80,5	200-250-300-350-400-500-600	6,10	H80SA094□□
174	114	119	80,5	200-250-300-350-400-500-600	6,22	H80SA119□□
181	114	126	80,5	200-250-300-350-400-500-600	6,23	H80SA126□□
484	114	429	80,5	200-250-300-350-400-500-600	8,22	H80SA429□□
553	114	498	80,5	200-250-300-350-400-500-600	8,77	H80SA498□□

□□ to be filled with Radius R

R	H	N	M	N1	M1
200	514	377	870	810	1775
250	614	427	1030	1050	2330
300	714	477	1185	1285	2885
350	814	527	1340	1525	3445
400	914	577	1340	1525	3445
500	1114	677	1815	2235	5115
600	1314	777	2125	2705	6225

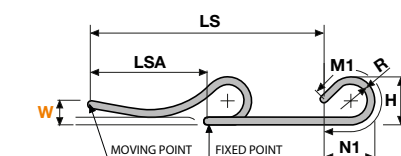
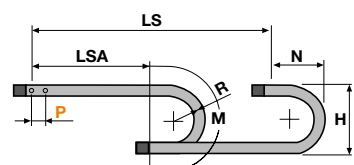

L=LSA + M or M1 Length of chain (L)= Half travel distance LSA plus length of curve (M) or (M1)

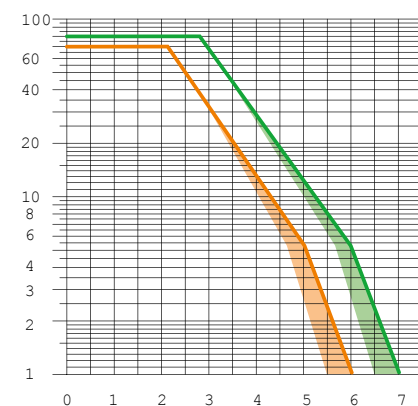
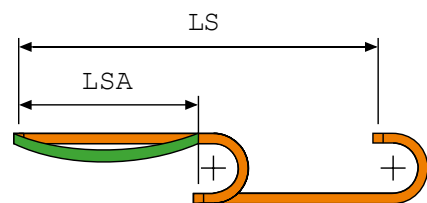

Self-Supporting Capacity Diagram
The maximum length of the self-supporting capacity LSA in relationship to the weight of the cables and hoses contained per metre.

The orange marking/area in the diagram considers the difference of weight between various widths of chain.

For applications with LSA and weights not included in the area of the diagram showing a self-supporting capacity, verify the possible use of support rollers (see page 41).

End brackets

The end brackets set allows the two ends of the chain to be attached to the equipment. Set complete with tiewrap clamps available on request.

Nylon Type

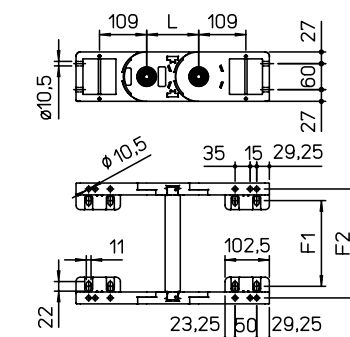
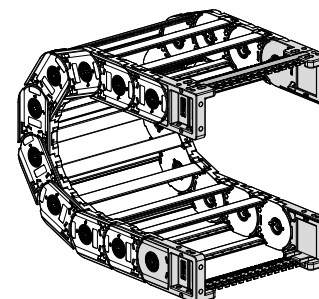

Chain type	F	F1
H80SC150	124	177,5
H80SC175	149	202,5
H80SC200	174	227,5
H80SC225	199	252,5
H80SC250	224	277,5
H80SC275	249	302,5
H80SC300	274	327,5
H80SC325	299	352,5
H80SC350	324	377,5
H80SC375	349	402,5

Chain type	F	F1
H80SA074	101,5	48
H80SA094	121,5	68
H80SA119	146,5	93
H80SA126	153,5	100
H80SA429	456,5	403
H80SA498	525,5	472

Nylon Type Part Numbers	
Complete Set Assembled	
ANH80KM□	
Complete Set Unassembled	
ANH80K□	
Tiewrap Clamp Part Numbers	
Complete Set Assembled	
SFCTH80□□KMA	
Complete Set Unassembled	
SFCTH80□□KA	

□□ Inner width (C)
Possible mounting positions: 1/2/3 (acc. to page 33)

SILVYN® CHAIN H80PC / PA

Nylon Protection cable chain with openable aluminium covers.

Info

- Sideband construction with quickly removable pin. Covers openable from either side on both inner and outer radius.

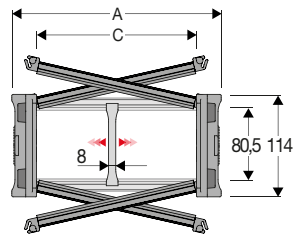

Technical data

- Inner Height (D)**
77 mm
- Pitch (P)**
120 mm
- Height Moving Point (W)**
300 mm
- Speed**
8 m/s
- Acceleration**
40 m/s²

Separator H80PC

Unassembled Article number SH80SFC6
Assembled Article number SH80SCF6MCI, SH80SCF6MCE

Separator H80PA

Unassembled Article number S80F
Assembled Article number S80FMCI, S80FMCE

MCI: chain opening outer radius

MCE: chain opening inner radius

Pin Article number PNH80RS

A (mm)	B (mm)	C (mm)	D (mm)	R (mm)	Weight (kg/m)	Article number
SILVYN® CHAIN H80PC						
205	114	150	80,5	200-250-300-350-400-500-600	8,51	H80PC150□□□
225	114	175	80,5	200-250-300-350-400-500-600	8,98	H80PC175□□□
255	114	200	80,5	200-250-300-350-400-500-600	9,44	H80PC200□□□
280	114	225	80,5	200-250-300-350-400-500-600	9,91	H80PC225□□□
305	114	250	80,5	200-250-300-350-400-500-600	10,38	H80PC250□□□
330	114	275	80,5	200-250-300-350-400-500-600	10,83	H80PC275□□□
355	114	300	80,5	200-250-300-350-400-500-600	11,27	H80PC300□□□
380	114	325	80,5	200-250-300-350-400-500-600	11,77	H80PC325□□□
405	114	350	80,5	200-250-300-350-400-500-600	12,26	H80PC350□□□
430	114	375	80,5	200-250-300-350-400-500-600	12,74	H80PC375□□□
SILVYN® CHAIN H80PA						
129	114	74	80,5	200-250-300-350-400-500-600	6,78	H80PA074□□□
149	114	94	80,5	200-250-300-350-400-500-600	7,18	H80PA094□□□
174	114	119	80,5	200-250-300-350-400-500-600	7,61	H80PA119□□□
181	114	126	80,5	200-250-300-350-400-500-600	7,74	H80PA126□□□
484	114	429	80,5	200-250-300-350-400-500-600	13,1	H80PA429□□□
553	114	498	80,5	200-250-300-350-400-500-600	14,3	H80PA498□□□

□□□ to be filled with Radius R

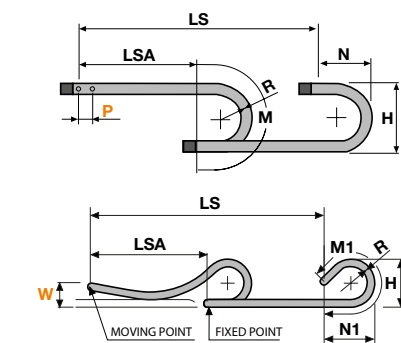

L=LSA + M or M1 Length of chain (L)= Half travel distance LSA plus length of curve (M) or (M1)

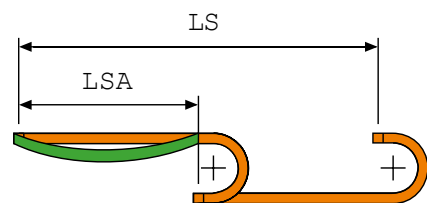

R	H	N	M	N1	M1
200	514	377	870	810	1775
250	614	427	1030	1050	2330
300	714	477	1185	1285	2885
350	814	527	1340	1525	3445
400	914	577	1500	1760	4000
500	1114	677	1815	2235	5115
600	1314	777	2125	2705	6225

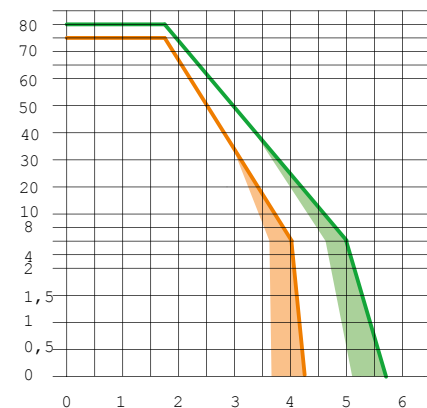

Self-Supporting Capacity Diagram
The maximum length of the self-supporting capacity LSA in relationship to the weight of the cables and hoses contained per metre.

The orange marking/area in the diagram considers the difference of weight between various widths of chain.

For applications with LSA and weights not included in the area of the diagram showing a self-supporting capacity, verify the possible use of support rollers (see page 41).

End brackets

The end brackets set allows the two ends of the chain to be attached to the equipment. Set complete with tiwrap clamps available on request.

Nylon Type

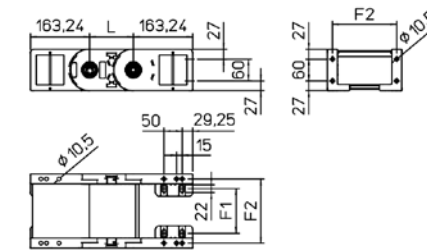
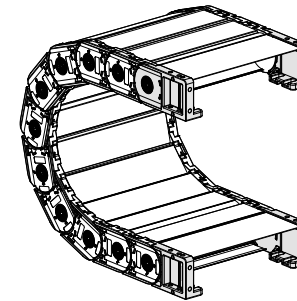

Chain Type	F1	F1
H80PC150	124	177,5
H80PC175	149	202,5
H80PC200	174	227,5
H80PC225	199	252,5
H80PC250	224	277,5
H80PC275	249	302,5
H80PC300	274	327,5
H80PC325	299	352,5
H80PC350	324	377,5
H80PC375	349	402,5

- Nylon Type Part Numbers**
- Complete Set Assembled
ANH80P□□□KMQ
 - Complete Set Unassembled
ANH80P□□□K□
- Tiewrap Clamp Part Numbers**
- Complete Set Assembled
SFCTH80□□□KMA
 - Complete Set Unassembled
SFCTH80□□□KA

□□□ Inner width (C)
Possible mounting positions: 1/2/3 (acc. to page 33)

SILVYN® CHAIN H80B

Nylon Cable Chain with opening frames

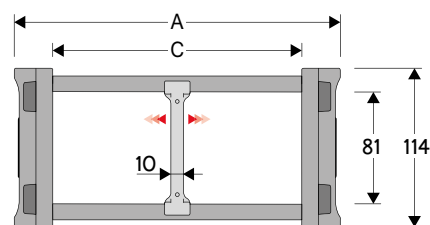

Technical data

- Inner Height (D)**
81 mm
- Pitch (P)**
120 mm
- Height Moving Point (W)**
300 mm
- Speed**
8 m/s
- Acceleration**
40 m/s²

A (mm)	B (mm)	C (mm)	D (mm)	R (mm)	Weight (kg/m)	Article number
205	114	150	81	200-250-300-350-400-500-600	6,70	H80B150□□
225	114	175	81	200-250-300-350-400-500-600	6,87	H80B175□□
255	114	200	81	200-250-300-350-400-500-600	7,04	H80B200□□
280	114	225	81	200-250-300-350-400-500-600	7,20	H80B225□□
305	114	250	81	200-250-300-350-400-500-600	7,37	H80B250□□
330	114	275	81	200-250-300-350-400-500-600	7,52	H80B275□□
355	114	300	81	200-250-300-350-400-500-600	7,66	H80B300□□
380	114	325	81	200-250-300-350-400-500-600	7,86	H80B325□□
405	114	350	81	200-250-300-350-400-500-600	8,05	H80B350□□
430	114	375	81	200-250-300-350-400-500-600	8,23	H80B375□□

□□ to be filled with Radius R

Separator

- Unassembled Article number SH80F
- Assembled Article number SH80FMC
- MCI: chain opening outer radius
- MCE: chain opening inner radius
- Pin Article number PNH80RS

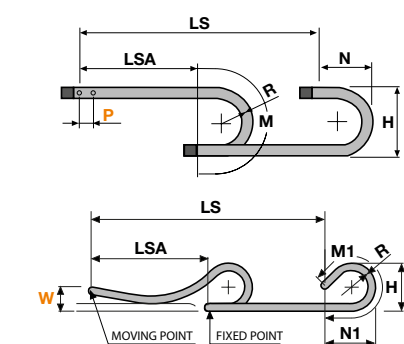

L=LSA + M or M1 Length of chain (L) = Half travel distance LSA plus length of curve (M) or (M1)

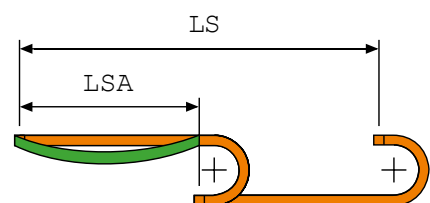

R	H	N	M	N1	M1
200	514	377	870	810	1775
250	614	427	1030	1050	2330
300	714	477	1185	1285	2885
350	814	527	1340	1525	3445
400	914	577	1340	1525	3445
500	1114	677	1815	2235	5115
600	1314	777	2125	2705	6225

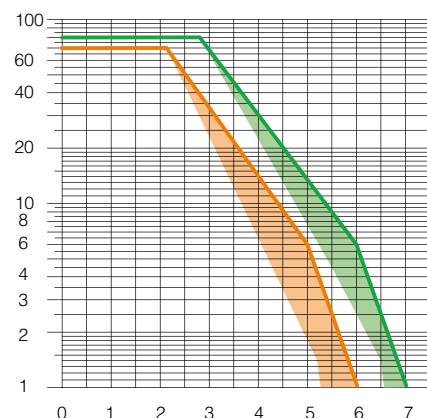

Self-Supporting Capacity Diagram

The maximum length of the self-supporting capacity LSA in relationship to the weight of the cables and hoses contained per metre.

The orange marking/area in the diagram considers the difference of weight between various widths of chain.

For applications with LSA and weights not included in the area of the diagram showing a self-supporting capacity, verify the possible use of support rollers (see page 41).

End brackets

The end brackets set allows the two ends of the chain to be attached to the equipment. Set complete with tiwrap clamps available on request.

Nylon Type

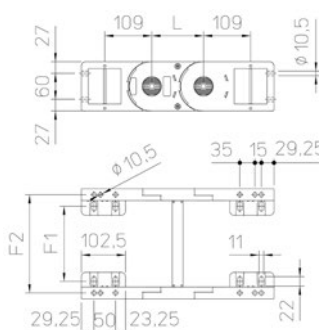
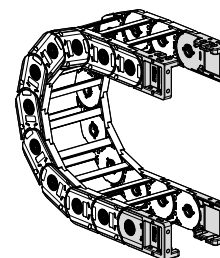

Chain type	F1	F1
H80B150	124	177,5
H80B175	149	202,5
H80B200	174	227,5
H80B225	199	252,5
H80B250	224	277,5
H80B275	249	302,5
H80B300	274	327,5
H80B325	299	352,5
H80B350	324	377,5
H80B375	349	402,5

Nylon Type Part Numbers

Complete Set Assembled

ANH80KM□

Complete Set Unassembled

ANH80K□

Tiewrap Clamp Part Numbers

Complete Set Assembled

SFCTH80□□KMA

Complete Set Unassembled

SFCTH80□□KA

□□ Inner width (C)

SILVYN® CHAIN H80T

Nylon cable chain with un-screwable aluminium rods.

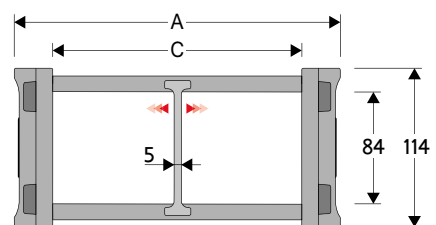

Technical data

- Inner Height (D)**
84 mm
- Pitch (P)**
120 mm
- Height Moving Point (W)**
300 mm
- Speed**
8 m/s
- Acceleration**
40 m/s²

A (mm)	B (mm)	C (mm)	D (mm)	R (mm)	Weight (kg/m)	Article number
155	114	100	84	200-250-300-350-400-500-600	6.17	H80T100□□
205	114	150	84	200-250-300-350-400-500-600	6.52	H80T150□□
255	114	200	84	200-250-300-350-400-500-600	6.87	H80T200□□
305	114	250	84	200-250-300-350-400-500-600	7.22	H80T250□□
355	114	300	84	200-250-300-350-400-500-600	7.57	H80T300□□
405	114	350	84	200-250-300-350-400-500-600	7.92	H80T350□□
455	114	400	84	200-250-300-350-400-500-600	8.28	H80T400□□
505	114	450	84	200-250-300-350-400-500-600	8.63	H80T450□□
555	114	500	84	200-250-300-350-400-500-600	8.98	H80T500□□

□□ to be filled with Radius R

Separator

- Unassembled Article number SH80TF
- Assembled Article number SH80TFMC
- MCI: chain opening outer radius
- MCE: chain opening inner radius
- Pin Article number PNH80RS

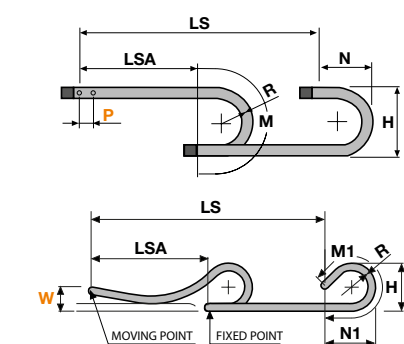

L=LSA + M or M1 Length of chain (L) = Half travel distance LSA plus length of curve (M) or (M1)

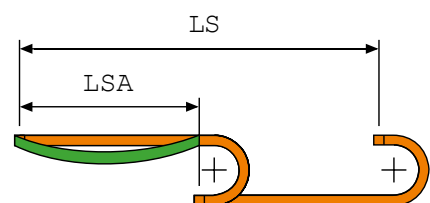

R	H	N	M	N1	M1
200	514	377	870	810	1775
250	614	427	1030	1050	2330
300	714	477	1185	1285	2885
350	814	527	1340	1525	3445
400	914	577	1340	1525	3445
500	1114	677	1815	2235	5115
600	1314	777	2125	2705	6225

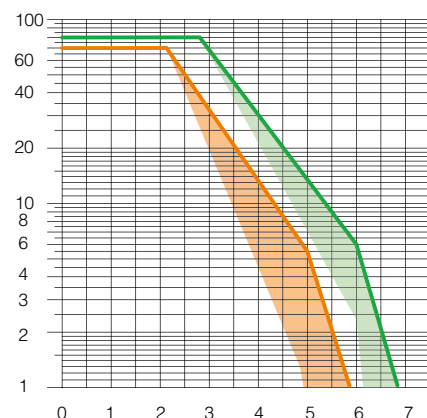

Self-Supporting Capacity Diagram

The maximum length of the self-supporting capacity LSA in relationship to the weight of the cables and hoses contained per metre.

The orange marking/area in the diagram considers the difference of weight between various widths of chain.

For applications with LSA and weights not included in the area of the diagram showing a self-supporting capacity, verify the possible use of support rollers (see page 41).

End brackets

The end brackets set allows the two ends of the chain to be attached to the equipment. Set complete with tiewrap clamps available on request.

Nylon Type

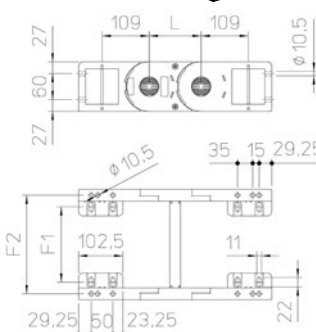
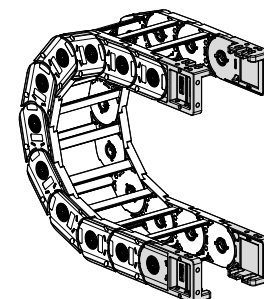

Chain type	F1	F1
H80T150	124	177,5
H80T175	149	202,5
H80T200	174	227,5
H80T225	199	252,5
H80T250	224	277,5
H80T275	249	302,5
H80T300	274	327,5
H80T325	299	352,5
H80T350	324	377,5
H80T375	349	402,5

Nylon Type Part Numbers

Complete Set Assembled

ANH80KM□

Complete Set Unassembled

ANH80K□

Tiewrap Clamp Part Numbers

Complete Set Assembled

SFCTH80□□KMA

Complete Set Unassembled

SFCTH80□□KA

□□ Inner width (C)

SILVYN® CHAIN H110SC / SA

Nylon Cable Chain with opening frames

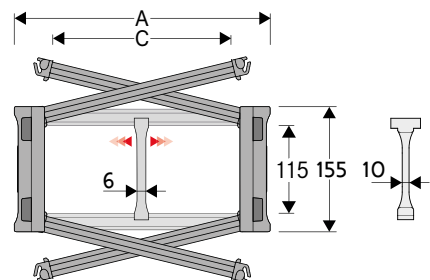

Technical data

- Inner Height (D)**
115 mm
- Pitch (P)**
160 mm
- Height Moving Point (W)**
350 mm
- Speed**
8 m/s
- Acceleration**
40 m/s²

A (mm)	B (mm)	C (mm)	D (mm)	R (mm)	Weight kg/m	Article number
SILVYN® CHAIN H110SC						
205	155	150	115	200-250-300-400-500-600-700-750	8,66	110SC150□□
230	155	175	115	200-250-300-400-500-600-700-750	8,79	110SC175□□
255	155	200	115	200-250-300-400-500-600-700-750	8,91	110SC200□□
280	155	225	115	200-250-300-400-500-600-700-750	9,03	110SC225□□
305	155	250	115	200-250-300-400-500-600-700-750	9,16	110SC250□□
330	155	275	115	200-250-300-400-500-600-700-750	9,27	110SC275□□
355	155	300	115	200-250-300-400-500-600-700-750	9,38	110SC300□□
380	155	325	115	200-250-300-400-500-600-700-750	9,53	110SC325□□
405	155	350	115	200-250-300-400-500-600-700-750	9,70	110SC350□□
430	155	375	115	200-250-300-400-500-600-700-750	9,80	110SC375□□
SILVYN® CHAIN H110SA						
484	155	429	115	200-250-300-400-500-600-700-750	9,85	110SA429□□
553	155	498	115	200-250-300-400-500-600-700-750	10,2	110SA498□□

□□ to be filled with Radius R

Separator

Unassembled Article number S110F3
Assembled Article number S110F3MCI, S110F3MCE

MCI: chain opening outer radius
MCE: chain opening inner radius

Strong-hold separator for C > 200 mm

Unassembled Article number S110HOFL
Assembled Article number S110HOFLMC
Pin Article number PNH110RS

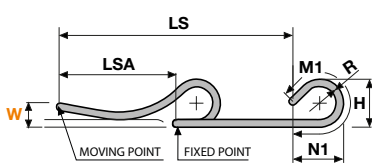
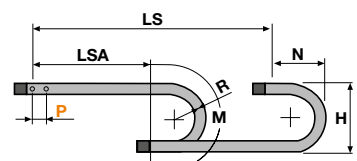

L=LSA + M or M1 Length of chain (L) = Half travel distance LSA plus length of curve (M) or (M1)

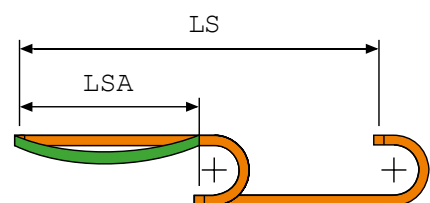

R	H	N	M	N1	M1
200	557	418	950	855	1820
250	657	468	1110	1095	2375
300	757	518	1265	1335	2935
400	957	618	1580	1805	4045
500	1157	718	1895	2280	5160
600	1357	818	2205	2750	6270
700	1557	918	2520	3225	7385
750	1657	968	2680	3460	7940

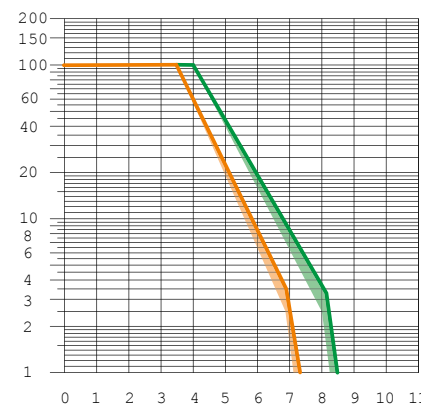

Self-Supporting Capacity Diagram

The maximum length of the self-supporting capacity LSA in relationship to the weight of the cables and hoses contained per metre.

The orange marking/area in the diagram considers the difference of weight between various widths of chain.

For applications with LSA and weights not included in the area of the diagram showing a self-supporting capacity, verify the possible use of support rollers (see page 41).

End brackets

The end brackets set allows the two ends of the chain to be attached to the equipment. Set complete with tiewrap clamps available on request.

Steel Type

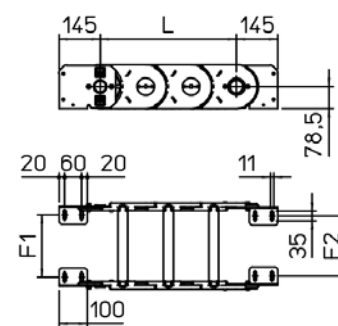
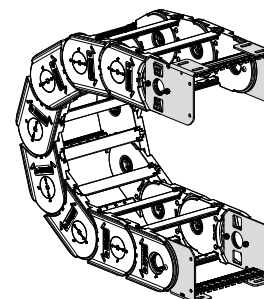

Chain Type	F1	F2
110SC150	120	112
110SC175	145	137
110SC200	170	162
110SC225	195	187
110SC250	220	212
110SC275	245	237
110SC300	270	262
110SC325	295	287
110SC350	320	312
110SC375	344	336
110SA429	399	391
110SA498	468	460

Steel Type Part Numbers

Complete Set Assembled

A110SC□□□KMQ

Complete Set Unassembled

A110SC□□□KMQ

Tiewrap Clamp Part Numbers

Complete Set Assembled

SFCT110□□□KMA

Complete Set Unassembled

SFCT110□□□KMA

□□ Inner width (C)

Possible mounting positions: 1/2/3 (acc. to page 33)

SILVYN® CHAIN H110PC / PA

Nylon Protection cable chain with openable aluminium covers.

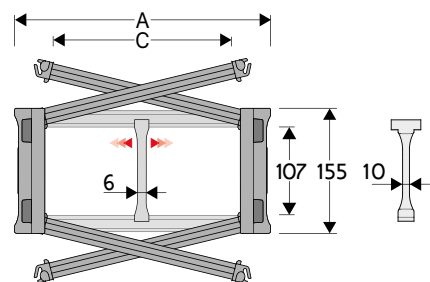

Technical data

- Inner Height (D)**
105 mm
- Pitch (P)**
160 mm
- Height Moving Point (W)**
350 mm
- Speed**
10 m/s
- Acceleration**
50 m/s²

Separator

- Unassembled Article number S110F3
- Assembled Article number S110F3MCI, S110F3MCE
- MCI: chain opening outer radius
- MCE: chain opening inner radius
- Pin Article number PNH110RS

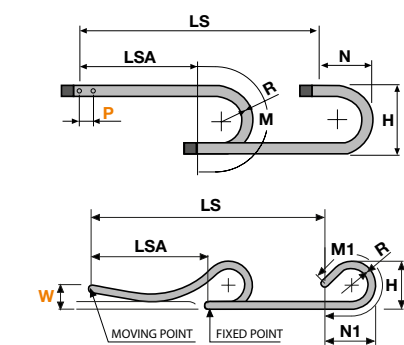

L=LSA + M or M1 Length of chain (L) = Half travel distance LSA plus length of curve (M) or (M1)

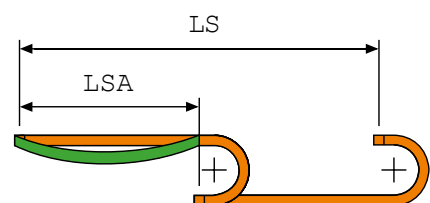

A (mm)	B (mm)	C (mm)	D (mm)	R (mm)	Weight (kg/m)	Article number
SILVYN® CHAIN H110PC						
205	155	150	107	200-250-300-400-500-600-700-750	11,06	110PC150□□□
230	155	175	107	200-250-300-400-500-600-700-750	11,59	110PC175□□□
255	155	200	107	200-250-300-400-500-600-700-750	12,11	110PC200□□□
280	155	225	107	200-250-300-400-500-600-700-750	12,63	110PC225□□□
305	155	250	107	200-250-300-400-500-600-700-750	13,16	110PC250□□□
330	155	275	107	200-250-300-400-500-600-700-750	13,67	110SC275□□□
355	155	300	107	200-250-300-400-500-600-700-750	14,18	110SC300□□□
380	155	325	107	200-250-300-400-500-600-700-750	14,73	110PC325□□□
405	155	350	107	200-250-300-400-500-600-700-750	15,30	110PC350□□□
430	155	375	107	200-250-300-400-500-600-700-750	15,81	110PC375□□□
SILVYN® CHAIN H110PA						
484	155	429	107	200-250-300-400-500-600-700-750	16,90	110PA429□□□
553	155	498	107	200-250-300-400-500-600-700-750	18,27	110PA498□□□

□□□ to be filled with Radius R

R	H	N	M	N1	M1
200	557	418	950	855	1820
250	657	468	1110	1095	2375
300	757	518	1265	1335	2935
400	957	618	1580	1805	4045
500	1157	718	1895	2280	5160
600	1357	818	2205	2750	6270
700	1557	918	2520	3225	7385
750	1657	968	2680	3460	7940

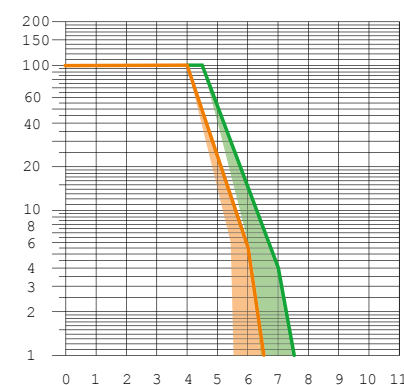

Self-Supporting Capacity Diagram

The maximum length of the self-supporting capacity LSA in relationship to the weight of the cables and hoses contained per metre.

The orange marking/area in the diagram considers the difference of weight between various widths of chain.

For applications with LSA and weights not included in the area of the diagram showing a self-supporting capacity, verify the possible use of support rollers (see page 41).

End brackets

The end brackets set allows the two ends of the chain to be attached to the equipment. Set complete with tiwrap clamps available on request.

Steel Type

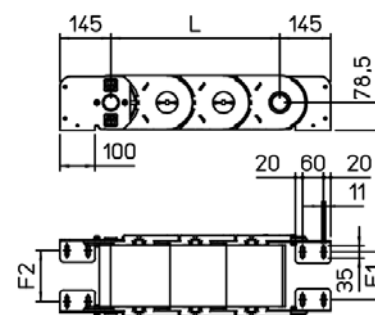
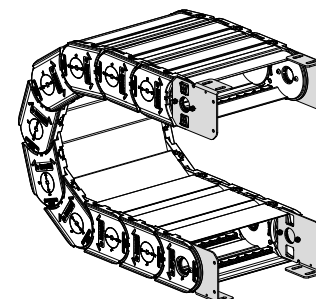

Chain type	F1	F2
110PC150	120	112
110PC175	145	137
110PC200	170	162
110PC225	195	187
110PC250	220	212
110PC275	245	237
110PC300	270	262
110PC325	295	287
110PC350	320	312
110PC375	344	336
110PA429	399	391
110PA498	468	460

Steel Type Part Numbers

Complete Set Assembled

A110PC□□□KMQ

Complete Set Unassembled

A110PC□□□KQ

Tiewrap Clamp Part Numbers

Complete Set Assembled

SFCT110□□□KMA

Complete Set Unassembled

SFCT110□□□KA

□□□ Inner width (C)
Possible mounting positions: 1/2/3 (acc. to page 33)

SILVYN® CHAIN H 110B

Nylon Cable Chain with opening frames

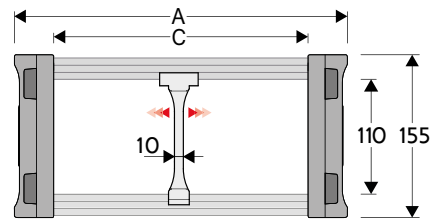

Technical data

- Inner Height (D)**
110 mm
- Pitch (P)**
160 mm
- Height Moving Point (W)**
350 mm
- Speed**
4 m/s
- Acceleration**
20 m/s²

Separator

- Unassembled Article number S310F
- Assembled Article number S310FMC
- MCI: chain opening outer radius
- MCE: chain opening inner radius
- Pin** Article number PNH110RS

A (mm)	B (mm)	C (mm)	D (mm)	R (mm)	Weight (kg/m)	Article number
255	155	200	110	200-250-300-400-500-600-700-750	11.73	H110B200□□□
355	155	300	110	200-250-300-400-500-600-700-750	13.70	H110B300□□□
455	155	400	110	200-250-300-400-500-600-700-750	15.67	H110B400□□□
555	155	500	110	200-250-300-400-500-600-700-750	17.64	H110B500□□□
655	155	600	110	200-250-300-400-500-600-700-750	19.62	H110B600□□□

□□□ to be filled with Radius R

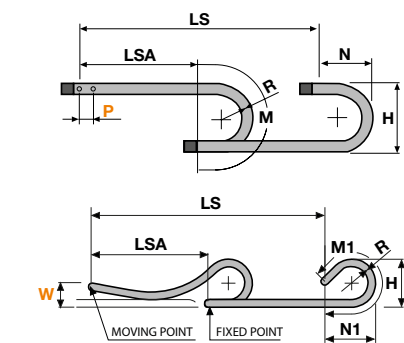

L=LSA + M or M1 Length of chain (L) = Half travel distance LSA plus length of curve (M) or (M1)

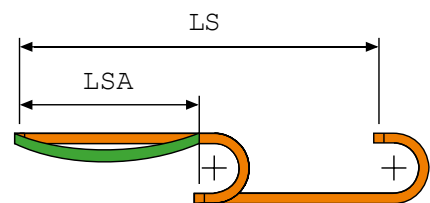

R	H	N	M	N1	M1
200	557	418	950	855	1820
250	657	468	1110	1095	2375
300	757	518	1265	1335	2935
400	957	618	1580	1805	4045
500	1157	718	1895	2280	5160
600	1357	818	2205	2750	6270
700	1557	918	2520	3225	7385
750	1657	968	2680	3460	7940

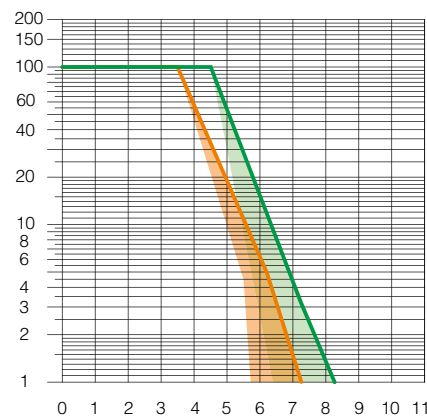

Self-Supporting Capacity Diagram
The maximum length of the self-supporting capacity LSA in relationship to the weight of the cables and hoses contained per metre.

The orange marking/area in the diagram considers the difference of weight between various widths of chain.

For applications with LSA and weights not included in the area of the diagram showing a self-supporting capacity, verify the possible use of support rollers (see page 41).

End brackets

The end brackets set allows the two ends of the chain to be attached to the equipment. Set complete with tiwrap clamps available on request.

Steel Type

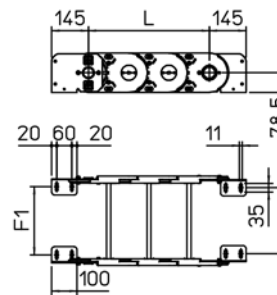
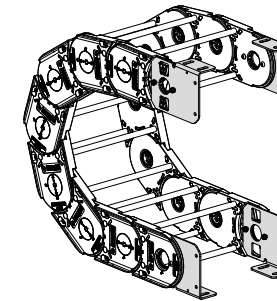

Chain Type	F1	F2
110B200	170	162
110B300	270	262
110B400	370	362
110B500	470	462
110B600	570	562
110B□□□	F=C-30	F=C-38

Steel Type Part Numbers	
Complete Set Assembled	
A110BKM□	
Complete Set Unassembled	
A110BK□	
Tiwrap Clamp Part Numbers	
Complete Set Assembled	
SFCT110□□□KMA	
Complete Set Unassembled	
SFCT110□□□KA	

□□ Inner width (C)
Possible mounting positions: 1/2/3 (acc. to page 33)

SILVYN® CHAIN H 110T

Nylon cable chain with un-screwable aluminium rods.

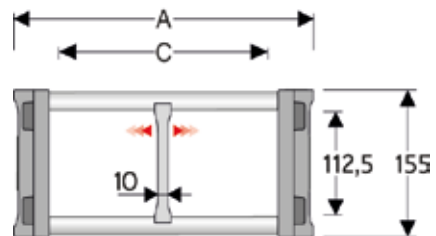

Technical data

- Inner Height (D)**
112,5 mm
- Pitch (P)**
160 mm
- Height Moving Point (W)**
350 mm
- Speed**
4 m/s
- Acceleration**
20 m/s²

A (mm)	B (mm)	C (mm)	D (mm)	R (mm)	Weight (kg/m)	Article number
255	155	200	112.5	200-250-300-400-500-600-700-750	9.93	H110T200□□□
355	155	300	112.5	200-250-300-400-500-600-700-750	10.96	H110T300□□□
455	155	400	112.5	200-250-300-400-500-600-700-750	12.00	H110T400□□□
555	155	500	112.5	200-250-300-400-500-600-700-750	13.04	H110T500□□□
655	155	600	112.5	200-250-300-400-500-600-700-750	14.08	H110T600□□□
C+55	155	...	112.5	200-250-300-400-500-600-700-750	...	H110T□□□□□

□□□ to be filled with Radius R

Separator

- Unassembled Article number S310TCF9
- Assembled Article number S310TCF9MC
- MCI: chain opening outer radius
- MCE: chain opening inner radius
- Pin Article number PNH110RS

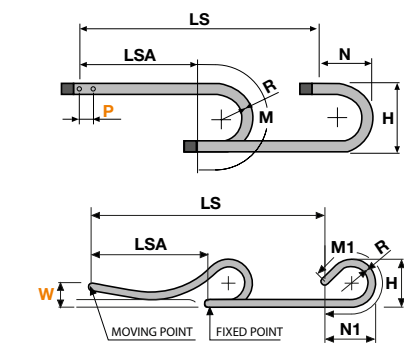

L=LSA + M or M1 Length of chain (L) = Half travel distance LSA plus length of curve (M) or (M1)

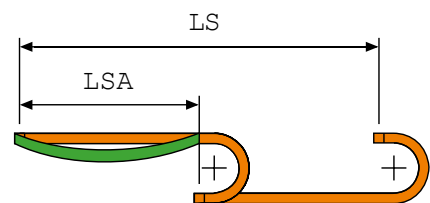

R	H	N	M	N1	M1
200	557	418	950	855	1820
250	657	468	1110	1095	2375
300	757	518	1265	1335	2935
400	957	618	1580	1805	4045
500	1157	718	1895	2280	5160
600	1357	818	2205	2750	6270
700	1557	918	2520	3225	7385
750	1657	968	2680	3460	7940

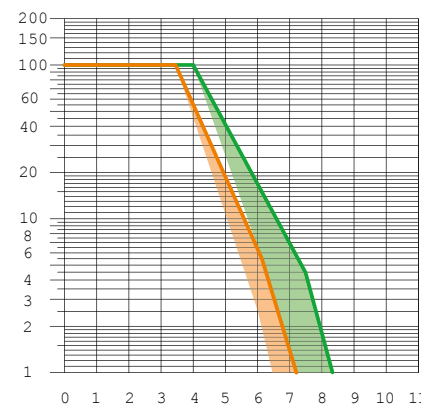

Self-Supporting Capacity Diagram

The maximum length of the self-supporting capacity LSA in relationship to the weight of the cables and hoses contained per metre.

The orange marking/area in the diagram considers the difference of weight between various widths of chain.

For applications with LSA and weights not included in the area of the diagram showing a self-supporting capacity, verify the possible use of support rollers (see page 41).

End brackets

The end brackets set allows the two ends of the chain to be attached to the equipment. Set complete with tiewrap clamps available on request.

Steel Type

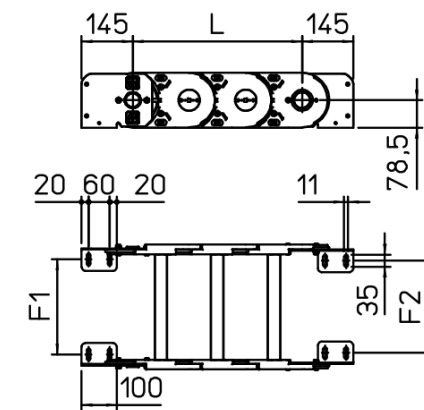
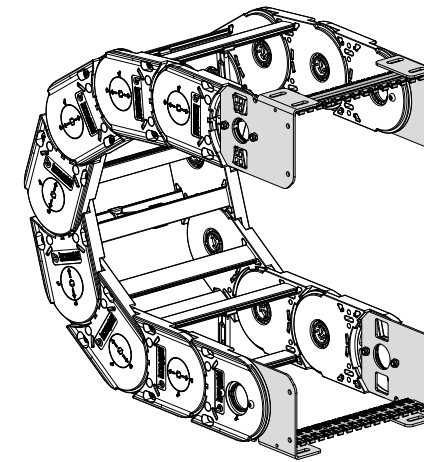

Chain Type	F1	F2
110T200	170	162
110T300	270	262
110T400	370	362
110T500	470	462
110T600	570	562
110T□□□	F=C-30	F=C-38

Steel Type Part Numbers

- Complete Set Assembled AH110TKM
- Complete Set Unassembled AH110TK□

Tiewrap Clamp Part Numbers

- Complete Set Assembled SFCT110□□□KMA
- Complete Set Unassembled SFCT110□□□KA

□□□ Inner width (C)
Possible mounting positions: 1/2/3 (acc. to page 33)

Guide Channel for 250L

Special channel guide allows the use of the chain for long travel distance. Available in galvanised steel and, on request, in stainless steel.

Single Chain Application

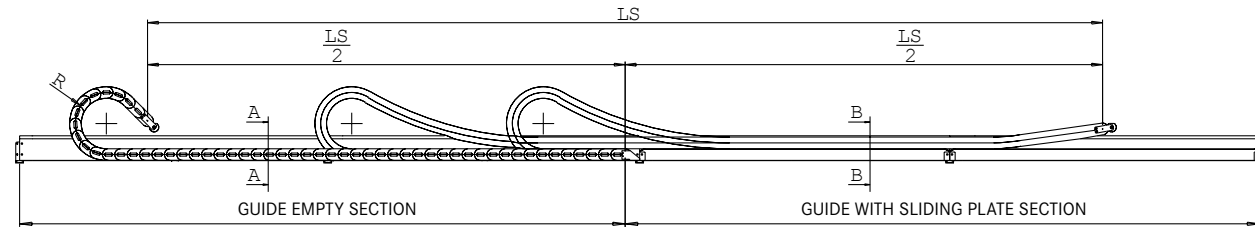

Double Chain Application

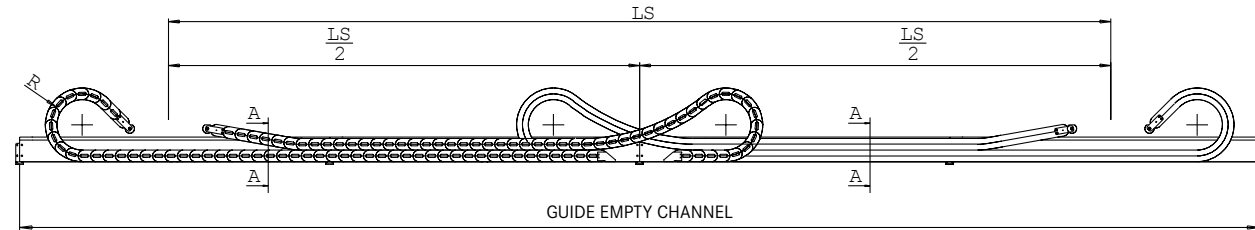

Channel guide is available in kit form composed of:
 side walls 2 m standard length
 joining plates
 fixing screws

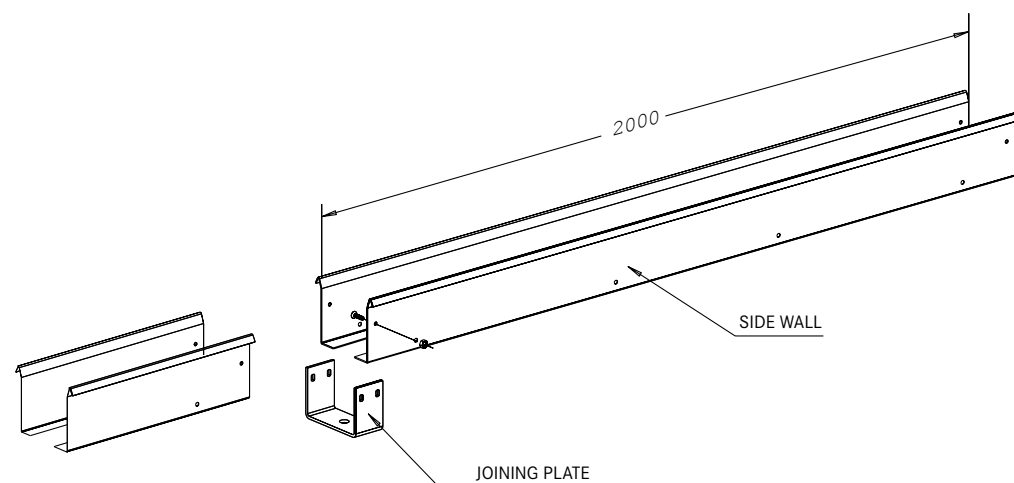

Guide Empty Section

Section A-A

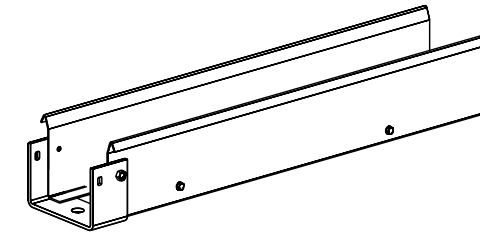
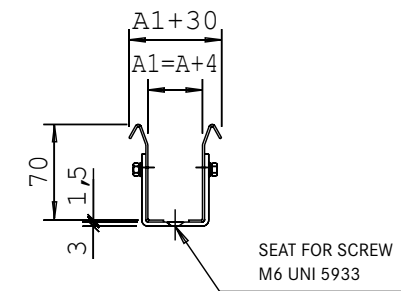

Part Number CS...

How to order

Chain part number	250L035060
Guide channel part number	CS250L035

Guide Sliding Plate Section

Section B-B

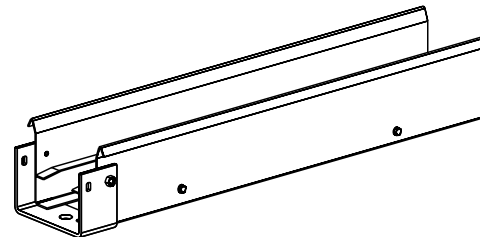
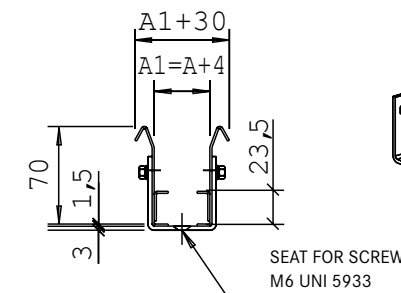

Part Number CA...

How to order

Chain part number	250L035060
Guide channel part number	CA250L035

Guide Channel for 325 - 335

Special channel guide allows the use of the chain for long travel distance. Available in galvanised steel and, on request, in stainless steel.

Single Chain Application

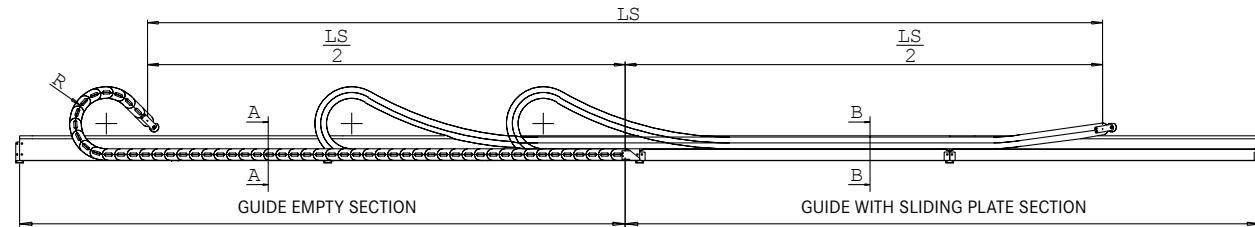

Double Chain Application

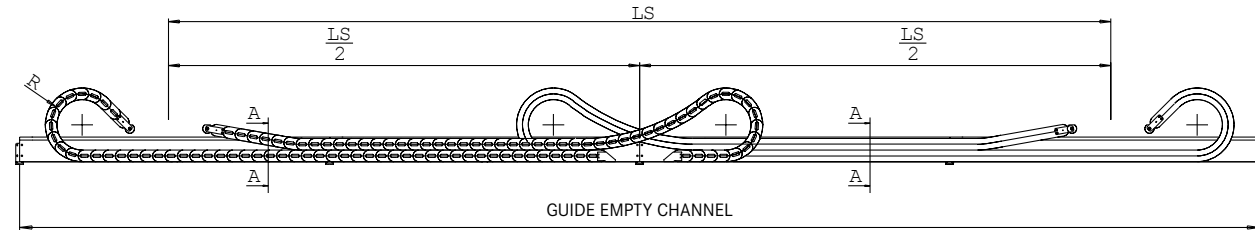

Channel guide is available in kit form composed of:
 side walls 2 m standard length
 joining plates
 fixing screws

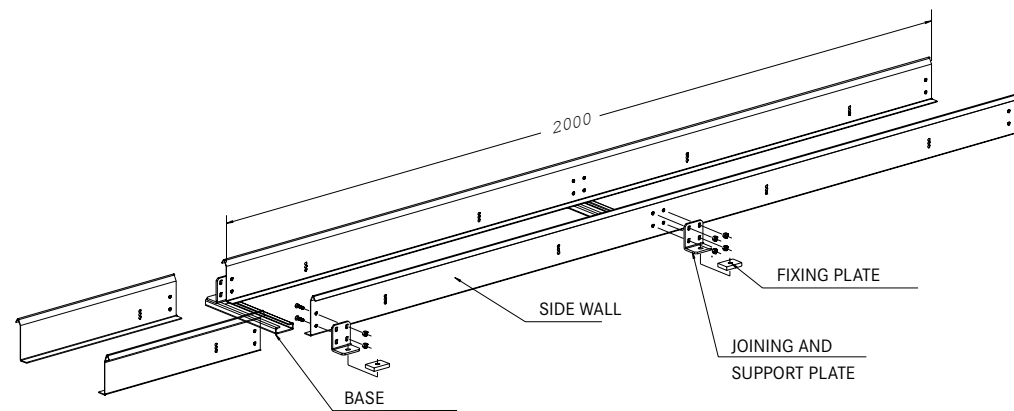

Guide Empty Section

Section A-A

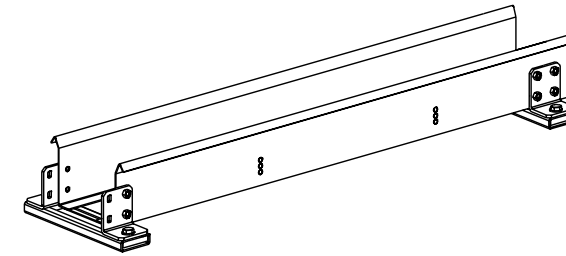
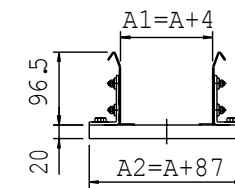

Part Number CS...

How to order

Chain part number	325L040050
Chain part number	325LI040050
Chain part number	325LE040050
Guide channel part number	CS325L040

Guide Sliding Plate Section 325...

Section B-B

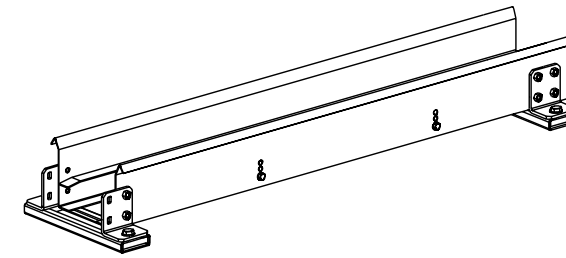
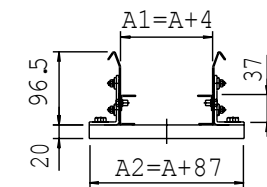

Part Number CA...

How to order

Chain part number	325L040050
Chain part number	325LI040050
Chain part number	325LE040050
Guide channel part number	CA325L040

Guide Sliding Plate Section 335

Section B-B

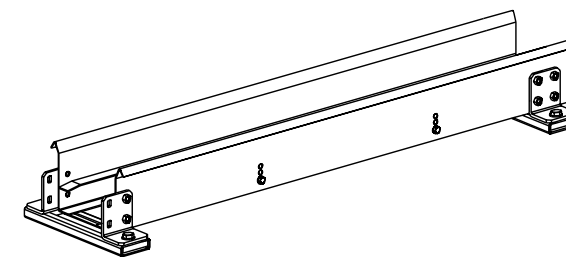
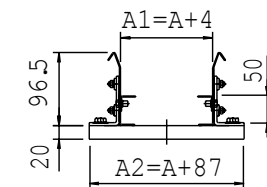

Part Number CA...

How to order

Chain part number	335040050
Guide channel part number	CA335040

Guide Channel for

445 - 660 - 770 - H57

Special channel guide allows the use of the chain for long travel distance.
Available in galvanised steel and, on request, in stainless steel.

Single Chain Application

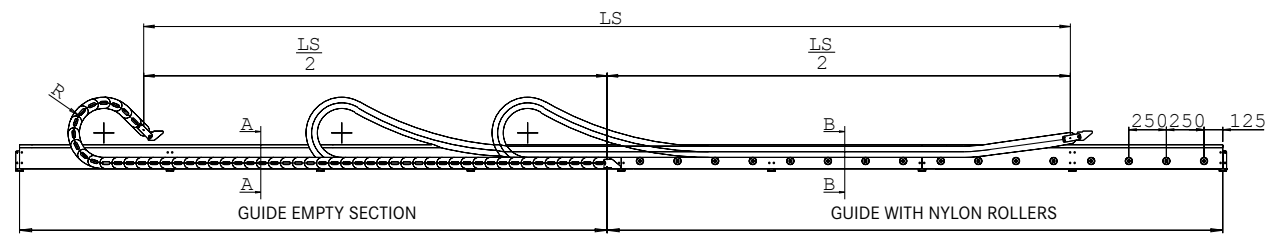

Double Chain Application

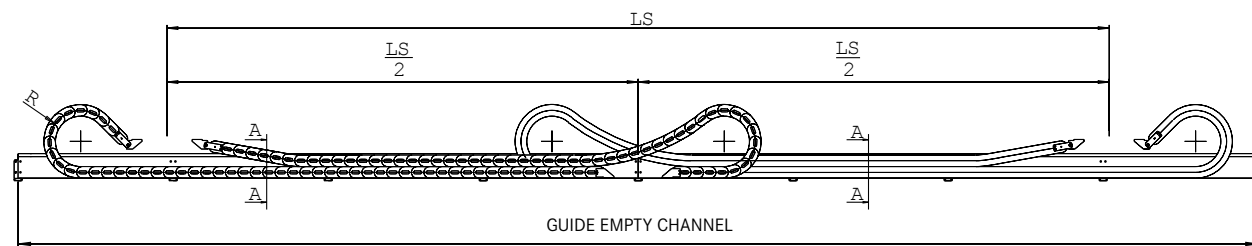

Channel guide is available in kit form composed of:
side walls 2 m standard length
joining plates
fixing screws

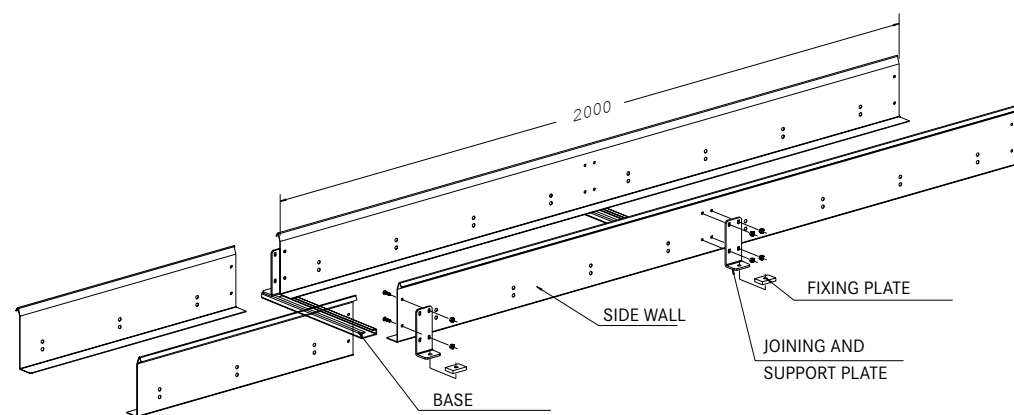

Empty Guide Section

Section A-A

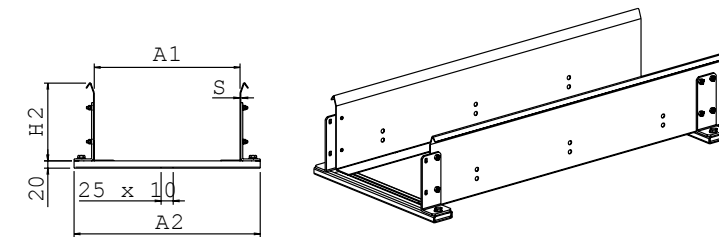

Guide with Nylon Rollers

Section B-B

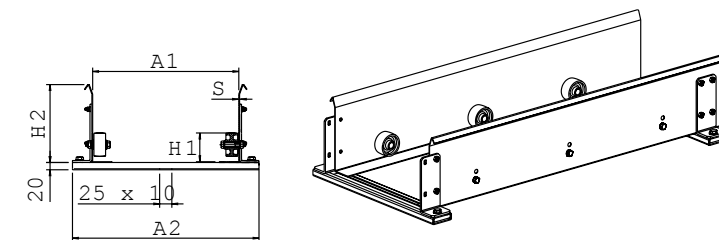

Guide with Steel Sliding Plate

Section B-B

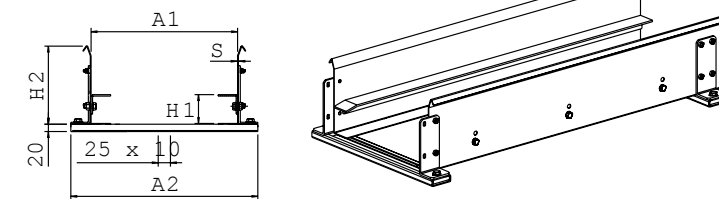

Guide with Plastic Sliding Plate

Section B-B

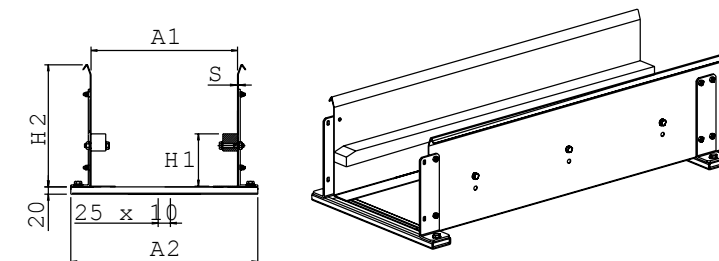

Chain type	H1 mm	H2 mm	A1 mm	A2 mm	S mm
445	64	160	A+4	A+87	1,5
660A	59	160	A+4	A+87	1,5
770A	79	160	A+4	A+87	1,5
H57	85	190	A+4	A+87	1,5

Part Number CS...

How to order

Chain part number	445MU 100150
Guide channel part number	CS445MU 100

Part Number CR...

How to order

Chain part number	445MU 100150
Guide channel part number	CR445MU 100

Part Number CA...

How to order

Chain part number	445MU 100150
Guide channel part number	CA445MU 100

Part Number CP...

How to order

Chain part number	445MU 100150
Guide channel part number	CP445MU 100

Aluminium Guide Channel for H57

Special channel guide allows the use of the chain for long travel distance. Available in galvanised steel and, on request, in stainless steel.

Single Chain Application

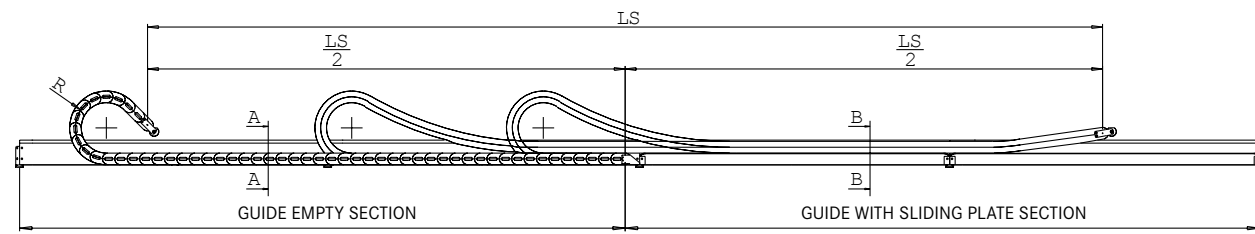

Double Chain Application

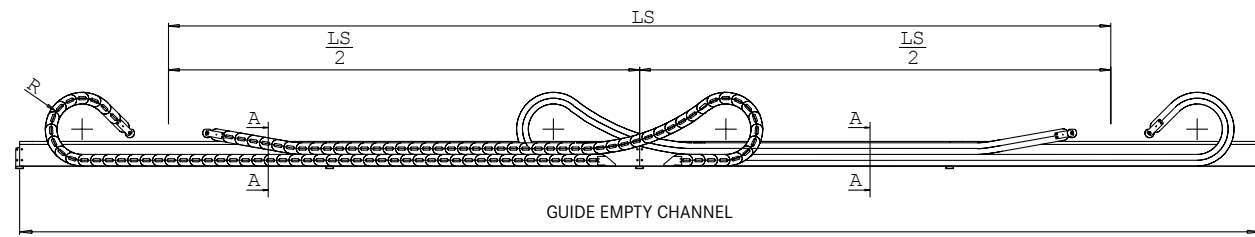

Channel guide is available in kit form composed of:
 side walls 2 m standard length
 joining plates
 fixing screws

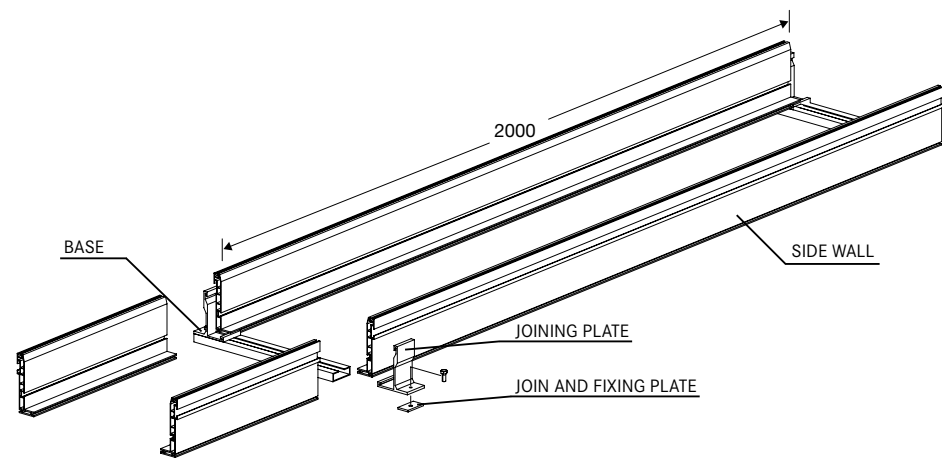

Empty Guide Section

Section A-A

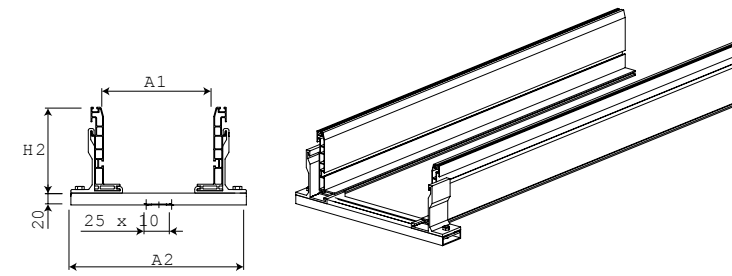

Part Number
CSAH57..

How to order

Chain part number	H57100150
Guide channel part number	CSAH57100

Guide with Nylon Rollers

Section B-B

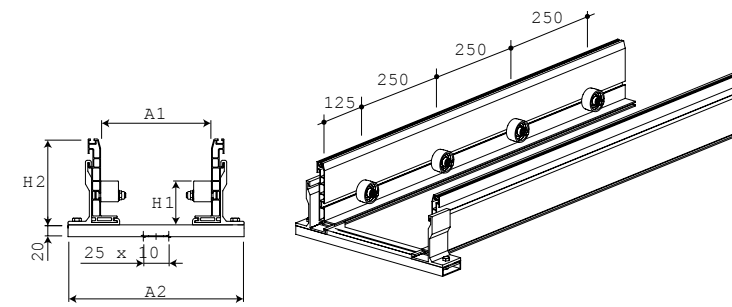

Part Number
CRAH57...

How to order

Chain part number	H57100150
Guide channel part number	CRAH57100

Guide with Plastic Sliding Plate

Section B-B

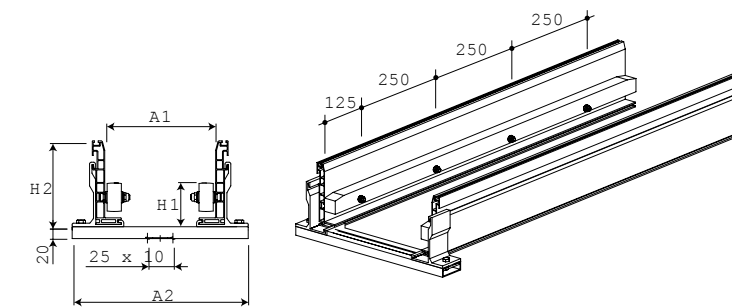

Part Number
CPAH57...

How to order

Chain part number	H57100150
Guide channel part number	CPAH57100

Chain type	H1 mm	H2 mm	A1 mm	A2 mm	S mm
H57	96	190	A+4	A+87	1,5

Guide Channel for H80 - H110

Special channel guide allows the use of the chain for long travel distance. Available in galvanised steel and, on request, in stainless steel.

Single Chain Application

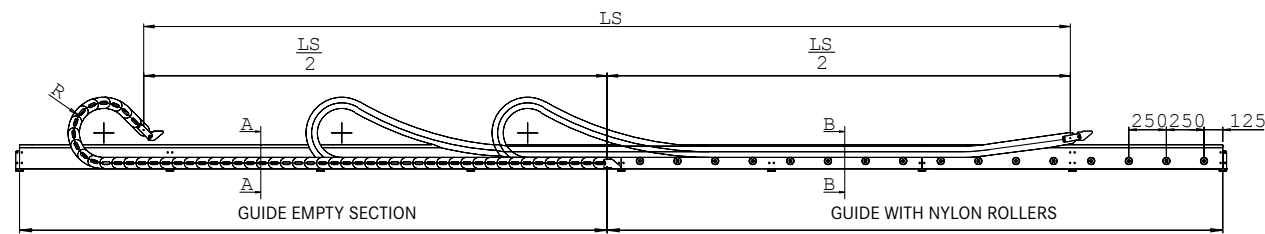

Double Chain Application

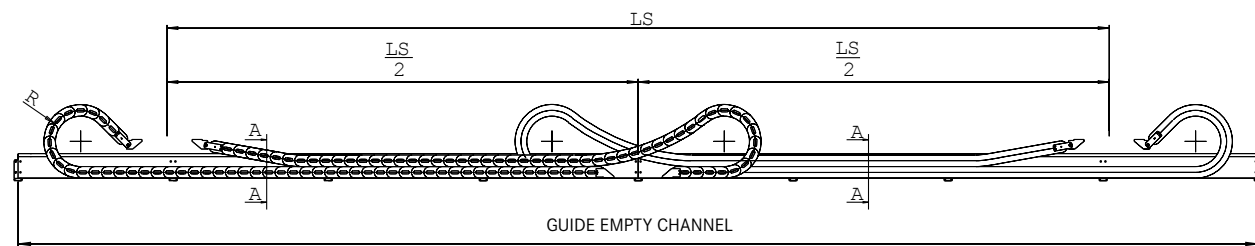

Channel guide is available in kit form composed of:
 side walls 2 m standard length
 joining plates
 fixing screws

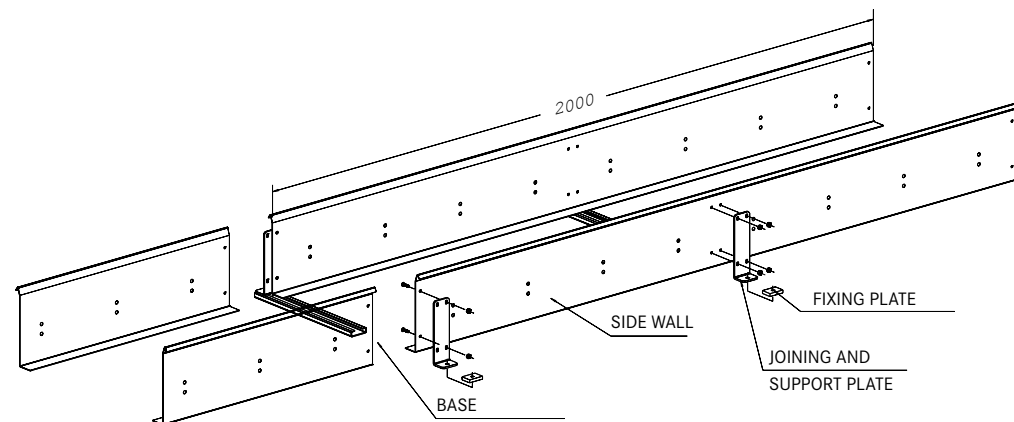

Empty Guide Section

Section A-A

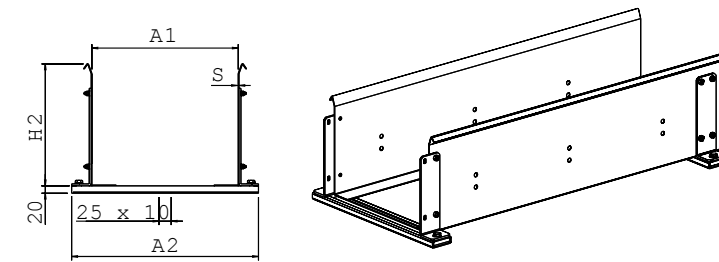

Guide with Nylon Rollers

Section B-B

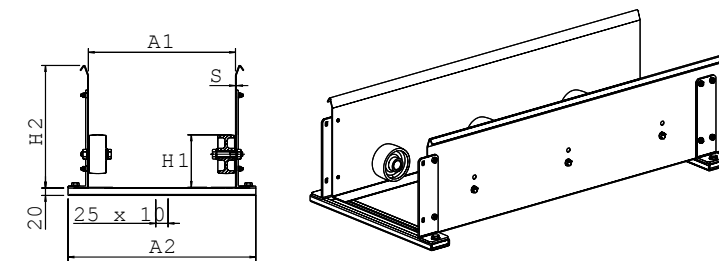

Guide with Steel Sliding Plate

Section B-B

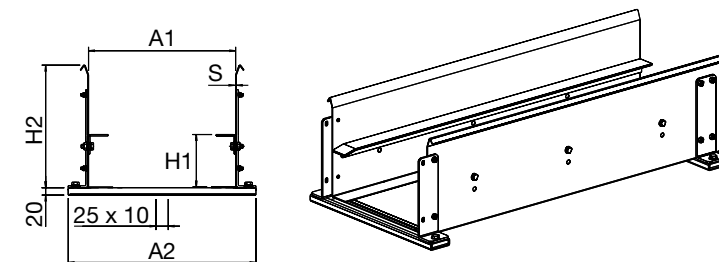

Guide with Plastic Sliding Plate

Section B-B

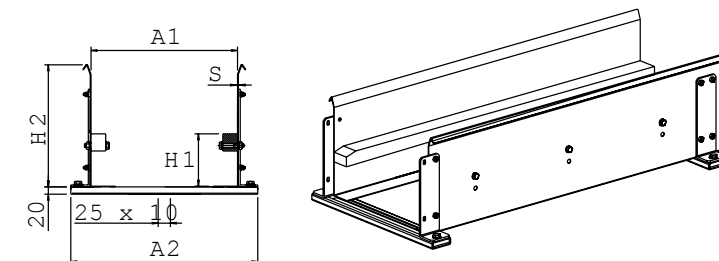

Chain type	H1 mm	H2 mm	A1 mm	A2 mm	S mm
H80	117	250	A+8	A+92	2
H110	155	324	A+8	A+93	2,5

Part Number CS...

How to order

Chain part number	H80150200
Guide channel part number	CSH80150

Part Number CR...

How to order

Chain part number	H80150200
Guide channel part number	CRH80150

Part Number CA...

How to order

Chain part number	H80150200
Guide channel part number	CAH80150

Part Number CP...

How to order

Chain part number	H80150200
Guide channel part number	CPH80150