

Nylon cable chains for multiple applications

Product	Page
SILVYN® CHAIN 200	56
SILVYN® CHAIN 250L/LI/LE	58
SILVYN® CHAIN 325L/LI/LE	64
SILVYN® CHAIN 325PI	70
SILVYN® CHAIN 335L/LI/LE	72
SILVYN® CHAIN 335PS	78
SILVYN® CHAIN 445MU	80
SILVYN® CHAIN 445PU	82
SILVYN® CHAIN 445AU	84
SILVYN® CHAIN 445PS	86
SILVYN® CHAIN 660A	88
SILVYN® CHAIN 660	90
SILVYN® CHAIN 770A	92
SILVYN® CHAIN 770	94
SILVYN® CHAIN 475MU	96
SILVYN® CHAIN 475PU	98
SILVYN® CHAIN 306SU	100
SILVYN® CHAIN 306CU	102
SILVYN® CHAIN 306B	104
SILVYN® CHAIN 307SU	106
SILVYN® CHAIN 307B	108
SILVYN® CHAIN 307E	110
SILVYN® CHAIN 308SU	112
SILVYN® CHAIN 308CU	114
SILVYN® CHAIN 308B	116
SILVYN® CHAIN 308E	118
SILVYN® CHAIN 309SU	120
SILVYN® CHAIN 309CU	122
SILVYN® CHAIN 309B	124
SILVYN® CHAIN 309T	126

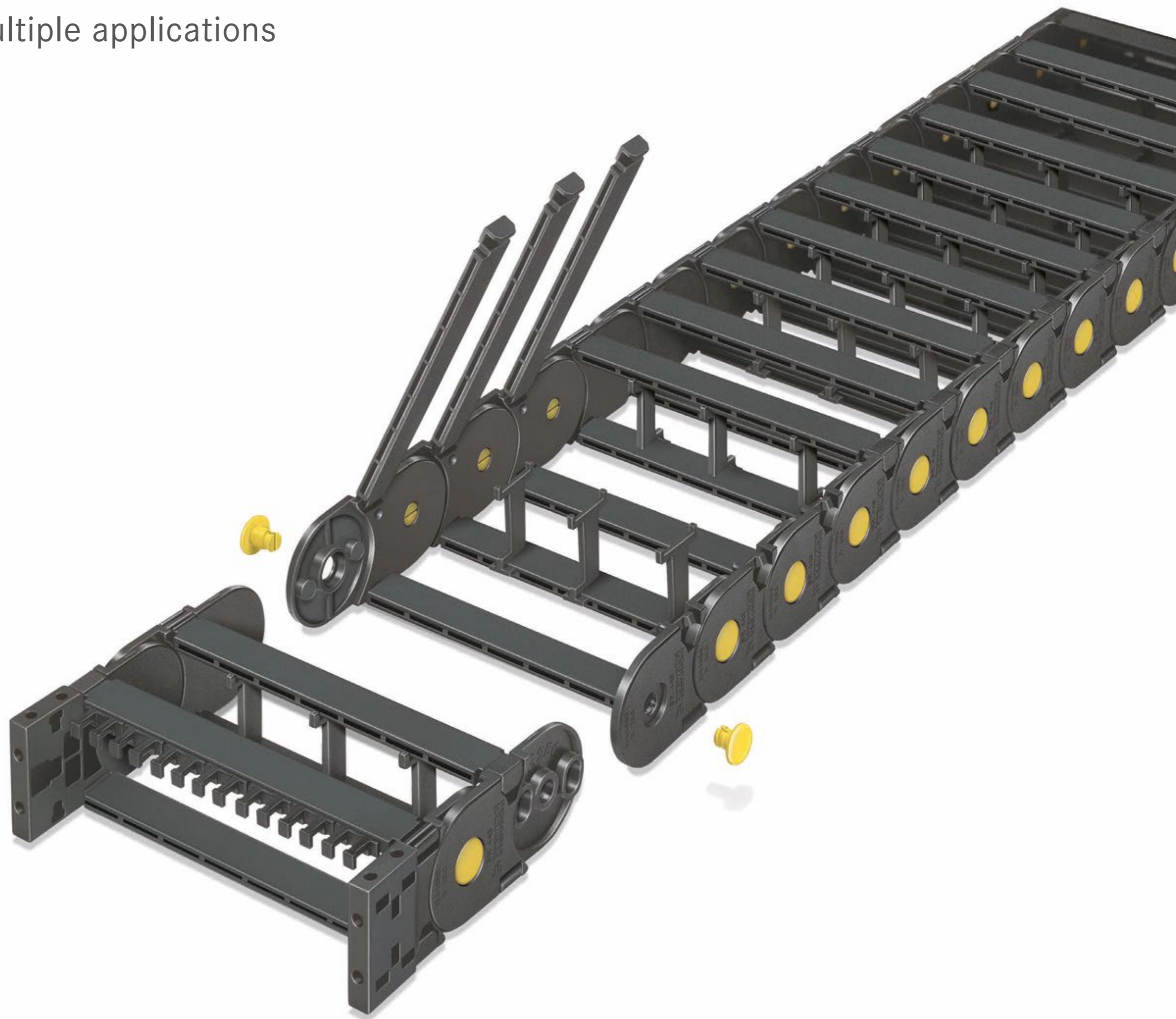

SILVYN® CHAIN 200

Nylon cable chain with non-openable frames

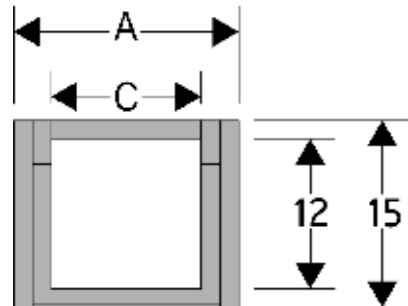

Technical data

- Inner Height (D)**
12 mm
- Pitch (P)**
17 mm
- Speed**
10 m/s
- Acceleration**
50 m/s²

A (mm)	B (mm)	C (mm)	D (mm)	R (mm)	Weight (kg/m)	Article number
18	15	12	12	018-030-040	0.13	20012□□□
31	15	25	12	018-030-040	0.14	20025□□□
41	15	35	12	018-030-040	0.15	20035□□□

□□ to be filled with Radius R

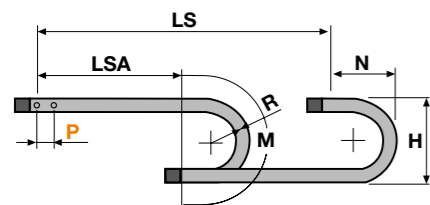

L=LSA + M or M1 Length of chain (L)= Half travel distance LSA plus length of curve (M) or (M1)

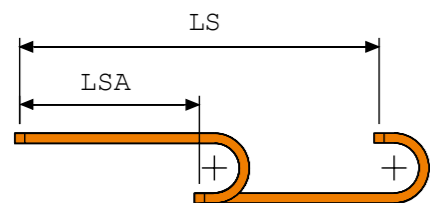

R	H	N	M
018	51	45	95
030	75	55	130
040	95	70	165

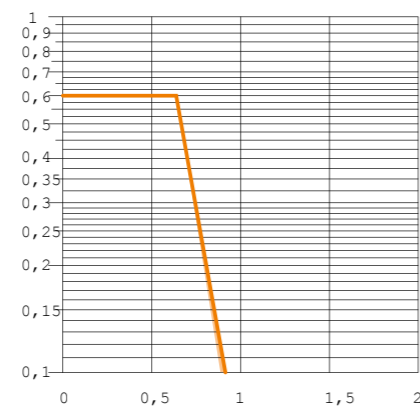

Self-Supporting Capacity Diagram
The maximum length of the self-supporting capacity LSA in relationship to the weight of the cables and hoses contained per metre.

The orange marking/area in the diagram considers the difference of weight between various widths of chain.

For applications with LSA and weights not included in the area of the diagram showing a self-supporting capacity, verify the possible use of support rollers (see page 41).

End brackets

The end brackets set allows the two ends of the chain to be attached to the equipment. Set complete with tiewrap clamps available on request.

Nylon Type

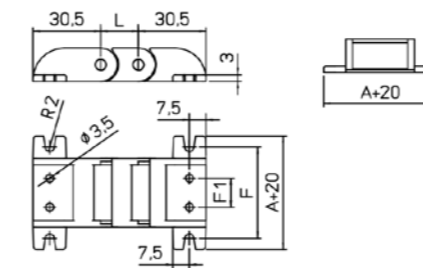
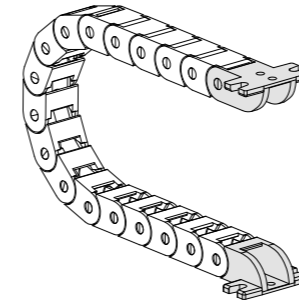

Chain Type	F1	F 1mm
20025□□□	13	41
20035□□□	23	51

Nylon Type Part Numbers

Complete Set Assembled	AN200□□KM
Complete Set Unassembled	AN200□□K

□ Inner width (C)

SILVYN® CHAIN 250L

Nylon cable chain with non-openable frames

i Info

- Sliding version to be ordered with pivoting end bracket set.

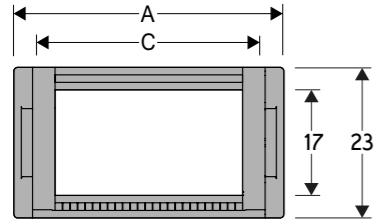

Technical data

- Inner Height (D)**
17 mm
- Pitch (P)**
29 mm
- Height Moving Point (W)**
100 mm
- Speed**
10 m/s
- Acceleration**
50 m/s²

A (mm)	B (mm)	C (mm)	D (mm)	R (mm)	Weight (kg/m)	Article number
26	23	15	17	028-038-045-060-075-100	0.34	250L015□□□
36	23	25	17	028-038-045-060-075-100	0.37	250L025□□□
46	23	35	17	028-038-045-060-075-100	0.40	250L035□□□
61	23	50	17	028-038-045-060-075-100	0.43	250L050□□□

□□ to be filled with Radius R

Separator
 Unassembled Article number S250L
 Assembled Article number S250LMC
 MCI: chain opening outer radius
 MCE: chain opening inner radius

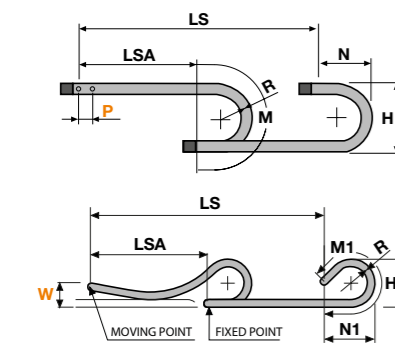

L=LSA + M or M1
 Length of chain (L) = Half travel distance LSA plus length of curve (M) or (M1)

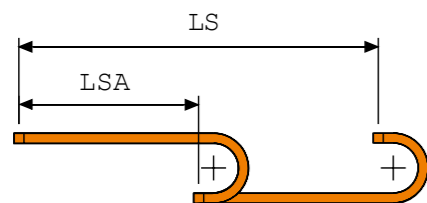

R	H	N	M	N1	M1
028	79	68,5	146	120	255
038	99	78,5	177	125	270
045	113	85,5	199	250	530
060	143	100,5	246	400	850
075	173	115,5	294	505	1085
100	223	140,5	372	650	1405

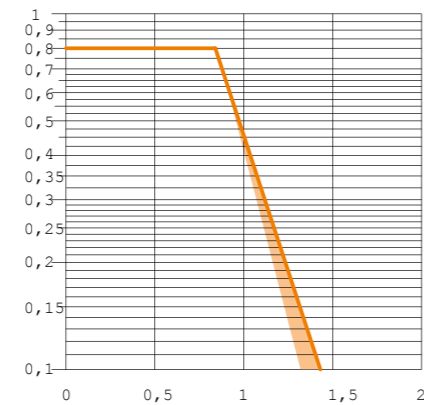

Self-Supporting Capacity Diagram
 The maximum length of the self-supporting capacity LSA in relationship to the weight of the cables and hoses contained per metre.

The orange marking/area in the diagram considers the difference of weight between various widths of chain.

For applications with LSA and weights not included in the area of the diagram showing a self-supporting capacity, verify the possible use of support rollers (see page 41).

End brackets

The end brackets set allows the two ends of the chain to be attached to the equipment. Set complete with tiewrap clamps available on request.

Nylon Type

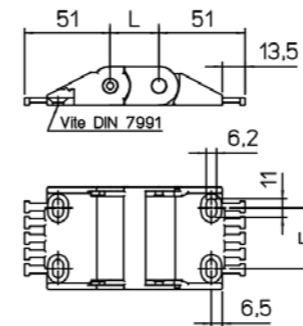
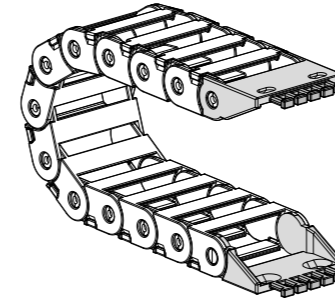

Chain Type	F1
250L35□□□	21
250L50□□□	36

Nylon Type Part Numbers

Complete Set Assembled
AN250L□□□KM
Complete Set Unassembled
AN250L□□□K

□□ Inner width (C)
 Possible mounting positions: 1/2/3/5/6 (acc. to page 33)

SILVYN® CHAIN 250LI

Nylon Cable Chain with opening frames

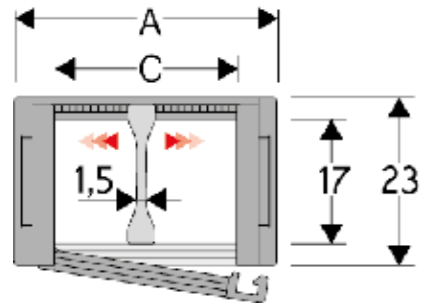

i Info

- Sliding version to be ordered with pivoting end bracket set.

Technical data

- Inner Height (D)**
17 mm
- Pitch (P)**
29 mm
- Height Moving Point (W)**
100 mm
- Speed**
10 m/s
- Acceleration**
50 m/s²

A (mm)	B (mm)	C (mm)	D (mm)	R (mm)	Weight (kg/m)	Article number
26	23	15	17	028-038-045-060-075-100	0.34	250LI015□□□
36	23	25	17	028-038-045-060-075-100	0.37	250LI025□□□
46	23	35	17	028-038-045-060-075-100	0.40	250LI035□□□
61	23	50	17	028-038-045-060-075-100	0.43	250LI050□□□

□□□ to be filled with Radius R

Separator

Unassembled Article number S250L
 Assembled Article number S250LMC
 MCI: chain opening outer radius
 MCE: chain opening inner radius

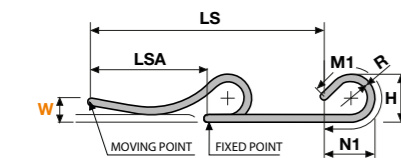
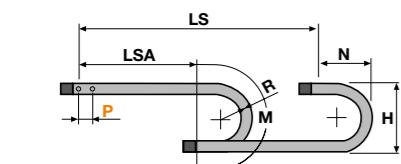

L=LSA + M or M1 Length of chain (L)= Half travel distance LSA plus length of curve (M) or (M1)

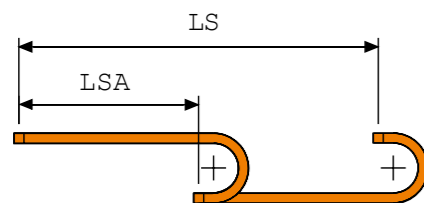

R	H	N	M	N1	M1
028	79	68,5	146	120	255
038	99	78,5	177	125	270
045	113	85,5	199	250	530
060	143	100,5	246	400	850
075	173	115,5	294	505	1085
100	223	140,5	372	650	1405

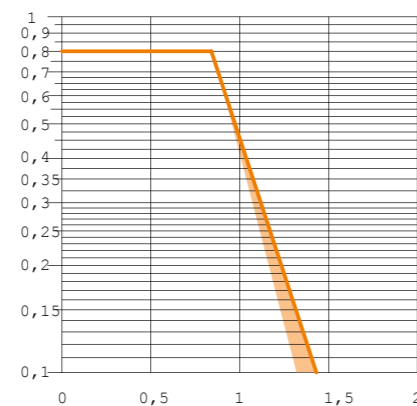

Self-Supporting Capacity Diagram

The maximum length of the self-supporting capacity LSA in relationship to the weight of the cables and hoses contained per metre.

The orange marking/area in the diagram considers the difference of weight between various widths of chain.

For applications with LSA and weights not included in the area of the diagram showing a self-supporting capacity, verify the possible use of support rollers (see page 41).

End brackets

The end brackets set allows the two ends of the chain to be attached to the equipment. Set complete with tiewrap clamps available on request.

Nylon Type

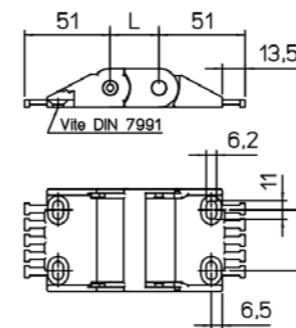
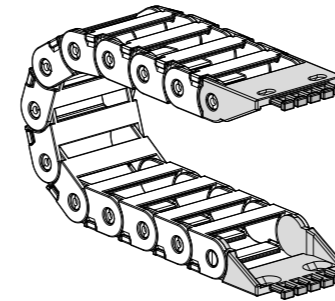

Chain Type	F1
250L35□□□	21
250L50□□□	36

Nylon Type Part Numbers	
Complete Set Assembled	
AN250L□□□KM	
Complete Set Unassembled	
AN250L□□□K	

□□□ Inner width (C)
 Possible mounting positions: 1/2/3/5/6 (acc. to page 33)

SILVYN® CHAIN 250LE

Nylon Cable Chain with opening frames

i Info

- Sliding version to be ordered with pivoting end bracket set.

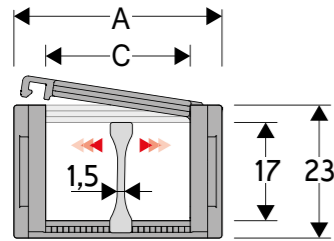

Technical data

- Inner Height (D)**
17 mm
- Pitch (P)**
29 mm
- Height Moving Point (W)**
100 mm
- Speed**
10 m/s
- Acceleration**
50 m/s²

Separator

Unassembled	Article number S250L
Assembled	Article number S250LMC

MCI: chain opening outer radius
MCE: chain opening inner radius

A (mm)	B (mm)	C (mm)	D (mm)	R (mm)	Weight (kg/m)	Article number
26	23	15	17	028-038-045-060-075-100	0.34	250LE015□□□
36	23	25	17	028-038-045-060-075-100	0.37	250LE025□□□
46	23	35	17	028-038-045-060-075-100	0.40	250LE035□□□
61	23	50	17	028-038-045-060-075-100	0.43	250LE050□□□

□□□ to be filled with Radius R

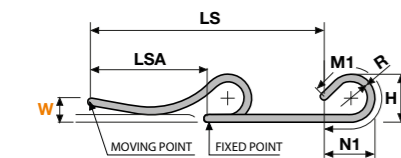
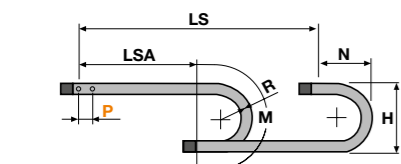

L=LSA + M or M1 Length of chain (L)= Half travel distance LSA plus length of curve (M) or (M1)

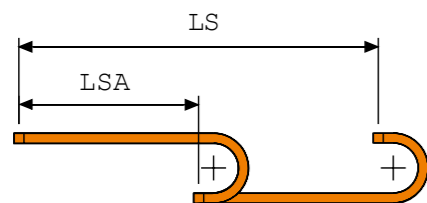

R	H	N	M	N1	M1
028	79	68,5	146	120	255
038	99	78,5	177	125	270
045	113	85,5	199	250	530
060	143	100,5	246	400	850
075	173	115,5	294	505	1085
100	223	140,5	372	650	1405

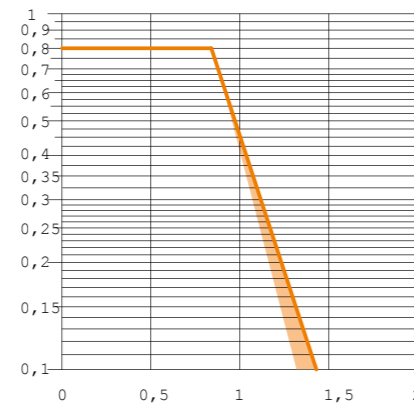

Self-Supporting Capacity Diagram
The maximum length of the self-supporting capacity LSA in relationship to the weight of the cables and hoses contained per metre.

The orange marking/area in the diagram considers the difference of weight between various widths of chain.

For applications with LSA and weights not included in the area of the diagram showing a self-supporting capacity, verify the possible use of support rollers (see page 41).

End brackets

The end brackets set allows the two ends of the chain to be attached to the equipment. Set complete with tiewrap clamps available on request.

Nylon Type

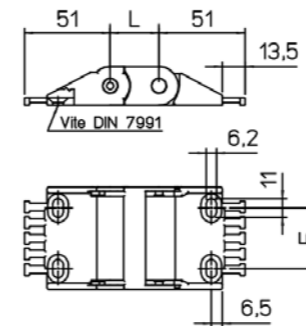
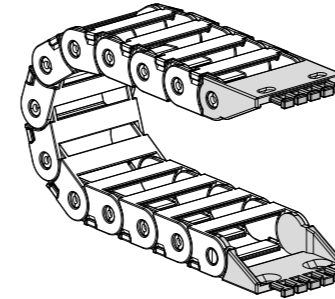

Chain Type	F1
250L35□□□	21
250L50□□□	36

Nylon Type Part Numbers

Complete Set Assembled
AN250L□□□KM
Complete Set Unassembled
AN250L□□□K

□□□ Inner width (C)
Possible mounting positions: 1/2/3/5/6 (acc. to page 33)

SILVYN® CHAIN 325PI

Nylon cable chain with openable protection frames.

i Info

- Sliding version to be ordered with pivoting end bracket set.

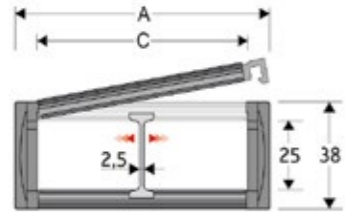

Technical data

- Inner Height (D)**
25 mm
- Pitch (P)**
45 mm
- Height Moving Point (W)**
140 mm
- Speed**
10 m/s
- Acceleration**
50 m/s²

A (mm)	B (mm)	C (mm)	D (mm)	R (mm)	Weight (kg/m)	Article number
57	38	40	25	075-100-125-150	1.15	325PI040□□□
77	38	60	25	075-100-125-150	1.30	325PI060□□□
93	38	76	25	075-100-125-150	1.40	325PI076□□□
120	38	103	25	075-100-125-150	1.70	325PI103□□□

□□□ to be filled with Radius R

Separator

Unassembled	Article number S325L
Assembled	Article number S325LMC

MCI: chain opening outer radius
MCE: chain opening inner radius

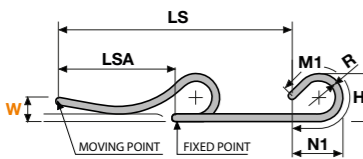
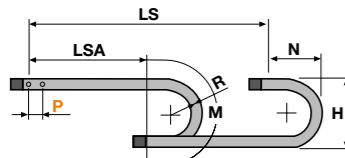

L=LSA + M or M1 Length of chain (L)= Half travel distance LSA plus length of curve (M) or (M1)

R	H	N	M	N1	M1
075	188	140	325	185	420
100	238	165	405	275	635
125	288	190	485	360	855
150	338	215	565	445	1075

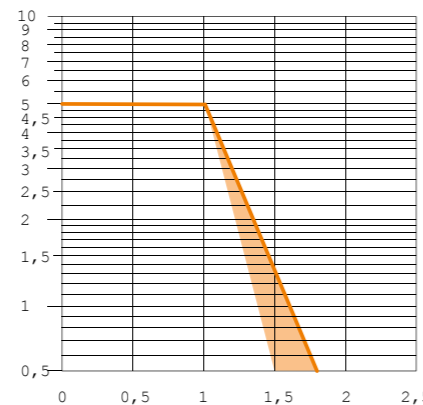
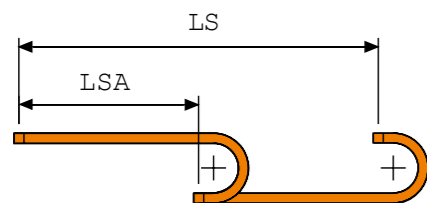

Self-Supporting Capacity Diagram
The maximum length of the self-supporting capacity LSA in relationship to the weight of the cables and hoses contained per metre.

The orange marking/area in the diagram considers the difference of weight between various widths of chain.

For applications with LSA and weights not included in the area of the diagram showing a self-supporting capacity, verify the possible use of support rollers (see page 41).

End brackets

The end brackets set allows the two ends of the chain to be attached to the equipment. Set complete with tiewrap clamps available on request.

Nylon Type

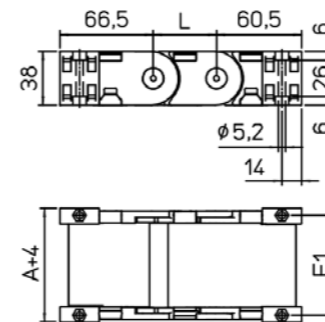
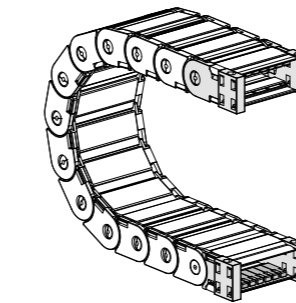

Steel Type

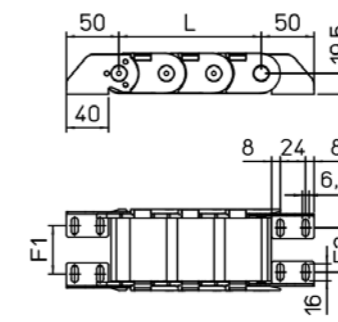
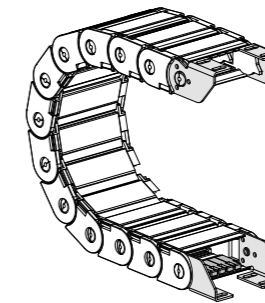

Chain Type	F1
325PI040□□□	51
325PI060□□□	71
325PI076□□□	87
325PI103□□□	114

Chain Type	F1	F2
325PI40□□□	25.5	22
325PI60□□□	45.5	42
325PI76□□□	61.5	58
325PI103□□□	88.5	85

Nylon Type Part Numbers

Complete Set Assembled	AN325L□□□KM
Complete Set Unassembled	AN325L□□□K

Tiewrap Clamp Part Numbers

Complete Set Assembled	CFC325L□□□KM
Complete Set Unassembled	CFC325L□□□K

Steel Type Part Numbers

Complete Set Assembled	A325LKM
Complete Set Unassembled	A325LK

Tiewrap Clamp Part Numbers

Complete Set Assembled	CFC325L□□□KM
Complete Set Unassembled	CFC325L□□□K

□□□ Inner width (C)

SILVYN® CHAIN 335LE

Nylon Cable Chain with opening frames

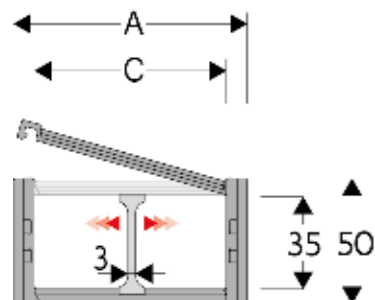

Info

- Sliding version to be ordered with pivoting end bracket set.



Technical data

- Inner Height (D)**
35 mm
- Pitch (P)**
52 mm
- Height Moving Point (W)**
140 mm
- Speed**
10 m/s
- Acceleration**
50 m/s²

A (mm)	B (mm)	C (mm)	D (mm)	R (mm)	Weight (kg/m)	Article number
56.5	50	40	35	065-075-100-125-150-200	1.12	335LE040□□□
66.5	50	50	35	065-075-100-125-150-200	1.15	335LE050□□□
76.5	50	60	35	065-075-100-125-150-200	1.19	335LE060□□□
92.5	50	76	35	065-075-100-125-150-200	1.25	335LE076□□□
119.5	50	103	35	065-075-100-125-150-200	1.36	335LE103□□□
141.5	50	125	35	065-075-100-125-150-200	1.44	335LE125□□□
166.5	50	150	35	065-075-100-125-150-200	1.54	335LE150□□□

□□□ to be filled with Radius R

L=LSA + M or M1 Length of chain (L)=
Half travel distance LSA
plus length of curve (M)
or (M1)

Separator
Unassembled Article number S4353
Assembled Article number S4353MC
MC: chain opening outer radius
MCE: chain opening inner radius

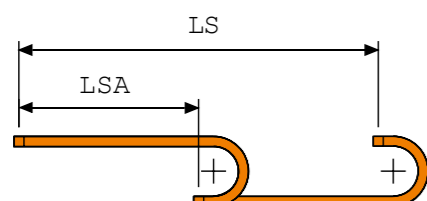
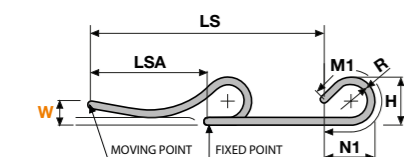
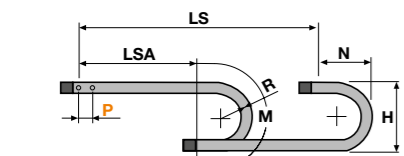

R	H	N	M	N1	M1
065	180	169	310	220	465
075	200	179	340	260	560
100	250	204	420	350	790
125	300	229	500	445	1025
150	350	254	580	540	1260
200	450	304	735	730	1725

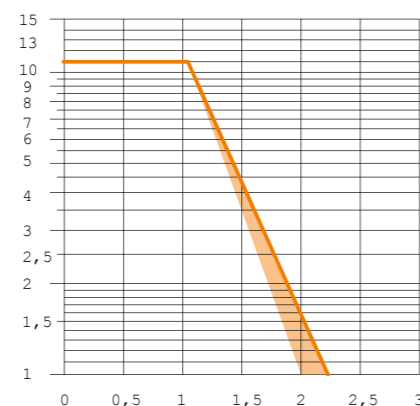

Self-Supporting Capacity Diagram
The maximum length of the self-supporting capacity LSA in relationship to the weight of the cables and hoses contained per metre.

The orange marking/area in the diagram considers the difference of weight between various widths of chain.

For applications with LSA and weights not included in the area of the diagram showing a self-supporting capacity, verify the possible use of support rollers (see page 41).

End brackets

The end brackets set allows the two ends of the chain to be attached to the equipment. Set complete with tiewrap clamps available on request.

Nylon Type

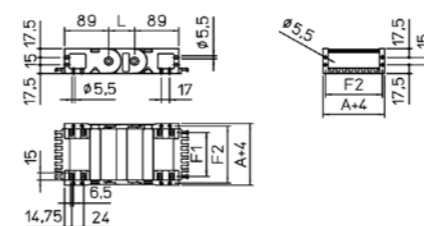
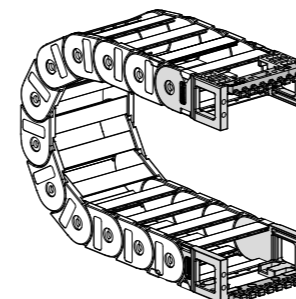

Chain Type	F1	F1
335L40□□□	25	51
335L50□□□	35	61
335L60□□□	45	71
335L76□□□	61	87
335L103□□□	88	114
335L125□□□	110	136
335L150□□□	135	161

Nylon Type Part Numbers

Complete Set Assembled

AN335L□□□KM

Complete Set Unassembled

AN335L□□□K

Tiewrap Clamp Part Numbers

Complete Set Assembled

PFN335□□□

□□□ Inner width (C)
Possible mounting positions: 1/2/3 (acc. to page 33)

SILVYN® CHAIN 335PS

Nylon cable chain with openable protection frames.

Info

- Sliding version to be ordered with pivoting end bracket set.

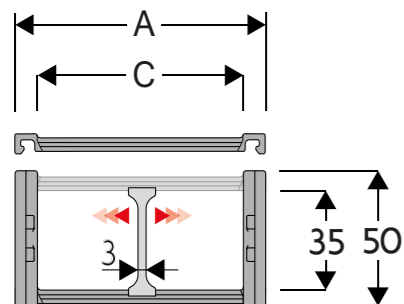

Technical data

- Inner Height (D)**
35 mm
- Pitch (P)**
52 mm
- Height Moving Point (W)**
140 mm
- Speed**
10 m/s
- Acceleration**
50 m/s²

A (mm)	B (mm)	C (mm)	D (mm)	R (mm)	Weight (kg/m)	Article number
66.5	50	50	35	100-125-150-200	1.35	335PS050□□□
92.5	50	76	35	100-125-150-200	1.57	335PS076□□□
119.5	50	103	35	100-125-150-200	1.81	335PS103□□□
166.5	50	150	35	100-125-150-200	2.21	335PS150□□□

□□□ to be filled with Radius R

Separator

Unassembled Article number S4353
 Assembled Article number S4353MC
 MCI: chain opening outer radius
 MCE: chain opening inner radius

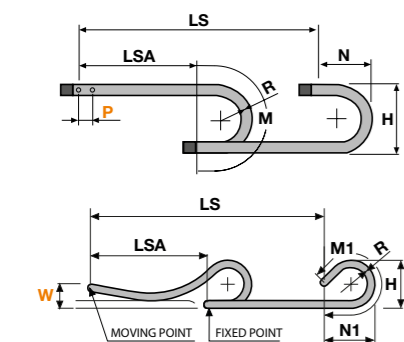

R	H	N	M	N1	M1
100	250	204	420	350	790
125	300	229	500	445	1025
150	350	254	580	540	1260
200	450	304	735	730	1725

L=LSA + M or M1 Length of chain (L)=
 Half travel distance LSA
 plus length of curve (M)
 or (M1)

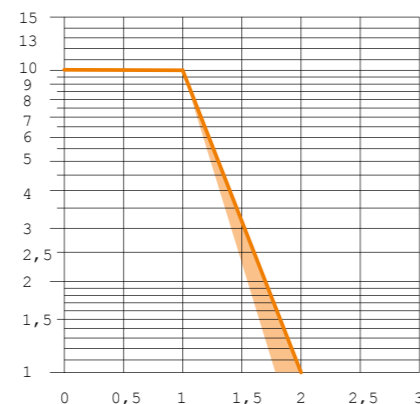
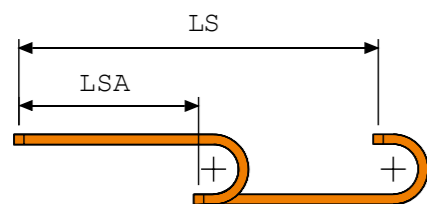

Self-Supporting Capacity Diagram

The maximum length of the self-supporting capacity LSA in relationship to the weight of the cables and hoses contained per metre.

The orange marking/area in the diagram considers the difference of weight between various widths of chain.

For applications with LSA and weights not included in the area of the diagram showing a self-supporting capacity, verify the possible use of support rollers (see page 41).

End brackets

The end brackets set allows the two ends of the chain to be attached to the equipment. Set complete with tiewrap clamps available on request.

Nylon Type

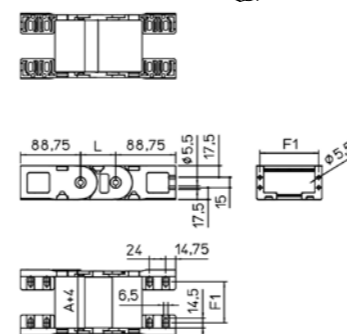
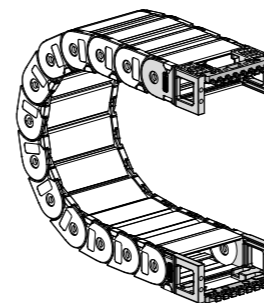

Chain Type	F1
335PS050□□□	61
335PS076□□□	87
335PS103□□□	114
335PS150□□□	161

Nylon Type Part Numbers

Complete Set Assembled

AN335P□□□KM

Complete Set Unassembled

AN335P□□□K

Tiewrap Clamp Part Numbers

Complete Set Assembled

PFN335□□□KM

□□□ Inner width (C)
 Possible mounting positions: 1/2/3 (acc. to page 33)

SILVYN® CHAIN 445MU

Nylon Cable Chain with opening frames

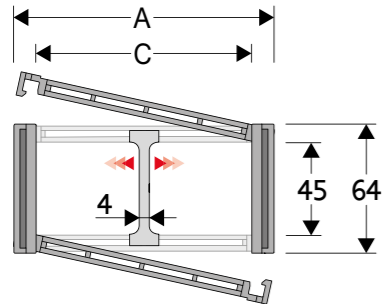

Info

- Sliding version to be ordered with pivoting end bracket set.

Technical data

	Inner Height (D)	45 mm
	Pitch (P)	67 mm
	Height Moving Point (W)	200 mm
	Speed	10 m/s
	Acceleration	50 m/s ²

Separator

Unassembled	Article number S445UF
Assembled	Article number S445UFMCI, S445UFMCE

MCI: chain opening outer radius
MCE: chain opening inner radius

Strong-hold separator for C > 200 mm

Unassembled	Article number S445SH
Assembled	Article number S445SHMC

Pin Article number PG445

A (mm)	B (mm)	C (mm)	D (mm)	R (mm)	Weight (kg/m)	Article number
72	64	50	45	075-100-125-150-175-200-250-300	1.64	445MU050
83	64	61	45	075-100-125-150-175-200-250-300	1.64	445MU061
97	64	75	45	075-100-125-150-175-200-250-300	1.76	445MU075
103	64	81	45	075-100-125-150-175-200-250-300	1.79	445MU081
107	64	85	45	075-100-125-150-175-200-250-300	2.15	445MU085
117	64	95	45	075-100-125-150-175-200-250-300	1.86	445MU095
122	64	100	45	075-100-125-150-175-200-250-300	1.87	445MU100
129	64	107	45	075-100-125-150-175-200-250-300	1.90	445MU107
139	64	117	45	075-100-125-150-175-200-250-300	1.93	445MU117
147	64	125	45	075-100-125-150-175-200-250-300	2.01	445MU125
158	64	136	45	075-100-125-150-175-200-250-300	2.07	445MU136
172	64	150	45	075-100-125-150-175-200-250-300	2.13	445MU150
197	64	175	45	075-100-125-150-175-200-250-300	2.25	445MU175
222	64	200	45	075-100-125-150-175-200-250-300	2.39	445MU200
233	64	211	45	075-100-125-150-175-200-250-300	2.44	445MU211
247	64	225	45	075-100-125-150-175-200-250-300	2.52	445MU225
274	64	252	45	075-100-125-150-175-200-250-300	2.66	445MU252
283	64	261	45	075-100-125-150-175-200-250-300	2.70	445MU261
334	64	312	45	075-100-125-150-175-200-250-300	2.92	445MU312
356	64	334	45	075-100-125-150-175-200-250-300	3.05	445MU334
384	64	362	45	075-100-125-150-175-200-250-300	3.18	445MU362

□□□ to be filled with Radius R

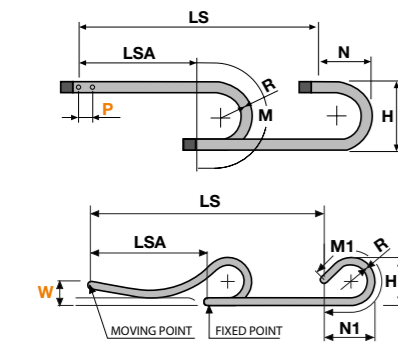

L=LSA + M or M1 Length of chain (L)= Half travel distance LSA plus length of curve (M) or (M1)

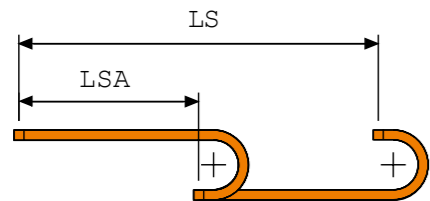

R	H	N	M	N1	M1
075	214	180	370	205	425
100	264	200	450	230	505
125	314	225	530	285	655
150	364	250	605	375	875
175	414	275	685	460	1085
200	464	300	765	550	1310
250	564	350	920	725	1750
300	664	400	1080	1295	2970

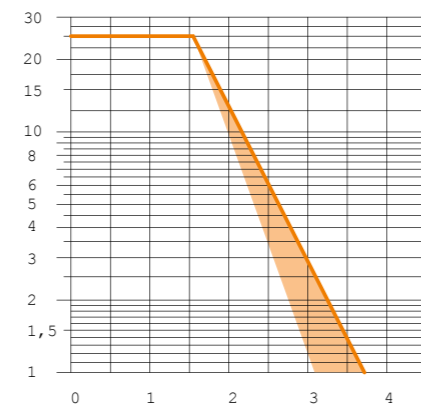

Self-Supporting Capacity Diagram
The maximum length of the self-supporting capacity LSA in relationship to the weight of the cables and hoses contained per metre.

The orange marking/area in the diagram considers the difference of weight between various widths of chain.

For applications with LSA and weights not included in the area of the diagram showing a self-supporting capacity, verify the possible use of support rollers (see page 41).

End brackets

The end brackets set allows the two ends of the chain to be attached to the equipment. Set complete with tiewrap clamps available on request.

Nylon Type

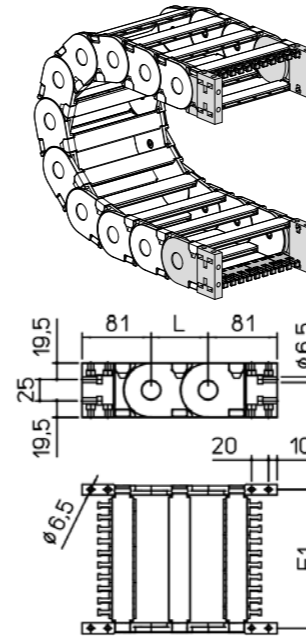

Chain Type	F1
445MU050	63
445MU061	74
445MU075	88
445MU081	94
445MU085	98
445MU095	108
445MU100	113
445MU107	120
445MU117	130
445MU125	138
445MU136	149
445MU150	163
445MU175	188
445MU200	213
445MU211	224
445MU225	238
445MU252	265
445MU261	274
445MU312	325
445MU334	347
445MU362	375

Nylon Type Part Numbers	
Complete Set Assembled	AN445M□□□KM
Complete Set Unassembled	AN445M□□□K
Tiewrap Clamp Part Numbers	
Complete Set Assembled	CFC445M□□□KM
Complete Set Unassembled	CFC445M□□□K

□□□ Inner width (C)

Nylon Type

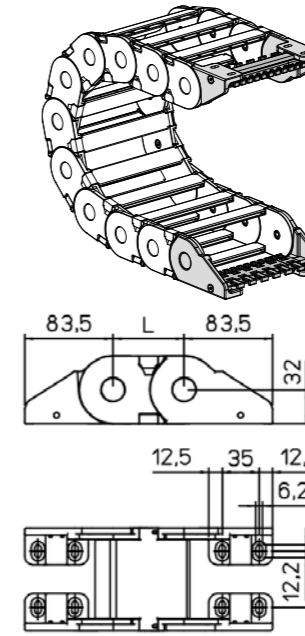

Chain Type	F1
445MU050	28
445MU061	39
445MU075	53
445MU081	59
445MU085	63
445MU095	73
445MU100	78
445MU107	85
445MU117	95
445MU125	103
445MU136	114
445MU150	128
445MU175	153
445MU200	178
445MU211	189
445MU225	203
445MU252	230
445MU261	239
445MU312	290
445MU334	312
445MU362	340

Nylon Type Part Numbers	
Complete Set Assembled	AN445KM□
Complete Set Unassembled	AN445K□
Tiewrap Clamp Part Numbers	
Complete Set Assembled	SFCT445□□□KM
Complete Set Unassembled	SFCT445□□□K

□□□ Inner width (C)
Possible mounting positions: 1/2/3/5/6 (acc. to page 33)

Steel Type

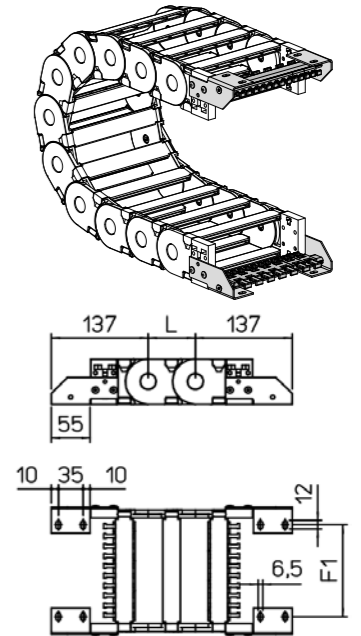

Chain Type	F1
445MU	F1=A-44

Steel Type Part Numbers	
Complete Set Assembled	A445M□□□KM□
Complete Set Unassembled	A445M□□□K□
Tiewrap Clamp Part Numbers	
Complete Set Assembled	CFC445M□□□KM
Complete Set Unassembled	CFC445M□□□K

□□□ Inner width (C)
Possible mounting positions: 1/2/3 (acc. to page 33)

SILVYN® CHAIN 445PU

Nylon cable chain with openable protection frames.

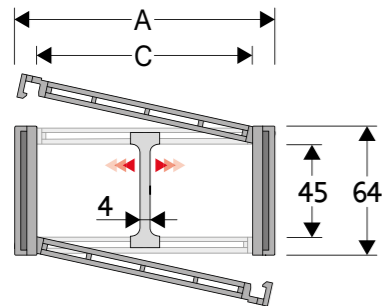

Technical data

- Inner Height (D)**
45 mm
- Pitch (P)**
67 mm
- Speed**
10 m/s
- Acceleration**
50 m/s²

- Separator**
- Unassembled Article number S445UF
 - Assembled Article number S445UFMCI, S445UFMCE
- MCI: chain opening outer radius
MCE: chain opening inner radius
- Pin** Article number PG445

A (mm)	B (mm)	C (mm)	D (mm)	R (mm)	Weight (kg/m)	Article number
72	64	50	45	100-125-150-175-200-250-300	1.83	445PU050
83	64	61	45	100-125-150-175-200-250-300	1.87	445PU061
97	64	75	45	100-125-150-175-200-250-300	2.05	445PU075
103	64	81	45	100-125-150-175-200-250-300	2.10	445PU081
107	64	85	45	100-125-150-175-200-250-300	2.15	445PU085
117	64	95	45	100-125-150-175-200-250-300	2.23	445PU095
122	64	100	45	100-125-150-175-200-250-300	2.26	445PU100
129	64	107	45	100-125-150-175-200-250-300	2.31	445PU107
139	64	117	45	100-125-150-175-200-250-300	2.38	445PU117
147	64	125	45	100-125-150-175-200-250-300	2.49	445PU125
158	64	136	45	100-125-150-175-200-250-300	2.60	445PU136
172	64	150	45	100-125-150-175-200-250-300	2.71	445PU150
197	64	175	45	100-125-150-175-200-250-300	2.93	445PU175
222	64	200	45	100-125-150-175-200-250-300	3.17	445PU200
233	64	211	45	100-125-150-175-200-250-300	3.26	445PU211
247	64	225	45	100-125-150-175-200-250-300	3.39	445PU225
274	64	252	45	100-125-150-175-200-250-300	3.64	445PU252
283	64	261	45	100-125-150-175-200-250-300	3.71	445PU261
334	64	312	45	100-125-150-175-200-250-300	4.13	445PU312
356	64	334	45	100-125-150-175-200-250-300	4.35	445PU334
384	64	362	45	100-125-150-175-200-250-300	4.59	445PU362

□□□ to be filled with Radius R

R	H	N	M
100	264	200	450
125	314	225	530
150	364	250	605
175	414	275	685
200	464	300	765
250	564	350	920
300	664	400	1080

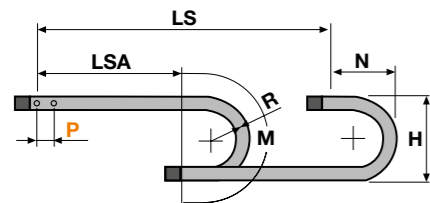

L=LSA + M or M1 Length of chain (L)= Half travel distance LSA plus length of curve (M) or (M1)

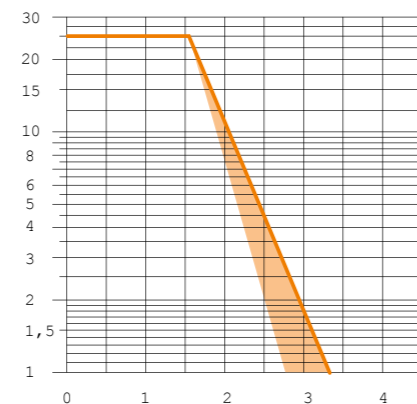
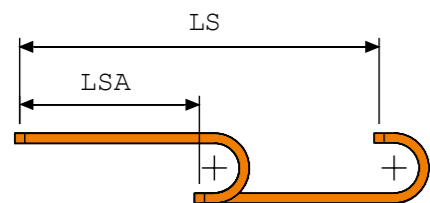

Self-Supporting Capacity Diagram
The maximum length of the self-supporting capacity LSA in relationship to the weight of the cables and hoses contained per metre.

The orange marking/area in the diagram considers the difference of weight between various widths of chain.

For applications with LSA and weights not included in the area of the diagram showing a self-supporting capacity, verify the possible use of support rollers (see page 41).

End brackets

The end brackets set allows the two ends of the chain to be attached to the equipment. Set complete with tiewrap clamps available on request.

Nylon Type

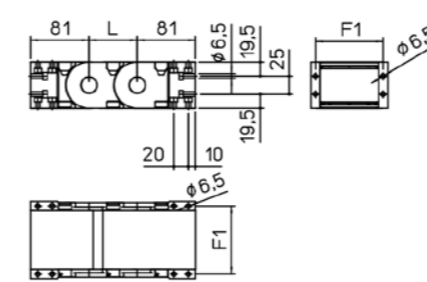
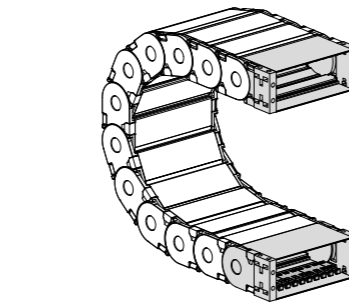

Chain Type	F1
445PU050	63
445PU061	74
445PU075	88
445PU081	94
445PU085	98
445PU095	108
445PU100	113
445PU107	120
445PU117	130
445PU125	138
445PU136	149
445PU150	163
445PU175	188
445PU200	213
445PU211	224
445PU225	238
445PU252	265
445PU261	274
445PU312	325
445PU334	347
445PU362	375

- Nylon Type Part Numbers**
- Complete Set Assembled AN445P□□□KM
 - Complete Set Unassembled AN445P□□□K
- Tiewrap Clamp Part Numbers**
- Complete Set Assembled CFC445M□□□KM
 - Complete Set Unassembled CFC445M□□□K

□□□ Inner width (C)

Nylon Type

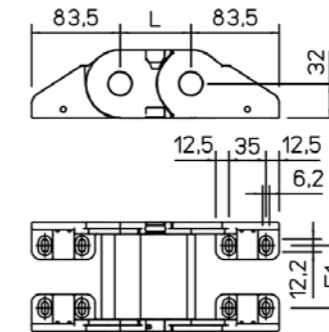
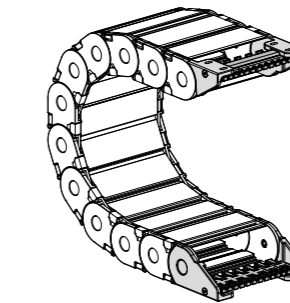

Chain Type	F1
445PU050	28
445PU061	39
445PU075	53
445PU081	59
445PU085	63
445PU095	73
445PU100	78
445PU107	85
445PU117	95
445PU125	103
445PU136	114
445PU150	128
445PU175	153
445PU200	178
445PU211	189
445PU225	203
445PU252	230
445PU261	239
445PU312	290
445PU334	312
445PU362	340

- Nylon Type Part Numbers**
- Complete Set Assembled AN445KM□
 - Complete Set Unassembled AN445K□
- Tiewrap Clamp Part Numbers**
- Complete Set Assembled SFCT445□□□KM
 - Complete Set Unassembled SFCT445□□□K

□□□ Inner width (C)

Possible mounting positions: 1/2/3/5/6 (acc. to page 33)

Steel Type

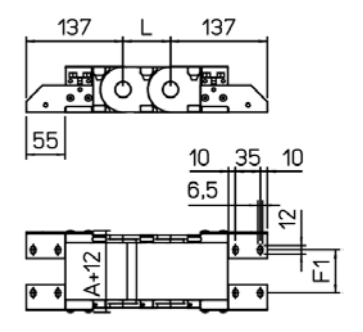
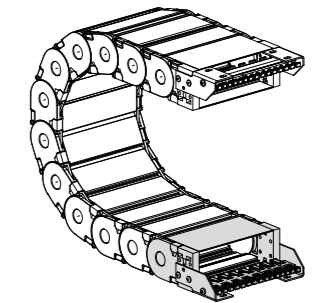

Chain Type	F1
445PU	F1=A-44

- Steel Type Part Numbers**
- Complete Set Assembled A445P□□□KM□
 - Complete Set Unassembled A445P□□□K□
- Tiewrap Clamp Part Numbers**
- Complete Set Assembled CFC445M□□□KM
 - Complete Set Unassembled CFC445M□□□K

□□□ Inner width (C)

Possible mounting positions: 1/2/3 (acc. to page 33)

SILVYN® CHAIN 445AU

Nylon cable chain with openable protection frames.

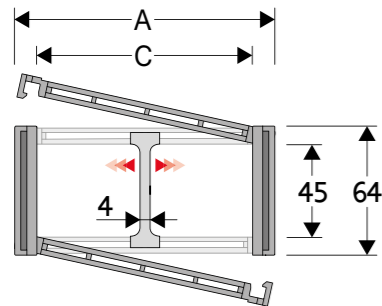

Technical data

- Inner Height (D)**
45 mm
- Pitch (P)**
67 mm
- Speed**
10 m/s
- Acceleration**
50 m/s²

Separator
Unassembled Article number S445UF
Assembled Article number S445UFMCI, S445UFMCE
MCI: chain opening outer radius
MCE: chain opening inner radius
Pin Article number PG445

A (mm)	B (mm)	C (mm)	D (mm)	R (mm)	Weight (kg/m)	Article number
72	64	50	45	100-125-150-175-200-250-300	2.13	445AU050
83	64	61	45	100-125-150-175-200-250-300	2.24	445AU061
97	64	75	45	100-125-150-175-200-250-300	2.49	445AU075
103	64	81	45	100-125-150-175-200-250-300	2.59	445AU081
107	64	85	45	100-125-150-175-200-250-300	2.65	445AU085
117	64	95	45	100-125-150-175-200-250-300	2.79	445AU095
122	64	100	45	100-125-150-175-200-250-300	2.85	445AU100
129	64	107	45	100-125-150-175-200-250-300	2.95	445AU107
139	64	117	45	100-125-150-175-200-250-300	3.08	445AU117
147	64	125	45	100-125-150-175-200-250-300	3.24	445AU125
158	64	136	45	100-125-150-175-200-250-300	3.41	445AU136
172	64	150	45	100-125-150-175-200-250-300	3.61	445AU150
197	64	175	45	100-125-150-175-200-250-300	3.97	445AU175
222	64	200	45	100-125-150-175-200-250-300	4.35	445AU200
233	64	211	45	100-125-150-175-200-250-300	4.51	445AU211
247	64	225	45	100-125-150-175-200-250-300	4.73	445AU225
274	64	252	45	100-125-150-175-200-250-300	5.13	445AU252
283	64	261	45	100-125-150-175-200-250-300	5.26	445AU261
334	64	312	45	100-125-150-175-200-250-300	6.00	445AU312
356	64	334	45	100-125-150-175-200-250-300	6.33	445AU334
384	64	362	45	100-125-150-175-200-250-300	6.73	445AU362

□□□ to be filled with Radius R

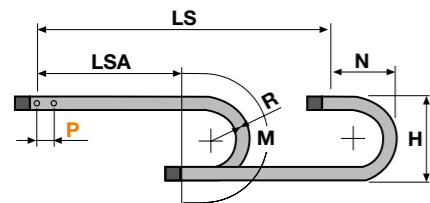

L=LSA + M or M1 Length of chain (L)= Half travel distance LSA plus length of curve (M) or (M1)

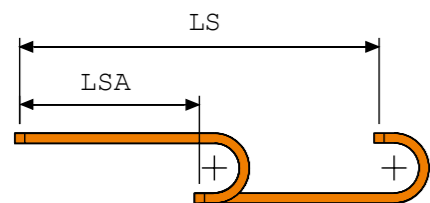

R	H	N	M
100	264	200	450
125	314	225	530
150	364	250	605
175	414	275	765
200	464	300	765
250	564	350	920
300	664	400	1080

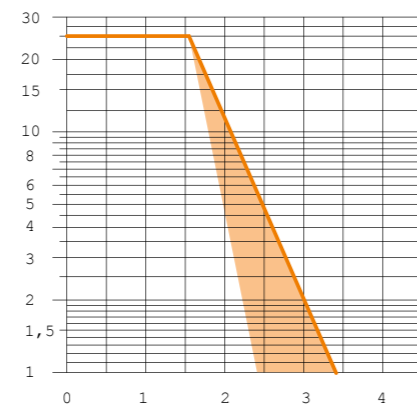

Self-Supporting Capacity Diagram
The maximum length of the self-supporting capacity LSA in relationship to the weight of the cables and hoses contained per metre.

The orange marking/area in the diagram considers the difference of weight between various widths of chain.

For applications with LSA and weights not included in the area of the diagram showing a self-supporting capacity, verify the possible use of support rollers (see page 41).

End brackets

The end brackets set allows the two ends of the chain to be attached to the equipment. Set complete with tiewrap clamps available on request.

Nylon Type

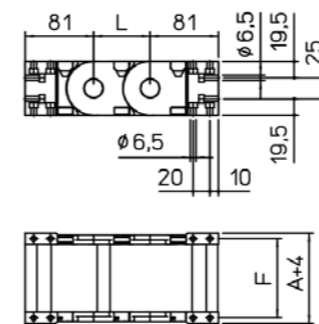
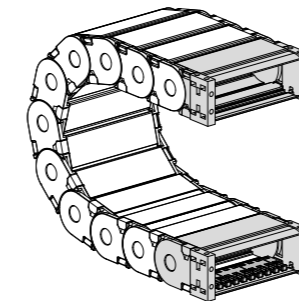

Nylon Type

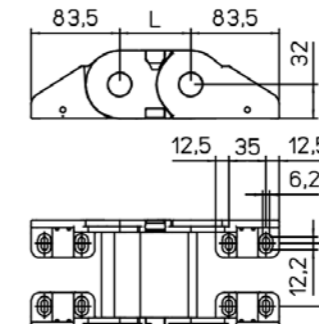
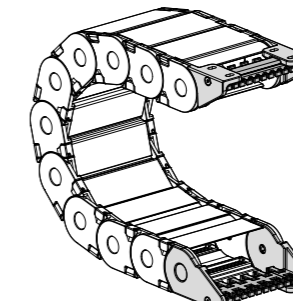

Steel Type

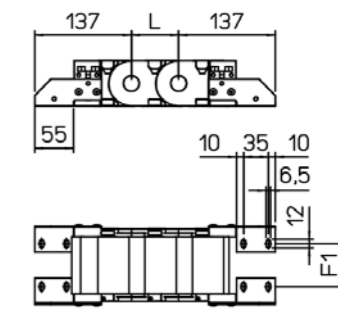
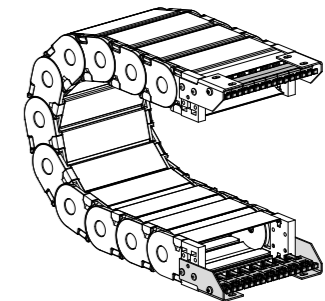

Chain Type	F1
445AU050	63
445AU061	74
445AU075	88
445AU081	94
445AU085	98
445AU095	108
445AU100	113
445AU107	120
445AU117	130
445AU125	138
445AU136	149
445AU150	163
445AU175	188
445AU200	213
445AU211	224
445AU225	238
445AU252	265
445AU261	274
445AU312	325
445AU334	347
445AU362	375

Nylon Type Part Numbers	
Complete Set Assembled	AN445A□□□KM
Complete Set Unassembled	AN445A□□□K
Tiewrap Clamp Part Numbers	
Complete Set Assembled	CFC445M□□□KM
Complete Set Unassembled	CFC445M□□□K

□□□ Inner width (C)

Chain Type	F1
445AU050	44
445AU061	55
445AU075	69
445AU081	75
445AU085	79
445AU095	89
445AU100	94
445AU107	101
445AU117	111
445AU125	119
445AU136	130
445AU150	144
445AU175	169
445AU200	194
445AU211	205
445AU225	219
445AU252	246
445AU261	255
445AU312	306
445AU334	328
445AU362	356

Nylon Type Part Numbers	
Complete Set Assembled	AN445KM□
Complete Set Unassembled	AN445K□
Tiewrap Clamp Part Numbers	
Complete Set Assembled	SFCT445M□□□KM
Complete Set Unassembled	SFCT445M□□□K

□□□ Inner width (C)

Possible mounting positions: 1/2/3/5/6 (acc. to page 33)

Chain Type	F1
445AU	F1=A-44

Steel Type Part Numbers	
Complete Set Assembled	A445A□□□KM
Complete Set Unassembled	A445A□□□K
Tiewrap Clamp Part Numbers	
Complete Set Assembled	CFC445M□□□KM
Complete Set Unassembled	CFC445M□□□K

□□□ Inner width (C)

Possible mounting positions: 1/2/3 (acc. to page 33)

SILVYN® CHAIN 445PS

Nylon cable chain with openable protection frames.

i Info

- Sliding version to be ordered with pivoting end bracket set.

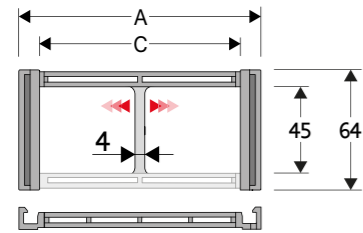

Technical data

- Inner Height (D)**
45 mm
- Pitch (P)**
67 mm
- Height Moving Point (W)**
140 mm
- Speed**
10 m/s
- Acceleration**
50 m/s²

Separator

- Unassembled Article number S445CNF
- Assembled Article number S445CNFMCI
- MCI: chain opening outer radius
- MCE: chain opening inner radius
- Pin** Article number PG445

A (mm)	B (mm)	C (mm)	D (mm)	R (mm)	Weight (kg/m)	Article number
83	64	61	45	100-125-150-175-200-250-300	1.87	445PS061□□□
97	64	75	45	100-125-150-175-200-250-300	2.05	445PS075□□□
147	64	125	45	100-125-150-175-200-250-300	2.49	445PS125□□□

□□□ to be filled with Radius R

L=LSA + M or M1 Length of chain (L)= Half travel distance LSA plus length of curve (M) or (M1)

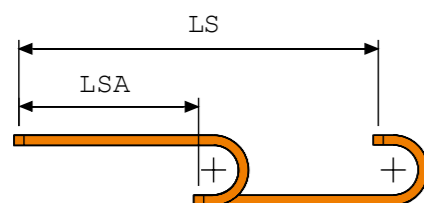
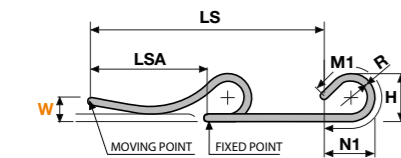
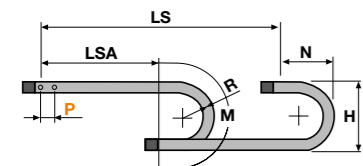

R	H	N	M	N1	M1
100	264	200	450	340	740
125	314	225	530	460	1020
150	364	250	605	580	1300
175	414	275	685	700	1575
200	464	300	765	820	1855
250	564	350	920	1055	2410
300	664	400	1080	1295	2970

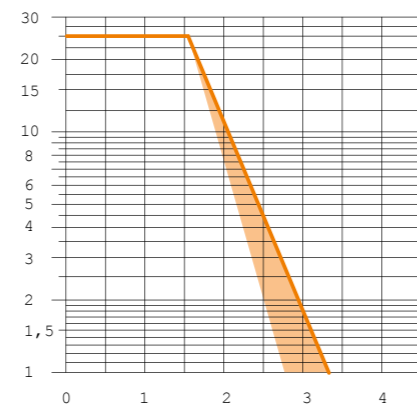

Self-Supporting Capacity Diagram

The maximum length of the self-supporting capacity LSA in relationship to the weight of the cables and hoses contained per metre.

The orange marking/area in the diagram considers the difference of weight between various widths of chain.

For applications with LSA and weights not included in the area of the diagram showing a self-supporting capacity, verify the possible use of support rollers (see page 41).

End brackets

The end brackets set allows the two ends of the chain to be attached to the equipment. Set complete with tiewrap clamps available on request.

Nylon Type

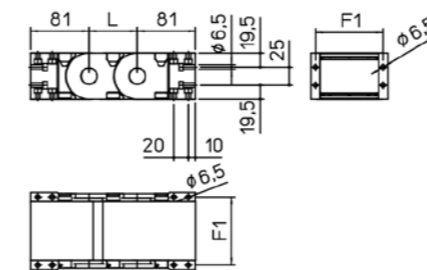
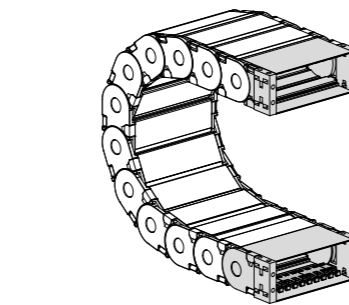

Nylon Type

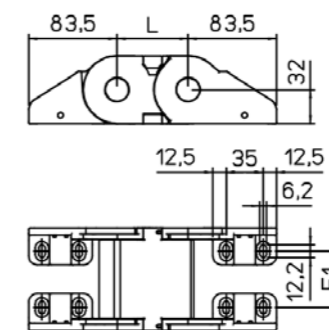
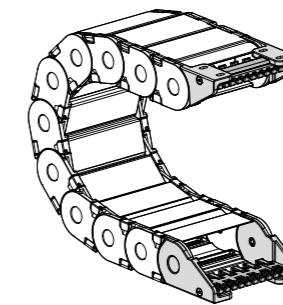

Chain Type	F1
445PS061	74
445PS075	88
445PS125	138

Nylon Type Part Numbers	
Complete Set Assembled	AN445P□□□KM
Complete Set Unassembled	AN445P□□□K

Tiewrap Clamp Part Numbers	
Complete Set Assembled	CFC445M□□□KM
Complete Set Unassembled	CFC445M□□□K

□□□ Inner width (C)

Chain Type	F1
445PS061	39
445PS075	53
445PS125	103

Nylon Type Part Numbers	
Complete Set Assembled	AN445KM□
Complete Set Unassembled	AN445K□

Tiewrap Clamp Part Numbers	
Complete Set Assembled	SFCT445□□□KM
Complete Set Unassembled	SFCT445□□□K

□□□ Inner width (C)

Possible mounting positions: 1/2/3/5/6 (acc. to page 33)

SILVYN® CHAIN 660A

Nylon Cable Chain with opening frames

i Info

- Sliding version to be ordered with pivoting end bracket set.

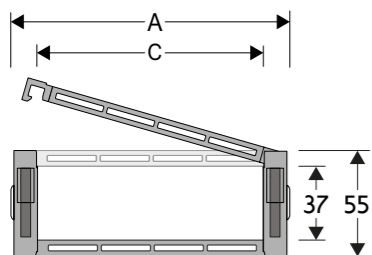

Technical data

- Inner Height (D)**
37 mm
- Pitch (P)**
50 mm
- Height Moving Point (W)**
200 mm
- Speed**
6 m/s
- Acceleration**
30 m/s²

Separator

Unassembled	Article number S660A
Assembled	Article number S660AMCI

MCI: chain opening outer radius
MCE: chain opening inner radius

Strong-hold separator for C > 200 mm

Unassembled	Article number S660AH
Assembled	Article number S660AHMC

Pin Article number PG660

A (mm)	B (mm)	C (mm)	D (mm)	R (mm)	Weight (kg/m)	Article number
75	55	50	37	100-150-200-250	1.51	660A050□□□
86	55	61	37	100-150-200-250	1.51	660A061□□□
100	55	75	37	100-150-200-250	1.59	660A075□□□
106	55	81	37	100-150-200-250	1.61	660A081□□□
120	55	95	37	100-150-200-250	1.66	660A095□□□
125	55	100	37	100-150-200-250	1.66	660A100□□□
132	55	107	37	100-150-200-250	1.69	660A107□□□
142	55	117	37	100-150-200-250	1.71	660A117□□□
150	55	125	37	100-150-200-250	1.76	660A125□□□
161	55	136	37	100-150-200-250	1.80	660A136□□□
175	55	150	37	100-150-200-250	1.84	660A150□□□
200	55	175	37	100-150-200-250	1.93	660A175□□□
225	55	200	37	100-150-200-250	2.02	660A200□□□
236	55	211	37	100-150-200-250	2.06	660A211□□□
250	55	225	37	100-150-200-250	2.11	660A225□□□
277	55	252	37	100-150-200-250	2.21	660A252□□□
286	55	261	37	100-150-200-250	2.24	660A261□□□
337	55	312	37	100-150-200-250	2.43	660A312□□□
359	55	334	37	100-150-200-250	2.52	660A334□□□
387	55	362	37	100-150-200-250	2.61	660A362□□□

□□□ to be filled with Radius R

L=LSA + M or M1 Length of chain (L)= Half travel distance LSA plus length of curve (M) or (M1)

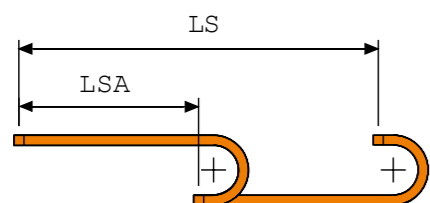
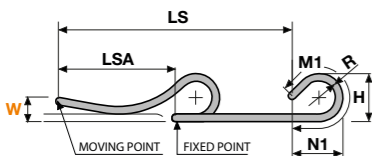
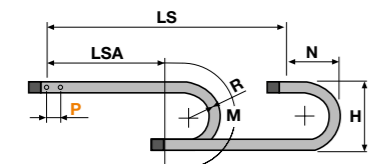

R	H	N	M	N1	M1
100	255	180	415	205	470
150	355	230	575	360	855
200	455	280	730	535	1290
250	555	330	885	705	1730

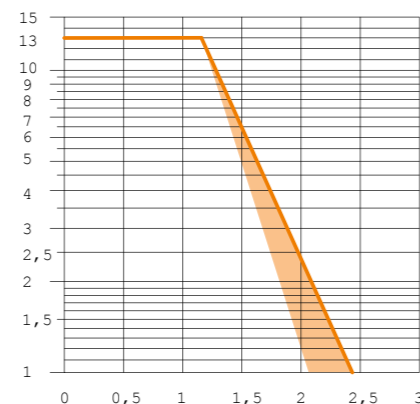

Self-Supporting Capacity Diagram

The maximum length of the self-supporting capacity LSA in relationship to the weight of the cables and hoses contained per metre.

The orange marking/area in the diagram considers the difference of weight between various widths of chain.

For applications with LSA and weights not included in the area of the diagram showing a self-supporting capacity, verify the possible use of support rollers (see page 41).

End brackets

The end brackets set allows the two ends of the chain to be attached to the equipment. Set complete with tiwrap clamps available on request.

Nylon Type

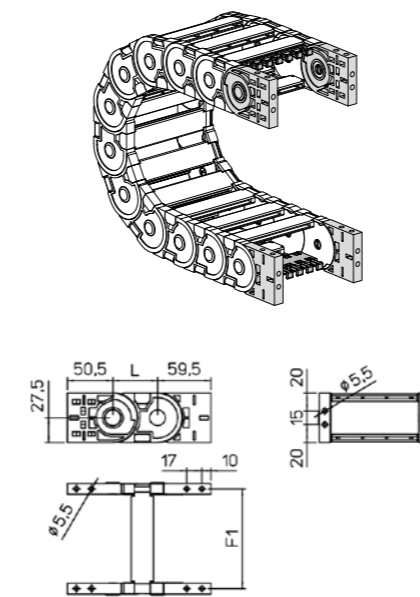

Steel Type

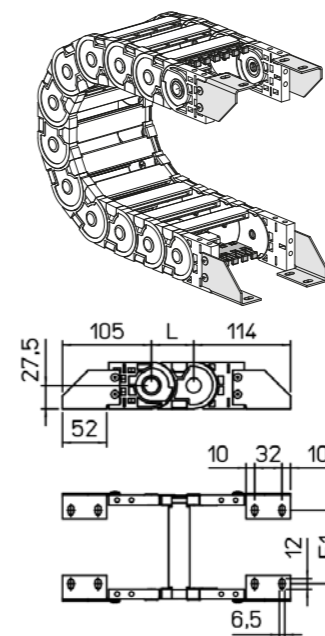

Chain Type	F1
660A050□□□	61
660A061□□□	72
660A075□□□	86
660A081□□□	92
660A095□□□	106
660A100□□□	111
660A107□□□	118
660A117□□□	128
660A125□□□	136
660A136□□□	147
660A150□□□	161
660A175□□□	186
660A200□□□	211
660A211□□□	222
660A225□□□	236
660A252□□□	263
660A261□□□	272
660A312□□□	323
660A334□□□	345
660A362□□□	373

Chain Type	F1
660A050□□□	38
660A061□□□	49
660A075□□□	63
660A081□□□	69
660A095□□□	83
660A100□□□	88
660A107□□□	95
660A117□□□	105
660A125□□□	113
660A136□□□	124
660A150□□□	138
660A175□□□	163
660A200□□□	188
660A211□□□	199
660A225□□□	213
660A252□□□	240
660A261□□□	249
660A312□□□	300
660A334□□□	322
660A362□□□	350

Nylon Type Part Numbers

Complete Set Assembled
AN660AKM
Complete Set Unassembled
AN660AK

Tiewrap Clamp Part Numbers

Complete Set Assembled
CFC660A□□□KM
Complete Set Unassembled
CFC660A□□□K

□□□ Inner width (C)

Steel Type Part Numbers

Complete Set Assembled
A660AKM□
Complete Set Unassembled
A660AK□

Tiewrap Clamp Part Numbers

Complete Set Assembled
CFC660A□□□KM
Complete Set Unassembled
CFC660A□□□K

□□□ Inner width (C)

Possible mounting positions: 1/2/3 (acc. to page 33)

SILVYN® CHAIN 660

Nylon cable chain with openable protection frames.

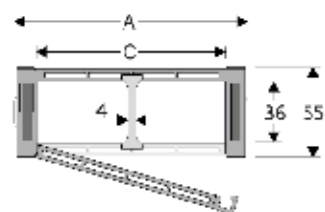

Technical data

- Inner Height (D)**
36 mm
- Pitch (P)**
50 mm
- Speed**
6 m/s
- Acceleration**
30 m/s²

Separator

Unassembled Article number S660A, S600
Assembled Article number S660MC, S600MC

MCI: chain opening outer radius
MCE: chain opening inner radius

A (mm)	B (mm)	C (mm)	D (mm)	R (mm)	Weight (kg/m)	Article number
79	55	50	36	100-150-200-250	1.90	660050□□
129	55	100	36	100-150-200-250	2.40	660100□□
179	55	150	36	100-150-200-250	3.00	600150□□

□□ to be filled with Radius R

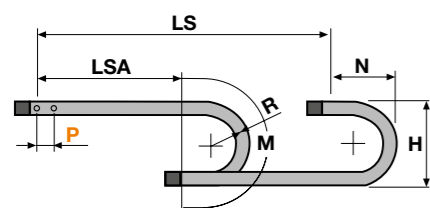

L=LSA + M or M1 Length of chain (L)=
Half travel distance LSA
plus length of curve (M)
or (M1)

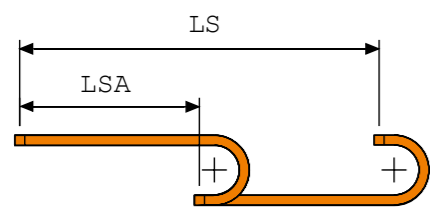

R	H	N	M
100	255	180	415
150	355	230	575
200	455	280	730
250	555	330	885

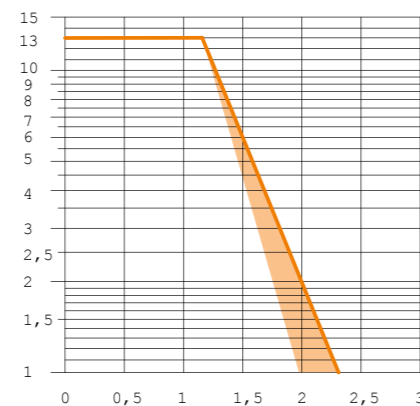

Self-Supporting Capacity Diagram

The maximum length of the self-supporting capacity LSA in relationship to the weight of the cables and hoses contained per metre.

The orange marking/area in the diagram considers the difference of weight between various widths of chain.

For applications with LSA and weights not included in the area of the diagram showing a self-supporting capacity, verify the possible use of support rollers (see page 41).

End brackets

The end brackets set allows the two ends of the chain to be attached to the equipment. Set complete with tiewrap clamps available on request.

Nylon Type

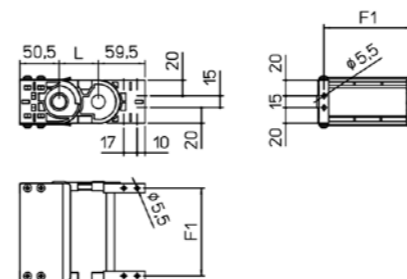
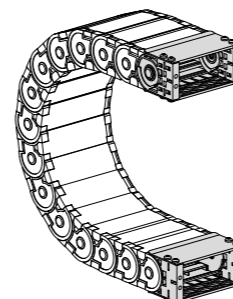

Chain Type	F1
660050	62
660100	112
600150	162

Nylon Type Part Numbers

Complete Set Assembled

660050 = AN660050KM

660100 = AN660100KM

600150 = AL600KM

Complete Set Unassembled

660050 = AN660050K

660100 = AN660100K

600150 = AL600K

□□ Inner width (C)

SILVYN® CHAIN 770A

Nylon Cable Chain with opening frames

i Info

- Sliding version to be ordered with pivoting end bracket set.

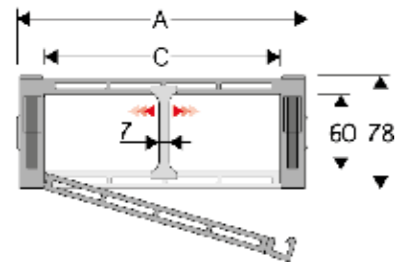

Technical data

- Inner Height (D)**
60 mm
- Pitch (P)**
70 mm
- Height Moving Point (W)**
250 mm
- Speed**
6 m/s
- Acceleration**
30 m/s²

Separator

- Unassembled Article number S770A
- Assembled Article number S770AMC
- MCI: chain opening outer radius
- MCE: chain opening inner radius

Strong-hold separator for C > 200 mm

- Unassembled Article number S770AH
- Assembled Article number S770AHMC
- Pin Article number PG770

A (mm)	B (mm)	C (mm)	D (mm)	R (mm)	Weight (kg/m)	Article number
80	78	45	60	130-150-200-250-300	2.25	770A045□□□
91	78	56	60	130-150-200-250-300	2.25	770A056□□□
105	78	70	60	130-150-200-250-300	2.31	770A070□□□
111	78	76	60	130-150-200-250-300	2.32	770A076□□□
125	78	90	60	130-150-200-250-300	2.36	770A090□□□
130	78	95	60	130-150-200-250-300	2.36	770A095□□□
137	78	102	60	130-150-200-250-300	2.38	770A102□□□
147	78	112	60	130-150-200-250-300	2.39	770A112□□□
155	78	120	60	130-150-200-250-300	2.43	770A120□□□
166	78	131	60	130-150-200-250-300	2.46	770A131□□□
180	78	145	60	130-150-200-250-300	2.49	770A145□□□
205	78	170	60	130-150-200-250-300	2.55	770A170□□□
230	78	195	60	130-150-200-250-300	2.62	770A195□□□
241	78	206	60	130-150-200-250-300	2.65	770A206□□□
255	78	220	60	130-150-200-250-300	2.68	770A220□□□
282	78	247	60	130-150-200-250-300	2.75	770A247□□□
291	78	256	60	130-150-200-250-300	2.77	770A256□□□
342	78	307	60	130-150-200-250-300	2.88	770A307□□□
364	78	329	60	130-150-200-250-300	2.94	770A329□□□
392	78	357	60	130-150-200-250-300	3.01	770A357□□□

□□□ to be filled with Radius R

L=LSA + M or M1 Length of chain (L)= Half travel distance LSA plus length of curve (M) or (M1)

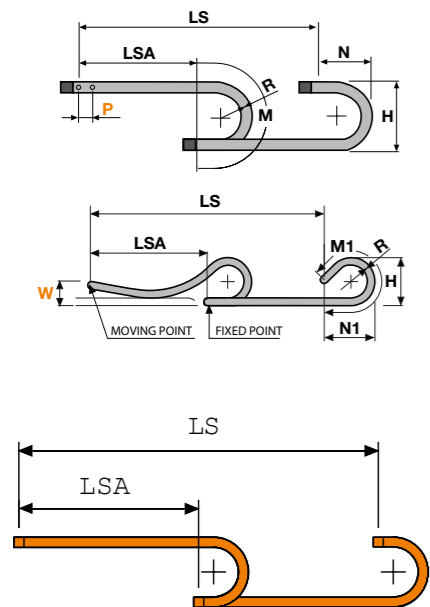

R	H	N	M	N1	M1
130	338	240	555	305	685
150	378	260	615	340	785
200	478	310	770	515	1220
250	578	365	930	690	1660
300	678	410	1085	865	2095

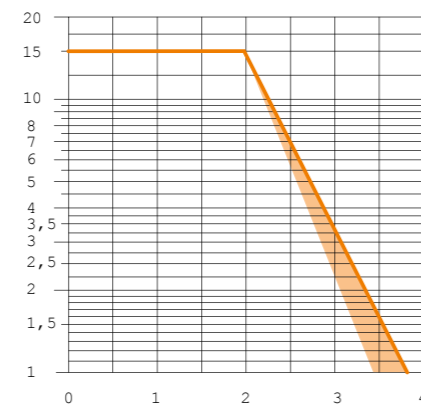

Self-Supporting Capacity Diagram
The maximum length of the self-supporting capacity LSA in relationship to the weight of the cables and hoses contained per metre.

The orange marking/area in the diagram considers the difference of weight between various widths of chain.

For applications with LSA and weights not included in the area of the diagram showing a self-supporting capacity, verify the possible use of support rollers (see page 41).

End brackets

The end brackets set allows the two ends of the chain to be attached to the equipment. Set complete with tiwrap clamps available on request.

Nylon Type

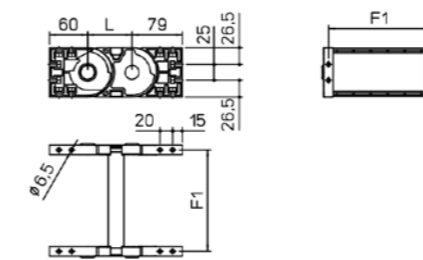
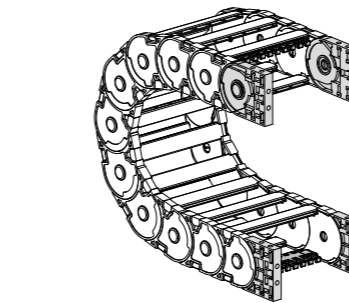

Steel Type

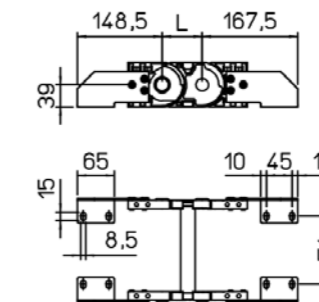
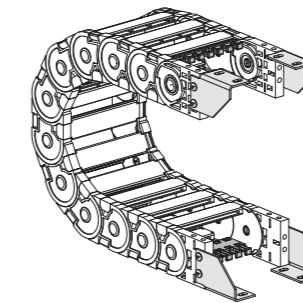

Chain Type	F1
770A045□□□	61
770A056□□□	72
770A070□□□	86
770A076□□□	92
770A090□□□	106
770A095□□□	111
770A102□□□	118
770A112□□□	128
770A120□□□	136
770A131□□□	147
770A145□□□	161
770A170□□□	186
770A195□□□	211
770A206□□□	222
770A220□□□	236
770A247□□□	263
770A256□□□	272
770A307□□□	323
770A329□□□	345
770A357□□□	373

Chain Type	F1
770A045□□□	19
770A056□□□	30
770A070□□□	44
770A076□□□	50
770A090□□□	64
770A095□□□	69
770A102□□□	76
770A112□□□	86
770A120□□□	94
770A131□□□	105
770A145□□□	119
770A170□□□	144
770A195□□□	169
770A206□□□	180
770A220□□□	194
770A247□□□	221
770A256□□□	230
770A307□□□	281
770A329□□□	303
770A357□□□	331

Nylon Type Part Numbers

- Complete Set Assembled AN770AKM
- Complete Set Unassembled AN770AK

Tiewrap Clamp Part Numbers

- Complete Set Assembled CFC770A□□□KM
- Complete Set Unassembled CFC770A□□□K

□□□ Inner width (C)

Steel Type Part Numbers

- Complete Set Assembled A660AKM□
- Complete Set Unassembled A660AK□

Tiewrap Clamp Part Numbers

- Complete Set Assembled CFC660A□□□KM
- Complete Set Unassembled CFC660A□□□K

□□□ Inner width (C)
Possible mounting positions: 1/2/3 (acc. to page 33)

SILVYN® CHAIN 770

Nylon cable chain with openable protection frames.

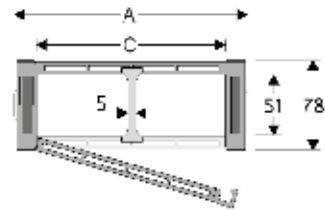

Technical data

- Inner Height (D)**
51 mm
- Pitch (P)**
70 mm
- Speed**
6 m/s
- Acceleration**
30 m/s²

Separator

Unassembled	Article number S770, S700
Assembled	Article number S770 MC, S700MC

MCI: chain opening outer radius
MCE: chain opening inner radius

A (mm)	B (mm)	C (mm)	D (mm)	R (mm)	Weight (kg/m)	Article number
120	78	85	51	150-200-250-300	3.30	770085□□
135	78	100	51	150-200-250-300	3.90	770100□□
185	78	150	51	150-200-250-300	4.10	770150□□
235	78	200	51	150-200-250-300	4.50	770200□□
285	78	250	51	150-200-250-300	5.00	700250□□

□□ to be filled with Radius R

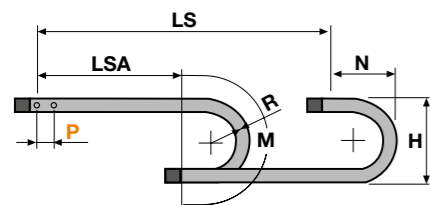

L=LSA + M or M1 Length of chain (L)= Half travel distance LSA plus length of curve (M) or (M1)

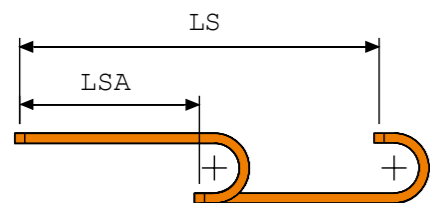

R	H	N	M
150	378	260	615
200	478	310	770
250	578	365	930
300	678	410	1085

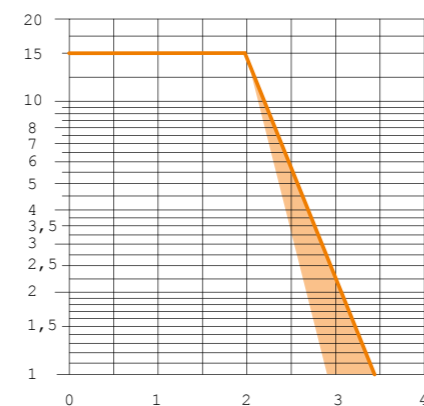

Self-Supporting Capacity Diagram

The maximum length of the self-supporting capacity LSA in relationship to the weight of the cables and hoses contained per metre.

The orange marking/area in the diagram considers the difference of weight between various widths of chain.

For applications with LSA and weights not included in the area of the diagram showing a self-supporting capacity, verify the possible use of support rollers (see page 41).

End brackets

The end brackets set allows the two ends of the chain to be attached to the equipment. Set complete with tiewrap clamps available on request.

Nylon Type

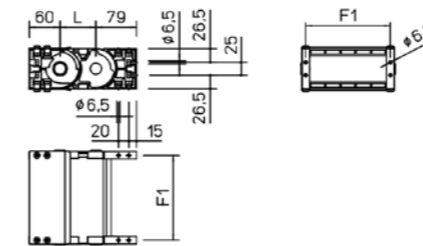
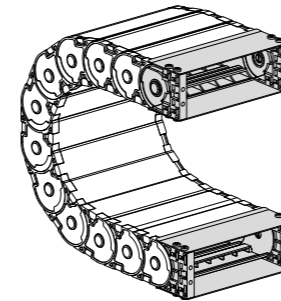

Chain Type	F1
770085	100
770100	115
770150	165
770200	215
70025	265

Nylon Type Part Numbers

Complete Set Assembled

770□□□ = AN770□□□KM

70025 = AL700KM

Complete Set Unassembled

770□□□ = AN770□□□K

70025 = AL700K

□□ Inner width (C)

SILVYN® CHAIN 475MU

Nylon Cable Chain with opening frames

i Info

- Sliding version to be ordered with pivoting end bracket set.

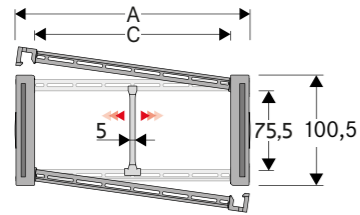

Technical data

	Inner Height (D) 75,5 mm
	Pitch (P) 105 mm
	Speed 8 m/s
	Acceleration 40 m/s ²

Separator

Unassembled	Article number S309S
Assembled	Article number S309SMCI, S309SMCE

MCI: chain opening outer radius
MCE: chain opening inner radius

Strong-hold separator for C > 200 mm

Unassembled	Article number S309HOFL
Assembled	Article number S309HOFLMC

Pin Article number PG475

A (mm)	B (mm)	C (mm)	D (mm)	R (mm)	Weight (kg/m)	Article number
112	100.5	74	75.5	150-180-200-250-300-350-400	3.70	475MU074□□□
132	100.5	94	75.5	150-180-200-250-300-350-400	3.80	475MU094□□□
157	100.5	119	75.5	150-180-200-250-300-350-400	3.85	475MU119□□□
164	100.5	126	75.5	150-180-200-250-300-350-400	3.90	475MU126□□□
187	100.5	149	75.5	150-180-200-250-300-350-400	3.95	475MU149□□□
227	100.5	189	75.5	150-180-200-250-300-350-400	4.05	475MU189□□□
262	100.5	224	75.5	150-180-200-250-300-350-400	4.15	475MU224□□□
288	100.5	250	75.5	150-180-200-250-300-350-400	4.25	475MU250□□□
312	100.5	274	75.5	150-180-200-250-300-350-400	4.30	475MU274□□□
338	100.5	300	75.5	150-180-200-250-300-350-400	4.37	475MU300□□□
362	100.5	324	75.5	150-180-200-250-300-350-400	4.45	475MU324□□□
388	100.5	350	75.5	150-180-200-250-300-350-400	4.55	475MU350□□□
412	100.5	374	75.5	150-180-200-250-300-350-400	4.60	475MU374□□□
467	100.5	429	75.5	150-180-200-250-300-350-400	4.80	475MU429□□□
536	100.5	498	75.5	150-180-200-250-300-350-400	5.00	475MU498□□□

□□□ to be filled with Radius R

L=LSA + M or M1 Length of chain (L)= Half travel distance LSA plus length of curve (M) or (M1)

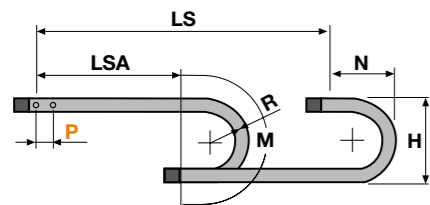

R	H	N	M
150	400.5	310	690
180	460.5	335	775
200	500.5	355	840
250	600.5	405	995
300	700.5	460	1155
350	800.5	505	1310
400	900.5	560	1470

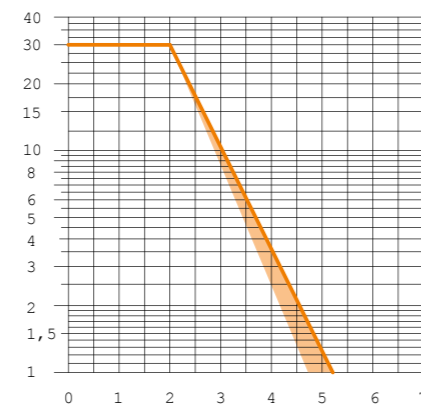
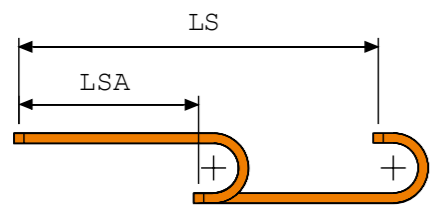

Self-Supporting Capacity Diagram
The maximum length of the self-supporting capacity LSA in relationship to the weight of the cables and hoses contained per metre.

The orange marking/area in the diagram considers the difference of weight between various widths of chain.

For applications with LSA and weights not included in the area of the diagram showing a self-supporting capacity, verify the possible use of support rollers (see page 41).

End brackets

The end brackets set allows the two ends of the chain to be attached to the equipment. Set complete with tiwrap clamps available on request.

Steel Type

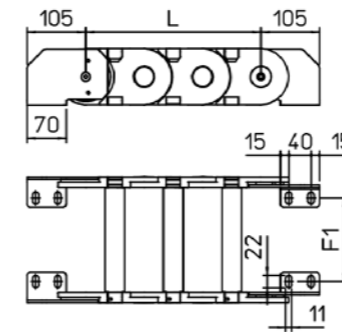
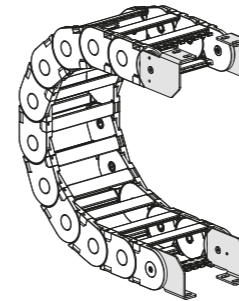

Chain Type	F1
475MU074□□□	35
475MU094□□□	55
475MU119□□□	80
475MU126□□□	87
475MU149□□□	110
475MU189□□□	150
475MU224□□□	185
475MU250□□□	211
475MU274□□□	235
475MU300□□□	261
475MU324□□□	285
475MU350□□□	311
475MU374□□□	335
475MU429□□□	390
475MU498□□□	459

Steel Type Part Numbers

Complete Set Assembled	A475M□□□KM
Complete Set Unassembled	A475M□□□K□

Tiewrap Clamp Part Numbers

Complete Set Assembled	CFC475M□□□KM
Complete Set Unassembled	CFC475M□□□K

□□□ Inner width (C)
Possible mounting positions: 1/2/3 (acc. to page 33)

SILVYN® CHAIN 475PU

Nylon cable chain with openable protection frames.

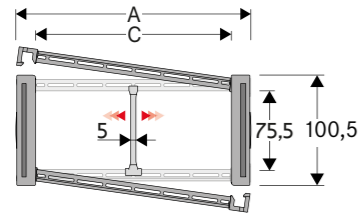

Technical data

- Inner Height (D)**
75,5 mm
- Pitch (P)**
105 mm
- Speed**
8 m/s
- Acceleration**
40 m/s²

Separator
Unassembled Article number S309S
Assembled Article number S309SMCI, S309SMCE

MCI: chain opening outer radius
MCE: chain opening inner radius

Pin Article number PG475

A (mm)	B (mm)	C (mm)	D (mm)	R (mm)	Weight (kg/m)	Article number
112	100.5	74	75.5	180-200-250-300-350-400	4.60	475PU074□□□
132	100.5	94	75.5	180-200-250-300-350-400	4.80	475PU094□□□
157	100.5	119	75.5	180-200-250-300-350-400	5.10	475PU119□□□
164	100.5	126	75.5	180-200-250-300-350-400	5.15	475PU126□□□
187	100.5	149	75.5	180-200-250-300-350-400	5.40	475PU149□□□
227	100.5	189	75.5	180-200-250-300-350-400	5.80	475PU189□□□
262	100.5	224	75.5	180-200-250-300-350-400	6.20	475PU224□□□
288	100.5	250	75.5	180-200-250-300-350-400	6.50	475PU250□□□
312	100.5	274	75.5	180-200-250-300-350-400	6.75	475PU274□□□
338	100.5	300	75.5	180-200-250-300-350-400	7.05	475PU300□□□
362	100.5	324	75.5	180-200-250-300-350-400	7.30	475PU324□□□
388	100.5	350	75.5	180-200-250-300-350-400	7.55	475PU350□□□
412	100.5	374	75.5	180-200-250-300-350-400	7.85	475PU374□□□
467	100.5	429	75.5	180-200-250-300-350-400	8.50	475PU429□□□
536	100.5	498	75.5	180-200-250-300-350-400	9.20	475PU498□□□

□□□ to be filled with Radius R

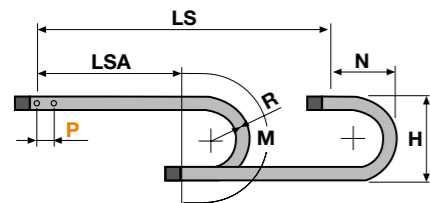

R	H	N	M
180	460.5	335	775
200	500.5	355	840
250	600.5	405	995
300	700.5	460	1155
350	800.5	505	1310
400	900.5	560	1470

L=LSA + M or M1 Length of chain (L)= Half travel distance LSA plus length of curve (M) or (M1)

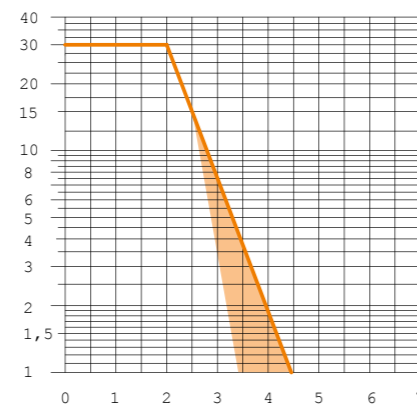
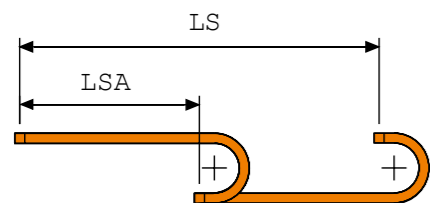

Self-Supporting Capacity Diagram

The maximum length of the self-supporting capacity LSA in relationship to the weight of the cables and hoses contained per metre.

The orange marking/area in the diagram considers the difference of weight between various widths of chain.

For applications with LSA and weights not included in the area of the diagram showing a self-supporting capacity, verify the possible use of support rollers (see page 41).

End brackets

The end brackets set allows the two ends of the chain to be attached to the equipment. Set complete with tiewrap clamps available on request.

Steel Type

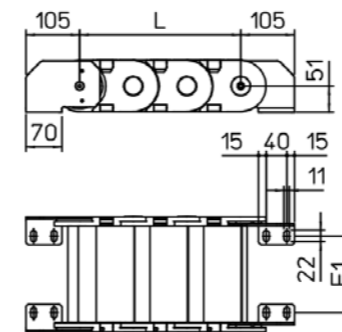
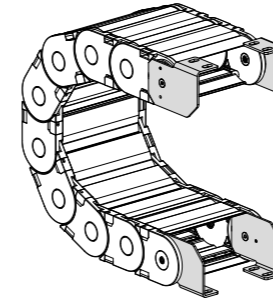

Chain Type	F1
475PU074□□□	35
475PU094□□□	55
475PU119□□□	80
475PU126□□□	87
475PU149□□□	110
475PU189□□□	150
475PU224□□□	185
475PU250□□□	211
475PU274□□□	235
475PU300□□□	261
475PU324□□□	285
475PU350□□□	311
475PU374□□□	335
475PU429□□□	390
475PU498□□□	459

Steel Type Part Numbers

Complete Set Assembled

A475P□□□KM

Complete Set Unassembled

A475P□□□K□

□□□ Inner width (C)

Possible mounting positions: 1/2/3 (acc. to page 33)

SILVYN® CHAIN 306SU

Nylon Cable Chain with opening frames

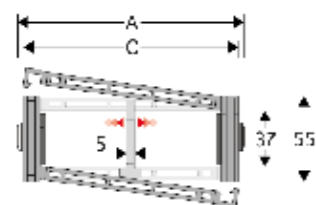

i Info

- Strong double share Sideband & Frame construction with large anti-friction triple-pin. Frames opening from inner and outer radius.

Technical data

- Inner Height (D)**
37 mm
- Pitch (P)**
65 mm
- Speed**
8 m/s
- Acceleration**
40 m/s²

Separator

- Unassembled Article number S660A
- Assembled Article number S660AMCI, S660AMCE

MCI: chain opening outer radius
MCE: chain opening inner radius

Strong-hold separator for C > 200 mm

- Unassembled Article number S660AH
- Assembled Article number S660AHMCI, S660AHMCE

Pin Article number PG307

A (mm)	B (mm)	C (mm)	D (mm)	R (mm)	Weight (kg/m)	Article number
79	55	43	37	075-107-150-200-250-300	1.61	306SU043
90	55	54	37	075-107-150-200-250-300	1.61	306SU054
104	55	68	37	075-107-150-200-250-300	1.68	306SU068
110	55	74	37	075-107-150-200-250-300	1.70	306SU074
124	55	88	37	075-107-150-200-250-300	1.74	306SU088
129	55	93	37	075-107-150-200-250-300	1.74	306SU093
136	55	100	37	075-107-150-200-250-300	1.76	306SU100
146	55	110	37	075-107-150-200-250-300	1.77	306SU110
154	55	118	37	075-107-150-200-250-300	1.82	306SU118
165	55	129	37	075-107-150-200-250-300	1.85	306SU129
179	55	143	37	075-107-150-200-250-300	1.89	306SU143
204	55	168	37	075-107-150-200-250-300	1.96	306SU168
229	55	193	37	075-107-150-200-250-300	2.04	306SU193
240	55	204	37	075-107-150-200-250-300	2.07	306SU204
254	55	218	37	075-107-150-200-250-300	2.11	306SU218
281	55	245	37	075-107-150-200-250-300	2.19	306SU245
290	55	254	37	075-107-150-200-250-300	2.22	306SU254
341	55	305	37	075-107-150-200-250-300	2.34	306SU305
363	55	327	37	075-107-150-200-250-300	2.41	306SU327
391	55	355	37	075-107-150-200-250-300	2.49	306SU355

□□□ to be filled with Radius R

R	H	N	M
075	208	170	370
107	272	205	470
150	358	245	605
200	458	295	760
250	558	345	920
300	658	395	1075

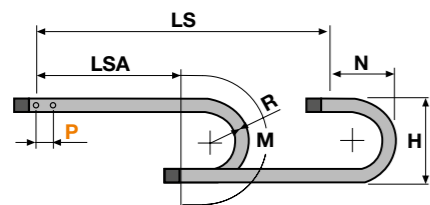

L=LSA + M or M1 Length of chain (L)= Half travel distance LSA plus length of curve (M) or (M1)

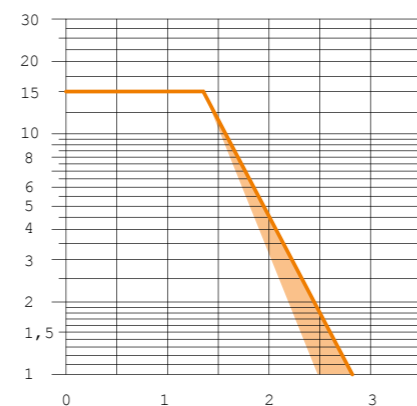
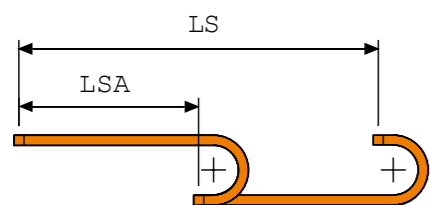

Self-Supporting Capacity Diagram

The maximum length of the self-supporting capacity LSA in relationship to the weight of the cables and hoses contained per metre.

The orange marking/area in the diagram considers the difference of weight between various widths of chain.

For applications with LSA and weights not included in the area of the diagram showing a self-supporting capacity, verify the possible use of support rollers (see page 41).

End brackets

The end brackets set allows the two ends of the chain to be attached to the equipment. Set complete with tiewrap clamps available on request.

Nylon Type

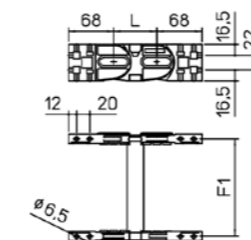
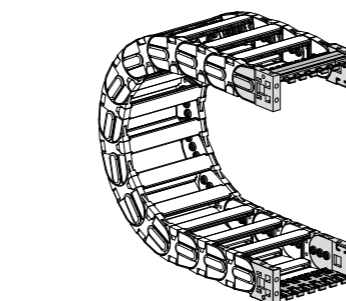

Chain Type	F1
306SU043	61
306SU054	72
306SU068	86
306SU074	92
306SU078	96
306SU088	106
306SU093	111
306SU100	118
306SU110	128
306SU118	136
306SU129	147
306SU143	161
306SU168	186
306SU193	211
306SU204	222
306SU218	236
306SU245	263
306SU254	272
306SU305	323
306SU327	345
306SU355	373

Nylon Type Part Numbers

- Complete Set Assembled AN306KM
- Complete Set Unassembled AN306K

Tiewrap Clamp Part Numbers

- Complete Set Assembled CFC306S□□□KM
- Complete Set Unassembled CFC306S□□□K

□□□ Inner width (C)

Nylon Type

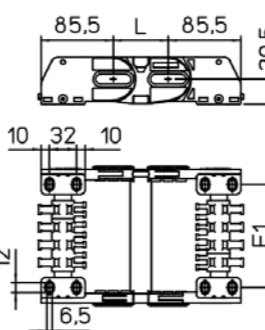
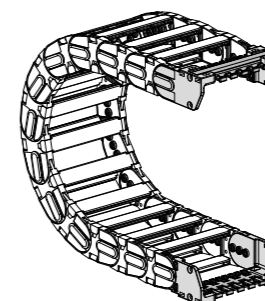

Chain Type	F1
306SU043	36
306SU054	47
306SU068	61
306SU074	67
306SU078	71
306SU088	81
306SU093	86
306SU100	93
306SU110	103
306SU118	111
306SU129	122
306SU143	136
306SU168	161
306SU193	186
306SU204	197
306SU218	211
306SU245	238
306SU254	247
306SU305	298
306SU327	320
306SU355	348

Nylon Type Part Numbers

- Complete Set Assembled ANL306KM□
- Complete Set Unassembled ANL306K□

Tiewrap Clamp Part Numbers

- Complete Set Assembled SFCTL306S□□□KM
- Complete Set Unassembled SFCTL306S□□□K

□□□ Inner width (C)

Steel Type

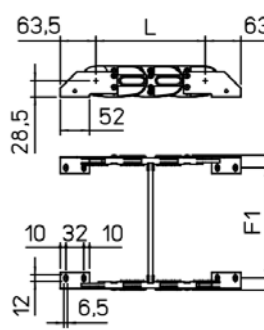
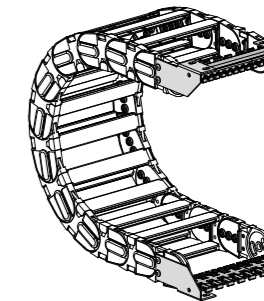

Chain Type	F1
306SU	F1=A-43

Steel Type Part Numbers

- Complete Set Assembled A306SKM
- Complete Set Unassembled AN306SK

Tiewrap Clamp Part Numbers

- Complete Set Assembled SFCT306S□□□KM
- Complete Set Unassembled SFCT306S□□□K

□□□ Inner width (C)
Possible mounting positions: 1/2/3 (acc. to page 33)

SILVYN® CHAIN 306CU

Nylon Protection Cable Chain with opening aluminium covers

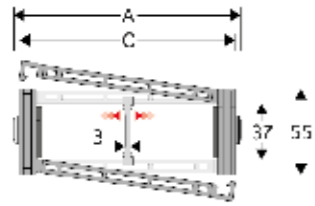

Technical data

- Inner Height (D)**
37 mm
- Pitch (P)**
65 mm
- Speed**
8 m/s
- Acceleration**
40 m/s²

Separator

Unassembled	Article number S306SM
Assembled	Article number S306SMC

MCI: chain opening outer radius
MCE: chain opening inner radius

Pin Article number PG307

A (mm)	B (mm)	C (mm)	D (mm)	R (mm)	Weight (kg/m)	Article number
79	55	43	37	107-150-200-250-300	1.85	306CU043
90	55	54	37	107-150-200-250-300	1.90	306CU054
104	55	68	37	107-150-200-250-300	2.04	306CU068
110	55	74	37	107-150-200-250-300	2.09	306CU074
124	55	88	37	107-150-200-250-300	2.20	306CU088
129	55	93	37	107-150-200-250-300	2.22	306CU093
136	55	100	37	107-150-200-250-300	2.27	306CU100
146	55	110	37	107-150-200-250-300	2.33	306CU110
154	55	118	37	107-150-200-250-300	2.42	306CU118
165	55	129	37	107-150-200-250-300	2.50	306CU129
179	55	143	37	107-150-200-250-300	2.61	306CU143
204	55	168	37	107-150-200-250-300	2.80	306CU168
229	55	193	37	107-150-200-250-300	3.00	306CU193
240	55	204	37	107-150-200-250-300	3.08	306CU204
254	55	218	37	107-150-200-250-300	3.19	306CU218
281	55	245	37	107-150-200-250-300	3.40	306CU245
290	55	254	37	107-150-200-250-300	3.47	306CU254
341	55	305	37	107-150-200-250-300	3.84	306CU305
363	55	327	37	107-150-200-250-300	4.01	306CU327
391	55	355	37	107-150-200-250-300	4.22	306CU355

□□ to be filled with Radius R

R	H	N	M
107	272	205	470
150	358	245	605
200	458	295	760
250	558	345	920
300	658	395	1075

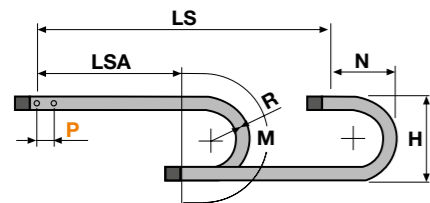

L=LSA + M or M1 Length of chain (L)= Half travel distance LSA plus length of curve (M) or (M1)

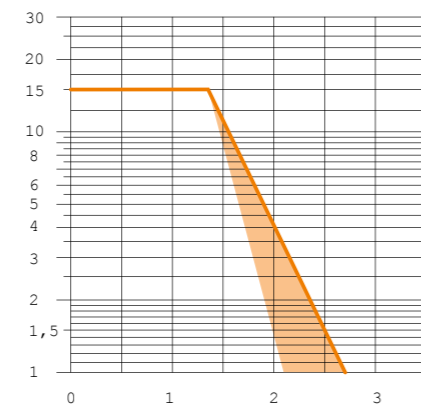
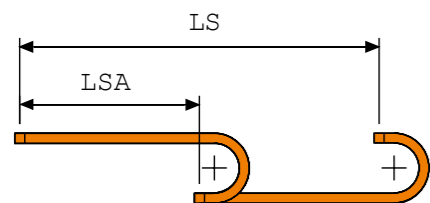

Self-Supporting Capacity Diagram
The maximum length of the self-supporting capacity LSA in relationship to the weight of the cables and hoses contained per metre.

The orange marking/area in the diagram considers the difference of weight between various widths of chain.

For applications with LSA and weights not included in the area of the diagram showing a self-supporting capacity, verify the possible use of support rollers (see page 41).

End brackets

The end brackets set allows the two ends of the chain to be attached to the equipment. Set complete with tiewrap clamps available on request.

Nylon Type

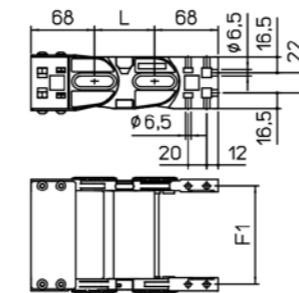
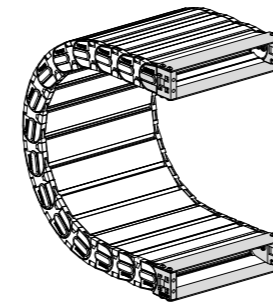

Chain Type	F1
306CU043	61
306CU054	72
306CU068	86
306CU074	92
306CU078	96
306CU088	106
306CU093	111
306CU100	118
306CU110	128
306CU118	136
306CU129	147
306CU143	161
306CU168	186
306CU193	211
306CU204	222
306CU218	236
306CU245	263
306CU254	272
306CU305	323
306CU327	345
306CU355	373

Nylon Type Part Numbers

Complete Set Assembled	AN306C□□□KM
Complete Set Unassembled	AN306C□□□K

□□ Inner width (C)

Nylon Type

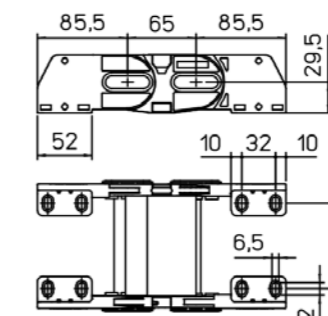
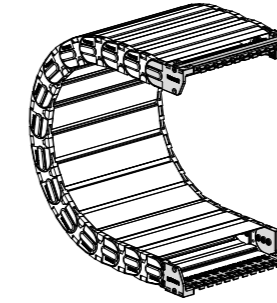

Chain Type	F1
306CU043	36
306CU054	47
306CU068	61
306CU074	67
306CU078	71
306CU088	81
306CU093	86
306CU100	93
306CU110	103
306CU118	111
306CU129	122
306CU143	136
306CU168	161
306CU193	186
306CU204	197
306CU218	211
306CU245	238
306CU254	247
306CU305	298
306CU327	320
306CU355	348

Nylon Type Part Numbers

Complete Set Assembled	ANL306KM
Complete Set Unassembled	ANL306K

Tiewrap Clamp Part Numbers

Complete Set Assembled	SFCTL306S□□□KM
Complete Set Unassembled	SFCTL306S□□□K

□□ Inner width (C)

Steel Type

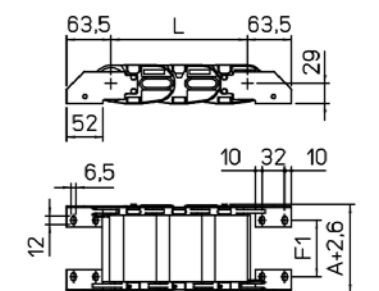
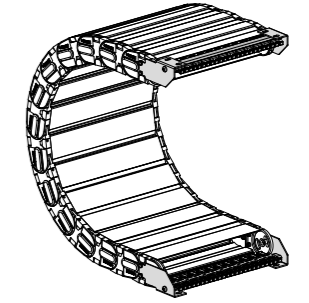

Chain Type	F1
306CU	F1=A-43

Steel Type Part Numbers

Complete Set Assembled	A306C□□□KM□
Complete Set Unassembled	A306C□□□K□

Tiewrap Clamp Part Numbers

Complete Set Assembled	SFCTL306CU□□□KM
Complete Set Unassembled	SFCTL306CU□□□K

□□ Inner width (C)
Possible mounting positions: 1/2/3 (acc. to page 33)

SILVYN® CHAIN 306B

Nylon Cable Chain with un-screwable aluminium rods

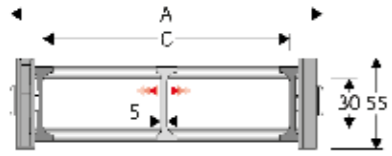

Technical data

- Inner Height (D)**
30 mm
- Pitch (P)**
65 mm
- Speed**
8 m/s
- Acceleration**
40 m/s²

A (mm)	B (mm)	C (mm)	D (mm)	R (mm)	Weight (kg/m)	Article number
115	55	75	30	075-107-150-200-250-300	1.60	306B075□
140	55	100	30	075-107-150-200-250-300	1.65	306B100□
190	55	150	30	075-107-150-200-250-300	1.80	306B150□
240	55	200	30	075-107-150-200-250-300	1.90	306B200□
290	55	250	30	075-107-150-200-250-300	2.00	306B250□
340	55	300	30	075-107-150-200-250-300	2.15	306B300□
C+40	55	...	30	075-107-150-200-250-300	...	306B□□□□

□□□ to be filled with Radius R

Separator

- Unassembled Article number S2000F
- Assembled Article number S2000FMC
- MCI: chain opening outer radius
- MCE: chain opening inner radius
- Pin Article number PG307

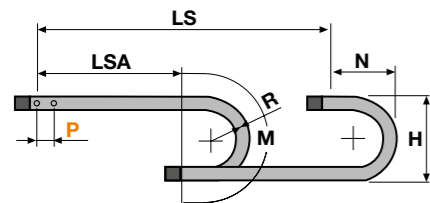

R	H	N	M
075	208	170	370
107	272	205	470
150	358	245	605
200	458	295	760
250	558	345	920
300	658	395	1075

L=LSA + M or M1 Length of chain (L)= Half travel distance LSA plus length of curve (M) or (M1)

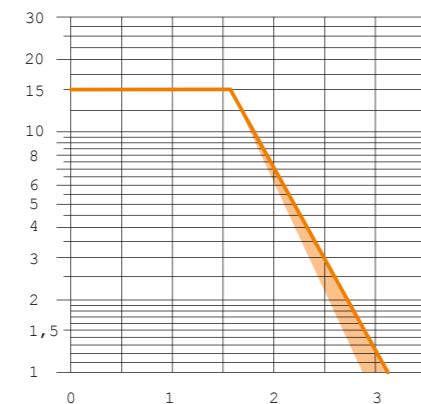
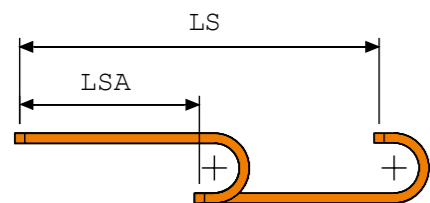

Self-Supporting Capacity Diagram

The maximum length of the self-supporting capacity LSA in relationship to the weight of the cables and hoses contained per metre.

The orange marking/area in the diagram considers the difference of weight between various widths of chain.

For applications with LSA and weights not included in the area of the diagram showing a self-supporting capacity, verify the possible use of support rollers (see page 41).

End brackets

The end brackets set allows the two ends of the chain to be attached to the equipment. Set complete with tiwrap clamps available on request.

Nylon Type

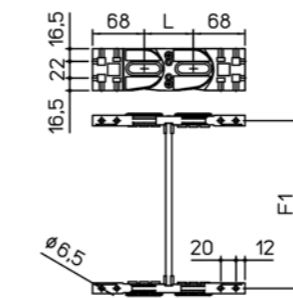
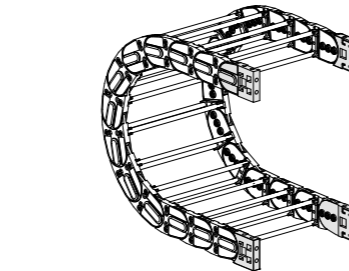

Chain Type	F1
306B075	96
306B100	121
306B150	171
306B200	221
306B250	271
306B300	321
306B□□□	F=A-19

Nylon Type Part Numbers	
Complete Set Assembled	AN306KM
Complete Set Unassembled	AN306K
Tiewrap Clamp Part Numbers	
Complete Set Assembled	CFC306S□□□KM
Complete Set Unassembled	CFC306S□□□K

□□□ Inner width (C)

Nylon Type

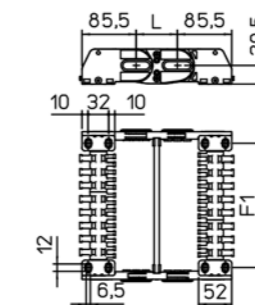
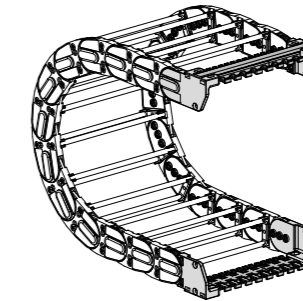

Chain Type	F1
306B075	71
306B100	96
306B150	146
306B200	196
306B250	246
306B300	296
306B□□□	F=A-44

Nylon Type Part Numbers	
Complete Set Assembled	ANL306KM□
Complete Set Unassembled	ANL306K□
Tiewrap Clamp Part Numbers	
Complete Set Assembled	SFCTL306B□□□KM
Complete Set Unassembled	SFCTL306B□□□K

□□□ Inner width (C)

Steel Type

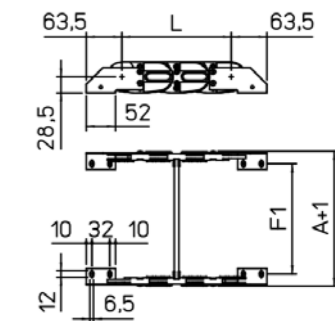
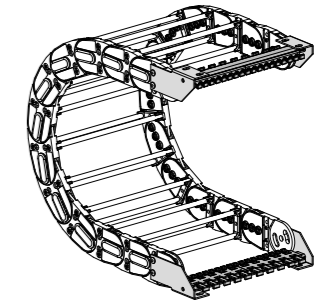

Chain Type	F1
306B□□□	F=A-44

Nylon Type Part Numbers	
Complete Set Assembled	A306KM□
Complete Set Unassembled	AN306K□
Tiewrap Clamp Part Numbers	
Complete Set Assembled	SFCT306B□□□KM
Complete Set Unassembled	SFCT306B□□□K

□□□ Inner width (C)
Possible mounting positions: 1/2/3 (acc. to page 33)

SILVYN® CHAIN 307SU

Nylon Cable Chain with opening frames

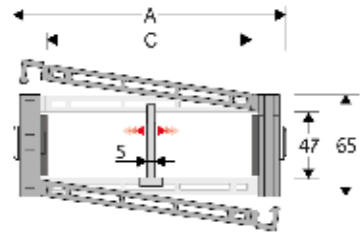

Technical data

- Inner Height (D)**
47 mm
- Pitch (P)**
70 mm
- Speed**
8 m/s
- Acceleration**
40 m/s²

Separator

Unassembled	Article number S307S
Assembled	Article number S307SMCI; S307SMCE

MCI: chain opening outer radius
MCE: chain opening inner radius

Strong-hold separator for C > 200 mm

Unassembled	Article number S307SH
Assembled	Article number S307SHMCI; S307SHMCE

Pin Article number PG307

A (mm)	B (mm)	C (mm)	D (mm)	R (mm)	Weight (kg/m)	Article number
80	65	42	47	075-090-120-140-200-250	1.86	307SU042□□□
91	65	53	47	075-090-120-140-200-250	1.86	307SU053□□□
105	65	67	47	075-090-120-140-200-250	1.92	307SU067□□□
111	65	73	47	075-090-120-140-200-250	1.94	307SU073□□□
125	65	87	47	075-090-120-140-200-250	1.97	307SU087□□□
130	65	92	47	075-090-120-140-200-250	1.97	307SU092□□□
137	65	99	47	075-090-120-140-200-250	1.99	307SU099□□□
147	65	109	47	075-090-120-140-200-250	2.00	307SU109□□□
155	65	117	47	075-090-120-140-200-250	2.05	307SU117□□□
166	65	128	47	075-090-120-140-200-250	2.07	307SU128□□□
180	65	142	47	075-090-120-140-200-250	2.10	307SU142□□□
205	65	167	47	075-090-120-140-200-250	2.16	307SU167□□□
230	65	192	47	075-090-120-140-200-250	2.23	307SU192□□□
241	65	203	47	075-090-120-140-200-250	2.26	307SU203□□□
255	65	217	47	075-090-120-140-200-250	2.30	307SU217□□□
282	65	244	47	075-090-120-140-200-250	2.37	307SU244□□□
291	65	253	47	075-090-120-140-200-250	2.39	307SU253□□□
342	65	304	47	075-090-120-140-200-250	2.50	307SU304□□□
364	65	326	47	075-090-120-140-200-250	2.56	307SU326□□□
392	65	354	47	075-090-120-140-200-250	2.63	307SU354□□□

□□□ to be filled with Radius R

R	H	N	M
075	219	180	375
090	249	195	425
120	309	225	520
140	349	245	580
200	469	305	770
250	569	355	925

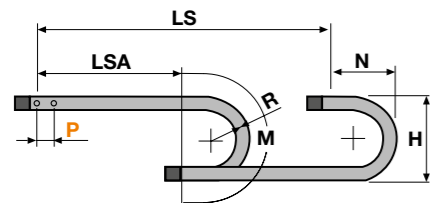

L=LSA + M or M1 Length of chain (L)= Half travel distance LSA plus length of curve (M) or (M1)

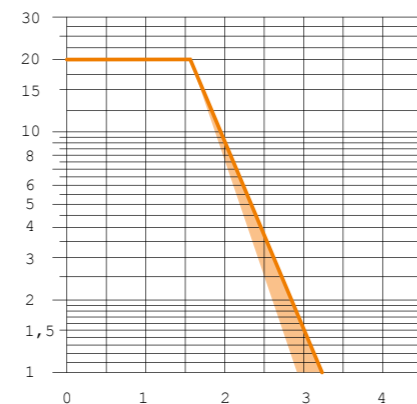
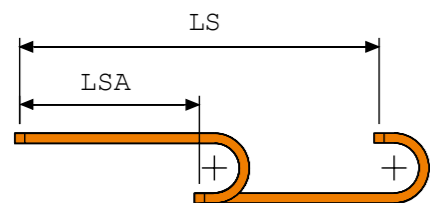

Self-Supporting Capacity Diagram
The maximum length of the self-supporting capacity LSA in relationship to the weight of the cables and hoses contained per metre.

The orange marking/area in the diagram considers the difference of weight between various widths of chain.

For applications with LSA and weights not included in the area of the diagram showing a self-supporting capacity, verify the possible use of support rollers (see page 41).

End brackets

The end brackets set allows the two ends of the chain to be attached to the equipment. Set complete with tiwrap clamps available on request.

Nylon Type

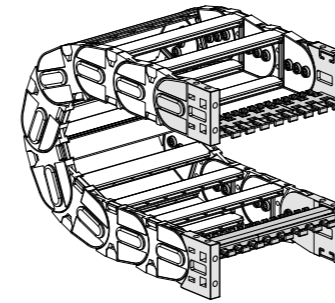

Steel Type

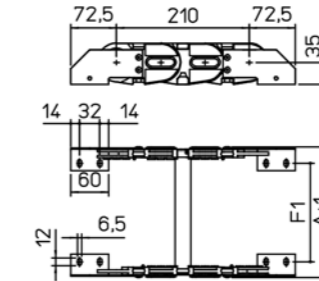
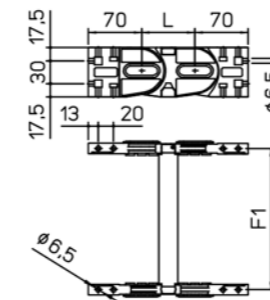
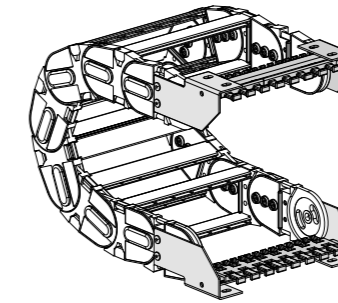

Chain Type	F1
307SU042	61
307SU053	72
307SU067	86
307SU073	92
307SU081	100
307SU087	106
307SU092	111
307SU099	118
307SU109	128
307SU117	136
307SU128	147
307SU142	161
307SU167	186
307SU192	211
307SU203	222
307SU217	236
307SU244	263
307SU253	272
307SU304	323
307SU326	345
307SU354	373

Chain Type	F1
307SU042	31
307SU053	42
307SU067	56
307SU073	62
307SU081	70
307SU087	76
307SU092	81
307SU099	88
307SU109	98
307SU117	106
307SU128	117
307SU142	131
307SU167	156
307SU192	181
307SU203	192
307SU217	206
307SU244	233
307SU253	242
307SU304	293
307SU326	315
307SU354	343

Nylon Type Part Numbers

Complete Set Assembled
AN307KM
Complete Set Unassembled
AN307K

Tiewrap Clamp Part Numbers

Complete Set Assembled
CFC307S□□□KM
Complete Set Unassembled
CFC307S□□□K

□□□ Inner width (C)

Steel Type Part Numbers

Complete Set Assembled
A307SKM□
Complete Set Unassembled
A307SK□

Tiewrap Clamp Part Numbers

Complete Set Assembled
SFCT307S□□□KM
Complete Set Unassembled
SFCT307S□□□K

□□□ Inner width (C)
Possible mounting positions: 1/2/3 (acc. to page 33)

SILVYN® CHAIN 307B

Nylon Cable Chain with un-screwable aluminium rods

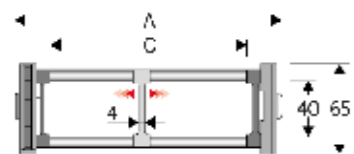

Technical data

- Inner Height (D)**
40 mm
- Pitch (P)**
70 mm
- Speed**
8 m/s
- Acceleration**
40 m/s²

A (mm)	B (mm)	C (mm)	D (mm)	R (mm)	Weight (kg/m)	Article number
117	65	75	40	075-090-120-140-200-250	1.80	307B075□□□
142	65	100	40	075-090-120-140-200-250	1.85	307B100□□□
192	65	150	40	075-090-120-140-200-250	1.95	307B150□□□
242	65	200	40	075-090-120-140-200-250	2.05	307B200□□□
292	65	250	40	075-090-120-140-200-250	2.15	307B250□□□
342	65	300	40	075-090-120-140-200-250	2.25	307B300□□□
C+42	65	...	40	075-090-120-140-200-250	...	307B□□□□□

□□□ to be filled with Radius R

Separator

- Unassembled Article number S307
- Assembled Article number S307MC
- MCI: chain opening outer radius
- MCE: chain opening inner radius
- Pin Article number PG307

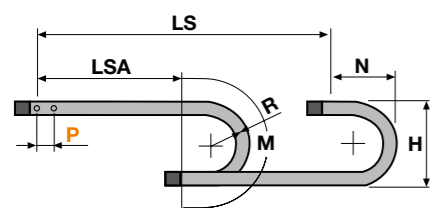

L=LSA + M or M1 Length of chain (L)= Half travel distance LSA plus length of curve (M) or (M1)

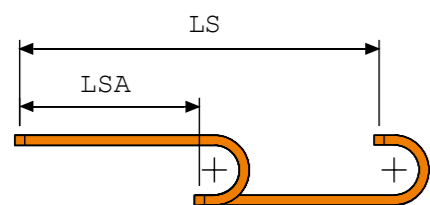

R	H	N	M
075	219	180	375
090	249	195	425
120	309	225	520
140	349	245	580
200	469	305	770
250	569	355	925

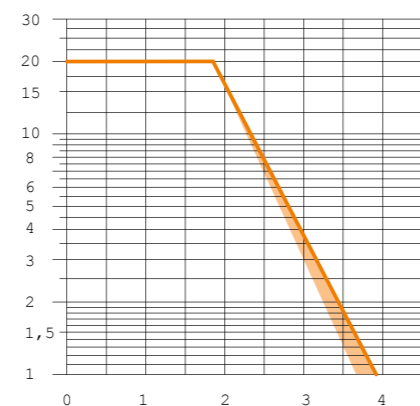

Self-Supporting Capacity Diagram
The maximum length of the self-supporting capacity LSA in relationship to the weight of the cables and hoses contained per metre.

The orange marking/area in the diagram considers the difference of weight between various widths of chain.

For applications with LSA and weights not included in the area of the diagram showing a self-supporting capacity, verify the possible use of support rollers (see page 41).

End brackets

The end brackets set allows the two ends of the chain to be attached to the equipment. Set complete with tiwrap clamps available on request.

Nylon Type

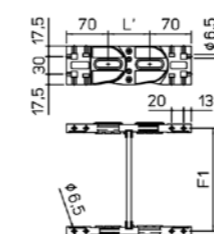
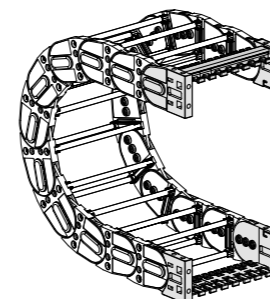

Chain Type	F1
307B075□	98
307B100□	123
307B150□	173
307B200□	223
307B250□	273
307B300□	323
307B□□□□	F=A-19

Steel Type

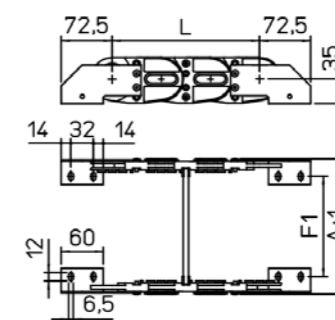
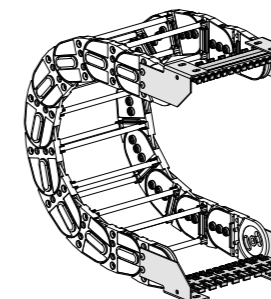

Chain Type	F ^mm
307B075□	68
307B100□	93
307B150□	143
307B200□	193
307B250□	243
307B300□	293
307B□□□□	F=A-49

Nylon Type Part Numbers
Complete Set Assembled
AN307KM
Complete Set Unassembled
AN307K
Tiewrap Clamp Part Numbers
Complete Set Assembled
CFC307S□□□KM
Complete Set Unassembled
CFC307S□□□K

□□□ Inner width (C)

Steel Type Part Numbers
Complete Set Assembled
A307KM
Complete Set Unassembled
A307K
Tiewrap Clamp Part Numbers
Complete Set Assembled
SFCT307B□□□KM
Complete Set Unassembled
SFCT307B□□□K

□□□ Inner width (C)

Possible mounting positions: 1/2/3 (acc. to page 33)

SILVYN® CHAIN 307E

Nylon cable chain with un-screwable aluminium rods.

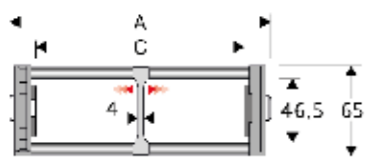

Technical data

- Inner Height (D)**
46,5 mm
- Pitch (P)**
70 mm
- Speed**
8 m/s
- Acceleration**
40 m/s²

A (mm)	B (mm)	C (mm)	D (mm)	R (mm)	Weight (kg/m)	Article number
113	65	75	46.5	075-090-120-140-170-200-250	1.80	307E075□□□
138	65	100	46.5	075-090-120-140-170-200-250	1.85	307E100□□□
188	65	150	46.5	075-090-120-140-170-200-250	1.95	307E150□□□
238	65	200	46.5	075-090-120-140-170-200-250	2.05	307E200□□□
288	65	250	46.5	075-090-120-140-170-200-250	2.15	307E250□□□
338	65	300	46.5	075-090-120-140-170-200-250	2.25	307E300□□□
C+38	65	...	46.5	075-090-120-140-170-200-250	...	307E□□□□□

□□□ to be filled with Radius R

Separator

- Unassembled Article number S307EF
- Assembled Article number S307EFMC
- MCI: chain opening outer radius
- MCE: chain opening inner radius
- Pin Article number PG307

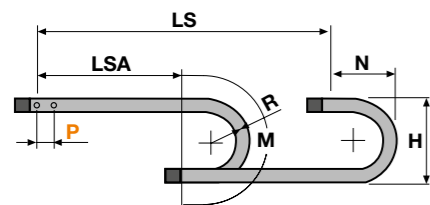

L=LSA + M or M1 Length of chain (L)= Half travel distance LSA plus length of curve (M) or (M1)

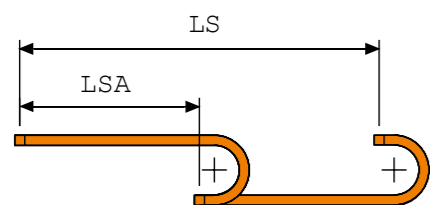

R	H	N	M
075	219	180	375
090	249	195	425
120	309	225	520
140	349	245	580
170	409	305	770
200	469	305	770
250	569	355	925

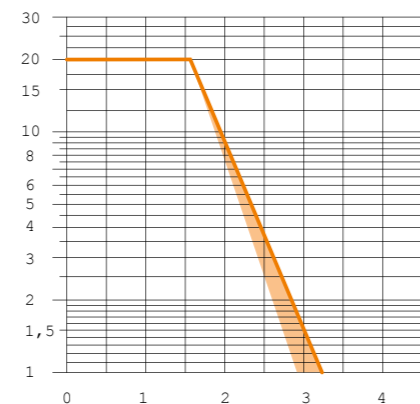

Self-Supporting Capacity Diagram

The maximum length of the self-supporting capacity LSA in relationship to the weight of the cables and hoses contained per metre.

The orange marking/area in the diagram considers the difference of weight between various widths of chain.

For applications with LSA and weights not included in the area of the diagram showing a self-supporting capacity, verify the possible use of support rollers (see page 41).

End brackets

The end brackets set allows the two ends of the chain to be attached to the equipment. Set complete with tiwrap clamps available on request.

Nylon Type

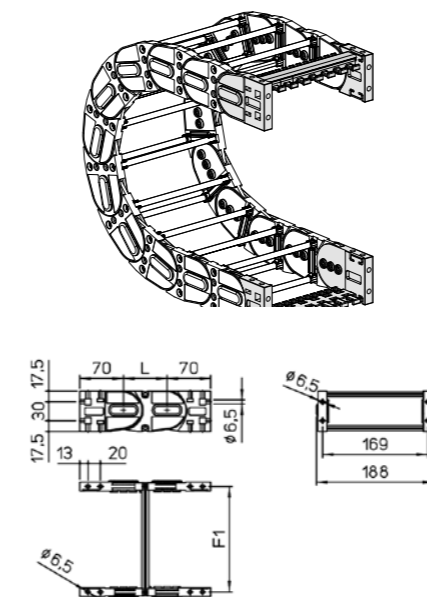

Steel Type

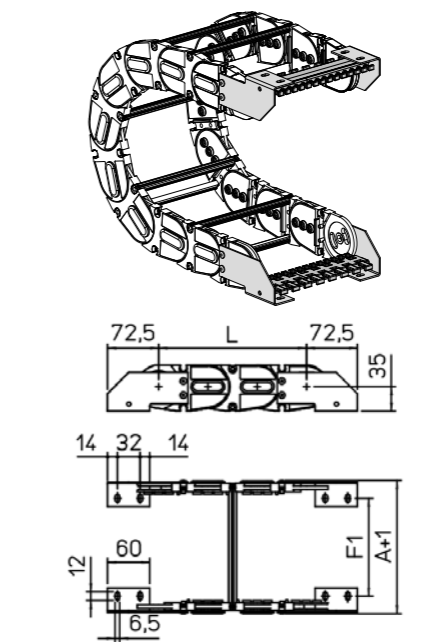

Chain Type	F1
307E075	94
307E100	119
307E150	169
307E200	219
307E250	269
307E300	319
307□□□	F=A-19

Chain Type	F1
307E075	94
307E100	119
307E150	169
307E200	219
307E250	269
307E300	319
307□□□	F=A-19

Nylon Type Part Numbers	
Complete Set Assembled	AN307KM
Complete Set Unassembled	AN307K
Tiwrap Clamp Part Numbers	
Complete Set Assembled	CFC307S□□□KM
Complete Set Unassembled	CFC307S□□□K

Steel Type Part Numbers	
Complete Set Assembled	A307EKM□
Complete Set Unassembled	A307EK□
Tiwrap Clamp Part Numbers	
Complete Set Assembled	SFCT307E□□□KM
Complete Set Unassembled	SFCT307E□□□K

□□□ Inner width (C)

□□□ Inner width (C)
Possible mounting positions: 1/2/3 (acc. to page 33)

SILVYN® CHAIN 308SU

Nylon Cable Chain with opening frames

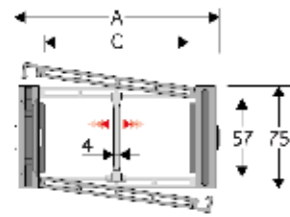

Technical data

- Inner Height (D)**
57 mm
- Pitch (P)**
80 mm
- Speed**
8 m/s
- Acceleration**
40 m/s²

Separator

- Unassembled Article number S308C
- Assembled Article number S308CMCI, S308CMCE

MCI: chain opening outer radius
MCE: chain opening inner radius

Strong-hold separator for C > 200 mm

- Unassembled Article number S308SHF
- Assembled Article number S308SHFMCI, S308SHFMCE

Pin Article number PG308

A (mm)	B (mm)	C (mm)	D (mm)	R (mm)	Weight (kg/m)	Article number
82	75	38	57	135-150-180-200-230-280-400	2.46	308SU038
93	75	49	57	135-150-180-200-230-280-400	2.46	308SU049
107	75	63	57	135-150-180-200-230-280-400	2.51	308SU063
113	75	69	57	135-150-180-200-230-280-400	2.53	308SU069
127	75	83	57	135-150-180-200-230-280-400	2.56	308SU083
132	75	88	57	135-150-180-200-230-280-400	2.56	308SU088
139	75	95	57	135-150-180-200-230-280-400	2.58	308SU095
149	75	105	57	135-150-180-200-230-280-400	2.59	308SU105
157	75	113	57	135-150-180-200-230-280-400	2.62	308SU113
168	75	124	57	135-150-180-200-230-280-400	2.65	308SU124
182	75	138	57	135-150-180-200-230-280-400	2.67	308SU138
207	75	163	57	135-150-180-200-230-280-400	2.73	308SU163
232	75	188	57	135-150-180-200-230-280-400	2.79	308SU188
243	75	199	57	135-150-180-200-230-280-400	2.81	308SU199
257	75	213	57	135-150-180-200-230-280-400	2.84	308SU213
284	75	240	57	135-150-180-200-230-280-400	2.90	308SU240
293	75	249	57	135-150-180-200-230-280-400	2.92	308SU249
344	75	300	57	135-150-180-200-230-280-400	3.02	308SU300
366	75	322	57	135-150-180-200-230-280-400	3.07	308SU322
394	75	350	57	135-150-180-200-230-280-400	3.13	308SU350

□□□ to be filled with Radius R

R	H	N	M
135	345	255	585
150	375	270	635
180	435	300	725
200	475	320	790
230	535	350	885
280	635	400	1040
400	875	520	1420

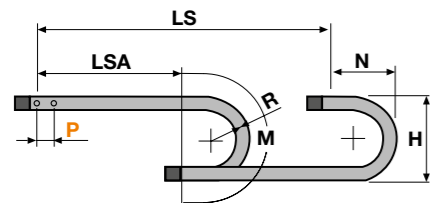

L=LSA + M or M1 Length of chain (L)= Half travel distance LSA plus length of curve (M) or (M1)

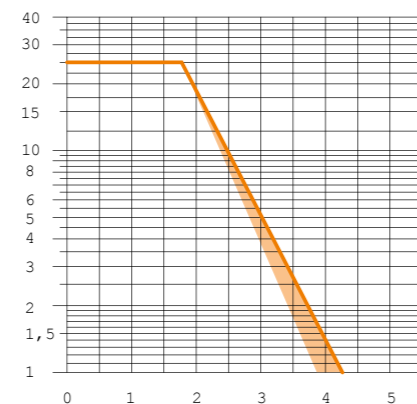
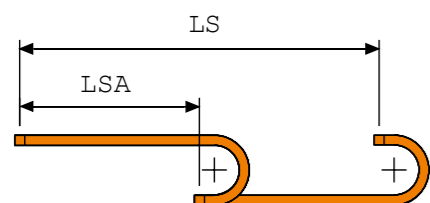

Self-Supporting Capacity Diagram

The maximum length of the self-supporting capacity LSA in relationship to the weight of the cables and hoses contained per metre.

The orange marking/area in the diagram considers the difference of weight between various widths of chain.

For applications with LSA and weights not included in the area of the diagram showing a self-supporting capacity, verify the possible use of support rollers (see page 41).

End brackets

The end brackets set allows the two ends of the chain to be attached to the equipment. Set complete with tiewrap clamps available on request.

Nylon Type

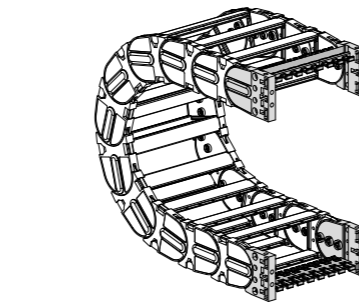

Steel Type

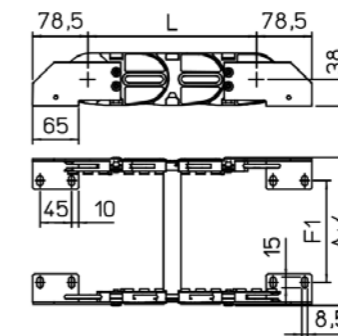
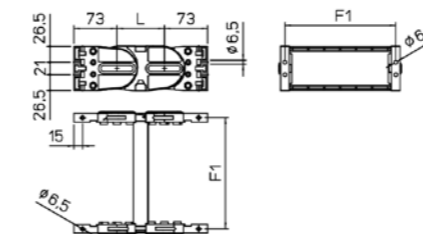
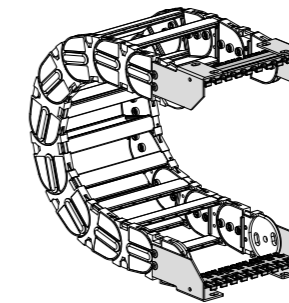

Chain Type	F1
308SU038	62
308SU049	73
308SU063	87
308SU069	93
308SU083	107
308SU088	112
308SU095	119
308SU105	129
308SU113	137
308SU124	148
308SU138	162
308SU163	187
308SU188	212
308SU199	223
308SU213	237
308SU240	264
308SU249	273
308SU300	324
308SU322	346
308SU350	374

Chain Type	F1
308SU038	20
308SU049	31
308SU063	45
308SU069	51
308SU083	65
308SU088	70
308SU095	77
308SU105	87
308SU113	95
308SU124	106
308SU138	120
308SU163	145
308SU188	170
308SU199	181
308SU213	195
308SU240	222
308SU249	231
308SU300	282
308SU322	304
308SU350	332

Nylon Type Part Numbers	
Complete Set Assembled	AN308SKM
Complete Set Unassembled	AN308SK
Tiewrap Clamp Part Numbers	
Complete Set Assembled	CFC308S□□□KM
Complete Set Unassembled	CFC308S□□□K

□□□ Inner width (C)

Steel Type Part Numbers	
Complete Set Assembled	A308SKM
Complete Set Unassembled	A308SK
Tiewrap Clamp Part Numbers	
Complete Set Assembled	SFCT308S□□□KM
Complete Set Unassembled	SFCT308S□□□K

□□□ Inner width (C)

Possible mounting positions: 1/2/3 (acc. to page 33)

SILVYN® CHAIN 308CU

Nylon Protection cable chain with openable aluminium covers.

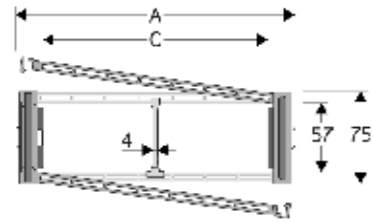

Technical data

- Inner Height (D)**
57 mm
- Pitch (P)**
80 mm
- Speed**
8 m/s
- Acceleration**
40 m/s²

- Separator**
- Unassembled Article number S308C
 - Assembled Article number S308CMCI, S308CMCE
- MCI: chain opening outer radius
MCE: chain opening inner radius
- Pin** Article number PG308

A (mm)	B (mm)	C (mm)	D (mm)	R (mm)	Weight (kg/m)	Article number
82	75	38	57	150-180-200-230-280-400	2.90	308CU038□□
93	75	49	57	150-180-200-230-280-400	3.01	308CU049□□
107	75	63	57	150-180-200-230-280-400	3.19	308CU063□□
113	75	69	57	150-180-200-230-280-400	3.27	308CU069□□
127	75	83	57	150-180-200-230-280-400	3.43	308CU083□□
132	75	88	57	150-180-200-230-280-400	3.48	308CU088□□
139	75	95	57	150-180-200-230-280-400	3.56	308CU095□□
149	75	105	57	150-180-200-230-280-400	3.67	308CU105□□
157	75	113	57	150-180-200-230-280-400	3.77	308CU113□□
168	75	124	57	150-180-200-230-280-400	3.91	308CU124□□
182	75	138	57	150-180-200-230-280-400	4.06	308CU138□□
207	75	163	57	150-180-200-230-280-400	4.36	308CU163□□
232	75	188	57	150-180-200-230-280-400	4.65	308CU188□□
243	75	199	57	150-180-200-230-280-400	4.78	308CU199□□
257	75	213	57	150-180-200-230-280-400	4.94	308CU213□□
284	75	240	57	150-180-200-230-280-400	5.25	308CU240□□
293	75	249	57	150-180-200-230-280-400	5.37	308CU249□□
344	75	300	57	150-180-200-230-280-400	5.95	308CU300□□
366	75	322	57	150-180-200-230-280-400	6.20	308CU322□□
394	75	350	57	150-180-200-230-280-400	6.11	308CU350□□

□□ to be filled with Radius R

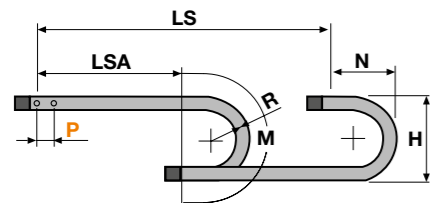

R	H	N	M
150	375	270	635
180	435	300	725
200	475	320	790
230	535	350	885
280	635	400	1040
400	875	520	1420

L=LSA + M or M1 Length of chain (L)= Half travel distance LSA plus length of curve (M) or (M1)

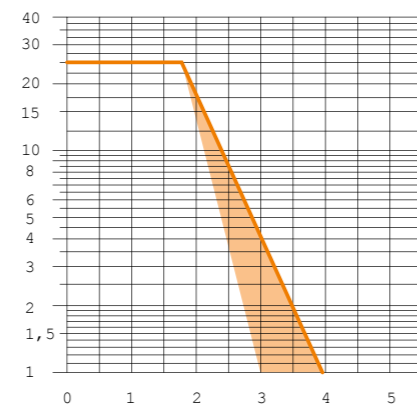
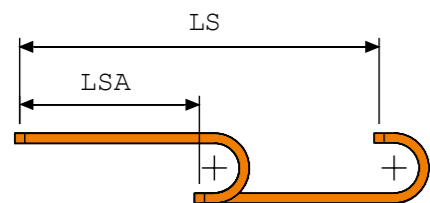

Self-Supporting Capacity Diagram
The maximum length of the self-supporting capacity LSA in relationship to the weight of the cables and hoses contained per metre.

The orange marking/area in the diagram considers the difference of weight between various widths of chain.

For applications with LSA and weights not included in the area of the diagram showing a self-supporting capacity, verify the possible use of support rollers (see page 41).

End brackets

The end brackets set allows the two ends of the chain to be attached to the equipment. Set complete with tiwrap clamps available on request.

Nylon Type

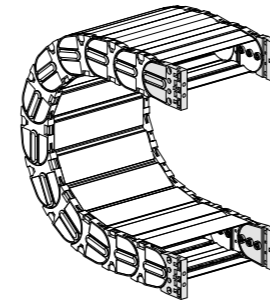

Steel Type

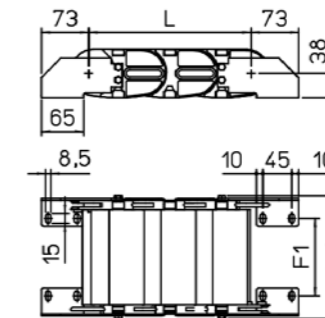
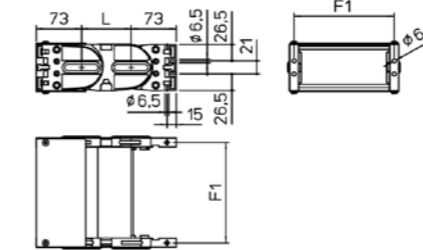
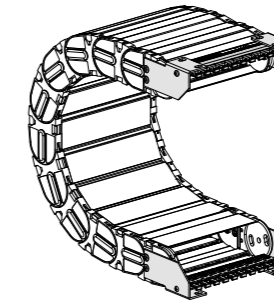

Chain Type	F1
308CU038□□	62
308CU049□□	73
308CU063□□	87
308CU069□□	93
308CU083□□	107
308CU088□□	112
308CU095□□	119
308CU105□□	129
308CU113□□	137
308CU124□□	148
308CU138□□	162
308CU163□□	187
308CU188□□	212
308CU199□□	223
308CU213□□	237
308CU240□□	264
308CU249□□	273
308CU300□□	324
308CU322□□	346
308CU350□□	374

Chain Type	F1
308CU038□□	20
308CU049□□	31
308CU063□□	45
308CU069□□	51
308CU083□□	65
308CU088□□	70
308CU095□□	77
308CU105□□	87
308CU113□□	95
308CU124□□	106
308CU138□□	120
308CU163□□	145
308CU188□□	170
308CU199□□	181
308CU213□□	195
308CU240□□	222
308CU249□□	231
308CU300□□	282
308CU322□□	304
308CU350□□	332

Nylon Type Part Numbers	
Complete Set Assembled	AN308C□□□KM
Complete Set Unassembled	AN308C□□□K

□□ Inner width (C)

Steel Type Part Numbers	
Complete Set Assembled	A308CU...KM□
Complete Set Unassembled	A308CU...K□□

Tiewrap Clamp Part Numbers

Complete Set Assembled	CFC445M□□□KM
Complete Set Unassembled	CFC445M□□□K

□□ Inner width (C)
Possible mounting positions: 1/2/3 (acc. to page 33)

SILVYN® CHAIN 308B

Nylon Cable Chain with un-screwable aluminium rods

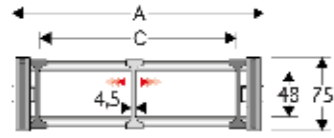

Technical data

- Inner Height (D)**
48 mm
- Pitch (P)**
80 mm
- Speed**
8 m/s
- Acceleration**
40 m/s²

A (mm)	B (mm)	C (mm)	D (mm)	R (mm)	Weight (kg/m)	Article number
156	75	100	48	150-180-200-230-280-400	2.85	308B100□□□
206	75	150	48	150-180-200-230-280-400	3.00	308B150□□□
256	75	200	48	150-180-200-230-280-400	3.15	308B200□□□
306	75	250	48	150-180-200-230-280-400	3.30	308B250□□□
356	75	300	48	150-180-200-230-280-400	3.45	308B300□□□
C+56	75	...	48	150-180-200-230-280-400	...	308B□□□□□

□□ to be filled with Radius R

Separator

Unassembled	Article number S3000F
Assembled	Article number S3000FMC

MCI: chain opening outer radius
MCE: chain opening inner radius

Pin Article number PG308

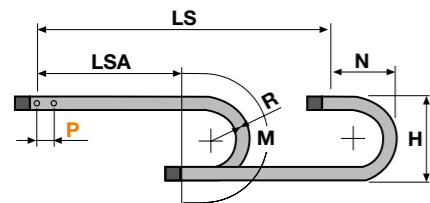

L=LSA + M or M1 Length of chain (L)= Half travel distance LSA plus length of curve (M) or (M1)

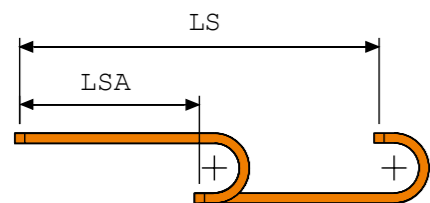

R	H	N	M
150	374	270	635
180	434	300	725
200	474	320	790
230	534	350	885
280	634	400	1040
400	874	520	1420

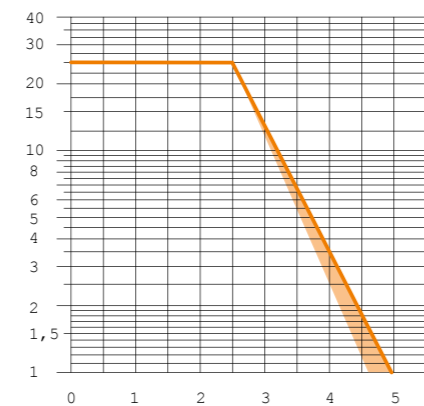

Self-Supporting Capacity Diagram
The maximum length of the self-supporting capacity LSA in relationship to the weight of the cables and hoses contained per metre.
The orange marking/area in the diagram considers the difference of weight between various widths of chain.

For applications with LSA and weights not included in the area of the diagram showing a self-supporting capacity, verify the possible use of support rollers (see page 41).

End brackets

The end brackets set allows the two ends of the chain to be attached to the equipment. Set complete with tiwrap clamps available on request.

Nylon Type

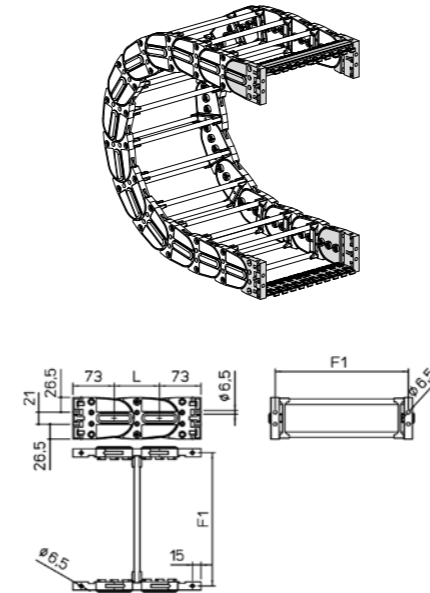

Chain Type	F1
308B100□	135
308B150□	185
308B200□	235
308B250□	285
308B300□	335
308B□□□□	F=A-21

Steel Type

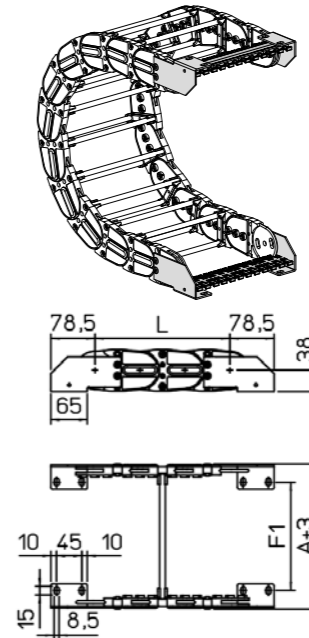

Chain Type	F1
308B100□	93
308B150□	143
308B200□	193
308B250□	243
308B300□	293
308B□□□□	F=A-63

Nylon Type Part Numbers

Complete Set Assembled	AN308KM
Complete Set Unassembled	AN308K

Tiewrap Clamp Part Numbers

Complete Set Assembled	CFC308S□□□KM
Complete Set Unassembled	CFC308S□□□K

□□ Inner width (C)

Steel Type Part Numbers

Complete Set Assembled	A308KM□
Complete Set Unassembled	A308K□

Tiewrap Clamp Part Numbers

Complete Set Assembled	SFCT308B□□□KM
Complete Set Unassembled	SFCT308B□□□K

□□ Inner width (C)
Possible mounting positions: 1/2/3 (acc. to page 33)

SILVYN® CHAIN 308E

Nylon cable chain with un-screwable aluminium rods.

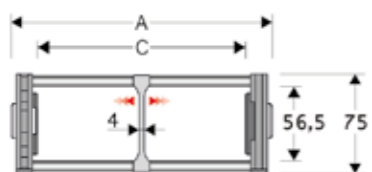

Technical data

- Inner Height (D)**
56,5 mm
- Pitch (P)**
80 mm
- Speed**
8 m/s
- Acceleration**
40 m/s²

Separator

- Unassembled Article number S308EF
- Assembled Article number S308EFMC
- MCL: chain opening outer radius
- MCE: chain opening inner radius
- Pin Article number PG308

A (mm)	B (mm)	C (mm)	D (mm)	R (mm)	Weight (kg/m)	Article number
144	75	100	56.5	135-150-180-200-230-280-400	2.85	308E100□□□
194	75	150	56.5	135-150-180-200-230-280-400	2.95	308E150□□□
244	75	200	56.5	135-150-180-200-230-280-400	3.05	308E200□□□
294	75	250	56.5	135-150-180-200-230-280-400	3.15	308E250□□□
344	75	300	56.5	135-150-180-200-230-280-400	3.25	308E300□□□
C+44	75	...	56.5	135-150-180-200-230-280-400	...	308E□□□□□

□□□ to be filled with Radius R

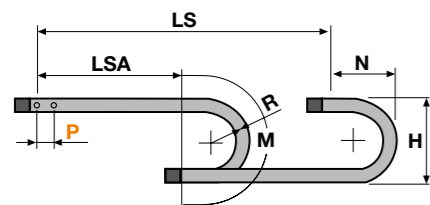

R	H	N	M
135	345	355	585
150	374	270	635
180	434	300	725
200	474	320	790
230	534	350	885
280	634	400	1040
400	874	520	1420

L=LSA + M or M1 Length of chain (L)= Half travel distance LSA plus length of curve (M) or (M1)

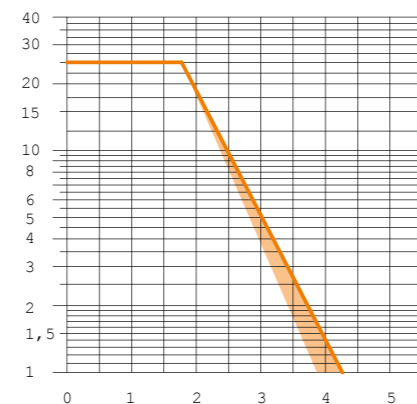
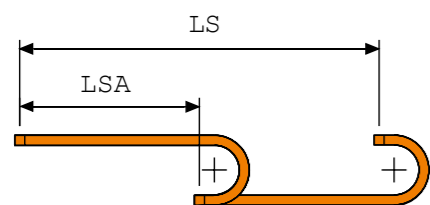

Self-Supporting Capacity Diagram

The maximum length of the self-supporting capacity LSA in relationship to the weight of the cables and hoses contained per metre.

The orange marking/area in the diagram considers the difference of weight between various widths of chain.

For applications with LSA and weights not included in the area of the diagram showing a self-supporting capacity, verify the possible use of support rollers (see page 41).

End brackets

The end brackets set allows the two ends of the chain to be attached to the equipment. Set complete with tiwrap clamps available on request.

Nylon Type

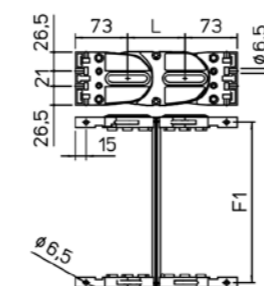
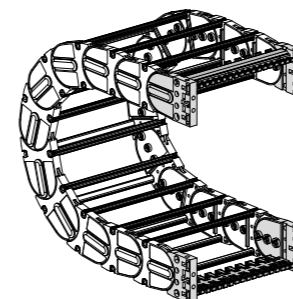

Chain Type	F1
308E100	123
308E150	173
308E200	223
308E250	273
308E300	323
308□□□	F=A-20

Nylon Type Part Numbers	
Complete Set Assembled	AN308KM
Complete Set Unassembled	AN308K
Tiwrap Clamp Part Numbers	
Complete Set Assembled	CFC308S□□□KM
Complete Set Unassembled	CFC308S□□□K

□□□ Inner width (C)

Steel Type

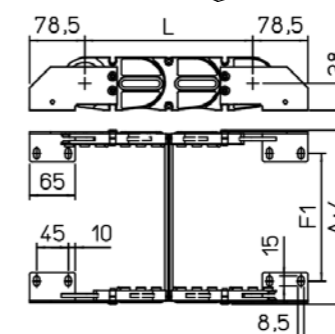
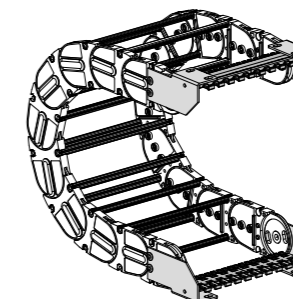

Chain Type	F1
308E100	81
308E150	131
308E200	181
308E250	231
308E300	281
308□□□	F=A-62

Steel Type Part Numbers	
Complete Set Assembled	A308EKM□
Complete Set Unassembled	A308EK□
Tiwrap Clamp Part Numbers	
Complete Set Assembled	SFCT308E□□□KM
Complete Set Unassembled	SFCT308E□□□K

□□□ Inner width (C)
Possible mounting positions: 1/2/3 (acc. to page 33)

SILVYN® CHAIN 309SU

Nylon Cable Chain with opening frames

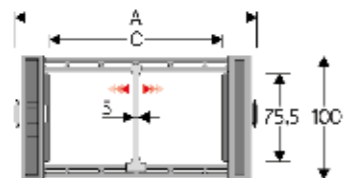

Technical data

- Inner Height (D)**
75,5 mm
- Pitch (P)**
100 mm
- Speed**
8 m/s
- Acceleration**
40 m/s²

Separator

Unassembled	Article number S309S
Assembled	Article number S309SMCI, S309SMCE

MCI: chain opening outer radius
MCE: chain opening inner radius

Strong-hold separator for C > 200 mm

Unassembled	Article number S309HOFL
Assembled	Article number S309HOFLMC

Pin Article number PG309H

A (mm)	B (mm)	C (mm)	D (mm)	R (mm)	Weight (kg/m)	Article number
120	100	64	75.5	150-200-250-300-350-400-500-600	4.03	309SU064□□
140	100	84	75.5	150-200-250-300-350-400-500-600	4.09	309SU084□□
165	100	109	75.5	150-200-250-300-350-400-500-600	4.17	309SU109□□
172	100	116	75.5	150-200-250-300-350-400-500-600	4.20	309SU116□□
195	100	139	75.5	150-200-250-300-350-400-500-600	4.27	309SU139□□
235	100	179	75.5	150-200-250-300-350-400-500-600	4.40	309SU179□□
270	100	214	75.5	150-200-250-300-350-400-500-600	4.51	309SU214□□
296	100	240	75.5	150-200-250-300-350-400-500-600	4.60	309SU240□□
320	100	264	75.5	150-200-250-300-350-400-500-600	4.67	309SU264□□
346	100	290	75.5	150-200-250-300-350-400-500-600	4.75	309SU290□□
370	100	314	75.5	150-200-250-300-350-400-500-600	4.83	309SU314□□
396	100	340	75.5	150-200-250-300-350-400-500-600	4.90	309SU340□□
420	100	364	75.5	150-200-250-300-350-400-500-600	4.99	309SU364□□
475	100	419	75.5	150-200-250-300-350-400-500-600	5.20	309SU419□□
544	100	488	75.5	150-200-250-300-350-400-500-600	5.40	309SU488□□

□□ to be filled with Radius R

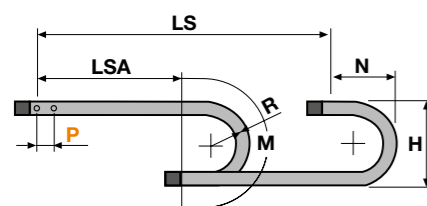

R	H	N	M
150	406	300	675
200	506	350	830
250	606	400	985
300	706	455	1145
350	806	500	1300
400	906	555	1460
500	1106	650	1770
600	1306	750	2085

L=LSA + M or M1 Length of chain (L)= Half travel distance LSA plus length of curve (M) or (M1)

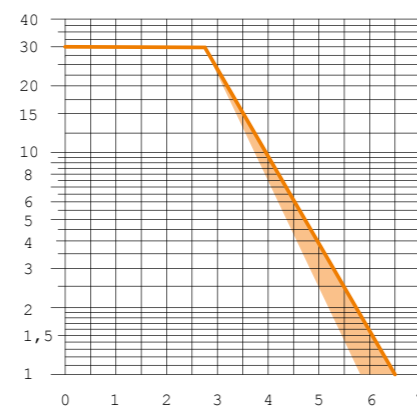
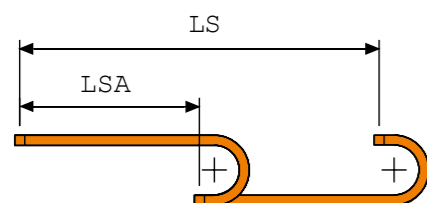

Self-Supporting Capacity Diagram
The maximum length of the self-supporting capacity LSA in relationship to the weight of the cables and hoses contained per metre.

The orange marking/area in the diagram considers the difference of weight between various widths of chain.

For applications with LSA and weights not included in the area of the diagram showing a self-supporting capacity, verify the possible use of support rollers (see page 41).

End brackets

The end brackets set allows the two ends of the chain to be attached to the equipment. Set complete with tiewrap clamps available on request.

Nylon Type

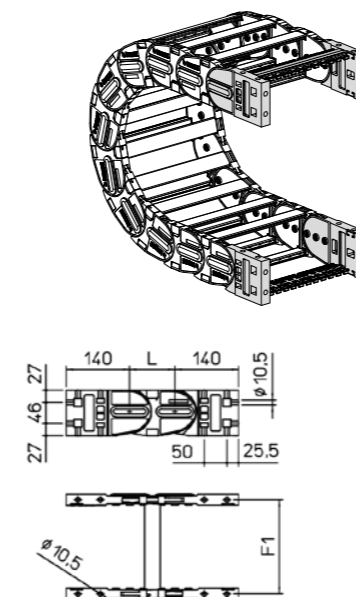

Steel Type

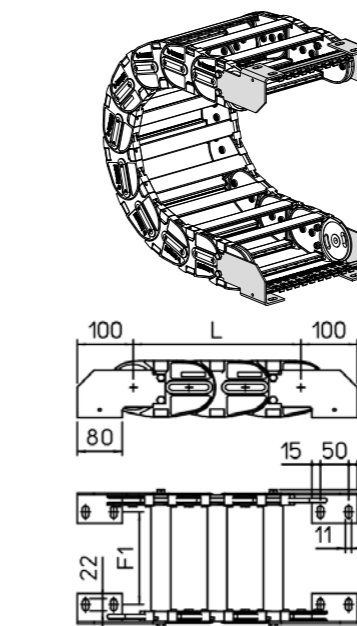

Chain Type	F1
309SU064	92
309SU084	112
309SU109	137
309SU116	144
309SU139	167
309SU179	207
309SU214	242
309SU240	268
309SU264	292
309SU290	318
309SU314	342
309SU340	368
309SU364	392
309SU419	447
309SU488	516

Nylon Type Part Numbers	
Complete Set Assembled	AN309KM
Complete Set Unassembled	AN309K
Tiewrap Clamp Part Numbers	
Complete Set Assembled	CFC309S□□□KM
Complete Set Unassembled	CFC309S□□□K

□□ Inner width (C)

Chain Type	F1
309SU064	50
309SU084	70
309SU109	95
309SU116	102
309SU139	125
309SU179	165
309SU214	200
309SU240	226
309SU264	250
309SU290	276
309SU314	300
309SU340	326
309SU364	350
309SU419	405
309SU488	474

Steel Type Part Numbers	
Complete Set Assembled	A309SKM□
Complete Set Unassembled	A309SK□
Tiewrap Clamp Part Numbers	
Complete Set Assembled	SFCT309S□□□KM
Complete Set Unassembled	SFCT309S□□□K

□□ Inner width (C)

Possible mounting positions: 1/2/3 (acc. to page 33)

SILVYN® CHAIN 309CU

Nylon Protection cable chain with openable aluminium covers.

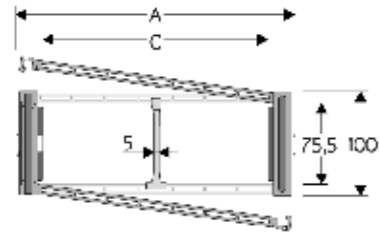

Technical data

- Inner Height (D)**
75,5 mm
- Pitch (P)**
100 mm
- Speed**
8 m/s
- Acceleration**
40 m/s²

Separator

Unassembled	Article number S309S
Assembled	Article number S309SMCI, S309SMCE

MCI: chain opening outer radius
MCE: chain opening inner radius

Pin Article number PG309H

A (mm)	B (mm)	C (mm)	D (mm)	R (mm)	Weight (kg/m)	Article number
120	100	64	75.5	200-250-300-350-400-500-600	4.84	309CU064□□□
140	100	84	75.5	200-250-300-350-400-500-600	5.12	309CU084□□□
165	100	109	75.5	200-250-300-350-400-500-600	5.47	309CU109□□□
172	100	116	75.5	200-250-300-350-400-500-600	5.58	309CU116□□□
195	100	139	75.5	200-250-300-350-400-500-600	5.90	309CU139□□□
235	100	179	75.5	200-250-300-350-400-500-600	6.47	309CU179□□□
270	100	214	75.5	200-250-300-350-400-500-600	6.97	309CU214□□□
296	100	240	75.5	200-250-300-350-400-500-600	7.35	309CU240□□□
320	100	264	75.5	200-250-300-350-400-500-600	7.68	309CU264□□□
346	100	290	75.5	200-250-300-350-400-500-600	8.04	309CU290□□□
370	100	314	75.5	200-250-300-350-400-500-600	8.39	309CU314□□□
396	100	340	75.5	200-250-300-350-400-500-600	8.74	309CU340□□□
420	100	364	75.5	200-250-300-350-400-500-600	9.09	309CU364□□□
475	100	419	75.5	200-250-300-350-400-500-600	9.98	309CU419□□□
544	100	488	75.5	200-250-300-350-400-500-600	10.86	309CU488□□□

□□□ to be filled with Radius R

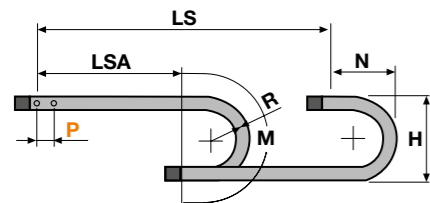

L=LSA + M or M1 Length of chain (L)= Half travel distance LSA plus length of curve (M) or (M1)

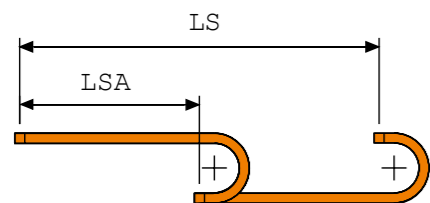

R	H	N	M
200	506	350	830
250	606	400	985
300	706	455	1145
350	806	500	1300
400	906	555	1460
500	1106	650	1770
600	1306	750	2085

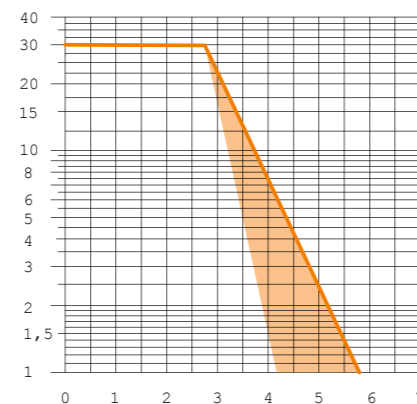

Self-Supporting Capacity Diagram
The maximum length of the self-supporting capacity LSA in relationship to the weight of the cables and hoses contained per metre.

The orange marking/area in the diagram considers the difference of weight between various widths of chain.

For applications with LSA and weights not included in the area of the diagram showing a self-supporting capacity, verify the possible use of support rollers (see page 41).

End brackets

The end brackets set allows the two ends of the chain to be attached to the equipment. Set complete with tiwrap clamps available on request.

Nylon Type

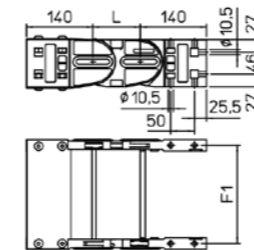
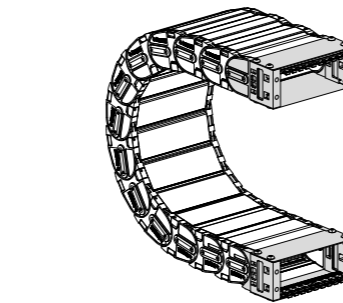

Steel Type

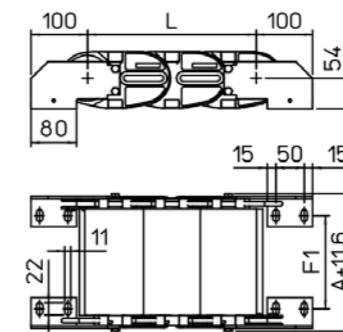
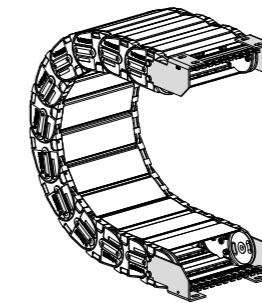

Chain Type	F1
309CU064□□□	92
309CU084□□□	112
309CU109□□□	137
309CU116□□□	144
309CU139□□□	167
309CU179□□□	207
309CU214□□□	242
309CU240□□□	268
309CU264□□□	292
309CU290□□□	318
309CU314□□□	342
309CU340□□□	368
309CU364□□□	392
309CU419□□□	447
309CU488□□□	516

Chain Type	F1
309CU064□□□	50
309CU084□□□	70
309CU109□□□	95
309CU116□□□	102
309CU139□□□	125
309CU179□□□	165
309CU214□□□	200
309CU240□□□	226
309CU264□□□	250
309CU290□□□	276
309CU314□□□	300
309CU340□□□	326
309CU364□□□	350
309CU419□□□	405
309CU488□□□	474

Nylon Type Part Numbers

Complete Set Assembled	AN309C□□□KM
Complete Set Unassembled	AN309C□□□K

□□□ Inner width (C)

Nylon Type Part Numbers

Complete Set Assembled	A309CU□□□KM□
Complete Set Unassembled	A309CU□□□K□

Tiewrap Clamp Part Numbers

Complete Set Assembled	SFCT309S□□□KM
Complete Set Unassembled	SFCT309S□□□K

□□□ Inner width (C)
Possible mounting positions: 1/2/3 (acc. to page 33)

SILVYN® CHAIN 309B

Nylon Cable Chain with opening frames

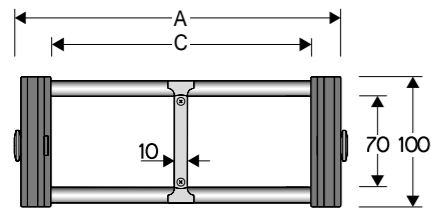

Technical data

- Inner Height (D)**
70 mm
- Pitch (P)**
100 mm
- Speed**
8 m/s
- Acceleration**
40 m/s²

Separator

Unassembled	Article number S309C
Assembled	Article number S309CMC
MCI: chain opening outer radius	
MCE: chain opening inner radius	
Pin	Article number PG309H

A (mm)	B (mm)	C (mm)	D (mm)	R (mm)	Weight (kg/m)	Article number
156	100	100	70	150-200-250-300-350-400-500-600	4.20	309B100□
206	100	150	70	150-200-250-300-350-400-500-600	4.40	309B150□
256	100	200	70	150-200-250-300-350-400-500-600	4.55	309B200□
306	100	250	70	150-200-250-300-350-400-500-600	4.70	309B250□
356	100	300	70	150-200-250-300-350-400-500-600	4.85	309B300□
456	100	400	70	150-200-250-300-350-400-500-600	5.20	309B400□
C+53	100	...	70	150-200-250-300-350-400-500-600	...	309B□□□□

□□□ to be filled with Radius R

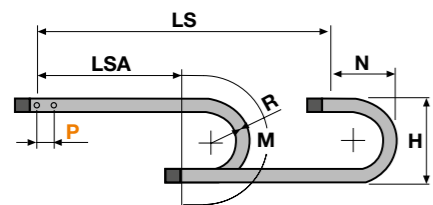

R	H	N	M
150	406	300	675
200	506	350	830
250	606	400	985
300	706	455	1145
350	806	500	1300
400	906	555	1460
500	1106	650	1770
600	1306	750	2085

L=LSA + M or M1 Length of chain (L)= Half travel distance LSA plus length of curve (M) or (M1)

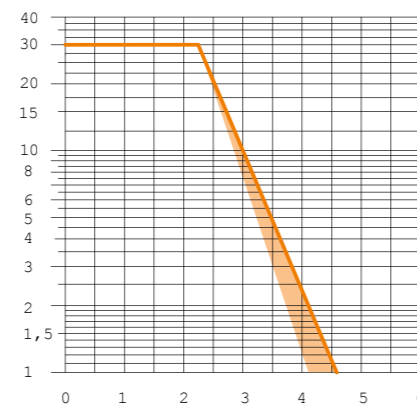
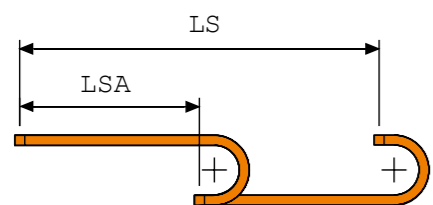

Self-Supporting Capacity Diagram
The maximum length of the self-supporting capacity LSA in relationship to the weight of the cables and hoses contained per metre.

The orange marking/area in the diagram considers the difference of weight between various widths of chain.

For applications with LSA and weights not included in the area of the diagram showing a self-supporting capacity, verify the possible use of support rollers (see page 41).

End brackets

The end brackets set allows the two ends of the chain to be attached to the equipment. Set complete with tiwrap clamps available on request.

Nylon Type

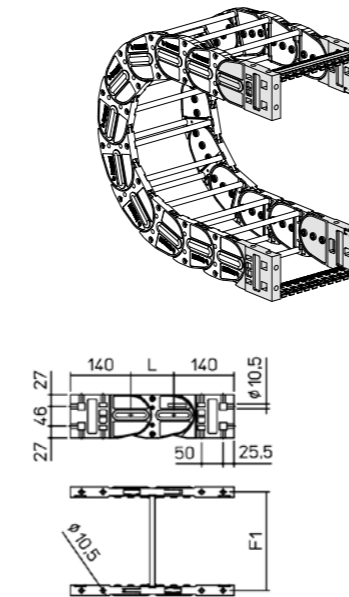

Steel Type

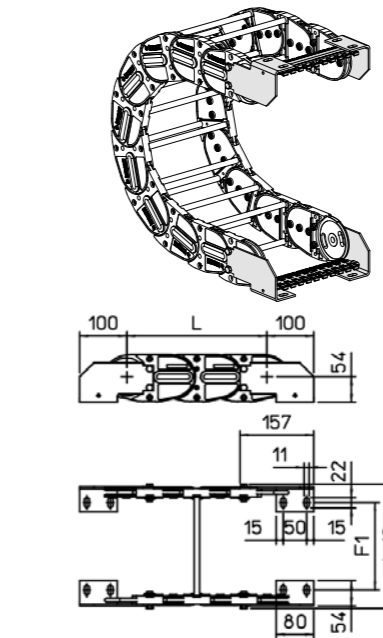

Chain Type	F1
309B100	87
309B150	137
309B200	187
309B250	237
309B300	287
309B400	387
309B□□□	F=A-66

Chain Type	F1
309B100	129
309B150	179
309B200	229
309B250	279
309B300	329
309B400	429
309B□□□	F=A-24

Nylon Type Part Numbers

Complete Set Assembled	AN309KM
Complete Set Unassembled	AN309K

Tiewrap Clamp Part Numbers

Complete Set Assembled	CFC309S□□□KM
Complete Set Unassembled	CFC309S□□□K

Steel Type Part Numbers

Complete Set Assembled	A309KM□
Complete Set Unassembled	A309K□

Tiewrap Clamp Part Numbers

Complete Set Assembled	SFCT309B□□□KM
Complete Set Unassembled	SFCT309B□□□K

□□□ Inner width (C)

□□□ Inner width (C)
Possible mounting positions: 1/2/3 (acc. to page 33)

SILVYN® CHAIN 309T

Nylon cable chain with un-screwable aluminium rods.

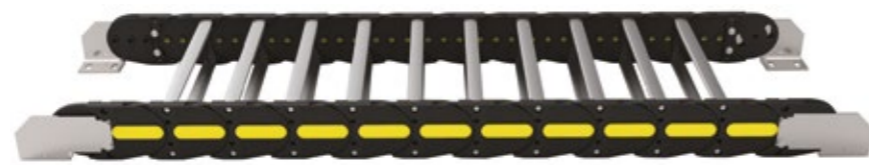
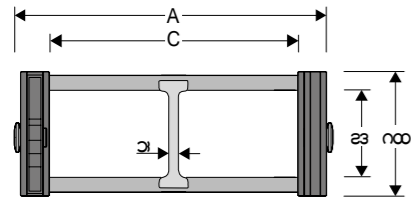

Technical data

- Inner Height (D)**
70 mm
- Pitch (P)**
100 mm
- Speed**
8 m/s
- Acceleration**
40 m/s²

Separator

- Unassembled Article number S309POT
- Assembled Article number S309POTMC
- MCI: chain opening outer radius
- MCE: chain opening inner radius
- Pin** Article number PG309H

A (mm)	B (mm)	C (mm)	D (mm)	R (mm)	Weight (kg/m)	Article number
153	100	100	70	150-200-250-300-350-400-500-600	4.48	309T100□□
203	100	150	70	150-200-250-300-350-400-500-600	4.81	309T150□□
253	100	200	70	150-200-250-300-350-400-500-600	5.09	309T200□□
303	100	250	70	150-200-250-300-350-400-500-600	5.37	309T250□□
353	100	300	70	150-200-250-300-350-400-500-600	5.65	309T300□□
453	100	400	70	150-200-250-300-350-400-500-600	6.26	309T400□□
C+53	100	...	70	150-200-250-300-350-400-500-600	...	309T□□□□

□□ to be filled with Radius R

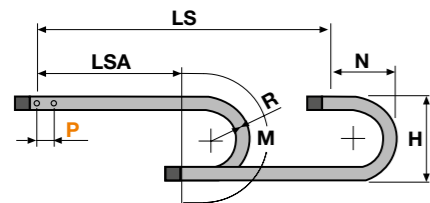

R	H	N	M
150	406	300	675
200	506	350	830
250	606	400	985
300	706	455	1145
350	806	500	1300
400	906	555	1460
500	1106	650	1770
600	1306	750	2085

L=LSA + M or M1 Length of chain (L)= Half travel distance LSA plus length of curve (M) or (M1)

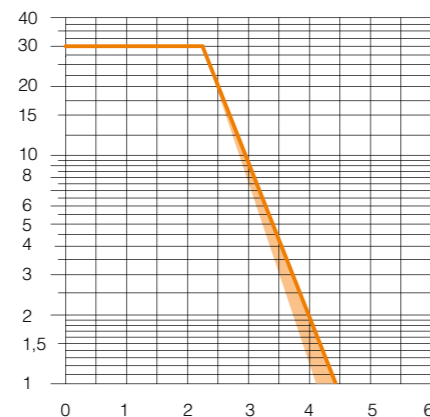
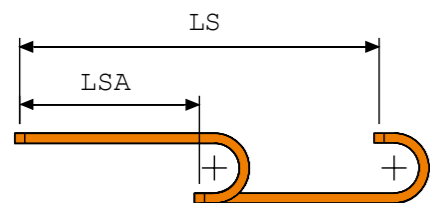

Self-Supporting Capacity Diagram

The maximum length of the self-supporting capacity LSA in relationship to the weight of the cables and hoses contained per metre.

The orange marking/area in the diagram considers the difference of weight between various widths of chain.

For applications with LSA and weights not included in the area of the diagram showing a self-supporting capacity, verify the possible use of support rollers (see page 41).

End brackets

The end brackets set allows the two ends of the chain to be attached to the equipment. Set complete with tiwrap clamps available on request.

Nylon Type

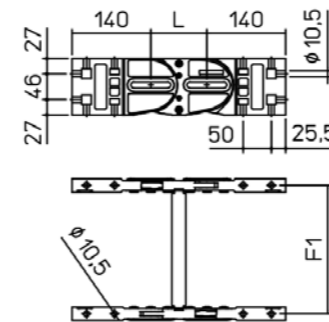
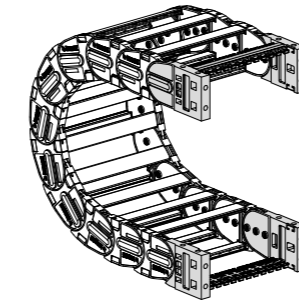

Steel Type

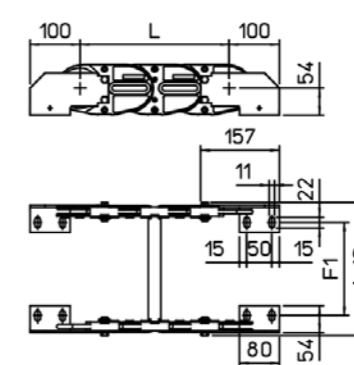
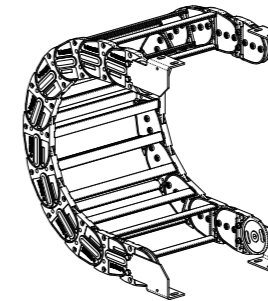

Chain Type	F1
309T100	87
309T150	137
309T200	187
309T250	237
309T300	287
309T400	387
309T□□□	F=A-66

Chain Type	F1
309T100	129
309T150	179
309T200	229
309T250	279
309T300	329
309T400	429
309T□□□	F=A-24

Nylon Type Part Numbers	
Complete Set Assembled	AN309KM
Complete Set Unassembled	AN309K
Tiwrap Clamp Part Numbers	
Complete Set Assembled	CFC309S□□□KM
Complete Set Unassembled	CFC309S□□□K

Steel Type Part Numbers	
Complete Set Assembled	A309KM□
Complete Set Unassembled	A309K□
Tiwrap Clamp Part Numbers	
Complete Set Assembled	SFCT309T□□□KM
Complete Set Unassembled	SFCT309T□□□K

□□ Inner width (C)

□□ Inner width (C)
Possible mounting positions: 1/2/3 (acc. to page 33)