

THE WORLD OF LAPP

Product News 2011



LAPP GROUP



Welcome







Please come in and look around. Irrespective of which cable, line, plug and accessory you require for your particular application, you will find exactly what you need here. We have more than 40,000 different standard articles in stock. We also deliver within 24 or 48 hours. Special tasks demand special solutions. In this case too, you need look no further than our company. In addition to the comprehensive range of standard Lapp products, we can also offer you individual cable assemblies and the engineering involved.

You should also be aware of the following: Lapp is one of the leading international system providers. Our brands are used in the most varied of applications, branches and global markets. One of our principles states: when striving for perfection we should rely on no-one but ourselves. This is why we manufacture everything in our own production sites. We also have numerous sales companies and logistics centres around the world, which enable us to be close to our customers. We're somewhere near you too!

To contact your local Lapp Group representative please visit www.lappgroup.com/worldwide

Source: Title/e-Mobility-Photo, Bosch Software Innovations GmbH

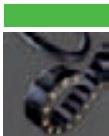
Content

	ÖLFLEX® Power- and control cables	8
	UNITRONIC® Data communication systems	13
	ETHERLINE® Data communication systems for ETHERNET-Technology	14
	EPIC® Industrial connectors	15
	SKINTOP® Cable glands	31
	SILVYN® Protective cable conduit- and cable carrier systems	32
	FLEXIMARK® Cable marking products	34
	Cable Accessories	35

The Lapp Group worldwide

 **Algeria**
EURL CABELMAT
 Cité Mimouni Lotissement 18
 Villa N° 14 Bordj El Kifane
 Alger, Algérie 16411
 Tel.: +213/21 20 10 39
 Fax: +213/20 38 82 20
 info@cabelmat.net
 www.cabelmat.net

 **Argentina**
NAKASE SRL
 Calle 49 No. 5764
 B1653A0X
 Villa Ballester
 1870 Buenos Aires
 Tel.: +54 11/4 76 84 24 21 22
 Fax: +54 11/4 76 84 24 21 21
 gerencia@nakase.com
 www.nakase.com.ar

 **Armenia**
Integral Design ev Engineering
 8 Tumanyan str., suite 425-426
 375002 Yerevan, Armenia
 Tel.: +374 10/51 91 88
 Mobil: +374 91/40 04 87
 Fax: +374 10/52 01 88
 info@ihtb.am
 www.ihtb.am

 **Australia**
DKSH Australia Pty Ltd.
 14-17 Dansu Court Hallam
 3803 Victoria, AUSTRALIEN
 Tel.: +61 3/95 54 66 66
 Fax: +61 3/95 54 66 77
 info@dksh.com.au

 **Austria**
Lapp Austria GmbH
 Brementstraße 8
 A-4030 Linz
 Tel.: +43 732/78 12 72 4 44
 Fax: +43 732/78 12 72 34
 sales@lappaustria.at
 www.lappaustria.at

 **Azerbaijan**
Mikhail Ali-Zadeh
 Gara Sheher 35
 1025 Bakı
 Tel.: +994 12/4 24 89 73
 Fax: +994 12/4 49 92 70
 ims.inc@azdata.net

 **Belarus**
PNS „Professional Network Systems“
 House 65b-308, Timirjaseva Str.
 220035 Minsk
 Tel.: +375 17/2 90 83 72
 Fax: +375 29/6 88 84 72
 info@pns.by
 www.pns.by

 **Belgium - Luxembourg**
Lapp Benelux B.V.
 Van Dijklaan 16,
 NL - 5581 WG Waalre
 Postbus 74 , NL - 5580 AB Waalre
 Tel.: +32 (0) 78 35 30 60
 Fax: +32 (0) 78 35 30 65
 info.lappbenelux@lappgroup.com
 www.lappbenelux.com

 **Brazil**
Cabos Lapp Brasil Ltda.
 Av. Dr. Mauro Lindemberg
 Monteiro, 628
 Galpao 18, Osasco
 CEP 06278-010 Sao Paulo
 Tel.: +55 11/21 66 41 66
 Fax: +55 11/21 66 41 65
 vendas@lappbrasil.com.br
 www.lappbrasil.com.br

 **Bulgaria**
V&V Isomatic Ltd.
 128, Yanko Sakazov blvd.
 1505 Sofia
 Tel.: +359/29 58 31 11
 Fax: +359/29 58 22 70
 v.v@techno-link.com
 www.viv-isomatic.com

 **Canada**
Lapp Canada
 3505 Laird Road, Unit 10
 L5L 5Y7 Mississauga, Ontario
 Tel.: +905/8 20 54 92
 Fax: +905/8 20 65 16
 sales@lappcanada.com
 www.lappcanada.com

 **Chile**
Desimat Chile
 Av. Puerto Vespucio 9670
 Parque Industrial Puerto Santiago
 Pudahuel, Santiago
 Tel.: +56 2/5 85 12 00
 Fax: +56 2/7 47 01 53
 importaciones@desimat.cl
 www.desimat.cl

 **China**
Lapp Kabel Shanghai Co., Ltd.
 23A Zhaofeng Universe Building
 1800 Zhongshan Road West
 Shanghai 200235
 Tel.: +86 21/64 40 08 33
 Fax: +86 21/64 40 08 34
 info@lappkabel.com.cn
 www.lappkabel.com.cn

 **Costa Rica**
Elvatrón, SA
 De Rapifreno en La Uruca
 400 metros Nte.
 San José, Costa Rica.
 Tel.: +506/22 42-99 55
 Fax: +506/25 20-06 97
 P.O. Box 8-3770 (1000)
 elvatron@elvatron.com
 www.elvatron.com

 **Colombia**
Transmisiones Ltda.
 Carrera 69 B No. 21 A 48 Bodega
 UE 28-9 Parque Industrial Salitre
 Bogotá, D.C.
 Tel.: +57 1/4 12 68 98
 Fax: +57 1/31 53 31 52 21
 info@transmisiones.de

 **Croatia**
TIM KABEL
 Savska cesta 103
 10360 Zagreb - Sesvete
 Tel.: +385 (1) 5 55 59 00
 Fax: +385 (1) 5 55 59 01
 zagreb@tim-kabel.hr
 www.tim-kabel.hr

 **Cyprus**
MARIOS KARANTONIS LTD
 6 Pentadactilou Street, CY-2682
 P.O. Box 14509, CY-2690
 Paleometochi, Nicosia
 info@karantonis.com.cy
 www.karantonis.com.cy

 **Czech Republic**
LAPP KABEL s.r.o.
 Bartosova 315
 765 02 Otrokovice
 Tel.: +420/5 73 50 10 11
 Fax: +420/5 73 39 46 50
 info@lappgroup.cz
 www.lappgroup.cz

 **Denmark**
Miltronik
 Korskildeng 6
 2670 Greve
 Tel.: +45 43/95 00 10
 Fax: +45 43/95 00 09
 info@miltronik.dk
 www.miltronik.dk

 **Ecuador**
ELSYSTEC S.A.
 Electricidad Sistemas y Tecnologia
 Vasco de Contreras y
 Mañosa 35-251
 Quito
 Tel.: +593 2/2 45 56 98
 Fax: +593 2/2 45 56 98
 info@elsystec.com.ec

 **El Salvador**
INTEK EL SALVADOR S.A. de C.V.
 Calle Gabriela Mistral No. 373
 Entre Blvd.Los Héroes y 33 Ave. NTE,
 C. A.
 San Salvador, El Salvador
 Tel.: +503/22 60-88 88
 Fax: +503/22 60-88 55
 inteksv@intek-ca.com
 www.intek-ca.com

 **Estonia**
Lapp Miltronik SIA Eesti Filiaal
 Kastani pst 10
 44307 Rakvere
 Tel.: +372/6 51 89 70
 Fax: +372/6 51 89 71
 orders@lappmiltronik.lv
 www.lappmiltronik.ee

 **Finland**
EPIC®
ENERGEL OY
 Atomitie 1
 00370 Helsinki
 Tel.: +358 9/54 07 13 13
 Fax: +358 9/54 07 13 30
 energel@energel.com
 www.energel.com

SKS Automaatio Oy
 Martinkyläntie 50
 P.O. Box 122
 01721 Vantaa
 Tel.: +358 2/07 64 61
 Fax: +358 2/07 64 68 20
 automaatio@sksf.fi
 www.sks.fi

 **France**
Lapp France s.a.r.l.
 Technopôle Forbach-Sud BP 50084
 57602 Forbach Cedex
 Tel.: +33 387/84 19 29
 Fax: +33 387/84 17 94
 lappfrance@lappgroup.com
 www.lappfrance.fr

LAPP MULLER SAS
 Z.A. du Grand Pont
 83310 Grimaud
 Tel.: +33 494/56 65 00
 Fax: +33 494/4 34 87
 info@mullercables.com
 www.mullercables.com

 **Georgia**
INSTA Ltd.
 8, Zakariadze str.
 0177 Tbilisi
 Tel.: +995 32/20 20 20
 Fax: +995 32/20 20 22
 sales@insta.ge
 www.insta.ge

 **Germany**
U.I. Lapp GmbH
 Schulze-Delitzsch-Straße 25
 70565 Stuttgart
 Tel.: +49 711/78 38 01
 Fax: +49 711/78 38 26 40
 info@lappkabel.de
 www.lappkabel.de

Lapp Systems GmbH
 Oskar-Lapp-Str. 5
 70565 Stuttgart
 Tel.: +49 711/78 38 04
 Fax: +49 711/78 38 35 20
 info@lappkabel.de
 www.lappkabel.de

 **Great Britain**
Lapp Limited
 Unit 3 Perivale Park
 Horsenden Lane South
 UB6 7RL Greenford Middlesex
 Tel.: +44 20/87 58 78 00
 Fax: +44 20/87 58 78 80
 sales@lapplimited.com
 www.lapplimited.com

 **Greece**
Dimoulas Special Cables S.A.
 100-102 Lenorman Str.
 10444 Athens
 Tel.: +30 21/05 15 76 10
 Fax: +30 21/05 15 76 11
 info@dimoulas.gr
 www.dimoulas.gr

 **Guatemala**
INTEK GUATEMALA, S.A.
 Via 5 y Ruta 3 4-35 Zona 4
 C.P. 01004
 Guatemala, GUA
 Tel.: +502/23 61-59 77
 Fax: +502/23 34-43 38
 intekgt@intek-ca.com

 **Honduras**
INTEK HONDURAS, S.A. DE C.V.
 3ra. Ave. entre 10 y 11 calle
 N.O., local #9, EDIFICIO SIKABUN,
 Barrio Las Acacias
 San Pedro Sula HON
 Honduras, C.A.
 Tel.: +504/5 50 31 16
 Fax: +504/5 57 80 16
 intekhn@intek-ca.com

 **Hong Kong**
Worldtex & Co.
 Unit 11, 11/F, Tins Enterprises
 Centre
 777 Lai Chi Kok Rd.
 Cheung Sha Wan
 Kowloon, Hong Kong
 Tel.: +85 22/7 81 18 60
 Fax: +85 22/7 81 47 33
 info@worldtex-co.com.hk

 **Hungary**
Lapp Austria GmbH m. k. k.
 Neumann János u.1
 2040 Budaörs
 Tel.: +36 23/501-250
 Fax: +36 23/501-259
 sales@lappgroup.hu
 www.lappgroup.hu

 **India**
Lapp India Pvt. Ltd.
 Lapp India No.98, J & K
 Jigani Industrial Area, II Phase
 Bangalore South - 560 105
 Tel.: +91 81 10/30 48 00
 Fax: +91 80 27/82 54 79
 info@lappindia.com
 www.lappindia.com

 **Indonesia**
PT. JJ-LAPP CABLE INDONESIA
 Graha INTI FAUZI, 7th Floor
 Jl. Buncit Raya No. 22
 Jakarta 12510 - Indonesia
 Tel.: +62 21 27 53 70 51
 Fax: +62 21 27 53 70 52
 sales_jji@jjsea.com
 www.jj-lappcable.com

 **Island**
Johan Rönning Ltd.
 Klettagardar 12
 104 Reykjavik
 Tel.: +354 5/20 08 00
 Fax: +354 5/20 08 88
 ronning@ronning.is
 www.ronning.is

 **Israel**
Arrow Control Cables Ltd.
 7, Zivan street
 49950 Nehalim
 Tel.: +972 3/9 07 48 87
 Fax: +972 3/9 07 48 89
 info@arrowcables.com
 www.arrowcables.com

 **Italy**
LAPP ITALIA S.R.L.
 Via Lavoratori Autobianchi 1
 Building 20
 20832 Desio - MB
 Tel.: +39 362/48 71
 Fax: +39 362/48 73 30-340
 lappitalia@lappitalia.it
 www.lappitalia.it

Camuna Cavi s.r.l.
 Via General Treboldi, 128
 25048 Edolo (BS)
 Tel.: +39 36/4 77 34 11
 Fax: +39 36/4 77 01 20
 info@camunacavi.it
 www.camunacavi.it

 **Japan**
K.Mecs Co., Ltd.
 Headquarters Yusen Iwamotocho
 Bldg. 3F
 2-3-3 Iwamotocho, Chiyodaku
 101-0032 Tokyo
 Tel.: +81 3/58 25 53 33
 Fax: +81 3/58 25 85 50
 info@kmecs.co.jp
 www.kmecs.com

 **Kazakhstan**
Alexandr Zemlyanoy SAR Sales
Area Representative
 Tel.: +7 7273/28 23 46
 Mob: +7 777/28 73 30
 Alexadr.Zemlyanoy@lappgroup.kz

 **Korea**
Lapp Korea Co., Ltd.
 7F, SongWon Bldg.
 92-2 YulJun JangAn
 SuWonCity, KyungGi
 440-824 Korea
 Tel.: +82 31/2 50 10 11
 Fax: +82 31/2 50 10 19

 **Latvia**
LAPP MILTRONIC SIA
Ulbrokas 44a
Riga, LV-1021
Tel.: +371/67 50 19 00
Fax: +371/67 50 19 09
pasutijumi@lappmiltronic.lv
www.lappmiltronic.lv

 **Libya**
Al jouda Co.
Al fath - Street
Al buraq - building
Third Floor
Benghazi - Libya
Tlf.: +218 91/7 43 33 63
ilsharee@yahoo.co.uk
kamal_ahf@yahoo.co.uk

 **Lithuania**
LAPP Miltronic UAB
P. Vileisio 18N
LT-10306 Vilnius
Tel.: +370 5/2 78 03 90
Fax: +370 5/2 78 03 97
info@lappmiltronic.lt
www.lappmiltronic.lt

 **Macedonia**
Siskon Doool
Taskenska 4A
1000 Skopje
Tel.: +389 2/3 06 24 23
Fax: +389 2/3 06 12 50
siskon@mt.net.mk
www.siskon.com.mk

 **Malaysia**
JJ-LAPP Cable (M) Sdn Bhd
16, Jalan 51A/225,
46100 Petaling Jaya Selangor
Tel.: +603/78 61 62 88
Fax: +603/78 61 62 99
sales_jjlm@jjsea.com
www.jj-lappcable.com

 **Malta**
G & E Electronics Ltd.
Genics Bldgs.
Giov. Papaffy Str.
B'KARA BKR 4021
Tel.: +356 21/48 68 16
Fax: +356 21/49 71 03
info@gemalta.com
www.gemalta.com

 **Mexico**
Lapp Mexico s de rl de C.V.
Metalurgia # 2730
Industrial El Alamo C.P.
44490 Tlaquepaque, Jalisco
Tel.: +52 33/36 66 02 50
Fax: +52 33/36 66 00 75
ventas@lappmexico.com
www.lappmexico.com

 **Republic of Moldova**
Licuri
Bd. Moskova, 20
2045 mun. Chisinau
Tel.: +3732/2 40 25 36/32 94 36
Fax: +3732/2 40 47 77
office@licuri.md

 **Mongolia**
MCS International Co. Ltd.
MCS Anun centera
Khan-Uul districta
3rd khoroo
Ulaanbaatar
Tel.: +976/34 63 63
Fax: +976/34 60 30
galbadrakh@mcs.mn
www.international.mcs.mn

 **Morocco**
Lasamari Energie & Produits S.A.R.L.
Rue Touki Ahmed No. 24
BD. HASSAN II
RESIDENCE OUROK
CASABLANCA
Tel.: +212 22 26/34-21, -17
Fax: +212 22 26/34 21
Lep@menara.ma

 **Netherlands**
Lapp Benelux B.V.
Van Dijkstraan 16,
NL - 5581 WG Waalre
Postbus 74 , NL - 5580 AB Waalre
Tel.: +31 (0) 40 228 50 00
Fax: +31 (0) 40 228 50 10
info.lappbenelux@lappgroup.com
www.lappbenelux.com

 **New Zealand**
Engineering Computer Services Ltd.
530 Te Rapa Road
P.O. Box 20204
Hamilton
Tel.: +64 7/8 49 22 11
Fax: +64 7/8 49 22 20
garry@lappgroup.co.nz
www.lappgroup.co.nz

 **Nicaragua**
EL-TEC
De la óptica Nicaraguense
3c al Este, 1/2 c al Sur
Residencial Bolonia, Managua
Tel.: +505/22 54-49 13
info@el-tec.com
www.el-tec.com

 **Nigeria**
Penz Williams Limited
Suite 7 Canaan Mall, Plot 2
Block 105 Lekki
Lagos
Tel.: +234 8037448810
Fax: +234 84 612169
info@penzwilliams.com
www.penzwilliams.com

 **Norway**
Miltronic AS
Eikveien 11
3036 Drammen
Tel.: +47 32/26 13 00
Fax: +47 32/2 61 39 8
info@miltronic.no
www.miltronic.no

 **Panamá**
CONTEC PANAMA
Consultores Electrotécnicos S.A.
Vía Tocumen, Plaza Conquistador
Local # 33
Panamá
Tel.: +507/2 33 51 19
Fax: +507/2 33 60 28
gerencia@consultorestecnicos.com
www.contecpanama.com

 **Peru**
DESIMAT PERU
Av. Velasco Astete 2371
Surco Lima Peru
Tel.: +51 1/2 75 27 65
Fax: +51 1/2 75 27 76
ventas@desimat.com.pe
www.desimat.com.pe

 **Philippines**
JJ-LAPP Cable (P) Inc
Unit 704, Total Corporate Center
1012 Triangle Drive
Bonifacio Global City
1634 Taguig City, Manila
Tel.: +632/786 7566
Fax: +632/786 7544
sales_jjlp@jjsea.com
www.jj-lappcable.com

 **Poland**
Lapp Kabel Sp. z o.o.
ul. Wroclawska 33 D
Dtugoleka, 55-095 Mirków
Tel.: +48 0 71/3 30 63 02
Fax: +48 0 71/3 30 63 06
info@lappolska.pl
www.lappkabel.pl

 **Portugal**
Policabos S.A.
Av. Pedro Álvares Cabral
Lugar da Capa Rota
2710-144 Sintra
Tel.: +351 21/9 17 86 40
Fax: +351 21/9 17 86 49
policabos@policabos.pt
www.policabos.pt

 **Rumania**
COELCO TRADE
Autostrada Bucuresti-Pitesti, km 13,5
A1 ind. park Polo Occidente/Hala M
Judet ILFOF, 077096
Tel.: +40/2 13 10 09-61, -62
Fax: +40/2 13 10 09-59, -89
coelco@dnt.ro
www.coelco.ro

 **Russia**
Lapp Russia OOO
Leninskaya St., 141
443041 Samara
Tel.: +7 846/3 73 17 17
Fax: +7 846/2 76 02 91
lappprussia@lappgroup.ru
www.lappgroup.ru

 **Serbia**
Vesimpex d.o.o.
Petra Konjovića 12v
Poslovni centar-Rakovica, ulaz C
11090 Beograd
Tel.: +381 11/35 10-6 83
Fax: +381 11/30 57-9 47
info@vesimpex.rs
www.vesimpex.rs

 **Singapore**
JJ-LAPP Cable (S) Pte Ltd
No.9 Tuas South St 3
Singapore 638017
Tel.: +65 65 08 62 00
Fax: +65 68 63 12 71
sales_jjls@jjsea.com
www.jj-lappcable.com

 **Slovakia**
LAPP SLOVENSKO, s.r.o.
Piaristicka 2
949 24 Nitra
Tel.: +421/3 76 57 80 95
Fax: +421/3 76 57 80 96
info@lappgroup.sk
www.lappgroup.sk

 **Slovenia**
FINEA TRADE d.o.o.
Limbuška cesta 2
2000 Maribor
Tel.: +386 2/4 21 35 55
Fax: +386 2/4 21 35 71
elektro@finea-trade.si
www.finea-trade.si

 **South Africa**
Lapp Group Southern Africa
51 Brunton Circle
Founders View South
Modderfontein
1645 Gauteng
Tel: +27 11/2 01 32 00
Fax: +27 11/6 09 58 50
info@lappkabel.co.za
www.lappcable.co.za

 **Spain**
Lapp Kabel España, S.L.U.
Avda. de les Garrigues, 34-36
Parque Empresarial Mas Blau II
Nave 1
E-08820 El Prat de Llobregat
(Barcelona)
Tel.: +34 902/10 86 69
Fax: +34 93/4 79 62 72
info@lappkabel.es
www.lappkabel.es

 **Sweden**
Miltronic AB
Kungshagsvägen 7
P.O. Box 1022
611 29 Nyköping
Tel.: +46 155/7 77 00
Fax: +46 155/7 77 01
info@miltronic.se
www.miltronic.se

Fleximark AB
Kungshagsvägen 9
P.O. Box 1022
61129 Nyköping
Tel.: +46 15/57 77 90
Fax: +46 15/57 77 91
info@fleximark.se
www.fleximark.se

 **Switzerland**
EPIC®
Bachofen AG
Ackerstraße 42
8610 Uster
Tel.: +41 44/9 44 11 11
Fax: +41 44/9 44 12 33
info@bachofen.ch
www.bachofen.ch

Volland AG
Ifangstrasse 103
8153 Rümlang
Tel.: +41 4 48 17 97 97
Fax: +41 4 48 17 97 00
info@volland.ch
www.volland.ch

 **Taiwan**
DKSH Taiwan Ltd.
10th Floor, No. 22, Lane 407
Tiding Blvd., Sec. 2
Neihu Technology Park
Taipei City 114-93, Taiwan, R.O.C.
Tel.: +886 2/87 52 76 51
Fax: +886 2/87 51 86 88
paul.lin@dksh.com

 **Thailand**
JJ-LAPP Cable (T) Ltd
23/110-117 Sorachai Building
25-29th FL
Soi Sukhumvit 63 (Ekamai),
Sukhumvit Road, Klongton Nua,
Wattana, Bangkok 10110
Tel.: +66 27 87 82 88
Fax: +66 27 87 82 99
sales_jjlt@jjsea.com
www.jj-lappcable.com

 **Turkey**
LAPP KABLO San.ve.Tic.Ltd.Şti.
Atatürk Bulvarı
Ayanoğlu İş Merkezi No: 1
34758 Ataşehir - İstanbul
Tel.: +90 216/4 56 56 99
Fax: +90 216/4 56 56-87, -89
info@lapp.com.tr
www.lapp.com.tr

 **Ukraine**
Lapp Ukraine LLC
201 - 203, Kharkivske shose
02121 Kiev
Tel.: +38 44/4 95 60 00
Fax: +38 44/4 90 76 30
info@lappukraine.com
www.lappukraine.com

 **United Arab Emirates**
LAPP Cables Middle East FZE
HQ Building A-502
Dubai Silicon Oasis
P.O. Box 341223
Tel.: +971 4/8 86 07 44
Fax: +971 4/8 86 07 42
lappme@lappgroup.com
www.lappgroup.com

 **Uruguay**
Reprinter Ltda.
Calle Dublin 2030
Montevideo
C.P.: 11500
Tel.: +598/26 00 73 43
Fax: +598/26 00 86 58
reprinter@multi.com.uy

 **USA**
Lapp USA, Inc.
29 Hanover Road
Florham Park, NJ 07932
Tel.: +1 973 660 9700
Fax: +1 973 660 9330
sales@lappusa.com
www.lappusa.com

Lapp Tannehill, Inc.
8675 Eagle Creek Parkway Suite 900
Savage, MN 55378
Tel.: +1 952/8 81 67 00
Fax: +1 952/8 81 07 43
sales@lapptannehill.com
www.lapptannehill.com

 **Uzbekistan**
Elektro-Potential LLC
2b,G.Mavlyanov str. off. 311
100084 Tashkent
Tel.: +99 898/3 00 38 21
Fax: +99 871/1 24 92 86
mz1958@yandex.ru

 **Venezuela**
Somerinca C.A.
3era Transversal Dos Caminos
Quinta Corazon de Jesús
1070 Caracas
Tel.: +58 212/2 37 30 03
Fax: +58 212/2 39 93 41
klocmoeller@cantv.net

 **Vietnam**
Jebsen & Jessen Vietnam Co., Ltd
(JJ-Lapp Cable Division)
Sailing Tower, Unit 1206, 12 floor,
111A, Pasteur Street, District 1
Ho Chi Minh City, Vietnam
Tel.: +848/35 20 34 11
Fax: +848/38 27 26 77
sales_jjlv@jjsea.com
www.jj-lappcable.com

Brand quality from Stuttgart



ÖLFLEX® Power- and control cables

The world's first brand cable is available in the most varied of versions to match maximum requirements.

Key features: Oil-resistant, flexible and available to match almost any requirement or environmental condition – also free of halogens.

Fields of application: Multipurpose. Special variants are more and more in demand in the area of renewable energies.



UNITRONIC® Data communication systems

The ideal brand for fast, trend-setting and reliable data transfer.

Key features: UNITRONIC® are not only data lines, but also bus lines, which together with active sensor/actuator modules or gateways provide a perfect system for automation.

Fields of application: Measurement, control, regulation, bus or LAN networks.

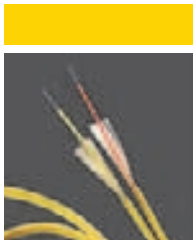

HITRONIC® Optical transmission systems

The brand for split-second, fault-free, intercept-free data transport.

Key features: The HITRONIC® product range includes fibre optic cables in the most varied of versions, along with suitable accessories such as splice boxes, wall distributors or couplings.

Fields of application: Office and industrial sector.



SKINTOP® Cable glands

The brand for multipurpose cable entries in line with the following: quickly fastened, centred and hermetically sealed.

Key features: Large clamping areas, optimum strain reliefs, the most diverse of versions such as SKINTOP® CLICK, COLD or CUBE.

Fields of application: Everywhere, where cables must be fastened reliably and quickly.

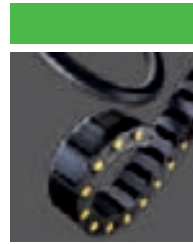

SILVYN® Protective cable conduit- and cable carrier systems

The brand for all-round cable protection.

Key features: The product range includes SILVYN® cable protection hoses for perfect protection against mechanical and chemical loads, along with SILVYN® CHAIN energy supply chains for highly-dynamic applications.

Fields of application: Everywhere that cables have to be additionally protected or routed.



EPIC® Industrial connectors

The brand for strong and reliable connections.

Key features: Robust square and circular connectors. Flexible system consisting of housings, inserts, contacts and accessories – for every requirement, the tailor-made solution. Similarly, EPIC® SOLAR plugs for photovoltaics are also part of the extensive product range.

Fields of application: Mechanical and systems engineering, and drive technology.



ETHERLINE® Data communication systems for ETHERNET-Technology

The brands for network solutions, safety systems and firewalls in the industrial networking sector.

Key features: Integral system consisting of hardware (switches, routers, cables, plugs etc.), software, consulting, network design and support.

Fields of application: Factory automation.



FLEXIMARK® Cable marking products

The brand for permanent, clearly-arranged cable markings.

Key features: Comprehensive range – from manual labelling solutions onto digital identification. Withstands high chemical, thermal and mechanical loads.

Fields of application: All cables.

Tailored connections for electric mobility

New environmentally friendly mobility concepts, particularly e-mobility (hybrid and purely electric vehicles), are a major trend. It is expected that a worldwide mass market will be formed within a few years – with completely new requirements for the cabling of vehicles.

The Lapp Group is a pioneer of e-mobility: with the LAPP CHARGE®, it was one of the

first companies to develop a co-ordinated, production-ready and complete charging system with cables and connector that complies with all conventional safety standards. The design and colour scheme can be adjusted according to the specific requirements of customers. Drivers of electric and hybrid vehicles are impressed by the charging system and its appealing, user-friendly design.

Lapp not only makes products used when charging, but also offers patented high-voltage cabling for connecting the individual cells in energy storage devices and supplying electric motors with power. Even today, the automotive supplier Continental uses special system connections made by Lapp for the series production of energy storage devices in two high-class hybrid vehicles. Lapp additionally works in collaboration with renowned companies that are currently developing new and increasingly powerful battery systems.

More information
www.lappkabel.com/industries

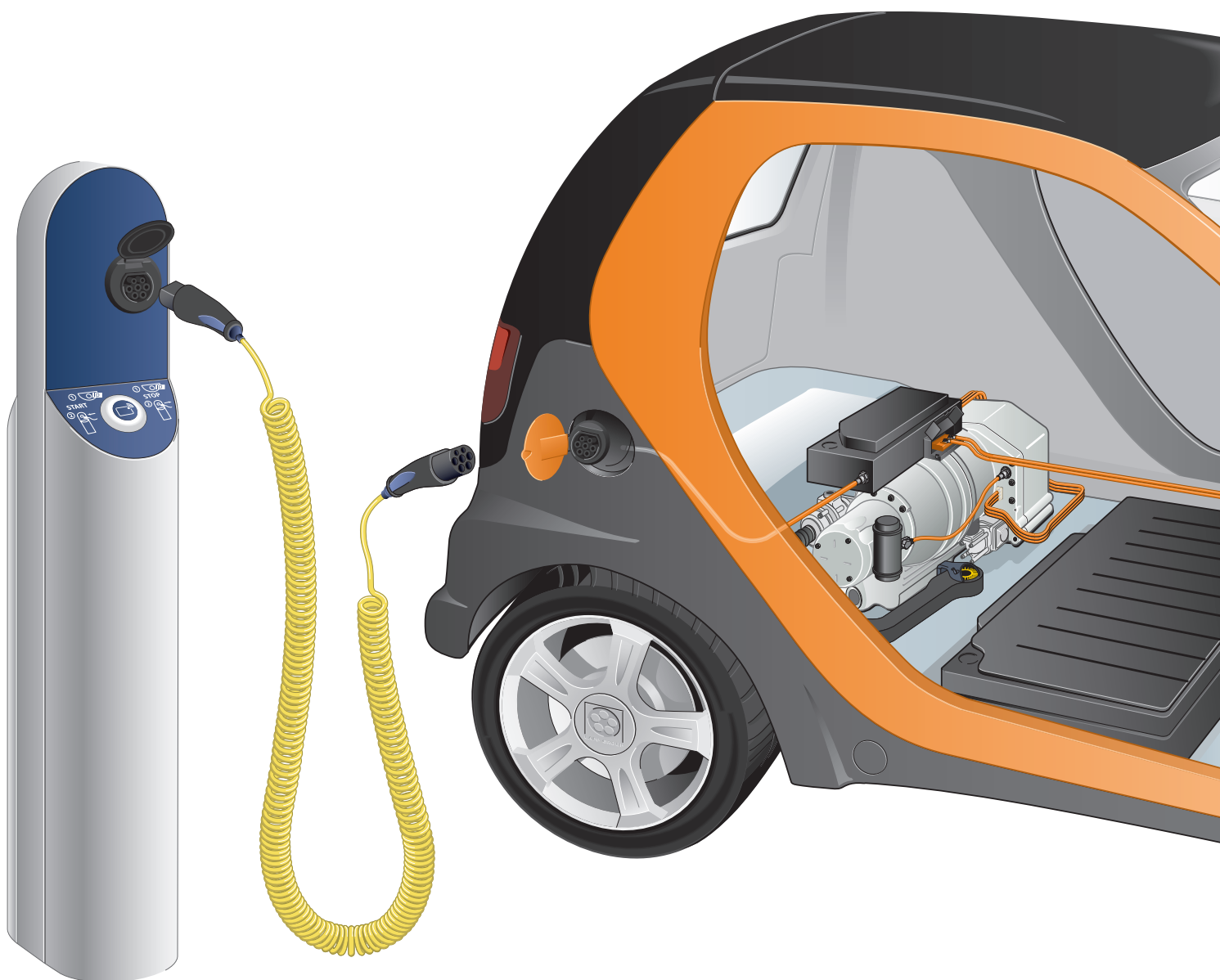



Welcome to the client specialist

Sometimes, more than 40,000 standard articles are just not enough. With Lapp Systems you have a specialist within the Lapp Group on hand for customer-specific assembly of cable and line systems, spiral special cables, power carrying systems and special applications with and without coating.

Cable and line systems

- Complete cable sets for mechanical & systems engineering, commercial-vehicle industry and lots more
- Prewired switching units for electronic and control systems
- Assembled single wires
- Ready-to-install connecting cables with special connectors
- Assembled optical fibres
- High-temperature cables with temperature-resistant special connectors

Spiral cables

- For trucks as supply and EBS/ABS coils
- As standard lines
- Made of lines specially assembled for the customer
- Spiral hoses with single wires and lines
- Special versions in cone shape

Energy supply systems

- Ready-to-install energy supply systems in plastic or metal versions. Also with hydraulic and pneumatic lines or mechanical joining technology

Special applications

- Wiring systems for robot applications
- Conductive fabric cable for energy and data systems

Lapp Muller, the specialist for tailor-made cables

Our specialist for somewhat unusual cables is located in France's Grimaud. For example, special lines for the maritime environment are produced there. But special cables from Lapp Muller were also used for the control and actuation of drilling platform valves. As if that wasn't enough: Be it special cables for aircraft supply, for port installations, high-tech robots or even for safety cables for aerial tramways and chair lifts – our experts develop and manufacture the perfect cable to match your particular requirements.

We put quality through a tough test

Multimillion bending cycles at maximum speeds and minimum bending radii. This is only one of many tests that a highly-flexible line has to withstand to be accepted into our standard product range.

Next to what in part are brute-force tests and stringent endurance tests, radiological methods are also used. For example, the special X-ray method EDX, with which the mineral content of human bone tissue is measured. We use EDX to trace any possible toxic substances or RoHS substances in cables and other products.

With this in mind: You are very welcome to put your own products through their paces in our trial and test centre.



Wide range use

PVC sheath and coloured cores

New

ÖLFLEX® CLASSIC 100



Info

- Change to new articles with reduced insulation wall thickness up to 1,5 mm²
- Advantage: less space required and improved installation possibilities, other features remain unchanged

Benefits

- Space saving installation due to small cable diameters
- High electrical performance due to 4kV test voltage
- Increased flexibility due short-twisted conductor layers

Application range

- Plant engineering and construction
Industrial machinery
Air conditioning installations
Power station
- Dry or damp interiors under medium mechanical load conditions
- Fixed installation as well as occasional flexing at free, non-continuously recurring movement without tensile load

Product features

- Flame retardant according to IEC 60332-1-2
- Good chemical resistance
see Main Catalogue 2010/11 Appendix T1

Approvals (Norm references)



Design

- Fine strands of bare copper wires
- PVC insulation LAPP P8/1
- Cores twisted in layers
- PVC outer sheath, grey (RAL 7001)

Technical data

- Core identification code**
Up to 5 cores: according to VDE 0293-308 (Main Catalogue 2010/11 Appendix T9)
- Based on**
HD 21.13 S1; VDE 0281 Part 13
- Specific insulation resistance**
> 20 GOhm x cm
- Conductor stranding**
Fine wire in accordance to VDE 0295 Class 5 / IEC 60228 Class 5
- Minimum bending radius**
Occasional flexing: 15 x cable diameter
Fixed installation: 4 x cable diameter
- Rated voltage**
Up to 1.5 mm²: U₀/U: 300/500 V
- Test voltage**
4000 V
- Protective conductor**
G = with protective conductor GN/YE
X = without protective conductor
- Range of temperature**
Occasional flexing: -5°C up to +70°C
Fixed installation: -40°C up to +80°C

New parts				
Part number „new“	Number of cores and mm ² per conductor	Outer diameter in mm approx. „new“	Copper index kg/km	Weight kg/km approx. „new“
ÖLFLEX® CLASSIC 100; U₀/U: 300/500 V				
00100004	2 X 0,5	4,8	9,6	35
00100014	3 G 0,5	5,1	14,4	42
00101224	3 X 0,5	5,1	14,4	42
00100024	4 G 0,5	5,7	19,2	54
00101234	4 X 0,5	5,7	19,2	54
00100034	5 G 0,5	6,2	24,0	63
00101244	5 X 0,5	6,2	24,0	63
00100214	2 X 0,75	5,4	14,4	45
00100224	3 G 0,75	5,7	21,6	55
00101254	3 X 0,75	5,7	21,6	55
00100234	4 G 0,75	6,2	28,8	66
00101264	4 X 0,75	6,2	28,8	66
00100244	5 G 0,75	6,7	36,0	79
00101274	5 X 0,75	6,7	36,0	79
00100414	2 X 1	5,7	19,2	53
00100424	3 G 1	6,0	28,8	65
00102034	3 X 1	6,0	28,8	65
00100434	4 G 1	6,5	38,4	79
00102044	4 X 1	6,5	38,4	79
00100444	5 G 1	7,1	48,0	94
00102054	5 X 1	7,1	48,0	94
00100634	2 X 1,5	6,3	28,8	68
00100644	3 G 1,5	6,7	43,0	84
00101284	3 X 1,5	6,7	43,0	84
00100654	4 G 1,5	7,2	58,0	104
00101294	4 X 1,5	7,2	58,0	104
00100664	5 G 1,5	8,1	72,0	128
00101304	5 X 1,5	8,1	72,0	128

Previous parts		
Part number „old“	Outer diameter in mm approx. „old“	Weight kg/km approx. „old“
ÖLFLEX® CLASSIC 100; U₀/U: 300/500 V		
0010000	5,4	42
0010001	5,7	50
00101223	5,7	50
00100023	6,2	60
00101233	6,2	60
00100033	6,7	71
00101243	6,7	71
0010021	6,2	56
0010022	6,5	67
00101253	6,5	67
00100233	7,1	81
00101263	7,1	81
00100243	8,0	99
00101273	8,0	99
0010041	6,5	64
0010042	6,9	78
00102033	6,9	78
00100433	7,7	97
00102043	7,7	97
00100443	8,4	105
00102053	8,4	105
0010063	7,5	87
0010064	8,1	109
00101283	8,1	109
00100653	8,9	133
00101293	8,9	133
00100663	10,0	164
00101303	10,0	164

All product related values as shown are nominal values unless specified differently. Further values, e.g. tolerances we submit on request - if available and released for publication.
Copper price basis: EUR 150 / 100 kg; For utilization and definition of 'Metal price basis' and 'Metal index' see Main Catalogue 2010/11 Appendix T17
Please find our standard lengths at: www.lappkabel.de/en/cable-standardlengths
Packaging size: Coil ≤ 30 kg and ≤ 250 m, otherwise drum
Please specify the desired packaging size (e.g. 1 x 500 m drum or 5 x 100 m coils)
Single lengths for sizes: ≥ 5G50 max. 500m; ≥ 5G95 max. 400; ≥ 3G120 max. 500m; ≥ 4G120 max. 300; ≥ 4G185 max. 250m
Photographs are not to scale and do not represent detailed images of the respective products.

Comparable products

- UNITRONIC® 100
- ÖLFLEX® CLASSIC 100 BK POWER 0,6/1kV
- ÖLFLEX® CLASSIC 130 H BK 0,6/1kV

Accessories

- SKINTOP® CLICK
- TY - FAST® standard cable ties
- STAR STRIP stripping tool

New

ÖLFLEX® CHAIN 815 CY

Screened, PVC- insulated, numbered, PVC- sheath

LAPP KABEL STUTTGART ÖLFLEX® CHAIN 815 CY



Info

- Addendum of the ÖLFLEX® FD CLASSIC 810 CY Serie
- EMC compliant

Benefits

- Economic solution
- Compact design

Application range

- In power chains or moving machine parts
- Use in measuring, control and regulating circuits
- Assembly lines, production lines, in all kinds of machines
- Plant engineering

Product features

- Low adhesive surface
- Flame retardant according to IEC 60332-1-2
- In damp and wet rooms
- Designed for continuous flex usage in power chains
- Outdoor use only with UV protection and in accordance with the temperature range.

Approvals (Norm references)



- For travel distances up to 10 m.
- Usage in Power Chains: Please comply with the assembly guidelines Main Catalogue 2010/11 Appendix T3

Design

- Extra fine strands of plain copper wires (Class 6)
- Core insulation: PVC
- Cores twisted in layers in short lay lengths
- Nonwoven wrapping
- Tinned copper braid
- PVC outer sheath, grey (RAL 7001)

Technical data

- Core identification code**
Black with white numbers acc. to VDE 0293
- Based on**
HD 21.13 S1; VDE 0281 Part 13
- Specific insulation resistance**
> 20 GOhm x cm
- Conductor stranding**
Extra fine wire in acc. to VDE 0295 Cl.6 / IEC 60228 Cl.6
- Minimum bending radius**
For flexible applications: 7.5 x outside diameter
Static:
4 x cable diameter
- Rated voltage**
300/500 V
- Test voltage**
Core/core: 4000 V
Core/screen: 2000 V
- Protective conductor**
G = with protective conductor GN/YE
X = without protective conductor
- Range of temperature**
Flexing: 0°C up to +70°C
Fixed installation: -40°C up to +80°C

Part number	Number of cores and mm ² per conductor	Outer diameter in mm	Copper index kg/km	Weight kg/km
1026801	2 X 0.5	5.9	31.0	58
1026803	3 G 0.5	6.3	38.0	70
1026805	4 G 0.5	6.9	44.0	85
1026807	5 G 0.5	7.4	52.0	98
1026808	7 G 0.5	8.8	68.0	148
1026809	12 G 0.5	10.3	96.0	191
1026810	18 G 0.5	12.2	148.0	263
1026811	25 G 0.5	14.5	195.0	374
1026812	2 X 0.75	6.3	38.0	69
1026814	3 G 0.75	6.8	46.0	82
1026815	4 G 0.75	7.4	57.0	113
1026816	5 G 0.75	8.0	66.0	130
1026817	7 G 0.75	9.5	89.0	168
1026818	12 G 0.75	11.2	124.0	243
1026819	18 G 0.75	13.7	199.0	357
1026820	25 G 0.75	16.0	265.0	466
1026821	2 X 1.0	6.7	44.0	78
1026823	3 G 1.0	7.2	55.0	97
1026825	4 G 1.0	7.9	68.0	121

Part number	Number of cores and mm ² per conductor	Outer diameter in mm	Copper index kg/km	Weight kg/km
1026826	5 G 1.0	8.8	77.0	147
1026827	7 G 1.0	10.4	102.0	194
1026828	12 G 1.0	12.2	178.0	289
1026829	18 G 1.0	14.7	249.0	430
1026830	25 G 1.0	17.4	361.0	572
1026831	2 X 1.5	7.4	55.0	94
1026833	3 G 1.5	8.0	71.0	131
1026835	4 G 1.5	8.9	87.0	169
1026836	5 G 1.5	9.7	106.0	199
1026837	7 G 1.5	11.5	138.0	259
1026838	12 G 1.5	13.9	238.0	395
1026839	18 G 1.5	16.4	341.0	555
1026840	25 G 1.5	19.6	485.0	777
1026841	2 X 2.5	8.9	80.0	144
1026842	3 G 2.5	9.6	113.0	191
1026843	4 G 2.5	10.8	156.0	235
1026844	5 G 2.5	12.0	189.0	289
1026845	7 G 2.5	14.4	255.0	408

All product related values as shown are nominal values unless specified differently. Further values, e.g. tolerances we submit on request - if available and released for publication.

Copper price basis: EUR 150 / 100 kg; For utilization and definition of 'Metal price basis' and 'Metal index' see Main Catalogue 2010/11 Appendix T17

Please find our standard lengths at: www.lappkabel.de/en/cable-standardlengths

Packaging size: Coil ≤ 30 kg and ≤ 250 m, otherwise drum

Please specify the desired packaging size (e.g. 1 x 500 m drum or 5 x 100 m coils)

Photographs are not to scale and do not represent detailed images of the respective products.

Comparable products

- ÖLFLEX® FD CLASSIC 810 CY
- ÖLFLEX® FD CLASSIC 810 CP
- ÖLFLEX® CHAIN 815 CP see page 10
- ÖLFLEX® FD 820 CH
- ÖLFLEX® CHAIN 879 CY

Accessories

- SKINTOP® MS-SC-M
- SILVYN® CHAIN Cable protection and guiding systems

New

ÖLFLEX® CHAIN 815 CP

Screened, PVC- insulated, numbered, PUR- sheath

LAPP KABEL STUÏTGART ÖLFLEX® CHAIN 815 CP CE



Info

- Abrasion and cut resistant
- EMC compliant
- Addendum of the ÖLFLEX® FD CLASSIC 810 CP Serie

Benefits

- Economic solution
- Compact design
- Wide range use

Application range

- In power chains or moving machine parts
- Especially in wet areas of machine tools and transfer lines subject to average mechanical stress
- Mechanical engineering
- Use in measuring, control and regulating circuits

Product features

- Low adhesive surface
- Oil resistant
- Flame retardant (IEC 60332-1-2)
- In dry, damp or wet interiors under medium mechanical load conditions
- Designed for continuous flex usage in power chains

Approvals (Norm references)



- For travel distances up to 10 m.
- Usage in Power Chains: Please comply with the assembly guidelines Main Catalogue 2010/11 Appendix T3

Design

- Extra fine strands of plain copper wires (Class 6)
- Core insulation: PVC
- Cores twisted in short lay lengths
- Nonwoven wrapping
- Copper braiding, tinned
- Polyurethane sheath (PUR), grey (RAL 7001)

Technical data

- Core identification code**
Black with white numbers acc. to VDE 0293
- Based on**
HD 21.13 S1; VDE 0281 Part 13
HD 22.10 (VDE 0282 Part 10)
- Specific insulation resistance**
> 20 GOhm x cm
- Conductor stranding**
Extra fine wire in acc. to VDE 0295 Cl.6 / IEC 60228 Cl.6
- Minimum bending radius**
For flexible applications: 7.5 x outside diameter
Static:
4 x cable diameter
- Rated voltage**
U₀/U:
300/500 V
- Test voltage**
Core/core: 4000 V
Core/screen: 2000 V
- Protective conductor**
G = with protective conductor GN/YE
X = without protective conductor
- Range of temperature**
Flexing: -5°C up to +70°C
Fixed installation: -40°C up to +80°C

Part number	Number of cores and mm ² per conductor	Outer diameter in mm	Copper index kg/km	Weight kg/km
1026851	2 X 0.5	5.9	31.0	55
1026852	3 G 0.5	6.3	38.0	68
1026853	4 G 0.5	6.9	44.0	82
1026854	5 G 0.5	7.4	52.0	94
1026855	7 G 0.5	8.8	68.0	144
1026856	12 G 0.5	10.3	96.0	185
1026857	18 G 0.5	12.2	148.0	257
1026858	25 G 0.5	14.5	195.0	365
1026859	2 X 0.75	6.3	38.0	66
1026860	3 G 0.75	6.8	46.0	79
1026861	4 G 0.75	7.4	57.0	114
1026862	5 G 0.75	8.0	66.0	126
1026863	7 G 0.75	9.5	87.0	165
1026864	12 G 0.75	11.2	124.0	230
1026865	18 G 0.75	13.7	199.0	349
1026866	25 G 0.75	16.0	265.0	456
1026867	2 X 1.0	6.7	44.0	75
1026868	3 G 1.0	7.2	55.0	94
1026869	4 G 1.0	7.9	68.0	117

Part number	Number of cores and mm ² per conductor	Outer diameter in mm	Copper index kg/km	Weight kg/km
1026870	5 G 1.0	8.8	77.0	142
1026871	7 G 1.0	10.4	102.0	188
1026872	12 G 1.0	12.2	178.0	281
1026873	18 G 1.0	14.7	249.0	420
1026874	25 G 1.0	17.4	361.0	559
1026875	2 X 1.5	7.4	55.0	90
1026876	3 G 1.5	8.0	71.0	127
1026877	4 G 1.5	8.9	87.0	164
1026878	5 G 1.5	9.7	106.0	193
1026879	7 G 1.5	11.5	138.0	252
1026880	12 G 1.5	13.9	238.0	386
1026881	18 G 1.5	16.4	341.0	543
1026882	25 G 1.5	19.6	485.0	760
1026883	2 X 2.5	8.9	80.0	139
1026884	3 G 2.5	9.6	113.0	186
1026885	4 G 2.5	10.8	156.0	229
1026886	5 G 2.5	12.0	189.0	281
1026887	7 G 2.5	14.4	255.0	398

All product related values as shown are nominal values unless specified differently. Further values, e.g. tolerances we submit on request - if available and released for publication.
Copper price basis: EUR 150 / 100 kg; For utilization and definition of 'Metal price basis' and 'Metal index' see Main Catalogue 2010/11 Appendix T17

Please find our standard lengths at: www.lappkabel.de/en/cable-standardlengths

Packaging size: Coil ≤ 30 kg and ≤ 250 m, otherwise drum

Please specify the desired packaging size (e.g. 1 x 500 m drum or 5 x 100 m coils)

Photographs are not to scale and do not represent detailed images of the respective products.

Comparable products

- ÖLFLEX® FD CLASSIC 810 CP
- ÖLFLEX® FD 855 CP
- ÖLFLEX® FD ROBUST C

Accessories

- SKINTOP® MS-SC-M
- SKINTOP® MS-M BRUSH
- SILVYN® CHAIN Cable protection and guiding systems

New

ÖLFLEX® SOLAR XLS-T

Electron beam cross-linked solar twin cable



Info

- Timesaving installation
- Temperature range -40°C up to +100°C
- Ideal for Stand-alone PV power systems

Benefits

- Timesaving installation
- Robust against mechanical impact
- Reduction of flame propagation as well as of toxic combustion gases in the event of fire
- Exact quantity control during installation by meter marking on the cable sheath

Application range

- Ideal for Stand-alone PV power systems
- Gable and flat roof photovoltaic systems
- Photovoltaic resp. solar fields

Product features

- Weathering-, abrasion and UV resistant
- Good heat pressure resistance
- Halogen-free and flame retardant
- Resistant against oxalic acid and sodium hydroxide
- Easy to split into single cables

Approvals (Norm references)



- Flame retardant according to IEC 60332-1-2
- Halogen-free according to EN 50267-2-1/-2, EN 60684-2
- Ozone resistant according to EN 50396
- Weather-/UV resistant according to HD 605/A1
- Acid-/Brine resistant according to EN 60811-2-1

Design

- Conductor: Fine wired tinned copper strands
- Core insulation: Electron beam cross-linked copolymer
- Outer sheath: Electron beam cross-linked Copolymer
- Outer sheath colour black

Technical data

- Core identification code**
black / red
blue / red
- Conductor stranding**
Fine wire in accordance to VDE 0295 Class 5 / IEC 60228 Class 5
- Minimum bending radius**
Fixed installation: 4 x cable diameter
- Rated voltage**
AC U₀/U : 600 / 1000 V
DC U₀/U : 900 / 1500 V
Max. permissible operating voltage:
DC 1800 V
- Test voltage**
AC 6500 V
- Range of temperature**
Fixed installation:
-40° C up to +100 °C

Part number	Number of cores and mm ² per conductor	Outer dimensions Width x height mm	Copper index kg/km	Weight kg/km
ÖLFLEX® SOLAR XLS-T - Core insulation: black / red				
0027150	2 X 2.5	10.8 x 5.4	48.0	90
0027152	2 X 4.0	12.0 x 6.0	76.8	144
0027154	2 X 6.0	14.2 x 7.1	115.2	204
ÖLFLEX® SOLAR XLS-T - Core insulation: blue / red				
0027151	2 X 2.5	10.8 x 5.4	48.0	90
0027153	2 X 4.0	12.0 x 6.0	76.8	144
0027155	2 X 6.0	14.2 x 7.1	115.2	204

All product related values as shown are nominal values unless specified differently. Further values, e.g. tolerances we submit on request - if available and released for publication.
Copper price basis: EUR 150 / 100 kg; For utilization and definition of 'Metal price basis' and 'Metal index' see Main Catalogue 2010/11 Appendix T17
Please find our standard lengths at: www.lappkabel.de/en/cable-standardlengths
Packaging size: Coil 100 m; Drum (500; 1000) m
Photographs are not to scale and do not represent detailed images of the respective products.

Comparable products

- ÖLFLEX® SOLAR XL multi

Accessories

- EPIC® SOLAR - Industrially injection over-moulded and field mountable solar connectors for safe connection of PV modules
- SKINTOP® ST / SKINTOP® CLICK - Approved cable glands for use for PV junction boxes, electric meters and DC/AC converters

New

ÖLFLEX® TRAFO XLv 1,8/3 kV

Flexible and mechanically robust single-conductor power cable



Info

- Voltage rating 1,8/3 kV
- Halogen-free and flame retardant
- Suitable for direct burial

Benefits

- Reinforced outer sheath offers enhanced protection against mechanical stress
- Extended temperature range for application in harsh climatic environmental conditions
- Reduction of flame propagation as well as of toxic combustion gases in the event of fire
- For outdoor use and considering general installation guidelines also suitable for direct burial
- Flexible and fine-wired conductor design enables easily on-site installation

Application range

- Applications with voltage rating 1,8/3 kV
- In the field of renewable energy as well as conventional power generation
- Photovoltaic resp. solar fields
- Drip loop installation in wind turbines
- As connection between the converter and the transformer substation

Product features

- Good weather-, abrasion-, temperature- and UV resistance
- Good heat pressure resistance
- Halogen-free and flame retardant
- Torsion-resistant up to ±150 °/mtr

Approvals (Norm references)



- Weather-/UV resistant according HD 605/A1
- Flame retardant according to IEC 60332-1-2
- Halogen free in accordance with IEC 60754-1
- Ozone resistant according EN 50396
- Acid-/Brine resistant according EN 60811-2-1

Design

- Conductor: Fine wired tinned copper strands
- Core insulation: Special polyolefin, cross-linked
- Outer sheath: Cross-linked copolymer
- Core insulation and outer jacket inseparably extruded together
- Outer sheath colour black

Technical data

- Core identification code**
Black
- Fire test**
Flame retardant acc. to IEC 60332-1-2
- Conductor stranding**
Fine wire in accordance to VDE 0295 Class 5 / IEC 60228 Class 5
- Minimum bending radius**
Occasional flexing: 15 x cable diameter
Fixed installation: 5 x outer diameter
- Rated voltage**
U₀/U: 1.8/3 kV
- Test voltage**
AC 6500 V
- Range of temperature**
Flexing: -40 °C up to +90 °C
Fixed installation: -40 °C up to +90 °C

Part number	Conductor cross section in mm ²	Outer diameter in mm	Copper index kg/km	Weight kg/km
ÖLFLEX® TRAFO XLv 1,8/3 kV				
1151010	95.0	22.1	912.0	1218
1151011	120.0	24.4	1,152.0	1496
1151012	150.0	25.9	1,440.0	1810
1151013	185.0	28.2	1,776.0	2184
1151014	240.0	30.3	2,304.0	2757
1151015	300.0	34.0	2,880.0	3407
1151016	400.0	37.6	3,840.0	4444

All product related values as shown are nominal values unless specified differently. Further values, e.g. tolerances we submit on request - if available and released for publication.
 Copper price basis: EUR 150 / 100 kg; For utilization and definition of 'Metal price basis' and 'Metal index' see Main Catalogue 2010/11 Appendix T17
 Please find our standard lengths at: www.lappkabel.de/en/cable-standardlengths
 Packaging size: Drum
 Photographs are not to scale and do not represent detailed images of the respective products.

Comparable products

- ÖLFLEX® SOLAR XLSv

Accessories

- Tube cable lugs KR/ KRT/ KRF
- V 1311 pressing pliers, hydraulic

New

UNITRONIC® BUS PB Y 7-W FC BK

Outdoor installation / UV-resistant



Benefits

- UV and weather resistant in black
- 7-W: 7-wire, eg. for applications where vibrations occur
- Fast Connect (FC) cable design
- Cables can be used for PROFIBUS-DP as well as PROFIBUS-FMS and FIP

Application range

- PROFIBUS® (in accordance with DIN 19245 and EN 50170, e.g. for SIEMENS SIMATIC® NET, also suitable for FIP - Factory Instrumentation Protocol).

Product features

- PVC compound TM2 acc. VDE 0281-1 or HD 21.1
- At room temperature mostly resistant against influence of acids, soaps, and determined oils

Approvals (Norm references)



Design

- Stranded conductor, 7-wire, bare
- Foam Skin - core isolation (O2YS)
- Aluminated foil
- Braided shielding made of tin-plated copper wires
- Outer sheath PVC, black

Suitable Connectors

- FC Strip stripping tool

Technical data

- Mutual capacitance**
(800 Hz): max. 30 nF/km
- Peak working voltage**
(not for power purposes) 250 V
- Minimum bending radius**
Fixed installation: 8 x outer diameter
Flexing: 15 x outer diameter
- Test voltage**
Core/core: 1500 V
Core/screen: 1500 V
- Range of temperature**
Flexing: -10°C up to +70°C
Fixed installation: -40°C up to +80°C
- Characteristic impedance**
150 +/- 15 Ohm

Part number	Article designation	Number of pairs and conductor diameter in mm	Outer diameter in mm	Copper index kg/km	Weight kg/km
2170310	UNITRONIC® BUS PB Y 7-W FC BK	1 x 2 x 0.64	7.8	30.1	80

All product related values as shown are nominal values unless specified differently. Further values, e.g. tolerances we submit on request - if available and released for publication.
 Copper price basis: EUR 150 / 100 kg; For utilization and definition of 'Metal price basis' and 'Metal index' see Main Catalogue 2010/11 Appendix T17
 Please find our standard lengths at: www.lappkabel.de/en/cable-standardlengths
 Packaging size: Coil ≤ 30 kg and ≤ 250 m, otherwise drum
 Please specify the desired packaging size (e.g. 1 x 500 m drum or 5 x 100 m coils)
 SIMATIC® is a registered trademark of SIEMENS AG. FIP is a registered trademark of World FIP
 Lapp Kabel is a member of the PROFIBUS user organisation (PNO)
 Photographs are not to scale and do not represent detailed images of the respective products.

New

ETHERLINE® Y CAT.5e BK 2x2AWG22/7



Benefits

- UV and weather resistant in black
- For flexible application (7 wire stranded conductor) = Type B
- FAST ETHERNET = 100 Mbit/s

Application range

- Many applications with Industrial Ethernet, e.g. PROFINET type B, e.g. fixed installation and flexible use.
- At room temperature mostly resistant against influence of acids, soaps, and determined oils

Product features

- PVC compound TM2 acc. VDE 0281-1 or HD 21.1

Approvals (Norm references)



Design

- Stranded conductor, 7-wire, bare
- Core insulation: Based on Polyolefin
- Star quad
- Aluminum coated foil
Screening braid of tinned copper wires
- PVC outer sheath

Technical data

- Peak working voltage**
(not for power purposes) 125 V
- Minimum bending radius**
Fixed installation: 10 x outer diameter
Flexing: 15 x outer diameter
- Test voltage**
Core/core: 1000 V
Core/shield: 500 V
- Range of temperature**
Flexing: -10°C up to +70°C
Fixed installation: -40°C up to +70°C
- Characteristic impedance**
At 1 - 100 MHz: 100 +/- 15 Ohm

Part number	Article designation	Paarzahl und AWG je Leiter	Outer diameter in mm max.	Copper index kg/km	Weight kg/km
2170901	ETHERLINE® Y CAT.5e BK 2x2AWG22/7	2 x 2 x AWG22/7	6.2	30.4	59

All product related values as shown are nominal values unless specified differently. Further values, e.g. tolerances we submit on request - if available and released for publication.
 Copper price basis: EUR 150 / 100 kg; For utilization and definition of 'Metal price basis' and 'Metal index' see Main Catalogue 2010/11 Appendix T17
 Please find our standard lengths at: www.lappkabel.de/en/cable-standardlengths
 Packaging size: Coil ≤ 30 kg and ≤ 250 m, otherwise drum
 Please specify the desired packaging size (e.g. 1 x 500 m drum or 5 x 100 m coils)
 PROFINET® is a registered trademark of the PNO (PROFIBUS user organisation)
 Photographs are not to scale and do not represent detailed images of the respective products.

New

EPIC® ULTRA H-B 6 TG LB

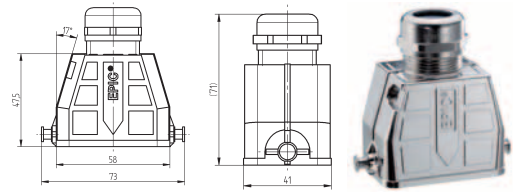

New

EPIC® ULTRA H-B 6 TS LB

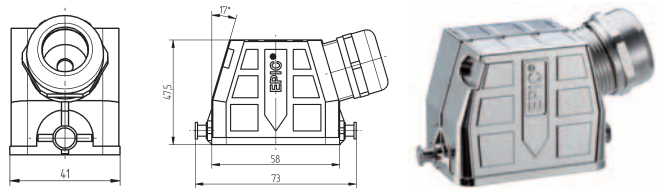

RoHS ✓



Info

- EMC protection
- Corrosion resistant
- SKINTOP® cable gland integrated

RoHS ✓



Info

- EMC protection
- Corrosion resistant
- SKINTOP® cable gland integrated

Benefits

- Optimal, low-resistance 360° screening
- All-purpose due to high corrosion resistance and a high environmental protection
- Space saving because of compact dimensions
- Faster than any other comparable system
- For higher mechanical stress

Application range

- In EMC critical environments
- For fixed and flexible applications in the field of machinery building and wind power plant engineering
- Construction machinery
- Drives

Product features

- The hoods and surface mount base come with integrated SKINTOP® cable gland
- Housings with addition BRUSH come with BRUSH cable screen contacting
- Mateable with standard housings
- Corrosion resistant according to DIN EN 6988

Suitable inserts

- EPIC® H-BE 6 Screw termination
- EPIC® H-DD 24
- EPIC® H-EE 10
- EPIC® MCR 6
- EPIC® H-BE 6 Crimp termination
- EPIC® H-BE 6 Cage clamp
- Additional support for selection of inserts and housings, please refer to the Main Catalogue 2010/11 Selection Table A10

Technical data

Material
 Housing: zinc die cast nickel plated
 Lever and bolts: stainless steel
 Sealing: NBR
 Cable gland
 Body: Nickel plated brass
 Insert: PA
 Seal: special elastomer

Degree of protection
 IP65

Range of temperature
 -40°C up to +100°C

Part number	Part	Cable clamping range	Minimum Ø above braiding in mm	Pieces / PU
H-B housing: Hood (straight cable entry, bolts for single lever)				
70250200	ULTRA H-B 6 TG LB 6-13	6 - 13		1
70250201	ULTRA H-B 6 TG LB 9-17	9 - 17		1
70250202	ULTRA H-B 6 TG LB 9-17 BRUSH	9 - 17	6	1
H-B housing: Hood (side cable entry, bolts for single lever)				
70250203	ULTRA H-B 6 TS LB 6-13	6 - 13		1
70250204	ULTRA H-B 6 TS LB 9-17	9 - 17		1
70250205	ULTRA H-B 6 TS LB 9-17 BRUSH	9 - 17	6	1

New

EPIC® ULTRA H-B 6 AG LB

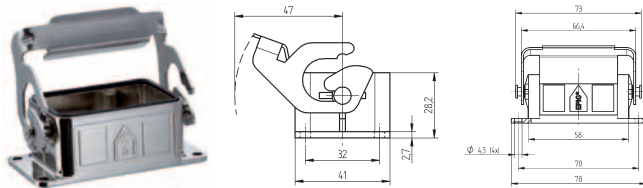

Info

- EMC protection
- Corrosion resistant
- SKINTOP® cable gland integrated

New

EPIC® ULTRA H-B 6 SGR LB

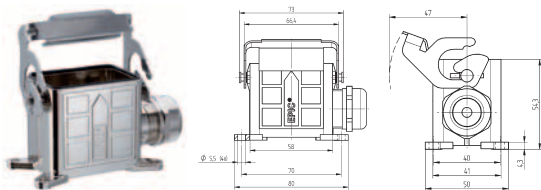

Info

- EMC protection
- Corrosion resistant
- SKINTOP® cable gland integrated

Benefits

- Optimal, low-resistance 360° screening
- All-purpose due to high corrosion resistance and a high environmental protection
- Space saving because of compact dimensions
- Faster than any other comparable system
- For higher mechanical stress

Product features

- The hoods and surface mount base come with integrated SKINTOP® cable gland
- Housings with addition BRUSH come with BRUSH cable screen contacting
- Mateable with standard housings
- Corrosion resistant according to DIN EN 6988

Application range

- In EMC critical environments
- For fixed and flexible applications in the field of machinery building and wind power plant engineering
- Construction machinery
- Drives

Suitable inserts

- EPIC® H-BE 6 Screw termination
- EPIC® H-DD 24
- EPIC® H-EE 10
- EPIC® MCR 6
- EPIC® H-BE 6 Crimp termination
- EPIC® H-BE 6 Cage clamp
- Additional support for selection of inserts and housings, please refer to the Main Catalogue 2010/11 Selection Table A10

Technical data

Material
 Housing: zinc die cast nickel plated
 Lever and bolts: stainless steel
 Sealing: NBR
 Cable gland
 Body: Nickel plated brass
 Insert: PA
 Seal: special elastomer

Degree of protection
 IP65

Range of temperature
 -40°C up to +100°C

Part number	Part	Cable clamping range	Minimum Ø above braiding in mm	Pieces / PU
H-B housing: Panel mount base (single lever)				
70250206	ULTRA H-B 6 AG LB			1
H-B housing: Surface mount base (1 cable entry, single lever)				
70250207	ULTRA H-B 6 SGR LB 6-13	6 - 13		1
70250208	ULTRA H-B 6 SGR LB 9-17	9 - 17		1
70250209	ULTRA H-B 6 SGR LB 9-17 BRUSH	9 - 17	6	1

New

EPIC® ULTRA H-B 10 TS QB



Info

- EMC protection
- Corrosion resistant
- SKINTOP® cable gland integrated

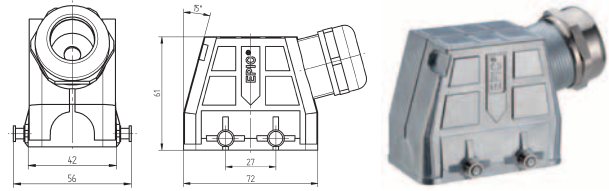

New

EPIC® ULTRA H-B 10 AG QB



Info

- EMC protection
- Corrosion resistant
- SKINTOP® cable gland integrated

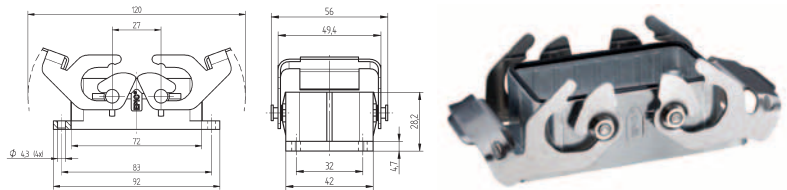

Benefits

- Optimal, low-resistance 360° screening
- All-purpose due to high corrosion resistance and a high environmental protection
- Space saving because of compact dimensions
- Faster than any other comparable system
- For higher mechanical stress

Application range

- In EMC critical environments
- For fixed and flexible applications in the field of machinery building and wind power plant engineering
- Construction machinery
- Drives

Product features

- The hoods and surface mount base come with integrated SKINTOP® cable gland

- Housings with addition BRUSH come with BRUSH cable screen contacting
- Mateable with standard housings
- Corrosion resistant according to DIN EN 6988

Suitable inserts

- EPIC® H-BVE 3
- EPIC® H-DD 42
- EPIC® H-EE 18
- EPIC® MCR 10
- EPIC® H-BE 10 Screw termination
- EPIC® H-BE 10 Crimp termination
- EPIC® H-BE 10 Cage clamp
- Additional support for selection of inserts and housings, please refer to the Main Catalogue 2010/11 Selection Table A10

Technical data

Material
 Housing: zinc die cast nickel plated
 Lever and bolts: stainless steel
 Sealing: NBR
 Cable gland
 Body: Nickel plated brass
 Insert: PA
 Seal: special elastomer

Degree of protection
 IP65

Range of temperature
 -40°C up to +100°C

Part number	Part	Cable clamping range	Minimum Ø above braiding in mm	Pieces / PU
H-B housing: Hood (side cable entry, bolts for double lever)				
70250210	ULTRA H-B 10 TS QB 7-15	7 - 15		1
70250211	ULTRA H-B 10 TS QB 11-21	11 - 21		1
70250212	ULTRA H-B 10 TS QB 11-21 BRUSH	11 - 21	8	1
H-B housing: Panel mount base (double lever)				
70250213	ULTRA H-B 10 AG QB			1

New

EPIC® ULTRA H-B 16 TS QB

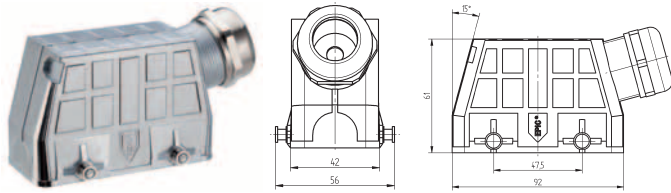

Info

- EMC protection
- Corrosion resistant
- SKINTOP® cable gland integrated

New

EPIC® ULTRA H-B 16 AG QB

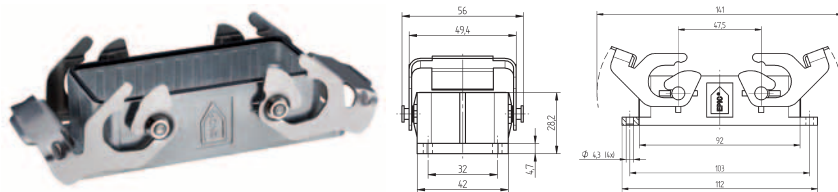

Info

- EMC protection
- Corrosion resistant
- SKINTOP® cable gland integrated

Benefits

- Optimal, low-resistance 360° screening
- All-purpose due to high corrosion resistance and a high environmental protection
- Space saving because of compact dimensions
- Faster than any other comparable system
- For higher mechanical stress

- Housings with addition BRUSH come with BRUSH cable screen contacting
- Mateable with standard housings
- Corrosion resistant according to DIN EN 6988

Suitable inserts

- EPIC® H-BS 6
- EPIC® H-BVE 6
- EPIC® H-DD 72
- EPIC® H-EE 32
- EPIC® MCR 16
- EPIC® H-D 40 machined
- EPIC® H-D 40 stamped
- EPIC® H-BE 16 Screw termination
- EPIC® H-BE 16 Crimp termination
- EPIC® H-BE 16 Cage clamp
- Additional support for selection of inserts and housings, please refer to the Main Catalogue 2010/11 Selection Table A10

Application range

- Construction machinery
- In EMC critical environments
- For fixed and flexible applications in the field of machinery building and wind power plant engineering
- Drives

Product features

- The hoods and surface mount base come with integrated SKINTOP® cable gland

Technical data



Material

Housing: zinc die cast nickel plated
Lever and bolts: stainless steel
Sealing: NBR
Cable gland
Body: Nickel plated brass
Insert: PA
Seal: special elastomer



Degree of protection

IP65



Range of temperature

-40°C up to +100°C

Part number	Part	Cable clamping range	Minimum Ø above braiding in mm	Pieces / PU
H-B housing: Hood (side cable entry, bolts for double lever)				
70250214	ULTRA H-B 16 TS QB 7-15	7 - 15		1
70250215	ULTRA H-B 16 TS QB 11-21	11 - 21		1
70250216	ULTRA H-B 16 TS QB 11-21 BRUSH	11 - 21	8	1
H-B housing: Panel mount base (double lever)				
70250217	ULTRA H-B 16 AG QB			1

New

EPIC® ULTRA H-B 24 TS QB



Info

- EMC protection
- Corrosion resistant
- SKINTOP® cable gland integrated

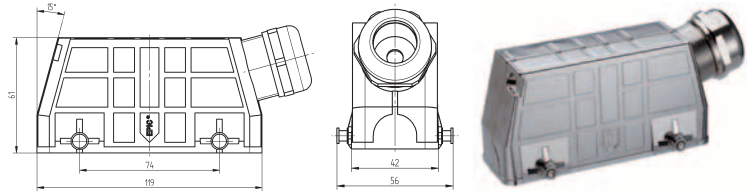

New

EPIC® ULTRA H-B 24 AG QB



Info

- EMC protection
- Corrosion resistant
- SKINTOP® cable gland integrated

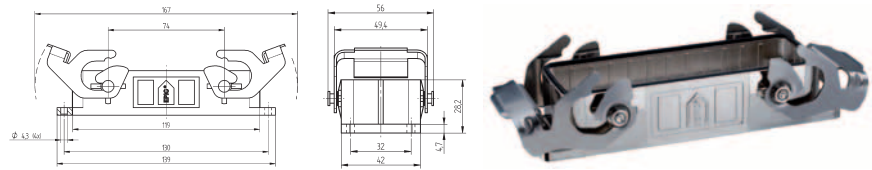

Benefits

- Optimal, low-resistance 360° screening
- All-purpose due to high corrosion resistance and a high environmental protection
- Space saving because of compact dimensions
- Faster than any other comparable system
- For higher mechanical stress

Application range

- In EMC critical environments
- For fixed and flexible applications in the field of machinery building and wind power plant engineering
- Construction machinery
- Drives

Product features

- The hoods and surface mount base come with integrated SKINTOP® cable gland

- Housings with addition BRUSH come with BRUSH cable screen contacting
- Mateable with standard housings
- Corrosion resistant according to DIN EN 6988

Suitable inserts

- EPIC® H-BVE 10
- EPIC® H-DD 108
- EPIC® H-EE 46
- EPIC® MCR 24
- EPIC® H-D 64 machined
- EPIC® H-D 64 stamped
- EPIC® H-BE 24 Screw termination
- EPIC® H-BE 24 Crimp termination
- EPIC® H-BE 24 Cage clamp
- Additional support for selection of inserts and housings, please refer to the Main Catalogue 2010/11 Selection Table A10

Technical data

Material
 Housing: zinc die cast nickel plated
 Lever and bolts: stainless steel
 Sealing: NBR
 Cable gland
 Body: Nickel plated brass
 Insert: PA
 Seal: special elastomer

Degree of protection
 IP65

Range of temperature
 -40 °C up to +100 °C

Part number	Part	Cable clamping range	Minimum Ø above braiding in mm	Pieces / PU
H-B housing: Hood (side cable entry, bolts for double lever)				
70250219	ULTRA H-B 24 TS QB 7-15	7 - 15		1
70250220	ULTRA H-B 24 TS QB 11-21	11 - 21		1
70250221	ULTRA H-B 24 TS QB 11-21 BRUSH	11 - 21	8	1
H-B housing: Panel mount base (double lever)				
70250222	ULTRA H-B 24 AG QB			1

New

FLEXIMARK® ULTRA L 12X8,5

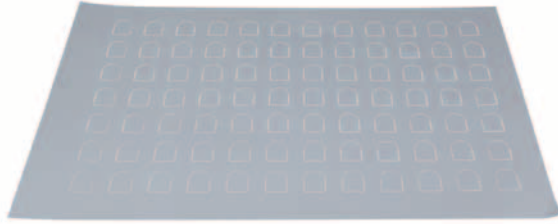

Info

- Sample labels on request

FLEXIMARK® ULTRA L 12X8,5

■ Suitable housing:

- EPIC® ULTRA H-B 6 page 15
- EPIC® ULTRA H-B 10 page 17
- EPIC® ULTRA H-B 16 page 18
- EPIC® ULTRA H-B 24 page 19

■ Benefits

- Printing with FLEXIMARK® Software
- Suits perfect the EPIC® ULTRA marking field dimensions

■ Application range

- Self-adhesive labels made from polyester foil for laser printers
- Special marking for EPIC® ULTRA hood

■ Approvals (Norm references)



■ Note

- Best printing results from laser printers are with straight sheet feed without going over rollers and without heat build-up
- Insert sheet in manual paper feed mode
- Use of original toner is recommended

■ Design

- Rounded corners
- Perforated sheets, approx. DIN A5

■ Technical data



On request

Also available in other colours on request.



Note

Adhesive strength: 15 N/25 mm



Colour delivered

silver grey



Material

Halogen-free polyester film
Thickness: 0.05 mm



Range of temperature

-40°C up to + 125°C
Working temperature: min. +10 °C

Part number	Article designation	Width x height mm	Labels per side	Labels / PU	PU
83252424	FLEXIMARK® ULTRA L	12.0 x 8.5	84	840	1

Photographs are not to scale and do not represent detailed images of the respective products.

■ Accessories

- FLEXIMARK® Software 10.0 see page 34

New

EPIC® Data PROFIBUS Connectors 35° Fast Connect

Info

- Interoperable to market standard

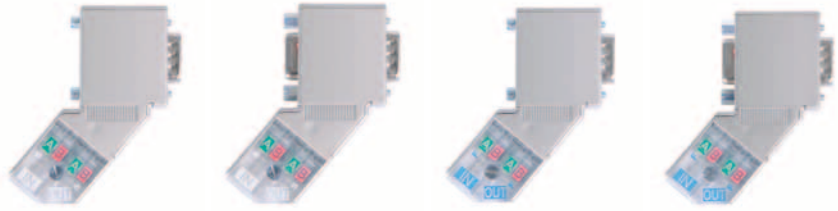

EPIC® Data PROFIBUS Connectors 35° Fast Connect

Benefits

- Qualified for FC cables
- Standardized interfaces
- Cost saving because of quick installation
- Easy to connect

Application range

- Automation technology
- Mechanical engineering
- Plant engineering
- Tool shop
- Control engineering

Product features

- Switchable terminating resistor integrated
- Switch can also be operated when the connector is plugged and setting is clearly visible
- If the switch is in the "ON" position the outgoing bus cable is disconnected
- When being used as a through connector (two cable connections, node) the switch must be in the "OFF" position, if being as a terminal resistor (one cable connection) the switch must be in the "ON" position

Approvals (Norm references)



- Sub-D connection / pin assignment in accordance with PROFIBUS

Design

- Sub-D plug, 9-pole
- Metalized housing
- Cable outlet 35°
- For cable diameter: 5.0 ... 8.0 mm
- Additional with programming/diagnostic interface (-PG): Sub-D socket, 9-pole

Suitable cables

- Cables for BUS-Systems PROFIBUS-DP/ FMS/FIP page 13
- Cables for BUS-System PROFIBUS-PA

Suitable tools

- FC Strip stripping tool

Technical data

- Dimensions**
95 mm x 70 mm x 17 mm (LxWxH)
- Connection type**
Fast Connect
- Pollution degree**
2
- Weight**
approx. 50 g
- Degree of protection**
IP20
- Outgoing cable**
35° angled
- Termination resistor**
Resistor combination integrated, connectable with slide switch
- Transmission rate**
max. 12 MBit/s
- Interfaces**
PROFIBUS-station:
SUB-D socket, 9-pole
PROFIBUS-cable:
FC standard cable, Ø 0.64 mm
- Current consumption**
max. 12.5 mA
- Permissible ambient conditions**
Surrounding air temperature:
0°C...+60°C
Transport and storage temperature:
-25°C...+80°C
Relative humidity:
max. 75% at +25°C
- Voltage consumption**
4.75 .. 5.25 V DC (device is energized)

Part number	Article designation	Outgoing cable	Cable types	PG	Pieces / PU
EPIC® Data PROFIBUS Connectors					
For solid cores					
21700511	ED-PB-35-FC	35°	Solid	no	1
21700513	ED-PB-35-PG-FC	35°	Solid	yes	1
For stranded cores					
21700514	ED-PB-35-FC-FLEX	35°	Flexible	no	1
21700515	ED-PB-35-PG-FC-FLEX	35°	Flexible	yes	1

All product related values as shown are nominal values unless specified differently. Further values, e.g. tolerances we submit on request - if available and released for publication.

Photographs are not to scale and do not represent detailed images of the respective products.

For detailed information please see www.lappautomation.com

New

EPIC® Data PROFIBUS Connectors 90° LED Fast Connect

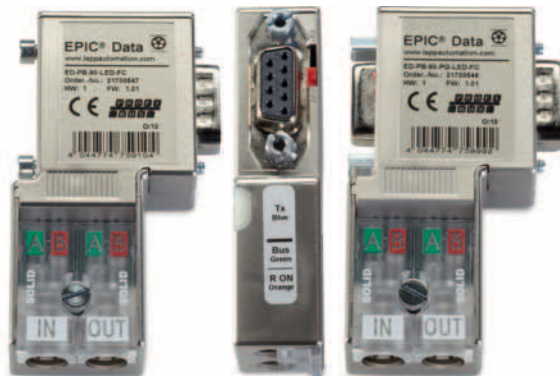

Info

- Interoperable to market standard

EPIC® Data PROFIBUS Connectors 90° LED Fast Connect

Benefits

- 3 status LEDs indicate: bus operation, station transmitting, terminating resistor
- Simplify status investigation
- Visual connection control
- Cost saving because of quick installation
- Easy to connect

Application range

- Automation technology
- Mechanical engineering
- Plant engineering
- Tool shop
- Control engineering

Product features

- Fast Connect
- Switchable terminating resistor integrated
- Switch can also be operated when the connector is plugged and setting is clearly visible
- When being used as a through connector (two cable connections, node) the switch must be in the "OFF" position, if being as a terminal resistor (one cable connection) the switch must be in the "ON" position
- If the switch is in the "ON" position the outgoing bus cable is disconnected

Approvals (Norm references)



- Sub-D connection / pin assignment in accordance with PROFIBUS

Design

- Sub-D plug, 9-pole
- Metalized housing
- Cable outlet 90°
- For cable diameter: 5.0 ... 8.0 mm
- Additional with programming/diagnostic interface (-PG): Sub-D socket, 9-pole

Suitable cables

- Cables for BUS-Systems PROFIBUS-DP/ FMS/FIP page 13
- Cables for BUS-System PROFIBUS-PA

Suitable tools

- FC Strip stripping tool

Technical data

- Dimensions**
64 mm x 40 mm x 17 mm (LxWxH)
- Connection type**
Fast Connect
- Pollution degree**
2
- Weight**
approx. 40 g
- Degree of protection**
IP20
- Outgoing cable**
90°
- Termination resistor**
Resistor combination integrated, connectable with slide switch
- Transmission rate**
max. 12 MBit/s
- Interfaces**
PROFIBUS-station:
SUB-D socket, 9-pole
PROFIBUS-cable:
FC standard cable,
Ø 0.64 mm
- Current consumption**
max. 35 mA
- Permissible ambient conditions**
Surrounding air temperature:
0°C...+60°C
Transport and storage temperature:
-25°C...+80°C
Relative humidity:
max. 75% at +25°C
- Voltage consumption**
4.75 .. 5.25 V DC
(device is energized)

Part number	Article designation	Outgoing cable	Cable types	PG	Pieces / PU
EPIC® Data PROFIBUS Connectors					
For solid cores					
21700547	ED-PB-90-LED-FC	90°	Solid	no	1
21700546	ED-PB-90-PG-LED-FC	90°	Solid	yes	1
For stranded cores					
21700549	ED-PB-90-LED-FC-FLEX	90°	Flexible	no	1
21700539	ED-PB-90-PG-LED-FC-FLEX	90°	Flexible	yes	1

All product related values as shown are nominal values unless specified differently. Further values, e.g. tolerances we submit on request - if available and released for publication. Photographs are not to scale and do not represent detailed images of the respective products. For detailed information please see www.lappautomation.com

New

EPIC® LS1.5 A1

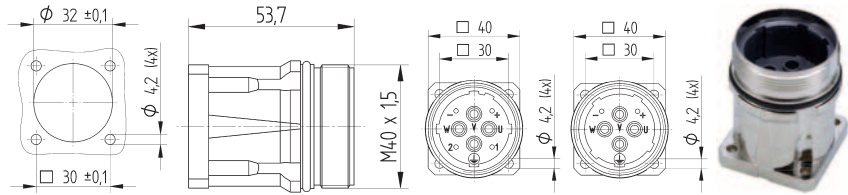

New

EPIC® LS1.5 A3

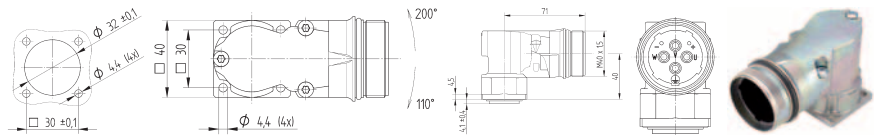

Suitable contacts:

- EPIC® LS1.5 Contacts male page 26
- The contacts have to be ordered separately

Benefits

- The power connectors with the contact configurations 3+PE+2 and 3+PE+4 are perfect suitable for servo motors and servo harnessings.
- Robust against mechanical impact

Application range

- Plant engineering
- Servo drives and Servo harnessings

Product features

EPIC® LS1.5 A1

- Panel mount base, straight entry
- For male contacts crimp
- Housing with assembled insulation body

EPIC® LS1.5 A3

- Panel mount base, angled, rotatable
- For male contacts crimp
- Housing with assembled insulation body

Suitable tools

- EPIC® LS1.5 Tools see page 26

Technical data

Rated voltage in V
630 V (2mm contacts)
250 V (2mm contacts)

Rated impulse Voltage
6 kV (3.6 mm contacts)
4 kV (2 mm contacts)

Rated current in A
70 A (3.6mm contacts) at 25°C
30 A (2mm contacts) at 25°C

Pollution degree
3

Contacts

Brass gold plated

Number of contacts

3 + PE + 2
3 + PE + 4

Termination methods

Crimp termination: 0.75 - 10 mm² (3.6mm contacts)
Crimp termination: 0.14 - 4.0 mm² (2mm contacts)



Material

Housing: zinc die-casting nickel-plated, brass nickel plated
Insert: PA,
Sealing: FPM



Degree of protection

IP67

Cycle of mechanical operation

50



Range of temperature

-20 °C - +125 °C

Part number	Part	Fastening type	Pin design	Pieces / PU
Type LS 1.5 A1 for male contacts				
44429308	EPIC® LS1.5 A1	Ø4,2mm (4x)	3 + PE + 2	1
44429309	EPIC® LS1.5 A1	Ø4,2mm (4x)	3 + PE + 4	1
Type LS 1.5 A3 for male contacts				
44429306	EPIC® LS1.5 A3	Ø4,2mm (4x)	3 + PE + 2	1
44429307	EPIC® LS1.5 A3	Ø4,2mm (4x)	3 + PE + 4	1

Photographs are not to scale and do not represent detailed images of the respective products.

New

EPIC® LS1.5 A6

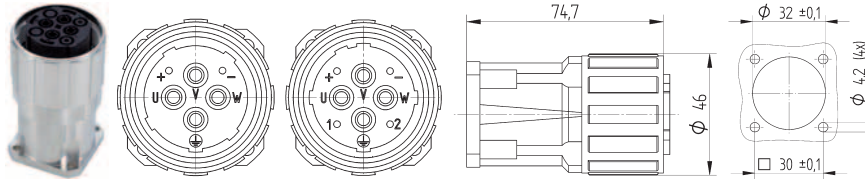

New

EPIC® LS1.5 D6

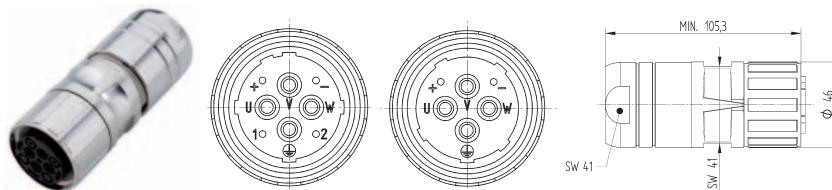

Info

- EMC protection

Suitable contacts:

- EPIC® LS1.5 Contacts female page 26
- The contacts have to be ordered separately

Benefits

- EPIC® LS1.5 A6**
- The power connectors with the contact configurations 3+PE+2 and 3+PE+4 are perfect suitable for servo motors and servo harnessings.
 - Robust against mechanical impact
- EPIC® LS1.5 D6**
- The power connectors with the contact configurations 3+PE+2 and 3+PE+4 are perfect suitable for servo motors and servo harnessings.
 - Faster, easier screen contact
 - Robust against mechanical impact

Application range

- Plant engineering
- Servo drives and Servo harnessings

Product features

- EPIC® LS1.5 A6**
- Panel mount base, straight entry
 - For female contacts crimp
 - Housing with assembled insulation body
- EPIC® LS1.5 D6**
- Cable connector
 - For female contacts crimp
 - Housing with assembled insulation body

Suitable tools

- EPIC® LS1.5 Tools see page 26

Technical data

- Rated voltage in V**
630 V (2mm contacts)
250 V (2mm contacts)
- Rated impulse Voltage**
6 kV (3.6 mm contacts)
4 kV (2 mm contacts)
- Rated current in A**
70 A (3.6mm contacts) at 25°C
30 A (2mm contacts) at 25°C
- Pollution degree**
3
- Contacts**
Brass gold plated
- Number of contacts**
3 + PE + 2
3 + PE + 4
- Termination methods**
Crimp termination: 0.75 - 16 mm² (3.6mm contacts)
Crimp termination: 0.14 - 4.0 mm² (2mm contacts)
- Material**
Housing: zinc die-casting nickel-plated, brass nickel plated
Insert: PA,
Sealing: FPM
- Degree of protection**
IP67
- Cycle of mechanical operation**
50
- Range of temperature**
-20 °C - +125 °C

Part number	Part	Cable clamping range	Fastening type	Pin design	Pieces / PU
Type LS1.5 A6 for female contacts					
44429316	EPIC® LS1.5 A6		Ø4,2mm (4x)	3 + PE + 2	1
44429317	EPIC® LS1.5 A6		Ø4,2mm (4x)	3 + PE + 4	1
Type LS1.5 D6 for female contacts					
44429310	EPIC® LS1.5 D6	9 - 14		3 + PE + 2	1
44429311	EPIC® LS1.5 D6	14 - 20		3 + PE + 2	1
44429312	EPIC® LS1.5 D6	20 - 26		3 + PE + 2	1
44429313	EPIC® LS1.5 D6	9 - 14		3 + PE + 4	1
44429314	EPIC® LS1.5 D6	14 - 20		3 + PE + 4	1
44429315	EPIC® LS1.5 D6	20 - 26		3 + PE + 4	1

Photographs are not to scale and do not represent detailed images of the respective products.

New

EPIC® LS1.5 F6



Info

- **EMC protection**

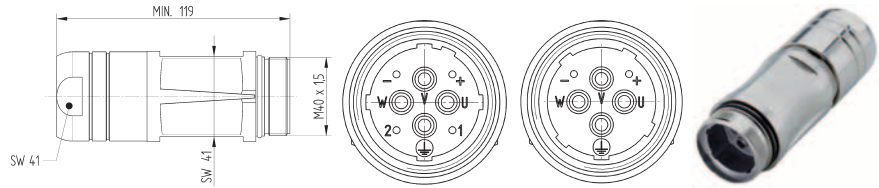

Suitable contacts:

- EPIC® LS1.5 Contacts male page 26
- The contacts have to be ordered separately

Benefits

- The power connectors with the contact configurations 3+PE+2 and 3+PE+4 are perfect suitable for servo motors and servo harnessings.
- Faster, easier screen contact
- Robust against mechanical impact

Application range

- Plant engineering
- Servo drives and Servo harnessings

Product features

- Cable coupler
- For male contacts crimp
- Housing with assembled insulation body

Suitable tools

- EPIC® LS1.5 Tools see page 26

Technical data

Rated voltage in V
630 V (2mm contacts)
250 V (2mm contacts)

Rated impulse Voltage
6 kV (3.6 mm contacts)
4 kV (2 mm contacts)

Rated current in A
70 A (3.6mm contacts) at 25°C
30 A (2mm contacts) at 25°C

Pollution degree
3

Contacts

Brass gold plated

Number of contacts

3 + PE + 2
3 + PE + 4

Termination methods

Crimp termination: 0.75 - 16 mm² (3.6mm contacts)
Crimp termination: 0.14 - 4.0 mm² (2mm contacts)



Material

Housing: zinc die-casting nickel-plated, brass nickel plated
Insert: PA,
Sealing: FPM



Degree of protection

IP67

Cycle of mechanical operation

50



Range of temperature

-20 °C - +125 °C

Part number	Part	Cable clamping range	Pin design	Pieces / PU
Type LS1.5 F6 for male contacts				
44429300	EPIC® LS1.5 F6	9 - 14	3 + PE + 2	1
44429301	EPIC® LS1.5 F6	14 - 20	3 + PE + 2	1
44429302	EPIC® LS1.5 F6	20 - 26	3 + PE + 2	1
44429303	EPIC® LS1.5 F6	9 - 14	3 + PE + 4	1
44429304	EPIC® LS1.5 F6	14 - 20	3 + PE + 4	1
44429305	EPIC® LS1.5 F6	20 - 26	3 + PE + 4	1

Photographs are not to scale and do not represent detailed images of the respective products.

Circular connectors

EPIC® LS1.5 Contacts, tools, accessories

New

EPIC® LS1.5 Contacts male



New

EPIC® LS1.5 Contacts female



New

EPIC® LS1.5 Tools



■ Suitable tools

- Crimp tool for 16.0 mm² on request

Part number	Article designation	Inserts	Version	For style	Pieces / PU
3.6 mm male contacts					
44429334	LS1.5 A SCEM 3,6MM AU 0,75-1,5		3.6 mm male 0.75-1.5	for type A1, A3	10
44429335	LS1.5 A SCEM 3,6MM AU 1,0-2,5		3.6 mm male 1.0-2.5mm ²	for type A1, A3	10
44429336	LS1.5 A SCEM 3,6MM AU 1,0-4,0		3.6 mm male 1.0-4.0mm ²	for type A1, A3	10
44429337	LS1.5 A SCEM 3,6MM AU 4,0-6,0		3.6 mm male 4.0-6.0mm ²	for type A1, A3	10
44429338	LS1.5 A SCEM 3,6MM AU 6,0-10,0		3.6 mm male 6.0-10.0mm ²	for type A1, A3	10
44429326	LS1.5 F SCEM 3,6MM AU 1,0-2,5		3.6 mm male 1.0-2.5mm ²	for type F6	10
44429327	LS1.5 F SCEM 3,6MM AU 2,5-4,0		3.6 mm male 2.5-4.0mm ²	for type F6	10
44429328	LS1.5 F SCEM 3,6MM AU 4,0-6,0		3.6 mm male 4.0-6.0mm ²	for type F6	10
44429329	LS1.5 F SCEM 3,6MM AU 6,0-16,0		3.6 mm male 6.0-16.0mm ²	for type F6	10
2mm male contacts					
44429339	LS1.5 A SCEM 2MM AU 0,14-0,25		2 mm male 0.14-0.25mm ²	for type A1, A3	10
44429340	LS1.5 A SCEM 2MM AU 0,25-1,0		2 mm male 0.25-1.0mm ²	for type A1, A3	10
44429341	LS1.5 A SCEM 2MM AU 0,75-1,5		2 mm male 0.75-1.5mm ²	for type A1, A3	10
44429342	LS1.5 A SCEM 2MM AU 1,0-2,5		2 mm male 1.0-2.5mm ²	for type A1, A3	10
44429343	LS1.5 A SCEM 2MM AU 4,0		2 mm male 4.0mm ²	for type A1, A3	10
44429330	LS1.5 F SCEM 2MM AU 0,25-1,0		2 mm male 0.25-1.0mm ²	for type F6	10
44429331	LS1.5 F SCEM 2MM AU 0,75-1,5		2 mm male 0.75-1.5mm ²	for type F6	10
44429332	LS1.5 F SCEM 2MM AU 1,0-2,5		2 mm male 1.0-2.5mm ²	for type F6	10
44429333	LS1.5 F SCEM 2MM AU 4,0		2 mm male 4.0mm ²	for type F6	10
3.6 mm female contacts					
44429318	LS1.5 D BCEM 3,6MM AU 1,0-2,5		3.6 mm female 1.0-2.5mm ²	for type D6, A6	10
44429319	LS1.5 D BCEM 3,6MM AU 2,5-4,0		3.6 mm female 2.5-4.0mm ²	for type D6, A6	10
44429320	LS1.5 D BCEM 3,6MM AU 4,0-6,0		3.6 mm female 4.0-6.0mm ²	for type D6, A6	10
44429321	LS1.5 D BCEM 3,6MM AU 6,0-16,0		3.6 mm female 6.0-16.0mm ²	for type D6, A6	10
2mm female contacts					
44429322	LS1.5 D BCEM 2MM AU 0,25-1,0		2 mm female 0.25-1.0mm ²	for type D6, A6	10
44429323	LS1.5 D BCEM 2MM AU 0,75-1,5		2 mm female 0.75-1.5mm ²	for type D6, A6	10
44429324	LS1.5 D BCEM 2MM AU 1,0-2,5		2 mm female 1.0-2.5mm ²	for type D6, A6	10
44429325	LS1.5 D BCEM 2MM AU 4,0		2mm female 4.0mm ²	for type D6, A6	10
Crimping tool					
44429367	LS1.5 CRIMPTOOL 0,08-6,0	4-indent crimp tool including locator	0.14-6.0mm ²	for LS1.5, LS3	1
44429368	LS1.5 CRIMPTOOL 6,0-10,0	4-indent crimp tool including locator	6.0-10.0mm ²	for LS1.5	1

Photographs are not to scale and do not represent detailed images of the respective products.

New

EPIC® LS3 A1

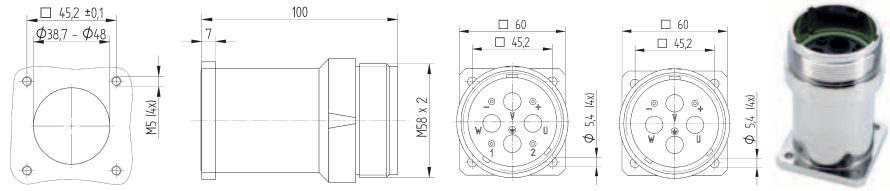

New

EPIC® LS3 D6

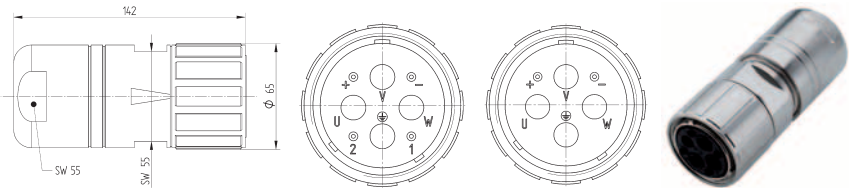

Suitable contacts:

EPIC® LS3 A1

- EPIC® LS3 Contacts male page 29

EPIC® LS3 D6

- EPIC® LS3 Contacts female page 29
- The contacts have to be ordered separately

Benefits

- The power connectors with the contact configurations 3+PE+2 and 3+PE+4 are perfect suitable for servo motors and servo harnessings.
- Robust against mechanical impact
- EMC protection

Application range

- Plant engineering
- Servo drives and Servo harnessings

Product features

Kopie von EPIC® LS1 A1 6 contacts

- Panel mount base, straight entry
- For male contacts crimp
- Housing with assembled insulation body

EPIC® LS3 D6

- Cable connector
- For female contacts crimp
- Housing with assembled insulation body

Suitable tools

- EPIC® LS3 Tools see page 29

Technical data

Rated voltage in V

- 630 V (10mm contacts)
- 250 V (1.6mm contacts)

Rated impulse Voltage

- 6 kV (10mm contacts)
- 4 kV (1.6mm contacts)

Rated current in A

- 150 A (10mm contacts) at 25 °C
- 12 A (1.6mm contacts) at 25 °C

Pollution degree

3

Contacts

- Brass silver plated
- Brass gold plated

Number of contacts

- 3 + PE + 2
- 3 + PE + 4

Termination methods

- Crimp termination 10 - 50 mm² (10mm contacts)
- Crimp termination 0.75 - 1.5 mm² (1.6mm contacts)



Material

- Housing: Aluminium anodised
- Insert: PA
- Sealing: FPM



Degree of protection

IP 67

Cycle of mechanical operation

50



Range of temperature

-20 °C - +120 °C

Part number	Part	Cable clamping range	Fastening type	Pin design	Pieces / PU
Type LS3 A1 for male contacts					
44429352	LS3 A1		Ø4,2mm (4x)	3 + PE + 2	1
44429353	LS3 A1		Ø4,2mm (4x)	3 + PE + 4	1
Type LS3 D6 for female contacts					
44429344	LS3 D6	17 - 25		3 + PE + 2	1
44429345	LS3 D6	25 - 36		3 + PE + 2	1
44429346	LS3 D6	17 - 25		3 + PE + 4	1
44429347	LS3 D6	25 - 36		3 + PE + 4	1

Photographs are not to scale and do not represent detailed images of the respective products.

New

EPIC® LS3 F6

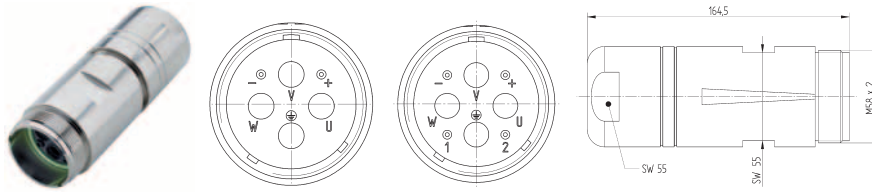

Suitable contacts:

- EPIC® LS3 Contacts male page 29
- The contacts have to be ordered separately

Benefits

- The power connectors with the contact configurations 3+PE+2 and 3+PE+4 are perfect suitable for servo motors and servo harnessings.
- Robust against mechanical impact
- EMC protection

Application range

- Plant engineering
- Servo drives and Servo harnessings

Product features

- Cable coupler
- For male contacts crimp
- Housing with assembled insulation body

Suitable tools

- EPIC® LS3 Tools see page 29

Technical data

Rated voltage in V

630 V (10mm contacts)
250 V (1.6mm contacts)

Rated impulse Voltage

6 kV (10mm contacts)
4 kV (1.6mm contacts)

Rated current in A

150 A (10mm contacts) at 25°C
12 A (1.6mm contacts) at 25°C

Pollution degree

3

Contacts

Brass silver plated
Brass gold plated

Number of contacts

3 + PE + 2
3 + PE + 4

Termination methods

Crimp termination 10 - 50 mm² (10mm contacts)
Crimp termination 0.75 - 1.5 mm² (1.6mm contacts)



Material

Housing: Aluminium anodised
Insert: PA
Sealing: FPM



Degree of protection

IP 67

Cycle of mechanical operation

50



Range of temperature

-20 °C - +120 °C

Part number	Part	Cable clamping range	Pin design	Pieces / PU
Type LS3 F6 for male contacts				
44429348	LS3 F6	17 - 25	3 + PE + 2	1
44429349	LS3 F6	25 - 36	3 + PE + 2	1
44429350	LS3 F6	17 - 25	3 + PE + 4	1
44429351	LS3 F6	25 - 36	3 + PE + 4	1

Photographs are not to scale and do not represent detailed images of the respective products.

New

EPIC® LS3 Contacts male

RoHS ✓



New

EPIC® LS3 Contacts female

RoHS ✓



New

EPIC® LS3 Tools

RoHS ✓

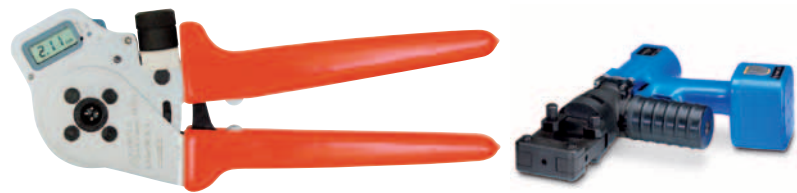

Part number	Article designation	Inserts	Version	For style	Pieces / PU
EPIC® LS3 male contacts					
44429360	LS3 A, F SCEM 10MM AG 10		10 mm male 10mm ²	for type A1, F6	4
44429361	LS3 A, F SCEM 10MM AG 16		10 mm male 16mm ²	for type A1, F6	4
44429362	LS3 A, F SCEM 10MM AG 25		10 mm male 25mm ²	for type A1, F6	4
44429363	LS3 A, F SCEM 10MM AG 35		10 mm male 35mm ²	for type A1, F6	4
44429364	LS3 A, F SCEM 10MM AG 50		10 mm male 50mm ²	for type A1, F6	4
44429365	LS3 A, F SCEM 1.6MM AU 0.75-1.5		1.6 mm male 0.75-1.5mm ²	for type A1, F6	4
EPIC® LS3 female contacts					
44429354	LS3 D BCEM 10MM AG 10		10 mm female 10mm ²	for type D6	4
44429355	LS3 D BCEM 10MM AG 16		10 mm female 16mm ²	for type D6	4
44429356	LS3 D BCEM 10MM AG 25		10 mm female 25mm ²	for type D6	4
44429357	LS3 D BCEM 10MM AG 35		10 mm female 35mm ²	for type D6	4
44429358	LS3 D BCEM 10MM AG 50		10 mm female 35mm ²	for type D6	4
44429359	LS3 D BCEM 1.6MM AU 0.75-1.5		1.6 mm female 0.75-1.5mm ²	for type D6	4
Crimping tool					
44429366	LS3 Crimp tool 10.0-50.0	Electro hydraulic Crimp tool including charging device, accumulator and crimp dies for 10-50mm ²	10.0-50.0mm ²	for LS3	1
44429367	LS1.5 CRIMPTOOL 0,08-6,0	4-indent crimp tool including locator	0.14-6.0mm ²	for LS1.5, LS3	1

Photographs are not to scale and do not represent detailed images of the respective products.

EPIC® M23 C2



Benefits

- Quick and easy separation of connection from both sides of a wall
- For the connection of two harnessed M23 D6 connectors

Application range

- Plant engineering
- Measurement and control technology

Product features

- Feedthrough connector
- Panel thickness: up to 3mm
- The inserts and contacts are already assembled in the housing

Technical data



Material

Housing: copper alloy, nickel-plated
Insert: thermoplastics,
Sealing: neoprene



Degree of protection

IP 67



Range of temperature

-25 °C - +125 °C

Part number	Part	Version	Contacts included	Fastening type	Pin design	Pieces / PU
Type M23 C2 Feedthrough connector						
00010108	EPIC® M23 C2 12	black (N)	12	Ø2,7mm (4x)	12E male - 12P female	5
00010521	EPIC® M23 C2 17	black (N)	17	Ø2,7mm (4x)	17E male - 17P female	5

Photographs are not to scale and do not represent detailed images of the respective products.

New

SKINTOP® CUBE

Info

- Innovative multi cable bushing system with variable clamping ranges for high assembling flexibility.
- In case of disassembling frame can remain on housing and clip module on the cable.

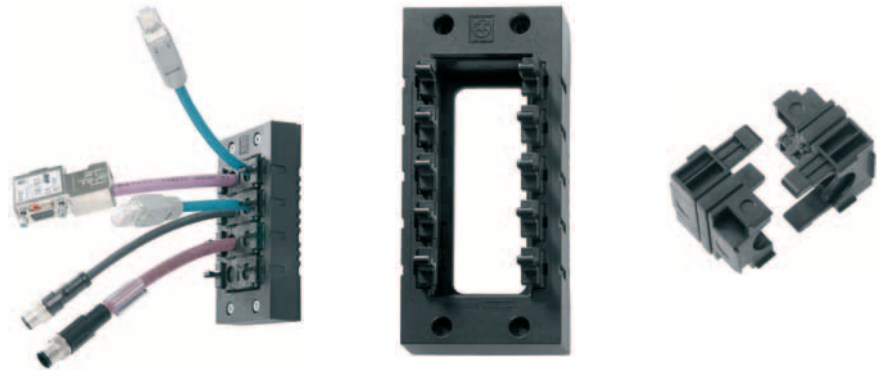

Benefits

- Various clamping range
- Vibration safe fixed modules
- Strain relief
- Oil resistance
- Simplified service due to easy assembling and disassembling

Application range

- For installation of harnessed cables
- Everywhere where cables must be safely inserted into housings.
- Apparatus and switch cabinet construction
- Electronic installations
- Automation technology

Approvals (Norm references)



Design

- SKINTOP® CUBE consists of SKINTOP® CUBE FRAME and the flexible clip module SKINTOP® CUBE MODULE.
- For cut-outs for industrial connectors with standard defined bore holes.
- For cut-outs for 16-pole industrial connectors (36 x 86mm)
- For cut-outs for 24-pole industrial connectors (36 x 112mm)

Note

- SKINTOP® CUBE MODULE 20x20 BLIND can be used as blind module, as well as for clamping ranges 1-3 mm

Scope of delivery

- SKINTOP® CUBE FRAME including mounting material

Suitable tools

- Kraftform Kompakt® 10

Technical data

Approvals
UL pending

Material
Frame: Glas fibre reinforced polyamide
Frame seal: CR
Clip Module: Special polypropylene
Clip Module Seal: LSE 2

Degree of protection
IP 64
NEMA 12

Range of temperature
-20 °C up to +80 °C

Part number	Part designation / size	Clamping range ØF mm	Max. Number of executions	Pieces / PU
SKINTOP® CUBE Frame				
52220000	SKINTOP® CUBE FRAME 16		8	1
52220001	SKINTOP® CUBE FRAME 24		10	1
SKINTOP® CUBE Clip Module				
52220004	SKINTOP® CUBE MODULE 20x20 BLIND	1 - 3		5
52220002	SKINTOP® CUBE MODULE 20x20 SMALL	4 - 6		5
52220003	SKINTOP® CUBE MODULE 20x20 LARGE	6 - 9		5
52220040	SKINTOP® CUBE MODULE 20x20 AS-I BUS	AS-I BUS cable		5
52220005	SKINTOP® CUBE MODULE 40x40 SMALL	9 - 12		5
52220006	SKINTOP® CUBE MODULE 40x40 LARGE	12 - 16		5
52220007	SKINTOP® CUBE MODULE 40x40 BLIND			5

Photographs are not to scale and do not represent detailed images of the respective products.

Comparable products

- SKINDICHT® Cable Bushing System CABLEFIX

Accessories

- FLEXIMARK® LB-10 W

SILVYN® CHAIN KITS – Quick, easy, modular and safe

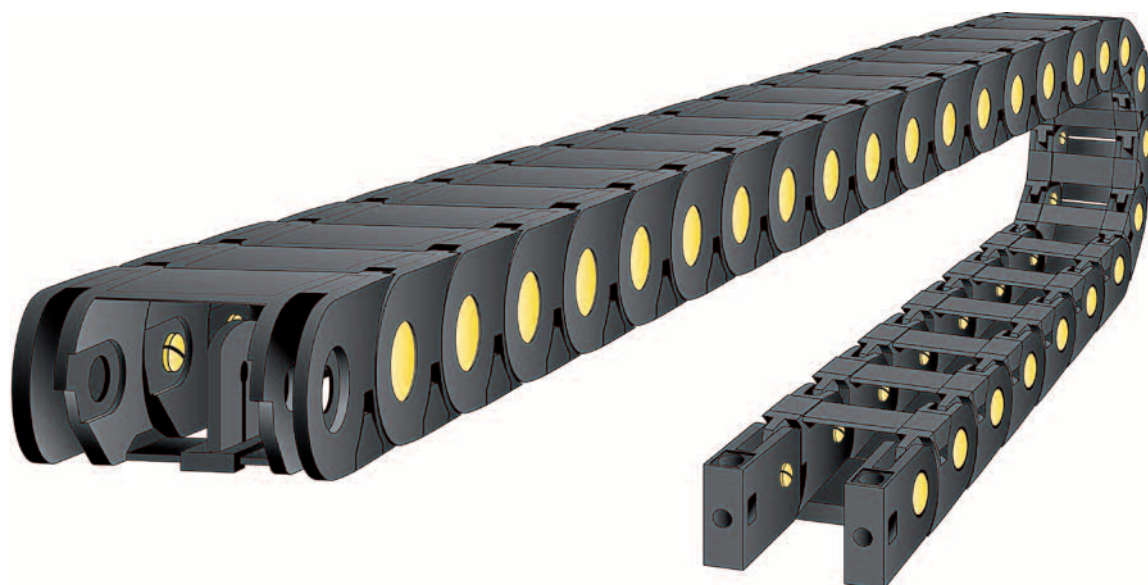

SILVYN® CHAIN the cable guidance system of the LAPP GROUP, known for reliable and long lasting cable guidance, is now introduced with a brand new selection opportunity. The so called SILVYN® CHAIN KITS, create an individual part assortment, which enables a fast, comfortable and safe

selection of the power chain, the suitable end brackets and further accessories. Due to the absolute clear determination of the system components, valuable time will be saved by terminating the correct chain components of SILVYN® CHAIN KITS.

SILVYN® CHAIN KITS

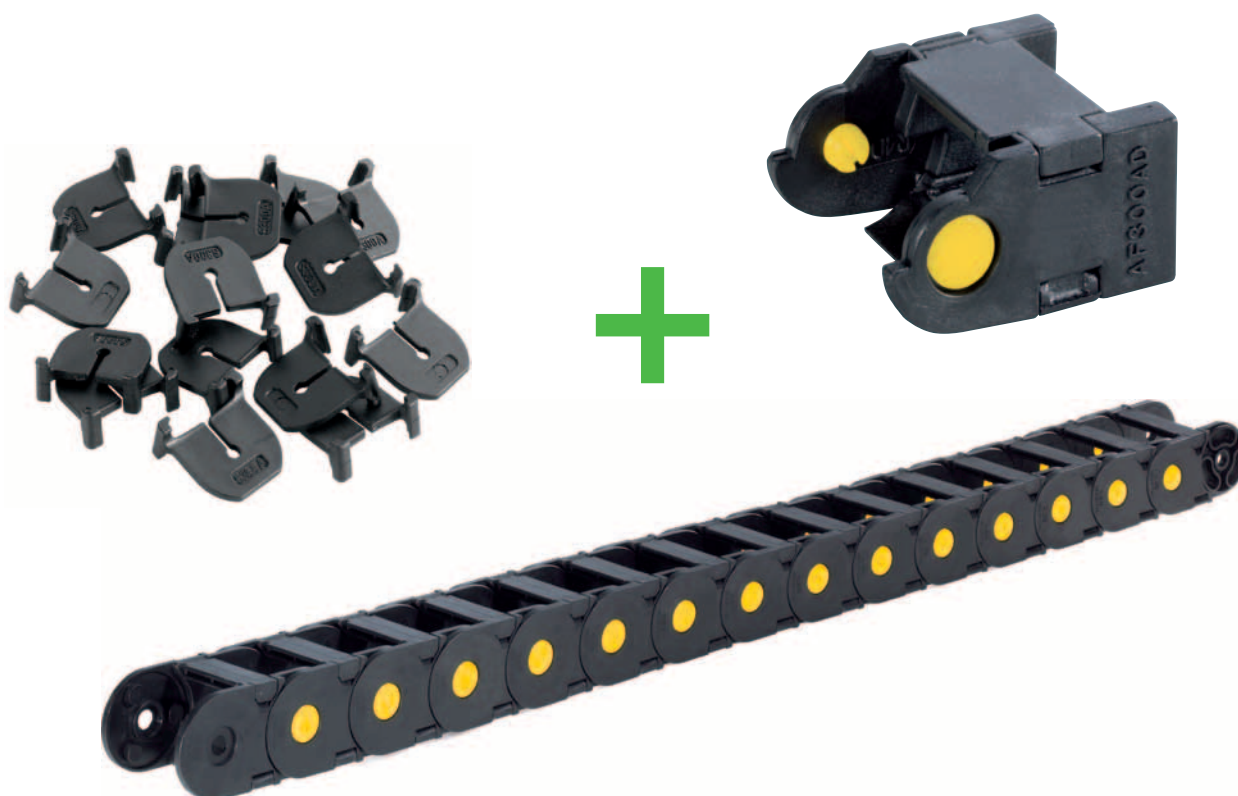

SILVYN® CHAIN SR445Mi Chain





■ Benefits

- Space-saving
- Interchangeable chain links
- Easy cable harnessing, due to open able frames in the inner radius



■ Application range

- All-purpose e.g.
- Machine building
- Short or long travelling distances (sliding usage is possible)

Selection Guide	Designation	Width inner/outer	Height inner/outer	Radius in mm	Length/pcs in mm
	SR445MI095100	95 / 117	45 / 64	100	1005
	SR445MI125150	125 / 147	45 / 64	150	1005

SILVYN® CHAIN AN445M end brackets



Selection Guide	Designation	Width inner/outer	Height inner/outer	Suitable for	Packing unit in pcs
	AN445M095K	95 / 117	45 / 64	SR445MI095...	2
	AN445M125K	125 / 147	45 / 64	SR445MI125...	2

SILVYN® CHAIN S445 separators



Selection Guide	Designation	Suitable for	Packing unit in pcs
	S445	SR445Mi...	10

New

FLEXIMARK® Software 10.0

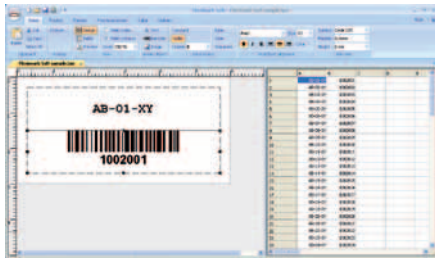

Info

- Marking software for FLEXIMARK® labels
- Download www.lappkabel.de - Service - Download-center - Kennzeichnungssoftware

Benefits

- New Layout
- Integrated word processing
- Guide that leads to the right label
- Function keys for frequently used commands
- Self-explanatory installation

Application range

- Machine and apparatus construction, control technology
- Switch cabinets and equipment wiring
- Automotive industry
- Building Installation

- FLEXIMARK® Software is the marking software that enables you to print all kinds of labels. It is especially suitable for FLEXIMARK® labels, which are already defined in this catalogue. With the FLEXIMARK® Software you can use all Microsoft® Windows options to print your labels: graphics, cliparts, fonts and font sizes. Integrated word processing will give you any desired result for your label text quickly and easily. You will be able to import data, store individual logos and apply bar codes easily.

Product features

- System requirements:
20 MB free hard disk space
Printer and driver for Microsoft® Windows 2000 or higher
- Import from other Microsoft® Windows applications or ASCII files (e.g. tables or graphs, logos) possible

- Zoom function from 25 % to 800 %
- Printer: Laser, Thermal Transfer, Matrix

Note

- The full version is available for download free of charge with a testperiod of 30 days
- Light version is available for download free of charge

Design

- Consecutive numbering, text sorting
- Barcodes: EAN-8, EAN-13, EAN-128, Code-128, Code-39, interleaved 2/5, UPC-A

Scope of delivery

- CD-ROM
- Operating manual and help function in the program
- Service manual on CD-ROM

Part number	Article designation	Language	PU
83251080	FLEXIMARK® SOFTWARE 10.0	DE / EN / SE	1

Photographs are not to scale and do not represent detailed images of the respective products.

New

Features & Benefits

Stronger head = bigger crimps

Widest die opening = easiest access

Optimal position for palm and fingers = lower wrist stress

Broader-shaped handle to spread load across palm = less pressure on hand

Textured surface on fixed handle = better grip/less friction in palm



Recessed ratchet release = less chance of accidental release

10 % longer handle but same length of tool = less hand force required

High friction insert = tool can be pressed against hard surface for very hard crimp

Smoother material for moving handle = less rotational friction on fingers

Part-No	Description	Application	Main Catalogue Page
61722130	KWB-4099	Tube Cable Lugs 4 -10 mm ²	931
61790910	KSA-0760	Insulated Cable Lugs 0,75 – 6 mm ²	929
61790950	KRB-0560	Panel Connectors insulated 0,5 – 6 mm ²	930
61791010	KCC-2300	Koax Connectors 9,75 mm 2,54 mm	no reference
61791020	KCC-2561	Koax Connectors 10,90 mm 2,54 mm	no reference
61791060	KEB-4010	Conductor End Sleeves 4 -10 mm ²	920
61791065	KEB-1025	Conductor End Sleeve 10 – 25 mm ²	920
61791100	KRB-0560L	Panel Connectors insulated 0,5 – 6 mm ² (with Locator)	930
61791095	KEB-3550	Conductor End Sleeve 35 – 50 mm ²	920

ÖLFLEX®

UNITRONIC®

ETHERLINE®

EPIC®

SKINTOP®

SILVYN®

FLEXIMARK®

ACCESSORIES

For the use of our products is valid

The conformity of our products with the relevant European directives and compliance with the provisions contained therein shall be indicated by the CE marking.

The safety of our products is closely associated with how they are used. A knowledge of and adherence to the respective international/national standards of use (e.g. DIN VDE 0100; 0298) are mandatory.

There are particular risks if installed improperly. This applies to all our products/items:

Processing is only to be done by an authorized electrician! Otherwise, there is the risk of an electric shock or a fire ignited by electric current!

Safety

Without exception our products are tested for application safety in accordance with laid down standards and our own regulations, which complement the standards. Relevant legal requirements and safety regulations are also observed. Provided due care and attention is paid, the possibility of product-specific danger to the user may thus reasonably be excluded. Where products are used carelessly or incorrectly, however, consi-

derable danger to persons and the environment may arise. For this reason, our cables must only be processed and /or used responsibly by trained electricians or specialists. This catalogue contains general information for the application of each product. Independent of such information, the application standards DIN VDE 0298 and DIN VDE 001 for cables will apply. Excerpts from these standards, as well as complementary selection

and application tables, design and installation guidelines, are contained in the tables in the appendix to our Main Catalogue 2010/11. Our machines and installation tools are – where necessary – designed in accordance with the machine guidelines and display the CE identification mark. It must be noted, however, that our machines and installation tools must only be used by trained specialized personnel and for the purpose for

which they were designed. ©Copyright by U.I. Lapp GmbH. Reprinting or reproduction of the text or the illustrations may be made only with written approval and with correct indication of source. We reserve the right to make modifications to our products, especially those based on technical improvements or continued development. All illustrations and numerical data etc. are therefore without warranty and are subject to change.

ÖLFLEX®

UNITRONIC®

ETHERLINE®

HITRONIC®

EPIC®

SKINTOP®

SILVYN®

FLEXIMARK®



Terms of Trade:

Our general conditions of sale
can be downloaded from our website
www.lappgroup.com/terms



www.lappgroup.com

To contact your local Lapp Group representative
please visit www.lappgroup.com/worldwide