

EPIC® HA 3/4 Tapa con entrada superior; pernos sencillos

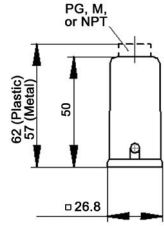

EPIC® HA 3/4 Tapa con entrada lateral pernos sencillos

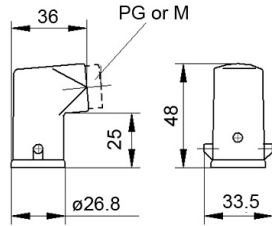

EPIC® HA 3/4 Base de panel; palanca sencilla

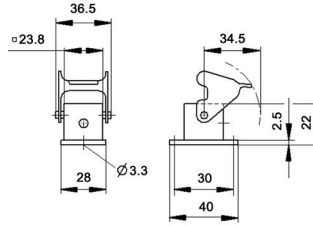

EPIC® HA 3/4 Base en ángulo; palanca sencilla

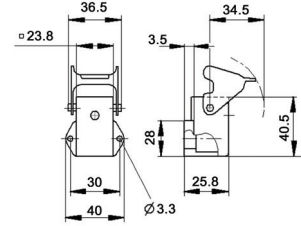

EPIC® HA/HB Tapa con entrada superior y lateral; pernos sencillos

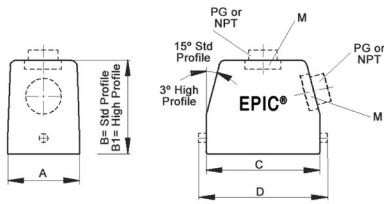

Series	HA/HB dimensión de la tapa (mm)				
	A	B	B1	C	D
HA 10	29.5	53.3	67.3	63	73
HA 16	29.5	58.3	72.3	79	89
HA 64	90	105	—	132	152
HB 6	43	52	72	60	74.8
HB 10	43	52	72	73	90
HB 16	43	61	76	93.3	110
HB 24	43	61	76	120	137
HB 48	90	105	—	132	152

EPIC® HA 3/4 Surface Mount Base; palanca sencilla

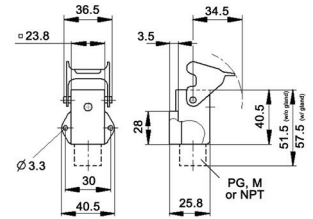

EPIC® HA/HB Tapa de cople de conexión; palanca sencilla

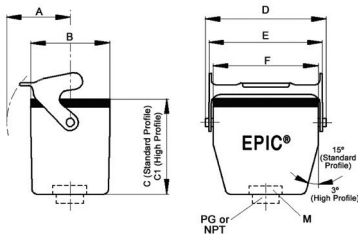

Series	HA/HB dimensión de la tapa (mm)						
	A	B	C	C1	D	E	F
HA 10	36.5	29.5	48	62	74.4	71.4	63
HA 16	36.5	29.5	53	67	90.4	87.8	79
HB 6	44	43	54.8	74.8	74.8	70	60
HB 10	50	43	54.8	74.8	91	88.5	73
HB 16	50	43	63.5	78.8	111	109.5	93.3
HB 24	50	43	63.5	78.8	138	136.5	120

EPIC® HA 3/4 Tapa de cople de conexión; palanca sencilla

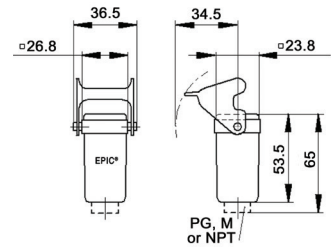

EPIC® HA/HB Base de panel; palanca sencilla

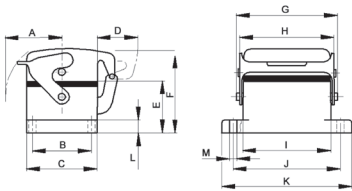

Series	HA/HB dimensión de la tapa (mm)												
	A	B	C	D	E	F	G	H	I	J	K	L	M
HA 10	36.5	17.5	29.5	25	25	42	74.4	71.4	63	70	81	3.5	3.6
HA 16	36.5	17.5	29.5	25	25	42	90.4	87.5	79	86	96	3.5	3.6
HA 64	105	70	90	30	39.5	56.5	152	139.5	132	148	165	10	7
HB 6	44	32	43	25	27.8	44.8	74.8	70	60	70	80	4	4.3
HB 10	50	32	43	25	27.8	44.8	91	88.5	73	83	93	4	4.3
HB 16	50	32	43	25	27.8	44.8	111	109.5	93.3	103	113	4	4.3
HB 24	50	32	43	25	27.8	44.8	138	136.5	120	130	140	4	4.3
HB 48	105	70	90	30	39.5	56.5	152	139.5	132	148	165	10	7

EPIC® HA/HB Base de superficie; palanca sencilla

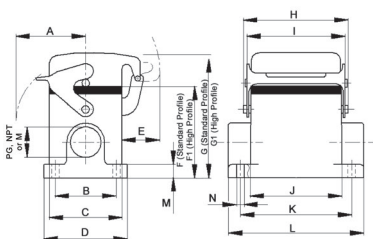

Series	HA/HB dimensión de la tapa (mm)															
	A	B	C	D	E	F	F1	G	G1	H	I	J	K	L	M	N
HA 10	36.5	40	29.5	50	25	57	—	74	—	74.4	71.4	63	48	80	3.5	4.5
HA 16	36.5	40	29.5	50	25	57	—	74	—	90.4	87.8	79	64	96	3.5	4.5
HA 64	105	106	90	120	30	100	—	117	—	152	139.5	132	111	132	12	6.5
HB 6	44	40	43	52	25	54	74	71	91	74.8	70	60	70	84	*	5.5
HB 10	50	40	43	52	25	57	74	74	91	91	88.5	73	82	94	*	5.5
HB 16	50	45	43	57	25	64	84	81	101	111	109.5	93	105	117	*	5.5
HB 24	50	45	43	57	25	64	84	81	101	138	136.5	120	132	144	*	5.5
HB 48	105	106	90	120	30	100	—	117	—	152	139.5	132	111	132	12	6.5

\* M medida para HB 6, 10, 16 & 24 es 4.5mm (perfil estándar) o 6mm (perfil alto).

EPIC® HA/HB Entrada superior y lateral; pernos dobles

Series	HA/HB dimensión de la tapa (mm)					
	A	B	C	C1	D	E
HA 32	56	67.8	75	—	49.6	82
HA 48	79	89.5	95	—	64.5	93.5
HB 10	43	55	52	72	27	73
HB 16	43	55	61	76	47.5	93.3
HB 24	43	55	61	76	74	120
HB 32	79	89.5	95	—	64.5	93.5

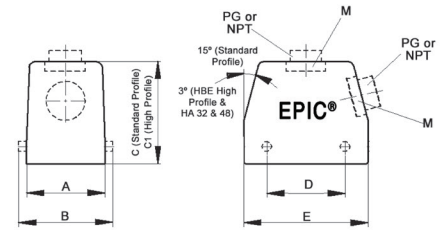

EPIC® HA/HB Base de panel; palanca doble

Series	HA/HB dimensión de la tapa (mm)											
	A	B	C	D	E	F	G	H	I	J	K	L
HA 32	67.8	66	42	56	25.4	124.5	49.6	82	92	102	4	4.3
HA 48	93.8	87.8	65	79	30.3	136.5	64.5	93.5	110	124	5	5.5
HB 10	55	53	32	43	27.8	116	27	73	83	93	4	4.3
HB 16	55	53	32	43	27.8	136.5	47.5	93.3	103	113	4	4.3
HB 24	55	53	32	42	27.8	163	74	120	130	140	4	4.3
HB 32	93.8	87.8	65	79	30.3	136.5	64.5	93.5	110	124	5	5.5

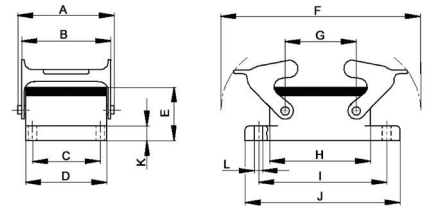

EPIC® HA/HB Base de superficie; palanca doble

Series	HA/HB dimensión de la tapa (mm)												
	A	B	C	D	E	F	F1	G	H	I	J	K	L
HA 32	67.8	66	46	56	57	75	—	124.5	49.6	82	94	106	4
HA 48	93.8	87.8	67	79	81	72	—	136.5	64.5	82	94	106	5
HB 10	55	53	40	43	54	57	74	116	27	73	82	94	*
HB 16	55	53	45	43	57	64	84	136.5	47.5	93	105	117	*
HB 24	55	53	45	43	57	64	84	163	74	120	132	144	*
HB 32	93.8	87.8	67	79	81	72	—	136.5	64.5	93.5	112	124.5	5

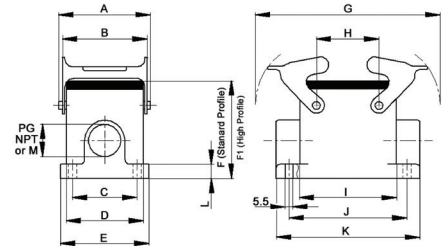

\* L dimensión para HB3 10, 16 & 24 es 4.5mm (perfil estándar) or 6mm (perfil alto).

EPIC® HA/HB Cople de conexión; palanca doble

Series	HA/HB dimensión de la tapa (mm)							
	A	B	C	D	D1	E	F	G
HA 32	67.8	66	56	76.5	—	124.5	82	49.6
HB 10	55	53	43	54.8	74.8	116	73	27
HB 16	55	53	43	63.6	78.8	136.5	93.3	47.5
HB 24	55	53	43	63.6	78.8	163	120	74
HB 32	93.8	87.8	79	97	—	136.5	93.5	64.5

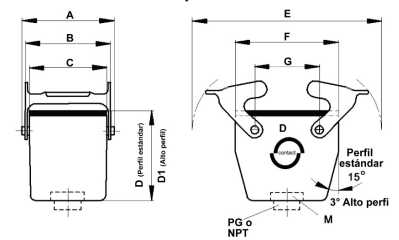

EPIC® HA/HB Base de panel, cortes

Series	HA/HB Cut-Out Dimension (mm)				
	A	B	C	D	E
HA 3/4	30	—	21	21	3.3
HA 10	70	17.5	57.5	24	3.6
HA 16	86	17.5	73.7	24	3.6
HA 32	92	42	74.2	48.4	4.3
HA 48	110	65	85.5	71	5.5
HA 64	148	70	117	82	7
HB 6	70	32	52.2	35	4.3
HB 10	83	32	65.2	35	4.3
HB 16	103	32	85.5	35	4.3
HB 24	130	32	112.2	35	4.3
HB 32	110	65	85.5	71	5.5
HB 48	148	70	117	82	7

