

55501500	<b>DATA SHEET</b>	
Valid from: 12.04.2024	<b>SILVYN® US-M</b>	

SILVYN® US-M is a high-quality brass conduit gland, designed for use with the SILVYN® FPS, FD-PUAS, EDU-AS, AS-P conduits. It provides a secure locking of conduits and screw connection, vibrations and tension resistance and fulfils highest demands on stability and function-reliability.



**Material:**

Body	Brass, nickel-plated
Sealing ring	TPE
O-Ring	NBR

**Technical features:**

Connecting thread	M10x1,0 up to M50x1,5 acc. to DIN 60423
Nominal width	NW 10 up to NW 56
Protection class	IP40 up to EN 60529
Temperature range	-40°C up to +125°C

**Suitable sleeve:**

SILVYN® US-AS  
SILVYN® US-EDU-AS  
SILVYN® EE-K

**Suitable conduit:**

SILVYN® FPS  
SILVYN® FD-PU  
SILVYN® AS  
SILVYN® EDU-AS  
SILVYN® AS-P

For more information please see our current catalogue. Please do not hesitate to contact our laboratory if there are any questions regarding resistance against aggressive agents and special oil.

Creator: MAAU1 /PDP Released: DAMU1/PDP	Document: DB55501500EN Version: 05	Page 1 of 2
--	---------------------------------------	-------------

55501500	<b>DATA SHEET</b>	
Valid from: 12.04.2024	<b>SILVYN® US-M</b>	

**Drawing:**

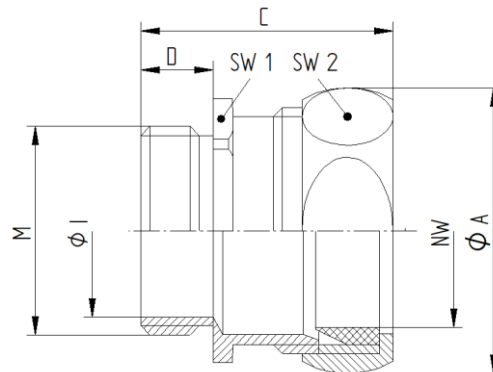

**Dimension table:**

Part No.	NW	Thread M	Thread length D mm	Length C mm	Diameter		Wrench size		Weigth Kg/100
					Inner Ø I mm	Outer Ø A mm	SW 1	SW 2	
55501500	10	M10x1,0	10	26	6,5	19,0	15	17	1,39
55501510	14	M12x1,5	10	28	9,0	23,0	19	21	2,14
55501520	17	M16x1,5	10	27	12,5	27,0	23	25	3,00
55501530	21	M20x1,5	10	28	16,0	31,0	27	29	3,94
55501540	27	M25x1,5	11	35,5	21,0	39,0	34	36	7,50
55501550	36	M32x1,5	14	40	27,5	48,0	43	45	11,30
55501560	45	M40x1,5	13	38	35,0	57,0	52	54	15,00
55501570	56	M50x1,5	15,5	45	45,0	70,0	63	66	21,80

Creator: MAU1 /PDP Released: DAMU1/PDP	Document: DB55501500EN Version: 05	Page 2 of 2
---	---------------------------------------	-------------