

55502300	DATA SHEET	
Valid from: 09.07.2018	SILVYN® ELW-M	

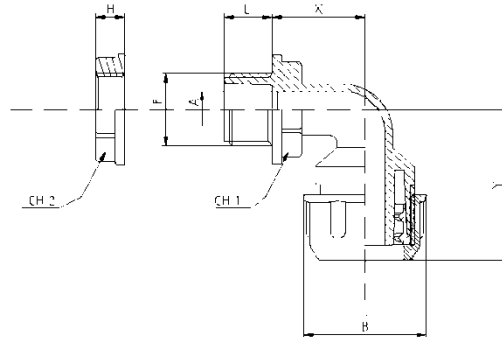

Dimensions table:

Art. Nr.	Des.	Connection Thread M (F)	Conduit	Ø A min. mm	L	X	Ø B	Y	H	CH 1 SW	CH 2 SW
5550 2300	ELW-M	M12x1,5	10	8,0	11,0	19,0	24,0	37,0	7,0	19,0	19,0
5550 2310	ELW-M	M 16x1,5	12	10,0	10,5	24,0	27,0	37,5	7,0	22,0	22,0
5550 2320	ELW-M	M 20x1,5	16	14,0	13,5	26,0	33,0	45,0	8,0	26,0	27,0
5550 2330	ELW-M	M 25x1,5	20	18,0	14,0	29,0	38,0	50,0	9,5	33,0	33,0
5550 2340	ELW-M	M 32x1,5	25	23,0	13,5	34,0	45,0	57,0	10,0	38,0	35,0
5550 2350	ELW-M	M 32x1,5	28	26,0	18,5	40,0	47,0	66,0	10,0	42,0	42,0
5550 2360	ELW-M	M 40x1,5	32	29,0	17,0	42,0	53,0	67,0	10,0	49,0	49,0

Material: body PP
clamping seal PA

Colour: RAL 7001 silver grey

Protection class: IP 65

Temperature range: -20°C up to +60°C

Flammability: V2 (UL94)

Approval: 

For more information please see our current catalogue. Please do not hesitate to contact our laboratory if there are any questions regarding resistance against aggressive agents and special oil.

Creator: PDP Released: DAMU1/PDP	Document: DB55502300EN Version: 02	Page 1 of 1
-------------------------------------	---------------------------------------	-------------