

55503326	<b>DATA SHEET</b>	
Valid from: 03.07.2018	<b>SILVYN® AMW 90°</b>	

The SILVYN® AMW 90° conduit gland, forms in combinations with the Anaconda Sealtite® protective conduit a unit that is impervious to liquids and ensures continuous earthing in acc. to VDE 0113/12.73

**Components:**

Gland body: brass nickel plated  
 Grounding sleeve: steel galvanized  
 Connecting part: inner PA insulated

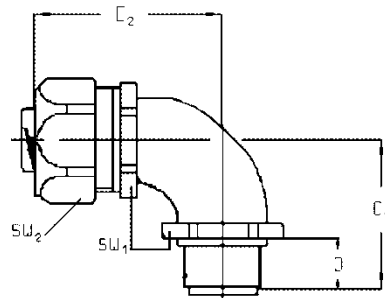

Part No.	Description	for conduit	C <sub>1</sub>	C <sub>2</sub>	D	SW <sub>1</sub>	SW <sub>2</sub>	minimum inner Ø	
5550 3326	SILVYN® AMW 11/1	SILVYN®, -EF, -OR, -HTDL, -HCX, -HFX	5/16"	32	42	12	22	26	8,3
5550 3327	SILVYN® AMW 11/2		3/8"	32	42	12	22	26	10,2
5550 3328	SILVYN® AMW 13,5		3/8"	32	42	12	22	26	10,2
5550 3329	SILVYN® AMW 16		1/2"	36	43	13	27	29	13,9
5550 3330	SILVYN® AMW 21		3/4"	43	48	15	33	35	18,5
5550 3331	SILVYN® AMW 29		1"	48	59	15	42	45	23,8
5550 3332	SILVYN® AMW 36		1 1/4"	57	68	16	51	54	31,8
5550 3333	SILVYN® AMW 42		1 1/2"	63	78	18	60	63	36,8
5550 3334	SILVYN® AMW 48		2"	74	96	20	74	77	47,8

**Connecting thread:** PG 11 up to PG 48

**Temperature range:** -45°C up to +105°C

**Approval:**



**Protection class:** IP 67

For more information please see our current catalogue. Please do not hesitate to contact our laboratory if there are any questions regarding resistance against aggressive agents and special oil.

Creator: PDP Released: DAMU1/PDP	Document: DB55503326EN Version: 01	Page 1 of 1
-------------------------------------	---------------------------------------	-------------