

| | | |
|---------------------------|-----------------------|-------------------------------------------------------------------------------------|
| 55506305 | DATA SHEET |  |
| Valid from: 18.07.2019 | SILVYN® FPAG-M | |

SILVYN® FPAG-M is a conduit gland with a fast fit for a safety assembling.
 For the demounting we are recommending to use a screwdriver.
 The gland is suitable for SILVYN® FPAS and can be used in the machine- and plant constructions.



Material: PA66

Technical Features:

| | |
|-------------------|--------------------------------------------------------|
| Connecting thread | M12x1,5 up to M63x1,5 |
| Nominal width | NW 10 up to NW 67 |
| Protection class | IP66 acc. to EN 60529 |
| Temperature range | In combination with SILVYN® FPAS -50°C up to +135°C |

Additional features:

| | |
|------------------------------------------|--------------------|
| Free of halogen, sulphur and phosphorous | |
| UV-Resistant | SILVYN® FPAS black |

Colour: Grey
Black

Approvals:  

Reference standards: IEC 61386-1
IEC 61386-23

Suitable conduits: SILVYN® FPAS

For more information please see our current catalogue. Please do not hesitate to contact our laboratory if there are any questions regarding resistance against aggressive agents and special oil.

| | | |
|-------------------------------------------|---------------------------------------|-------------|
| Creator: MAU1 /PDP Released: DAMU1/PDP | Document: DB55506305EN Version: 04 | Page 1 of 2 |
|-------------------------------------------|---------------------------------------|-------------|

| | | |
|---------------------------|-----------------------|-------------------------------------------------------------------------------------|
| 55506305 | DATA SHEET |  |
| Valid from: 18.07.2019 | SILVYN® FPAG-M | |

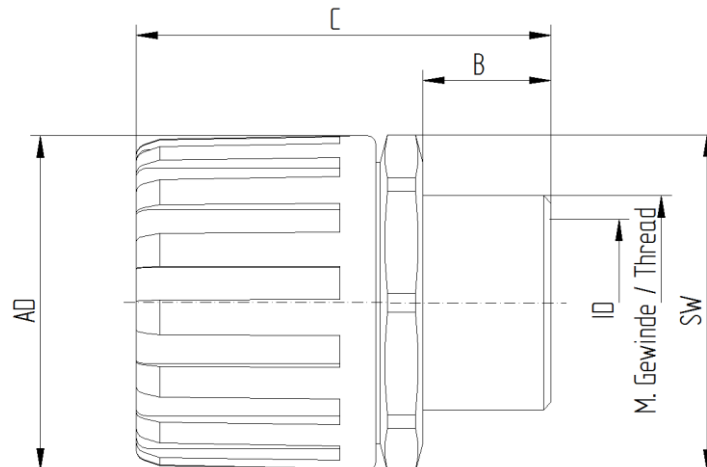

Dimension table:

| Part No. | NW | Thread | Thread length B mm | Length C mm | Inner Diameter ID mm | Outer Diameter AD mm | SW |
|----------------------------|----|---------|--------------------|-------------|----------------------|----------------------|----|
| SILVYN FPAG-M Grey | | | | | | | |
| 5550 6300 | 10 | M12x1,5 | 9 | 33 | 7,5 | 19 | 19 |
| 5550 6310 | 13 | M16x1,5 | 11 | 37 | 11,0 | 24 | 23 |
| 5550 6320 | 16 | M16x1,5 | 11 | 41 | 11,0 | 29 | 28 |
| 5550 6330 | 16 | M20x1,5 | 14 | 44 | 14,5 | 29 | 28 |
| 5550 7050 | 18 | M20x1,5 | 14 | 44 | 14,5 | 32 | 30 |
| 5550 6340 | 21 | M20x1,5 | 14 | 44 | 14,5 | 32 | 30 |
| 5550 6350 | 28 | M25x1,5 | 15 | 49 | 19,5 | 44 | 42 |
| 5550 6360 | 34 | M32x1,5 | 16 | 53 | 26,5 | 51 | 49 |
| 5550 6370 | 42 | M40x1,5 | 16 | 60 | 32,5 | 63 | 60 |
| 5550 6380 | 42 | M50x1,5 | 16 | 60 | 40,5 | 63 | 60 |
| 5550 6390 | 54 | M50x1,5 | 16 | 65 | 42,0 | 76 | 73 |
| 5550 6400 | 54 | M63x1,5 | 16 | 65 | 53,0 | 76 | 73 |
| 5550 6470 | 67 | M63x1,5 | 16 | 70 | 56,0 | 90 | 87 |
| SILVYN FPAG-M Black | | | | | | | |
| 5550 6305 | 10 | M12x1,5 | 9 | 33 | 7,5 | 19 | 19 |
| 5550 6315 | 13 | M16x1,5 | 11 | 37 | 11,0 | 24 | 23 |
| 5550 6325 | 16 | M16x1,5 | 11 | 41 | 11,0 | 29 | 28 |
| 5550 6335 | 16 | M20x1,5 | 14 | 44 | 14,5 | 29 | 28 |
| 5550 7055 | 18 | M20x1,5 | 14 | 44 | 14,5 | 32 | 30 |
| 5550 6345 | 21 | M20x1,5 | 14 | 44 | 14,5 | 32 | 30 |
| 5550 6355 | 28 | M25x1,5 | 15 | 49 | 19,5 | 44 | 42 |
| 5550 6365 | 34 | M32x1,5 | 16 | 53 | 26,5 | 51 | 49 |
| 5550 6375 | 42 | M40x1,5 | 16 | 60 | 32,5 | 63 | 60 |
| 5550 6385 | 42 | M50x1,5 | 16 | 60 | 40,5 | 63 | 60 |
| 5550 6395 | 54 | M50x1,5 | 16 | 65 | 42,0 | 76 | 73 |
| 5550 6405 | 54 | M63x1,5 | 16 | 65 | 53,0 | 76 | 73 |
| 5550 6475 | 67 | M63x1,5 | 16 | 70 | 56,0 | 90 | 87 |