

61825170	DATA SHEET	
Valid from: 03.07.2018	SILVYN® RKS 1	

The SILVYN® RKS 1, pipe-type cable clamps are the best fastening elements for cables, conduits and tubes. They are used throughout industry and also meet the high requirements in the automobile industry. With the rubber profile and several ribbon widths, together with the wide range of diameters, a large number of applications can be covered.



Material:

Clamp: Thin sheet, nickel plated
Rubber profile: EPDM

Technical Features:

Clamp wide: 12, 15 and 20mm
Range: 6 up to 40 mm

Additional features:

Weather and ozone resistance: Very good
Aging and sun crack resistance: Very good
Resistant to alcohol, acids and bases: Good

Temperature range: -40°C up to +120°C

Colour: Black

Creator: M. Wegerer /PDP Released: DAMU1/PDP	Document: DB61825170EN Version: 03	Page 1 of 2
---	---------------------------------------	-------------

61825170	DATA SHEET	
Valid from: 03.07.2018	SILVYN® RKS 1	

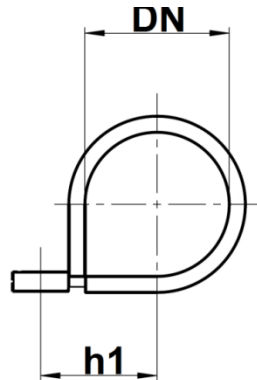

Dimensions

Part No.	Clamping range DN		Clamp wide mm	Wide x Thick Rubber profile mm	Drill hole mm	Assembly dimension h1 mm
	mm	inch				
6182 5170	6	1/4	12	15 x 1,2	5,3 (M5)	11,0 – 12,0
6182 5180	8	5/16	12	15 x 1,2	5,3 (M5)	12,0 – 13,0
6182 5190	10	3/8	12	15 x 1,2	5,3 (M5)	13,0 – 14,0
6182 5200	12	1/2	12	15 x 1,2	5,3 (M5)	14,0 – 15,0
6182 5210	13	1/2	15	18,5 x 1,5	6,4 (M6)	17,7 – 18,7
6182 5355	14	9/16	15	18,5 x 1,5	6,4 (M6)	18,2 – 19,2
6182 5365	15	5/8	15	18,5 x 1,5	6,4 (M6)	18,7 – 19,7
6182 5375	16	5/8	15	18,5 x 1,5	6,4 (M6)	19,2 – 20,2
6180 5040	18	3/4	15	18,5 x 1,5	6,4 (M6)	20,2 – 21,2
6182 5052	19	3/4	15	18,5 x 1,5	6,4 (M6)	20,7 – 21,7
6182 5380	20	13/16	15	18,5 x 1,5	6,4 (M6)	21,2 – 22,2
6182 5382	21	13/16	15	18,5 x 1,5	6,4 (M6)	21,7 – 22,7
6182 5050	22	7/8	15	18,5 x 1,5	6,4 (M6)	22,2 – 23,2
6182 5390	23	7/8	15	18,5 x 1,5	6,4 (M6)	22,7 – 23,7
6182 5392	24	15/16	20	25 x 1,5	8,4 (M8)	26,5 – 27,5
6182 5400	25	1	15	18,5 x 1,5	6,4 (M6)	23,7 – 24,7
6182 5402	26	1 1/6	15	18,5 x 1,5	6,4 (M6)	24,2 – 25,2
6182 5250	28	1 1/8	15	18,5 x 1,5	6,4 (M6)	25,2 – 26,2
6182 5255	30	1 3/16	15	18,5 x 1,5	6,4 (M6)	26,2 – 27,2
6182 5257	32	1 1/4	15	18,5 x 1,5	6,4 (M6)	27,2 – 28,2
6182 5259	34	1 5/16	15	18,5 x 1,5	6,4 (M6)	28,2 – 29,2
6182 5260	35	1 3/8	15	18,5 x 1,5	6,4 (M6)	28,7 – 29,7
6182 5262	36	1 7/16	20	25 x 1,5	8,4 (M8)	32,5 – 33,5
6182 5264	38	1 1/2	20	25 x 1,5	8,4 (M8)	33,5 – 34,5
6182 5295	40	1 9/16	20	25 x 1,5	8,4 (M8)	34,5 – 35,5

For more information please see our current catalogue. Please do not hesitate to contact our laboratory if there are any questions regarding resistance against aggressive agents and special oil.

Creator: M. Wegerer /PDP Released: DAMU1/PDP	Document: DB61825170EN Version: 03	Page 2 of 2
---	---------------------------------------	-------------